



泗水縣特力工具有限公司

地址：山东省泗水县经济开发区泉鑫路东首 P.C: 273299

Add: At East of Quanxin Rd., Sishui Economic Development Zone,
Sishui, Shandong, China

电话(Tel): 400-152-0537 +86-537-4252090

传真(Fax): 0537-4255482 Skype: tooltree

E-mail: ssst@tooltree.cn QQ: 1360156851

网址 (Website) : www.tooltree.cn

Tool Tree

CNC TOOLING SYSTEMS

NO.1
2016-2017
Made in China



Tool Tree

SISHUI TELI TOOL MANUFACTURING CO., LTD was legally registered in April, 2014 and locates in Sishui Economic Developing Zone, well-known in China as "the Hometown of Machine Tool Accessories". With the advantages of local production, skilled operation, well-organized management & intellectual in this line, we mainly manufacture series of Tool Holders on machine tools necessarily.

Our products are 3 types. The first is various Tooling System for CNC Machine Tools, including precision Tool Holders, Spring Collets, Rough or Precision Boring Heads and Tapping Collets; The second is other standard machine tool accessories, such as all kinds of Live Centers, Drill Chucks and so on; The third is the special machine parts on CNC machine tools as clients' samples or drawings.

Our brand "Tool Tree" was legally registered in May, 2015; The right of Export in March, 2015. We export our goods to worldwide markets, meanwhile we also push our brand via Trust-pass, T-mail, Taobao on Alibaba.com at domestic market.

We maintain the operation regulations and principles "quality breeds market, innovation creates development", and constantly update the practical value and brand effect of our products. Our aim is to bring more convenient first-hand experience to customers, and improve employee' life.

泗水县特力工具有限公司注册于2014年3月份，位于素有“机床附件之乡”的山东泗水县经济开发区。依靠当地特有的附件生产氛围与熟练操作及管理的人才优势，专门加工生产工具夹具类的机床附件产品。

主要产品一是各类数控工具系统，包括高精刀柄刀杆，高精筒夹；精镗粗镗头与攻丝夹头系列；二是其它标准附件如顶尖与钻夹头系列；三是可来图来样加工或非标订做各式机床上的部件产品。

本公司产品商标“Tool Tree工具树”注册于2015年5月份；自营出口权登记于2015年5月份；产品专注出口市场，同时国内网销于阿里诚信通，天猫旗舰店与淘宝店等渠道。

我们秉持“有品质才有市场，有创新才有发展”的经营理念，不断创新升级产品的实用价值与品牌效应，力争为客户不断带来更多更便利地实用新体验，同时为员工不断提升生活福祉！



CNC Tooling Systems 机床工具适配图

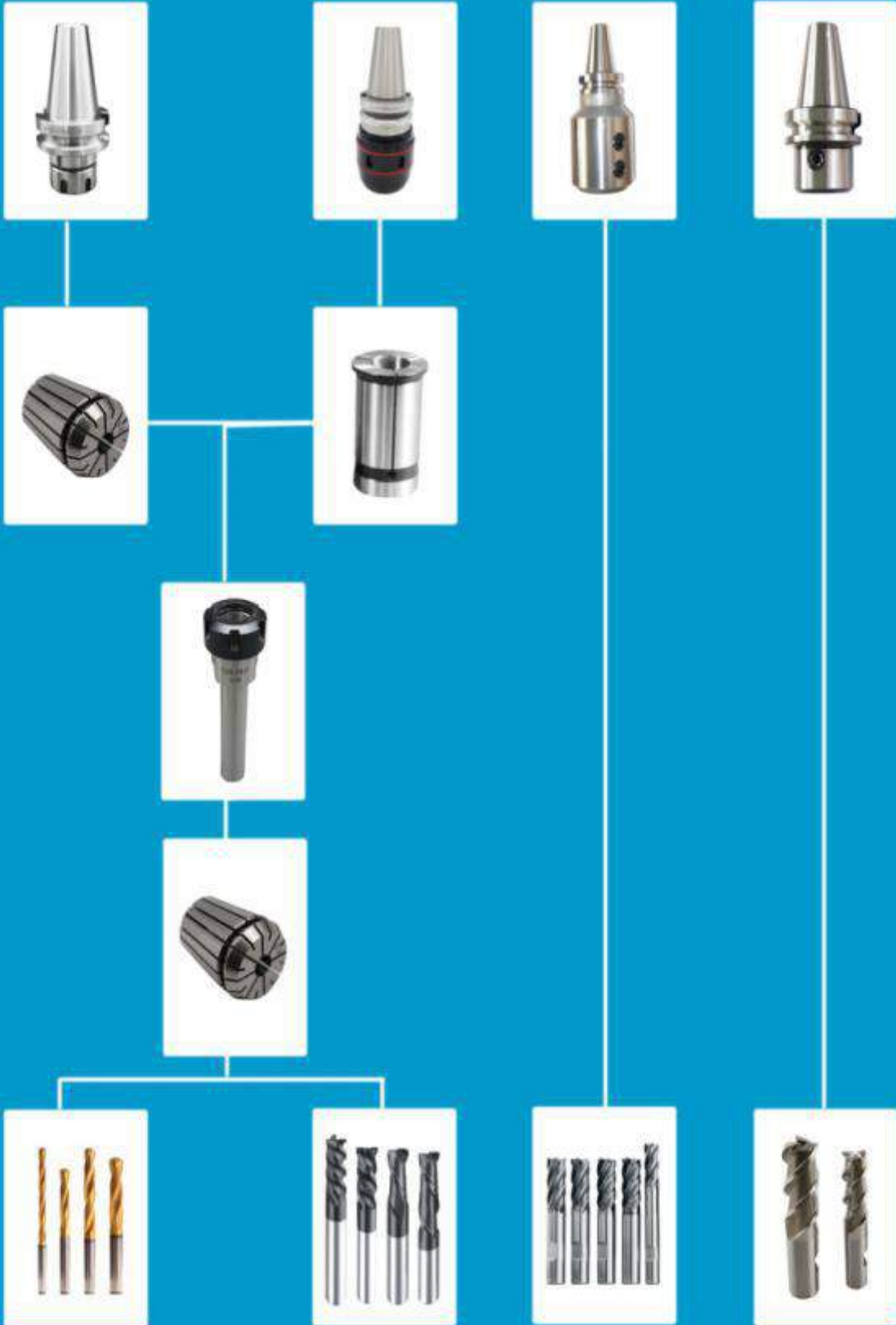

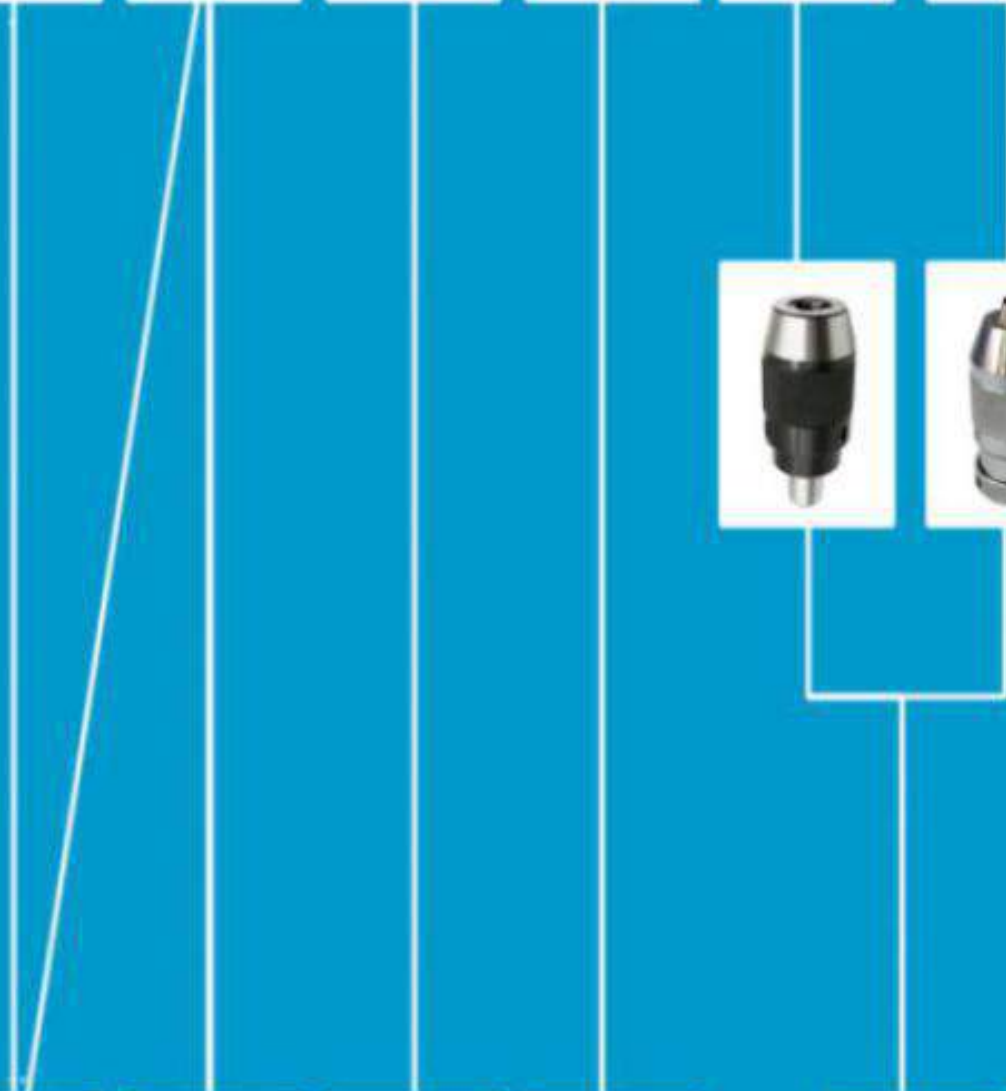

Tooling Systems 机床工具系统



BT 高速刀柄 BT x ER High-speed & Fine-balanced Tool Holders

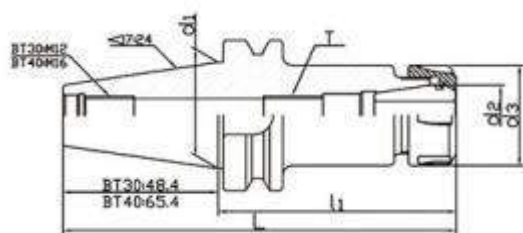

MAS403	20CrMnTi	≤0.005mm	≥12000rpm
--------	----------	----------	-----------

Model	L1	d3	d1
BT30xER11A-70	70	19	31.75
BT30xER16A-70	70	28	31.75
BT30xER20A-70	70	34	31.75
BT30xER25UM-70	70	42	31.75
BT30xER32UM-100	100	50	31.75
BT40xER11A-100	100	19	44.45
BT40xER16A-100	100	28	44.45
BT40xER20A-100	100	34	44.45
BT40xER25UM-100	100	42	44.45
BT40xER32UM-70	70	50	44.45
BT40xER32UM-100	100	50	44.45
BT40xER32UM-150	150	50	44.45
BT40xER40UM-80	80	63	44.45
BT40xER40UM-100	100	63	44.45
BT50xER16A-100	100	28	69.85
BT50xER16A-150	150	28	69.85
BT50xER20A-150	150	34	69.85
BT50xER25UM-150	150	42	69.85
BT50xER32UM-100	100	50	69.85
BT50xER32UM-150	150	50	69.85
BT50xER40UM-100	100	63	69.85
BT50xER40UM-150	150	63	69.85



Left different types of A.B.C&D are from different material with different precision and rotation for your choice.

左边 A, B, C & D 款材质不同, 精度与转速也不同供选择。

BT-ER 刀柄套装 BT-ER Collets Chuck Sets



Model	Qty. & Sizes	Bar Thread
BT30×ER16-70L	8 PCS(3-10mm)	M12×1.75P
BT30×ER32-70L	6 PCS(6-20mm)	M12×1.75P
	11 PCS(4-20mm)	
	18 PCS(3-20mm)	
BT40×ER32-70L	6PCS(6-20mm)	M16×2.0P
	11 PCS(4-20mm)	
	18 PCS(3-20mm)	
BT40×ER40-80L	7 PCS(6-25mm)	M16×2.0P
	15 PCS(4-26mm)	
	23 PCS(4-26mm)	
BT40×ER16-100L	8 PCS(3-10mm)	M12×1.75P
BT40×ER20-100L	11 PCS(3-13mm)	M12×1.75P
BT40×ER32-100L	6 PCS(6-20mm)	M16×2.0P
	11 PCS(4-20mm)	
	18 PCS(3-20mm)	
BT40×ER40-100L	7 PCS(6-25mm)	M16×2.0P
	15 PCS(4-26mm)	
	23 PCS(4-26mm)	
BT50×ER32- 100L	6 PCS(6-20mm)	M24×3.0P
	11 PCS(4-20mm)	
	18 PCS(3-20mm)	
BT50×ER40-100L	7 PCS(6-25mm)	M24×3.0P
	15 PCS(4-26mm)	
	23 PCS(4-26mm)	
BT50L×ER32-150	6 PCS(6-20mm)	M24×3.0P
	11 PCS(4-20mm)	
	18 PCS(3-20mm)	
BT50×ER40-150L	7 PCS(6-25mm)	M24×3.0P
	15 PCS(4-26mm)	
	23 PCS(4-26mm)	

NBT30 无键槽高速刀柄 NBT30 High Speed Collets Chuck without Keyway

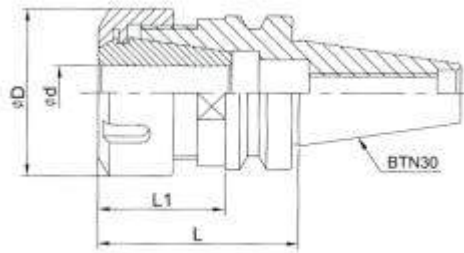

30000rpm
20CrMnTi
≤0.005mm

Model	Clamping	D	L	L1
NBT30-ER16-70	1-10	28	60	38
NBT30-ER20-70	1-13	34		38
NBT30-ER25-70	1-16	42		38
NBT30-ER32-70	3-20	50		38

ISO 无键槽高速刀柄 ISO High Speed Collets Chuck without Keyway

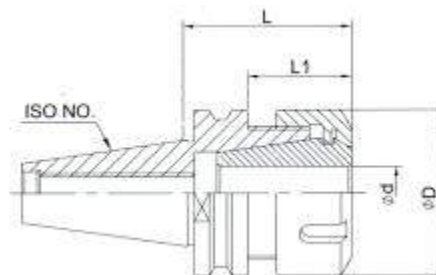

Model	Capacity	D	L	L1	20CrMnTi	≤0.005mm	≥30000rpm
ISO20×ER16MS-35	1-10	22	35	26			
ISO20×ER16M-35							
ISO25×ER16MS-35	1-10	22	35	26.2			
ISO25×ER16M-35							
ISO25×ER20MS-35	1-13	28	35	26.2			
ISO25×ER20M-35							
ISO30×ER16MS-60	1-10	22	60	40.9			
ISO30×ER20MS-60	1-13	28	60	40.9			
ISO30×ER25MS-60	1-16	35	60	40.9			
ISO30×ER25M-60							
ISO30×ER32UM-50	3-20	50	50	30.9			

BT×SK 高速刀柄 BT×SK Collets Chuck Holders

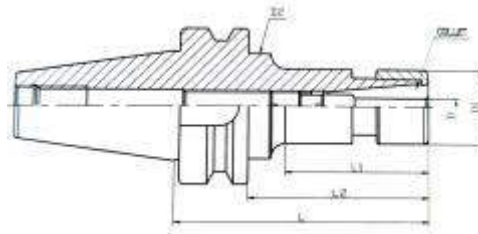

MAS403
20CrMnTiH
≤0.005mm
≧3000rpm



Model	Clamping	L	L1	D1	Collets
BT30xSK10-60	3-10	60	33	29	SK10
BT30xSK10-90		90	63		
BT30xSK16-60	3-16	60	33	40.5	SK16
BT30xSK16-90		90	63		
BT40xSK10-60	3-10	60	33	29	SK10
BT40xSK10-90		90	63		
BT40xSK16-60	3-16	60	33	40.5	SK16
BT40xSK16-90		90	63		
BT40xSK20-90	3-20	90	63	51	SK20
BT40xSK25-90	6-25.4	90	70	56.5	SK25

GSK/SK 螺帽 GSK/SK Nuts

Model	D	L	M
SK10	27	24	M21.5X1
SK16	40	31	M32X1.5
SK20	48	35	M40X1.5
SK25	55	37	M45X1.5

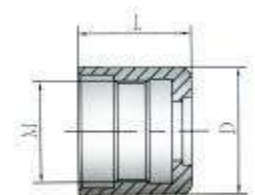

GSK/SK Ball Spanner 滚珠扳手

Model	D	L
SK10	27	130
SK16	40	193
SK20	48	200
SK25	55	210

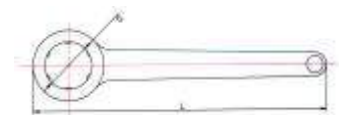

Straight Collets Chuck Sets

强力铣夹头套装 Straight Collets Chuck Sets

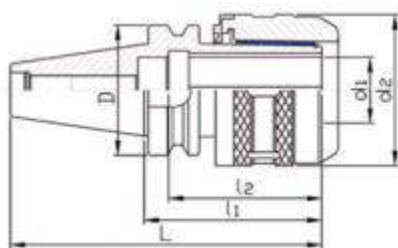

MAS403
20CrMnTiH
≤0.008mm

Size of shank & Collets		Back Bar Thread	Wt.
MT4	C32-75L	M16×2.0P	2.5
MT5	C32-75L	M24×3.0P	3.5
	C42-110L		5.0
R8	C20-85L	7/16"-20	2.5
NT30	C20-65L	M12×1.75P	3.0
NT40	C20-70L	M16×2.0P	3.5
	C32-95L		4.0
NT50	C32-100L	M24×3.0P	4.5
	C42-110L		6.0
BT30	C20-85L	M12×1.75P	2.5
	C25-85L		3.0
BT40	C20-90L/120L	M16×2.0P	3.0/4.0
	C25-95L/130L		4.5/5.0
	C32-105L/135L		3.0/3.5
BT50	C32-110L/150L	M24×3.0P	5.2/7.0
	C42-110L/135L		6.5/7.5



BT 侧固式立铣刀杆

BT Side Lock End Mill Arbors

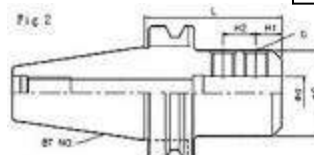
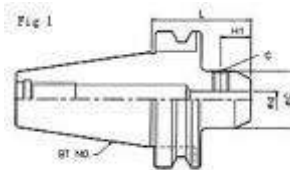

MAS403
20CrMnTi
≧ 12000rpm

Model	Fig	L	C	H1	H2
BT30×SLN20-70	1	70	52	25	-
BT40×SLN20-70	1	70	52	25	-
BT40×SLN25-90	2	90	65	24	25
BT40×SLN32-100	2	100	72	24	28
BT50×SLN25-100	2	100	65	24	25
BT50×SLN32-105	2	105	72	24	28
BT50×SLN40-110	2	110	90	30	32

BT × OMS 侧固式油路刀柄

BT-OMS Side Lock Oil-fed End Mill Arbors

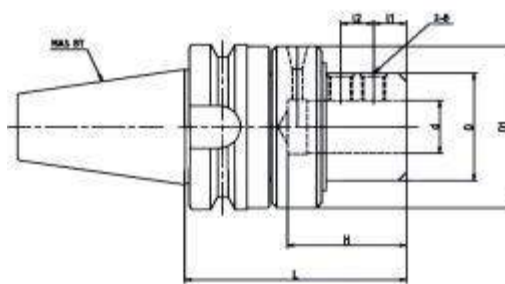

Model	d	L	D	D1	H	L1	L2	B	M
BT40×OMS20-105	20	105	50	78	50	20	-	M12	M16
BT40×OMS25-120	25	120	50	78	60	20	20	M12	M16
BT40×OMS32-125	32	125	60	88	70	20	20	M14	M16
BT50×OMS20-120	20	120	50	78	50	20	-	M12	M24
BT50×OMS25-135	25	135	50	78	60	20	20	M12	M24
BT50×OMS32-135	32	135	65	98	70	20	20	M14	M24
BT50×OMS40-145	40	145	65	98	80	20	25	M16	M24
BT50×OMS50-145	50	170	90	123	90	35	35	M20	M24

BT x FMA 端面铣刀杆

BT x FMA Shell Mill Arbors

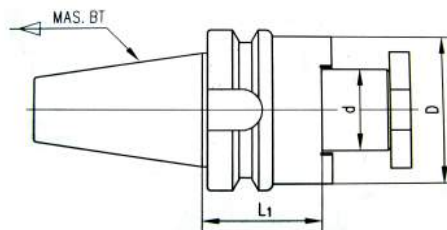

MAS403	20CrMnTi	$\geq 12000\text{rpm}$
--------	----------	------------------------

Model	L1	D	d
BT30×FMA25.4-45	45	50	25.4
BT40×FMA25.4-90	90	50	25.4
BT40×FMA31.75-75	75	60	31.75
BT40×FMA38.1-60	60	80	38.1
BT50×FMA25.4-45	45	50	25.4
BT50×FMA25.4-90	90	50	25.4
BT50×FMA31.75-45	45	60	31.75

BT x FMB 端面铣刀杆

BT x FMB Shell Mill Arbors

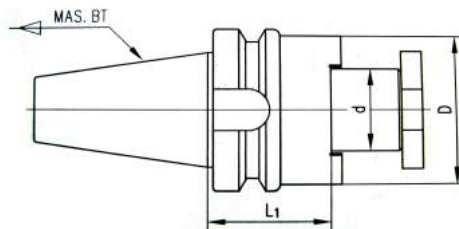

MAS403	20CrMnTi	$\geq 12000\text{rpm}$
--------	----------	------------------------

Model	L1	D	d
BT30×FMB22-45	45	50	22
BT30×FMB27-45	45	60	27
BT30×FMB32-60	60	78	32
BT40×FMB22-60	60	48	22
BT40×FMB22-100	100	48	22
BT40×FMB27-60	60	60	27
BT40×FMB32-60	60	78	32
BT40×FMB40-60	60	89	40
BT50×FMB22-100	100	50	22
BT50×FMB27-100	100	60	27
BT50×FMB32-100	100	78	32
BT50×FMB40-100	100	98	40
BT50×FMB60-75	75	140	60

BT X MT 变径套 BT × MT Adapt Sleeves



BT-MTA BT-MTB

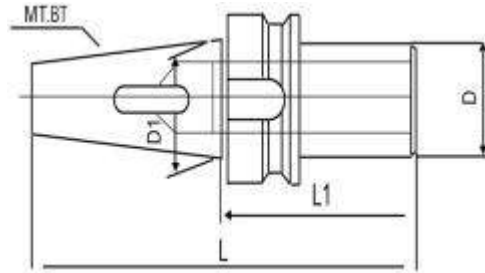

MAS403
20CrMnTi
≥85%

Model	L	D	D1
BT30 × MT2 - 60	108.4	32	31.75
BT30 × MT3 - 80	128.4	40	31.75
BT 40 × MT2 - 60	125.4	32	44.45
BT40 × MT3 - 70	135.4	40	44.45
BT40 × MT3 - 75	140.4	40	44.45
BT40 × MT4 - 90	155.4	48	44.45
BT40 × MT4 - 95	160.4	48	44.45
BT50 × MT2 - 45	146.8	25	69.85
BT50 × MT3 - 65	166.8	40	69.85
BT50 × MT3 - 75	176.8	40	69.85
BT50 × MT3 - 135	236.8	40	69.85
BT50 × MT4 - 85	186.8	48	69.85

BT x OZ 铣刀柄 BT x OZ Collets Holders

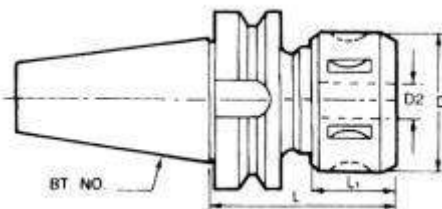

20CrMnTiH
≤0.005mm
≥12000rpm



Model	D2	L	D	L1	Collets	Back Bar Thread
BT40xOZ25-80	3-25	80	60	30	OZ25	M16×2.0P
BT40xOZ25-120	3-25	120	60	30	OZ25	
BT40xOZ32-80	6-32	80	72	33	OZ32	
BT40xOZ32-150	6-32	150	72	33	OZ32	M24×3.0P
BT50xOZ25-90	3-25	90	60	30	OZ25	
BT50xOZ25-130	3-25	130	60	30	OZ25	
BT50xOZ32-105	6-32	105	72	33	OZ32	

BT 钻接杆 BT Drill Chuck Arbors

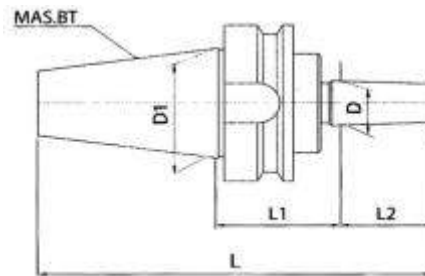

20CrMnTi	MAS403	≥85%
----------	--------	------

Model	L2	L	D	D1	M
BT40-B16-45	24	134.4	15.733	44.45	M16
BT40-B18-45	32	142.4	15.733	44.45	M16
BT40-JT6-45	22.225	132.6	14.199	44.45	M16
BT40-JT3-45	30.956	141.4	20.599	44.45	M16
BT40-J33-45	25.4	135.8	15.850	44.45	M16

数控一体式钻夹头 CNC Integrated Drill Chucks

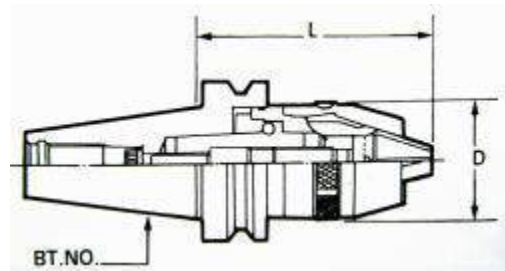

MAS403	≤0.015	20CrMnTi
--------	--------	----------

Model	Clamping range	D	L	
			Min.	Max.
BT30-APU08-80	1-8	36.3	75	82
BT30-APU13-110	1-13	51.5	94	104.5
BT40-APU08-85	1-8	36.3	79	86.5
BT40-APU13-110	1-13	51.5	98	109
BT40-APU16-110	1-16	58	115	130
BT50-APU13-110	1-13	49	98	109
BT50-APU16-130	1-16	54	115	130

BT 混合插入式铣刀杆 BT Combine Shell End Mill Arbors

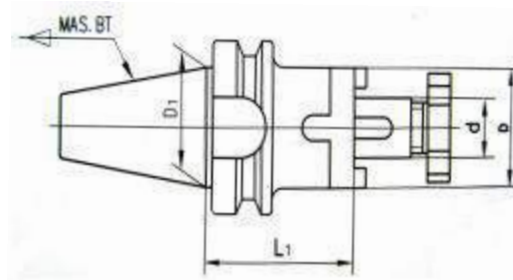

MAS403	20CrMnTi	≧ 12000rpm
--------	----------	------------

Model	L1	D	D1	d
BT30×CEM16-50	50	32	31.75	16
BT30×CEM22-50	50	40		22
BT30×CEM27-55	55	48		27
BT40×CEM16-55	55	32	44.45	16
BT40×CEM16-100	100	32		16
BT40×CEM22-55	55	40		22
BT40×CEM22-100	100	40		22
BT40×CEM27-55	55	48		27
BT40×CEM27-100	100	48		27
BT40×CEM32-60	60	58		32
BT40×CEM32-100	100	58		32
BT40×CEM40-60	60	70		40
BT40×CEM40-100	100	70		40
BT50×CEM16-70	70	32		69.85
BT50×CEM16-100	100	32	16	
BT50×CEM22-70	70	40	22	
BT50×CEM22-100	100	40	22	
BT50×CEM27-70	70	48	27	
BT50×CEM27-100	100	48	27	
BT50×CEM32-70	70	58	32	
BT50×CEM32-100	100	58	32	
BT50×CEM40-70	70	70	40	
BT50×CEM40-100	100	70	40	

HSK-ER 高速刀柄 HSK-ER High Speed Collets Chuck

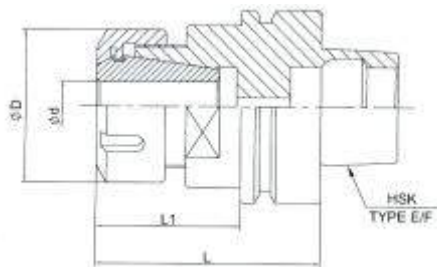

DIN69893
30000rpm
20CrMnTi
 $\leq 0.005\text{mm}$

Model	Range	d	L	D
HSK40E-ER20-80	1.0-13.0	34	80	40
HSK40E-ER25-80	1.0-16.0	42	80	40
HSK50E-ER16-100	1.0-10.0	28	100	50
HSK50E-ER20-100	1.0-13.0	34	100	50
HSK50E-ER25-100	1.0-16.0	42	100	50
HSK50E-ER32-100	3.0-20.0	50	100	50
HSK63A-ER16-75	1.0-10.0	28	75	63
HSK63A-ER16-100	1.0-10.0	28	100	63
HSK63A-ER16-125	1.0-10.0	28	125	63
HSK63A-ER20-75	1.0-13.0	34	75	63
HSK63A-ER20-100	1.0-13.0	34	100	63
HSK63A-ER20-125	1.0-13.0	34	125	63
HSK63A-ER25-75	2.0-16.0	42	75	63
HSK63A-ER25-100	2.0-16.0	42	100	63
HSK63A-ER25-125	2.0-16.0	42	125	63
HSK63A-ER32-100	2.0-20.0	50	100	63
HSK63A-ER32-125	2.0-20.0	50	125	63
HSK63A-ER32-160	2.0-20.0	50	160	63
HSK100A-ER16-100	1.0-10.0	28	100	100
HSK100A-ER16-125	1.0-10.0	28	125	100
HSK100A-ER16-160	1.0-10.0	28	160	100
HSK100A-ER20-100	1.0-13.0	34	100	100
HSK100A-ER20-125	1.0-13.0	34	125	100
HSK100A-ER20-160	1.0-13.0	34	160	100
HSK100A-ER25-100	2.0-16.0	42	100	100
HSK100A-ER25-125	2.0-16.0	42	125	100
HSK100A-ER32-100	2.0-20.0	50	100	100
HSK100A-ER32-125	2.0-20.0	50	125	100
HSK100A-ER32-160	2.0-20.0	50	160	100

HSK-FMB 高速刀柄 HSK-FMB High Speed Collets Chuck

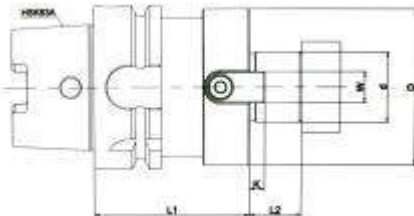

DIN69893
30000rpm
20CrMnTi
≤0.005mm

Model	d	D	L1	L2	W	K
HSK63A-FMB22-50	22	50	50	19	10	4.8
HSK63A-FMB22-100	22	50	100	19	10	4.8
HSK63A-FMB22-160	22	50	160	19	10	4.8
HSK63A-FMB27-60	27	60	60	21	12	5.8
HSK63A-FMB27-100	27	60	100	21	12	5.8
HSK63A-FMB27-160	27	60	160	21	12	5.8
HSK63A-FMB32-60	32	78	60	24	14	6.8
HSK63A-FMB32-100	32	78	100	24	14	6.8
HSK63A-FMB32-160	32	78	160	24	14	6.8
HSK63A-FMB40-60	40	89	60	27	16	8.3
HSK63A-FMB40-100	40	89	100	27	16	8.3
HSK63A-FMB40-160	40	89	160	27	16	8.3
HSK100A-FMB22-50	22	50	50	19	10	4.8
HSK100A-FMB22-100	22	50	100	19	10	4.8
HSK100A-FMB22-160	22	50	160	19	10	4.8
HSK100A-FMB27-50	27	60	50	21	12	5.8
HSK100A-FMB27-100	27	60	100	21	12	5.8
HSK100A-FMB27-160	27	60	160	21	12	5.8
HSK100A-FMB32-60	32	78	60	24	14	6.8
HSK100A-FMB32-100	32	78	100	24	14	6.8
HSK100A-FMB32-160	32	78	160	24	14	6.8
HSK100A-FMB40-60	40	89	60	27	16	8.3
HSK100A-FMB40-100	40	89	100	27	16	8.3
HSK100A-FMB40-160	40	89	160	27	16	8.3

SK 刀柄 SK x ER High-speed & Fine-balanced Tool Holders

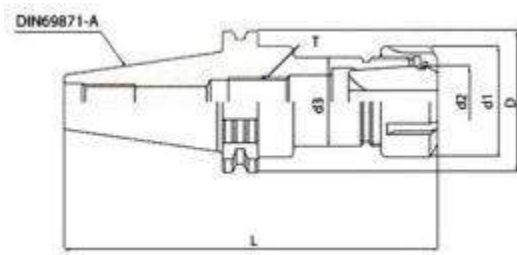

DIN69871-A
20CrMnTi
≤0.005mm
≥12000rpm



Model	L	L1	D	d1	d2	Thread	KGS
SK30-ER11-100	148.4	80	50	19	11	M6*1P	0.6
SK30-ER16-100	148.4	100		28	16	M10*1.5P	0.7
SK30-ER20-100	148.4	100		34	20	M12*1.75P	0.75
SK40-ER11-80	148.4	80	63.55	19	11	M6*1P	1.05
SK40-ER16-70	138.4	70		28	16	M10*1.5P	1.3
SK40-ER16-100	168.4	100		28	16	M10*1.5P	1.4
SK40-ER20-100	168.4	100		34	20	M12*1.75P	1.5
SK40-ER25-100	168.4	100		42	25	M16*2P	1.85
SK40-ER25-150	218.4	150		42	25	M16*2P	2.25
SK40-ER32-70	138.4	70		50	32	M16*2P	1.6
SK40-ER32-100	168.4	100		50	32	M16*2P	2
SK40-ER40-70	138.4	70		63	40	M16*2P	1.5
SK40-ER40-100	168.4	100		50	32	M16*2P	2
SK40-ER40-135	203.4	135		63	40	M16*2P	3.3
SK50-ER16-100	201.4	100		97.5	28	16	M10*1.5P
SK50-ER16-160	261.75	160	28		16	M10*1.5P	4.5
SK50-ER20-100	201.75	100	34		20	M12*1.75P	3.4
SK50-ER20-160	261.75	160	34		20	M12*1.75P	3.8
SK50-ER25-70	171.75	70	42		25	M16*2P	3.4
SK50-ER25-100	201.75	100	42		25	M16*2P	4.15
SK50-ER25-150	251.75	150	42		25	M16*2P	4.5
SK50-ER32-120	221.75	120	50		32	M16*2P	4.6
SK50-ER32-160	261.75	160	50		32	M16*2P	4.75
SK50-ER40-80	181.75	80	63		40	M16*2P	3.65
SK50-ER40-120	221.75	120	63		40	M16*2P	4.8
SK50-ER40-160	261.75	160	63		40	M16*2P	5.2
SK50-ER50-120	221.75	120	78		50	M20*2.5P	5.45
SK50-ER50-160	261.75	160	78		50	M20*2.5P	5.55

SK 套式铣刀杆 SK Shell End Mill Arbors

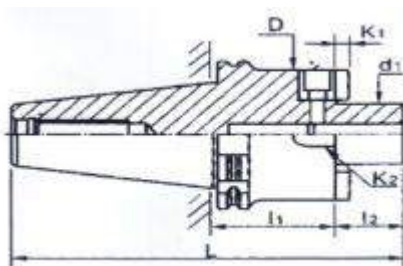

DIN69871-A

20CrMnTiHH



Model	L	l2	l3	d2	d3	k1	k2	KGS
SK30xEMB22-35	100.8	18	14	26	47	4.8	10	1.00
SK30xFMB27-35	102.8	20	16	31.5	58	5.8	12	1.05
SK40xFMB22-35	121.4	18	14	26	47	4.8	10	1.20
SK40xFMB27-60	148.4	20	16	31.5	58	5.8	12	1.8
SK40xFMB32-60	150.4	22	16	41	66	6.8	14	2.3
SK40xFMB40-60	153.4	25	20.5	48	80	8.3	16	2.8
SK50xFMB22-35	154.75	18	14	26	47	4.8	10	3.4
SK50xFMB27-35	156.75	20	16	31.5	58	5.8	12	3.5
SK50xFMB32-35	158.75	22	16	41	66	6.8	14	3.7
SK50xFMB40-50	189.75	25	20.5	48	80	8.3	16	4.7

SK 一体式钻夹头 SK Integrated Keyless Drill Chucks

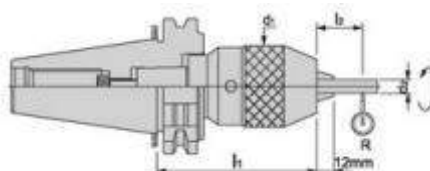

DIN69871-A

20CrMnTi



Model	l1	l2	d1	d2	R	Range		KGS
						mm	inch	
SK30xAPU08-80	80	55	37	6	0.4	1~8	1/24~5/16	0.60
SK30xAPU13-120	120	75	50	13		1~13	1/24~1/2	1.45
SK30xAPU16-120	120	75	57	16		3~16	1/8~5/8	1.78
SK40xAPU08-75	75	55	37	6	0.4	1~8	1/24~5/16	1.32
SK40xAPU13-100	100	75	50	13		1~13	1/24~1/2	1.92
SK40xAPU16-115	115	80	57	16		3~16	1/8~5/8	2.28
SK50xAPU08-75	75	55	37	6	0.4	1~8	1/24~5/16	3.86
SK50xAPU13-100	100	75	50	13		1~13	1/24~1/2	4.40
SK50xAPU16-105	105	80	57	16		3~16	1/8~5/8	4.48

SK 侧固式立铣刀杆 SK Side Lock End Mill Arbors

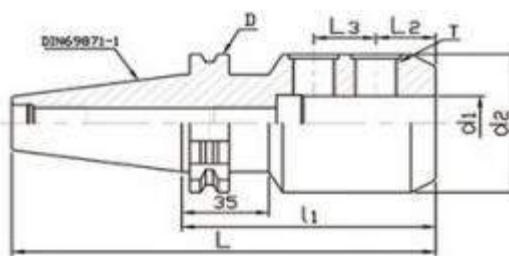

DIN69871-A

20CrMnTi

Model	L	I2	I3	L2	d2	T	KGS
SK30×SLN12-50	97.8	50	42	22.5	42	M12x1.75P	0.9
SK30×SLN16-63	97.8	63	48	24	48	M14x2.0P	1.10
SK40×SLN12-50	118.4	50	42	22.5	42	M12x1.75P	1.15
SK40×SLN16-63	131.4	63	48	24	48	M14x2.0P	1.4
SK40×SLN20-63	131.4	63	52	25	52	M16x2.0P	1.3
SK40×SLN25-100	168.4	100	65	24	65	M18x2.0P	2.4
SK40×SLN32-100	168.4	100	72	24	72	M20x2.0P	2.7
SK50×SLN16-63	164.75	63	48	24	48	M14x2.0P	3.45
SK50×SLN20-63	164.75	63	52	25	52	M16x2.0P	3.5
SK50×SLN25-80	181.75	80	65	24	65	M18x2.0P	4.2
SK50×SLN32-100	201.75	100	72	24	72	M20x2.0P	5.0
SK50×SLN40-100	201.75	100	90	30	90	M20x2.0P	5.6
SK50×SLN50-125	226.75	125	100	35	125	M20x2.0P	6.2

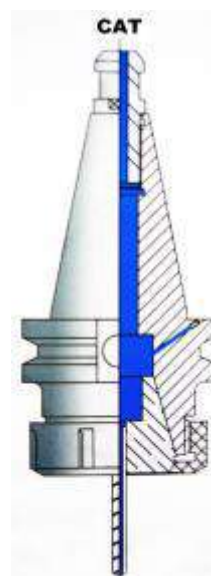
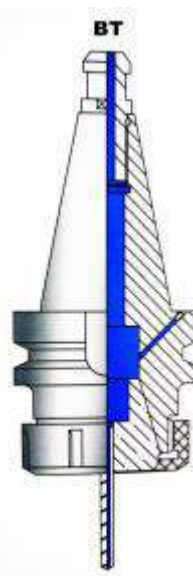
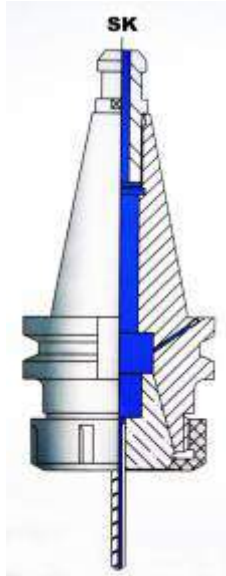

NT x ER 铣夹头刀柄 NT x ER Collets Holders

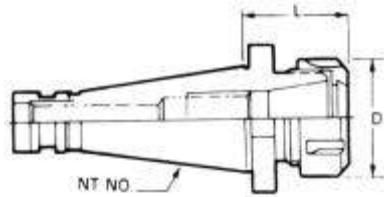

DIN2080
20CrMnTi



NT x ER 套装铣夹头 NT x ER Collets Chuck Sets



Model	Qty. & Clamping	Back Bar Thread	Wt.
NT30×ER25	7PCS(2-16mm)	M12×1.75P	2.4
	15PCS(4-16mm)		2.8
NT30×ER32	6PCS(6-20mm)	M12×1.75P	2.8
	11 PCS(4-20mm)		3.2
	18 PCS(3-20mm)		4.2
NT30×ER40	7PCS(6-25mm)	M12×1.75P	4.6
	15 PCS(4-26mm)		6.0
	23 PCS(4-26mm)		7.3
NT40×ER25	7PCS(3-16mm)	M16×2.0P	3.0
	15 PCS(3-16mm)		3.3
NT40×ER32	6 PCS(6-20mm)	M12×1.75P	3.4
	11 PCS(4-20mm)		3.8
	18 PCS(3-20mm)		4.8
NT40×ER40	7PCS(6-25mm)	M16×2.0P	5.2
	15 PCS(4-26mm)		6.9
	23 PCS(4-26mm)		8.2
NT50×ER32	6 PCS(6-20mm)	M24×3.0P	5.3
	11PCS(4-20mm)		5.5
	18 CS(3-206mm)		6.5
NT50×ER40	7 PCS(6-25mm)	M24×3.0P	7.0
	15 PCS(4-26mm)		8.5
	23 PCS(4-26mm)		9.8

NTxOZ 铣刀柄 NTxOZ Collets Holders

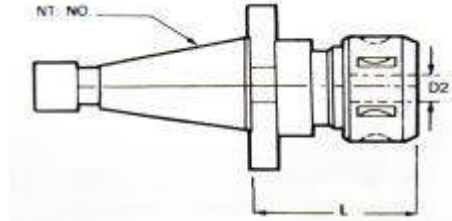

DIN2080	20CrMnTi	≥12000rpm
---------	----------	-----------

Model	D2	L	Collets	Back Bar Thread
NT30xOZ25-70	3-25	70	OZ25	M12×1.75P
NT30xOZ32-100	6-32	100	OZ32	
NT40xOZ25-70	3-25	70	OZ25	M16×2.0P
NT40xOZ32-70	6-32	70	OZ32	
NT50xOZ25-80	3-25	80	OZ25	M24×3.0P
NT50xOZ32-80	6-32	80	OZ32	

NT 侧固式铣刀杆 NT Side Lock End Mill Arbors

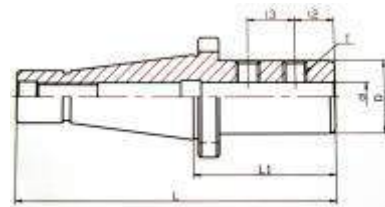

DIN2080

Model	L1	D	d	l2	l3
NT30×SL20-63	63	52	20	25	-
NT30×SL25-80	82	65	25	24	25
NT40×SL20-63	63	52	20	25	-
NT40×SL25-80	80	65	25	24	25
NT40×SL32-80	80	72	32	24	28
NT50×SL25-80	80	65	25	24	25
NT50×SL32-80	80	72	32	24	28
NT50×SL40-100	100	90	40	30	32
NT50×SL42-100	100	90	42	30	32

NT 套式铣刀杆

NT Shell End Mill Arbors

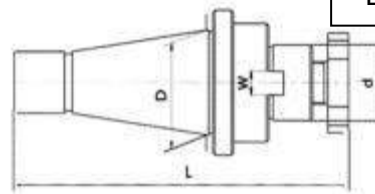

DIN2080

Model	D	d	W	L
NT30xFMB22	31.75	22	10	129
NT30xFMB27		27	12	134
NT40xFMB22	44.45	22	10	156
NT40xFMB27		27	12	159
NT40xFMB32		32	14	178
NT50xFMB22	69.85	22	10	208
NT50xFMB27		27	12	211
NT50xFMB32		32	14	215
NT50xFMB40		40	16	219

NT 混合插入式铣刀杆

NT Combine Shell End Mill Arbors

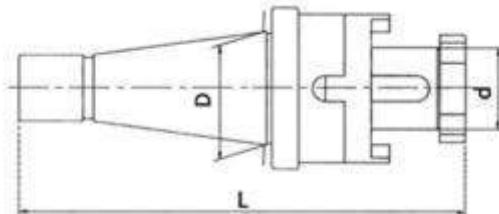

DIN2080

Model	Shank	d	L	Wt.
NT30×13	ISO30	13	120	0.608
NT30×16	ISO30	16	131	0.746
NT30×22	ISO30	22	132	1.038
NT30×27	ISO30	27	135	1.474
NT30×32	ISO30	32	151	2.101
NT40×16	ISO40	16	168	1.3
NT40×22	ISO40	22	171	2.042
NT40×27	ISO40	27	174	2.69
NT40×32	ISO40	32	178	2.679

ER 直柄延长杆 ER Collets Extension Bars

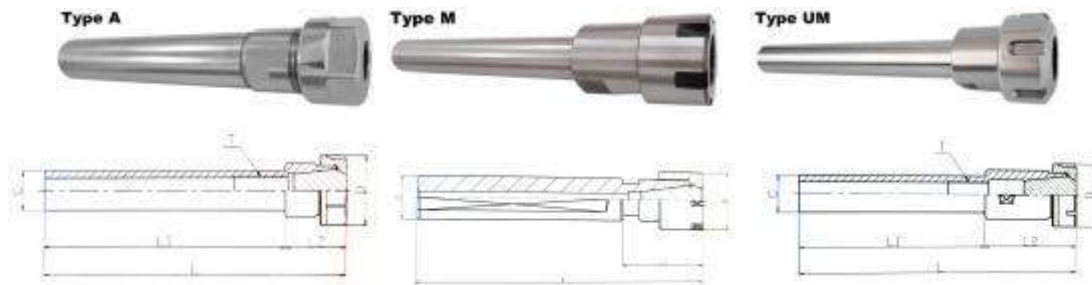

≧ 12000rpm	20CrMnTi
------------	----------

Model	L	L1	C	D
C10×ER8A/M-100	117	100	10	12
C10×ER11A/M-100	121.6/116.6	100	10	19/16
C12×ER11A/M-100	121.6/116.6	100	12	19/16
C12×ER16A/M-100	140/137	100	12	28/22
C16×ER11A/M-100	121.6/116.6	100	16	19/16
C16×ER16A/M-100	140/137	100	16	28/22
C16×ER16A/M-150	190/187	150	16	28/22
C20×ER16A/M-100	140/137	100	20	28/22
C20×ER16A/M-150	190/187	150	20	28/22
C20×ER20A/M-100	140.5/140	100	20	34/28
C20×ER25UM-100	151	100	20	42
C20×ER32UM-100	51.5	100	20	50
C25×ER20A/M-100	140.5/140	100	25	34/28
C25×ER25UM-100	51	100	25	42
C25×ER32UM-100	51.5	100	25	50
C32×ER32UM-100	51.5	100	32	50
C32×ER32UM-150	51.5	150	32	50
C40×ER32UM-100	51.5	100	40	50
C40×ER40UM-100	65	100	40	63



Any other special sizes as ordered. 其它规格可按订单供货

ER 直柄延长杆套装

ER Collets Extension Bar Sets



Model		Qty. & Clamping	Back Bar Thread	Wt.
C16	100L×ER11	5PCS(3-7mm)	M10x1.5P	0.6
	150L×ER11	5PCS(3-7mm)		0.7
C20	100L×ER16	8 PCS(3-10mm)	M12x1.75P	1.15
	150L×ER16	8 PCS(3-10mm)		1.25
	100L×ER20	11 PCS(3-13mm)		1.25
	150L×ER20	11 PCS(3-13mm)		1.35
	100L×ER25	7 PCS(6-16mm)		1.8
		15 PCS(2-16mm)		2.5
	150L×ER25	7 PCS(6-16mm)		1.9
		15 PCS(2-16mm)		2.65
C25	100L×ER16	8 PCS(3-10mm)	M12x1.75P	1.25
	150L×ER16	8 PCS(3-10mm)		1.35
	100L×ER20	11 PCS(3-13mm)		1.4
	100L×ER25	7 PCS(6-16mm)		1.9
		15 PCS(2-16mm)		2.5
	150L×ER25	7 PCS(6-16mm)		2.0
		15 PCS(2-16mm)	2.65	
	100L×ER32	6 PCS(3-20mm)	M16x2.0P	2.7
18 PCS(3-20mm)		4.1		
C32	100L×ER25	7 PCS(6-16mm)	M12x1.75P	2.0
		15 PCS(2-16mm)		2.5
	100L×ER32	6 PCS(6-20mm)	M16x2.0P	2.9
		11 PCS(6-20mm)		3.2
		18 PCS(4-20mm)		4.3
	100L×ER40	7 PCS(6-25mm)		4.6
		15 PCS(4-26mm)		6.1
		23 PCS(4-26mm)	7.3	
C40	100L×ER32	6 PCS(6-20mm)	M16x2.0P	3.2
		11 PCS(6-20mm)		3.5
		18 PCS(4-20mm)		4.6
	100L×ER40	7 PCS(6-25mm)		5.0
		15 PCS(4-26mm)		6.5
		23 PCS(4-26mm)		7.6

MTxER Collets Holders

MT x ER 刀柄 MT x ER Collets Holders

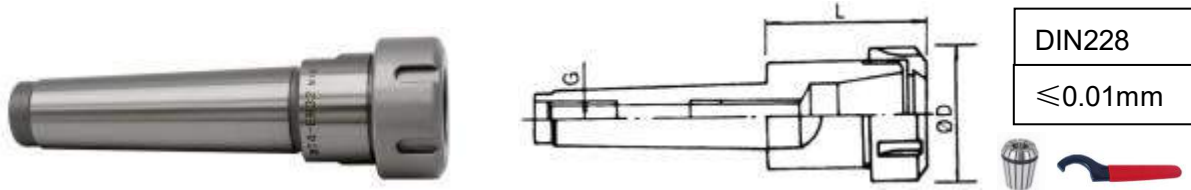

MT x ER 套装铣夹头 MT x ER Collets Chuck Sets



Model	Qty. & Clamping	Back Bar Thread	Wt.
MT2×ER16	8PCS(3-10mm)	M10×1.5P	1.0
MT2×ER20	11 PCS(3-13mm)		1.2
MT2×ER25	7 PCS(6-16mm)		1.3
	15PCS(2-16mm)		2.4
MT3×ER16	8PCS(3-10mm)	M12×1.75P	1.1
MT3×ER20	11PCS(3-13mm)		1.3
MT3×ER25	7PCS(4-16mm)		2.1
	15 PCS(2-16mm)		2.5
MT3×ER32	6 PCS(6-20mm)		2.7
	11 PCS(4-20mm)		3.0
	18 PCS(3-20mm)		4.1
MT3×ER40	7PCS(6-25mm)		4.5
	15 PCS(4-26mm)		6.0
	23PCS(4-26mm)		7.2
MT4×ER32	6 PCS(6-20mm)	M16×2.0P	2.9
	11 PCS(4-20mm)		3.2
	18 PCS(3-20mm)		4.3
MT4×ER40	7 PCS(6-25mm)		4.6
	15 PCS(4-26mm)		6.1
	23 PCS(4-26mm)		7.3
MT5×ER40	7 PCS(6-25mm)	M20×2.5P	5.4
	15 PCS(4-26mm)		6.9
	23 PCS(4-26mm)		8.2

OZ Collets Holders

MTxOZ 铣刀柄

MTxOZ Collets Holder

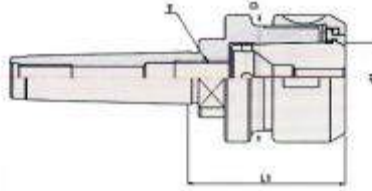

Model	D2	L1	Collets	Back Bar Thread
MT3xOZ25-60	3-25	60	OZ25	M10×1.0P
MT4xOZ25-60	3-25	60	OZ25	M16×2.0P
MT5xOZ25-75	3-25	75	OZ25	M24×3.0P

R8xOZ 铣刀柄

R8xOZ Collets Holder

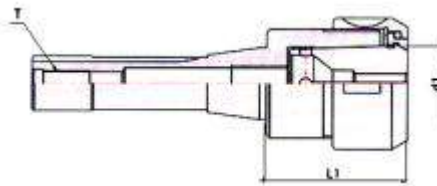

Model	D2	L1	Collets	Back Bar Thread
R8 xOZ25-60	3-25	60	OZ25	7/16-20UNF

OZ 筒夹套装

OZ Collets Sets

(OZ Collets = EOCA)



OZ25 (EOCA25)	7PCS	Metric	6; 8; 10; 12; 16; 20; 25mm
		Inch	1/4", 5/16", 3/8", 1/2", 5/8", 3/4", 1"
	15PCS	Metric	3; 4; 5; 6; 7; 8; 9; 10; 11; 12; 14; 16; 18; 20; 25mm
		Inch	1/8",3/16";1/4",5/16",3/8",7/16",1/2",9/16",5/8",11/16",3/4",13/16",7/8",15/16",1"
OZ32 (EOCA32)	8PCS	Metric	6; 8; 10; 12; 16; 20; 25; 32mm
		Inch	1/4", 5/16", 3/8", 1/2", 5/8", 3/4", 1", 1-1/4"
	15PCS	Metric	6; 7; 8; 9; 10; 11; 12; 13; 16; 18; 20; 25; 30; 32mm
		Inch	1/4",5/16",3/8",7/16",1/2",9/16",5/8",11/16",3/4",13/16",7/8",15/16",1";1-1/8";1-1/4"

MT 套式铣刀杆 MT Shell End Mill Arbors

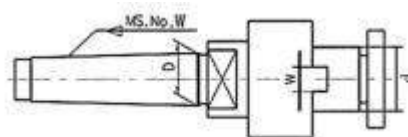

DIN228

Model	D	d	W
MT3×22	23.825	22	10
MT3×27		27	12
MT3×32		32	14
MT3×40		40	16
MT4×22	31.267	22	10
MT4×27		27	12
MT4×32		32	14
MT4×40		40	16
MT4×50		50	18

MT 混合插入式铣刀杆 MT Combine Shell End Mill Arbors

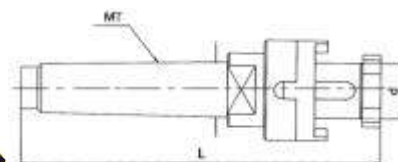

DIN228

Model	MS.NO	d	L	Wt.
MT3×27	MT3	27	160	0.725
MT3×32	MT3	32	169	0.975
MT4×22	MT4	22	184	0.969
MT4×27	MT4	27	187	1.083
MT4×32	MT4	32	199	1.395
MT4×40	MT4	40	203	1.746
MT5×22	MT5	22	226	2.137
MT5×27	MT5	27	229	2.294
MT5×32	MT5	32	233	2.496
MT5×40	MT5	40	237	2.862
MT5×50	MT5	50	242	2.536

CAT 高速刀柄 CAT x ER High-speed & Fine-balanced Tool Holders

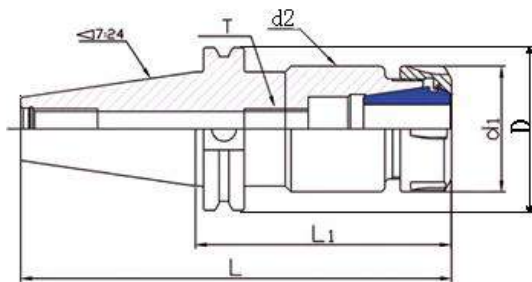

ANSI B5.50	20CrMnTi	$\le 0.005\text{mm}$	$\ge 12000\text{rpm}$
------------	----------	----------------------	-----------------------

Model	L	L1	D	d1	d2	Thread	KGS
CAT40-ER16-2.76"	5.447"	2.76"	2.5"	1.102"	1.75"	M10*1.5P	1.05
CAT40-ER16-4"	6.687"	4"		1.102"		M10*1.5P	1.35
CAT40-ER16-6"	8.687"	6"		1.102"		M10*1.5P	1.65
CAT40-ER20-2.76"	5.447"	2.76"		1.339"		M12*1.75P	1.25
CAT40-ER20-4"	6.687"	4"		1.339"		M12*1.75P	1.65
CAT40-ER25-2.76"	5.447"	2.76"		1.654"		M16*2P	1.35
CAT40-ER25-4"	6.687"	4"		1.654"		M16*2P	1.70
CAT40-ER25-6"	8.687"	6"		1.654"		M16*2P	2.25
CAT40-ER32-2.76"	5.447"	2.76"		1.969"		M16*2P	1.25
CAT40-ER32-4"	6.687"	4"		1.969"		M16*2P	1.75
CAT40-ER32-6"	8.687"	6"		1.969"		M16*2P	2.15
CAT40-ER40-3.15"	5.837"	3.15"		2.480"		M20*2.5P	1.80
CAT40-ER40-4"	6.687"	4"		2.480"		M20*2.5P	2.05
CAT40-ER40-6"	8.687"	6"		2.480"		M20*2.5P	3.30
CAT40-ER50-4"	6.687"	4"	3.070"	M24*3.0P	2.65		
CAT50-ER16-4"	8"	4"	3.875"	1.102"	2.75"	M10*1.5P	4.10
CAT50-ER16-6"	10"	6"		1.102"		M10*1.5P	4.28
CAT50-ER20-4"	8"	4"		1.339"		M12*1.75P	4.20
CAT50-ER20-6"	10"	6"		1.339"		M12*1.75P	4.45
CAT50-ER25-4"	8"	4"		1.654"		M16*2P	4.15
CAT50-ER25-6"	10"	6"		1.654"		M16*2P	4.50
CAT50-ER32-4"	8"	4"		1.969"		M16*2P	4.70
CAT50-ER32-6"	10"	6"		1.969"		M16*2P	4.60
CAT50-ER40-4"	8"	4"		2.480"		M20*2.5P	4.25
CAT50-ER40-6"	10"	6"		2.480"		M20*2.5P	4.80
CAT50-ER50-4"	8"	4"		3.070"		M24*3P	4.85

CAT 套式铣刀杆 CAT Shell End Mill Arbors

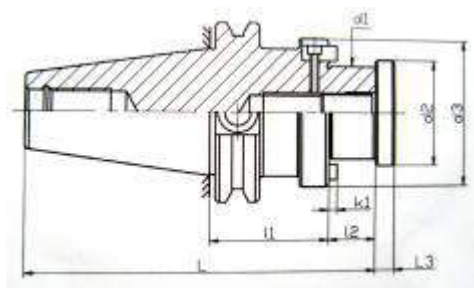

ANSI B5.50	20CrMnTi	≤0.005mm	≥12000rpm
------------	----------	----------	-----------

Model	L	L2	d1	d3
CAT40×FMB1"-1.75"	1.75"	17.5	1"	60
CAT40×FMB1.25"-2"	2"	17.5	1.25"	70
CAT40×FMB1.5"-2"	2"	23.8	1.5"	85
CAT50×FMB1.25"-4"	4"	17.5	1.25"	70
CAT50×FMB1.25"-6"	6"	17.5	1.25"	70
CAT50×FMB1.5"-4"	4"	23.8	1.5"	85
CAT50×FMB1.5"-6"	6"	23.8	1.5"	85
CAT50×FMB2"-2"	2"	24	2"	95
CAT50×FMB2"-4"	4"	24	2"	95
CAT50×FMB2"-6"	6"	24	2"	95

锁刀座 Tool Locking Devices



C45 +
Aluminum

Model	Taper of Tool Holders	Outer Size	Wt.
BT30	BT30	205×98.5×128	3.7
BT40	BT40	205×98.5×128	3.8
BT50	BT50	275×150×198	11.4

CAT 侧固式铣刀杆 CAT Side Lock End Mill Arbors

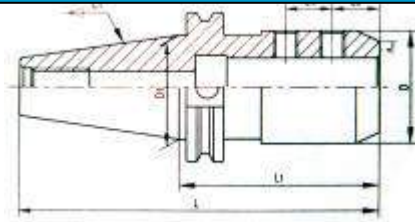

ANSI B5.50

Model	L1	D	d	l2	l3
CAT40×SL0.4"-2"	2"	1.4"	0.4"	0.8"	-
CAT40×SL0.475"-2"	2"	1.675"	0.475"	9"	-
CAT40×SL0.65"-2.5"	2.5"	1.925"	0.65"	1"	-
CAT40×SL0.8"-2.5"	2.5"	2.075"	0.8"	1"	-
CAT40×SL1"-4"	4"	2.625"	1"	1"	1"
CAT40×SL1.25"-4"	4"	2.85"	1.25"	1"	1.125"
CAT50×SL0.475"-2.5"	2.5"	1.675"	0.475"	9"	-
CAT50×SL0.65"-2.5"	2.5"	1.925"	0.65"	1"	-
CAT50×SL0.8"-2.5"	2.5"	2.075"	0.8"	1"	-
CAT50×SL1"-3.2"	3.2"	2.625"	1"	1"	1"
CAT50×SL1.25"-4"	4"	2.85"	1.25"	1"	1.125"
CAT50×SL1.6"-4.8"	4.8"	3.6"	1.6"	1.2"	1.275"
CAT50×SL2"-5.2"	5.2"	4"	2"	1.4"	1.4"

CAT 一体式钻夹头 CAT Integrated Drill Chucks

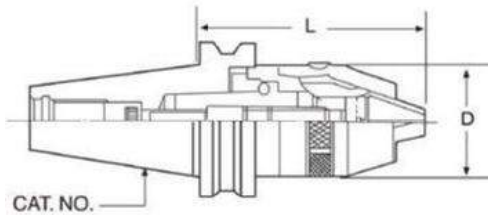

Model	Clamping Range		D		L			
	(Φmm)	(Φinch)	(mm)	(inch)	Minimum		Maximum	
					(mm)	(inch)	(mm)	(inch)
CAT40-APU08	1-8	1/32"-5/16"	36.3	1.429"	65	2.559"	76.5	3.011"
CAT40-APU13	1-13	1/32"-1/2"	51.5	2.028"	88	3.464"	99	3.697"
CAT40-APU16	3-16	3/32"-5/8"	58	2.283"	106	4.173"	120	4.724"
CAT50-APU08	1-8	1/32"-5/16"	36.3	1.429"	70	2.755"	77.5	3.051"
CAT50-APU13	1-13	1/32"-1/2"	51.5	2.028"	89	3.503"	100	3.937"
CAT50-APU16	3-16	3/32"-5/8"	58	2.283"	96	3.779"	110	4.330"

ER 筒夹

ER Collets

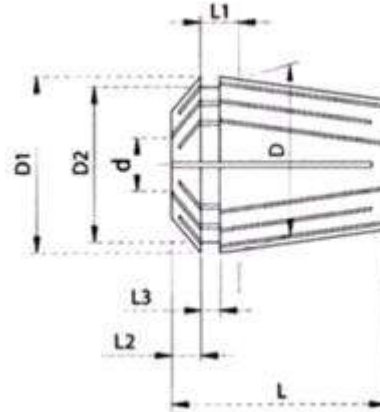

Material:65Mn
Hardness:HRC44-48

Run out
≤5u
≤8u
≤0.015mmm

Model	dH7	D	D1	D2	L	L1	L2	L3	Collapsible capacity
ER8	1.0-5.0	8	8.5	6.5	13.5	2.7	1.5	1.2	0.5
ER11	1.0-7.0	11	11.5	9.5	18.0	3.8	2.5	2.0	0.5
ER16	1.0-2.5	16	17	13.8	27.5	6.26	4.0	2.7	0.5
	2.5-10.0	16	17	13.8	27.5	6.26	4.0	2.7	1.0
ER20	1.0-2.5	20	21	17.4	31.5	6.36	4.8	2.8	0.5
	2.5-13.0	20	21	17.4	31.5	6.36	4.8	2.8	1.0
ER25	1.0-2.5	25	26	22.0	34.0	6.66	5.0	3.1	0.5
	2.5-16.0	25	26	22.0	34.0	6.66	5.0	3.1	1.0
ER32	2.0-2.5	32	33	29.2	40.0	7.16	5.5	3.6	0.5
	2.5-20.0	32	33	29.2	40.0	7.16	5.5	3.6	1.0
ER40	3.0-26.0	40	41	36.2	46.0	7.66	7.0	4.1	1.0
ER50	6.0-10.0	50	52	46.0	60.0	12.6	8.5	5.5	1.0
	10.0-34.0	50	52	46.0	60.0	12.6	8.5	5.5	2.0



型号 Model	规格 Types	
	公制 metric	英制 inch
ER8	1,1.5,2,2.5,3,3.5,4,4.5,5	1/32,3/64,1/16,5/64,3/32,7/64,1/8,9/64,5/32,11/64,3/16
ER11	1,1.5,2,2.5,3,3.5,4,4.5,5,5.5,6,6.5,7	1/32,3/64,1/16,5/64,3/32,7/64,1/8,9/64,5/32,11/64,3/16,13/64 7/32,15,64,1/4,17/64
ER16	1,1.5,2,2.5,3,3.5,4,4.5,5,5.5,6,6.5,7, 7.5,8,8.5,9,9.5,10	1/32,3/64,1/16,5/64,3/32,7/64,1/8,9/64,5/32,11/64,3/16,13/64, 7/32,15,64,1/4,17/64,9/32,19/64,5/16,21/64,11/32,23/64,3/8
ER20	1,1.5,2,2.5,3,3.5,4,4.5,5,5.5,6,6.5,7, 7.5,8,8.5,9,9.5,10,10.5,11,11.5,12, 12.5,13	1/32,3/64,1/16,5/64,3/32,7/64,1/8,9/64,5/32,11/64,3/16,13/64, 7/32,15,64,1/4,17/64,9/32,19/64,5/16,21/64,11/32,23/64,3/8, 25/64,13/32,27/64,7/16,29/64,15/32,31/64,1/2,33/64
ER25	1,1.5,2,2.5,3,3.5,4,4.5,5,5.5,6,6.5,7, 7.5,8,8.5,9,9.5,10,10.5,11,11.5,12, 12.5,13,13.5,14,14.5,15,15.5,16	3/64,1/16,5/64,3/32,7/64,1/8,9/64,5/32,11/64,3/16,13/64,7/32, 15,64,1/4,17/64,9/32,19/64,5/16,21/64,11/32,23/64,3/8,25/64, 13/32,27/64,7/16,29/64,15/32,31/64,1/2,33/64,17/32,35/64 9/16,37/64,19/32,39/64,5/8
ER32	1,1.5,2,2.5,3,4,5,6,7,8,9,10,11,12,13 14,15,16,17,18,19,20	1/16,3/32,1/8,5/32,3/16,7/32,1/4,9/32,5/64,11/32,3/8,13/32, 7/16,15/32,1/2,17/32,9/16,19/32,5/8,21/32,11/16,23/32,3/4,25/32
ER40	3,4,5,6,7,8,9,10,11,12,13,14,15,16, 17,18,19,20,21,22,23,24,25,26	1/8,5/32,3/16,7/32,1/4,9/32,5/16,11/32,3/8,13/32,7/16,15/32,1/2, 17/32,9/16,19/32,5/8,21/32,11/16,23/32,3/4,25/32,13/16,27/32, 7/8,29/32,15/16,31/32,1"
ER50	6,7,8,9,10,11,12,13,14,15,16,17,18, 19,20,21,22,23,24,25,26,27,28,29, 30,31,32,33,34	1/4,9/32,5/16,11/32,3/8,13/32,7/16,15/32,1/2,17/32,9/16,19/32, 5/8,21/32,11/16,23/32,3/4,25/32,13/16,27/32,7/8,29/32,15/16, 31/32,1",1-1/32,1-1/16,1-3/32,1-1/8,1-5/32,1-3/16,1-7/32,1-1/4, 1-9/32,1-5/16

All above sizes of various holes below 3mm are special ones with high costs. 内径 3mm 以下非常规成本

ER 套装 ER Collets Sets

ER8	9 PCS	1-5 mm(1,1.5,2,2.5,3,3.5,4,4.5,5mm)
ER11	5PCS	3-7mm(3;4;5;6;7mm) if 7PCS,includes 1&2mm
ER16	8PCS	3-10mm(3;4;5;6;7;8;9;10mm)
ER20	6PCS	3-13mm(3;4;6;8;10;13mm)
	11PCS	3-13mm(3;4;5;6;7;8;9;10;11;12;13mm)
ER25	7PCS	4-16mm(4;6;8;10;12;14;16mm)
	15PCS	2-16mm(2;3;4;5;6;7;8;9;10;11;12;13;14;15;16mm)
ER32	6PCS	6-20mm(6;8;10;12;16;20mm)
	11PCS	4-20mm(4;5;6;8;10;12;14;15;16;18;20mm)
	18PCS	3-20mm(3;4;5;6;7;8;9;10;11;12;13;14;15;16;17;18;19;20mm)
ER40	7PCS	6-25mm(6;8;10;12;16;20;25mm)
	15PCS	4-26mm(4;5;6;8;10;12;14;15;16;18;20;22;24;25;26mm)
	23PCS	4-26mm(4;5;6;7;8;9;10;11;12;13;14;15;16;17;18;19;20;21;22;23;24;25;26mm)
ER50	12PCS	10-34mm(10,12,14,16,18,20,22,24,26,28,30,32,34mm)

ER 夹持范围 The Clamping Capacity of ER Collets

ER8 (1-5mm)	ER11 (1-7mm)	ER16 (1-10mm)	ER20 (1-13mm)	ER25 (1-16mm)	ER32 (1-20mm)	ER40 (3-26mm)	ER50 (10-32mm)
1.0-0.5	1.0-0.5	1.0-0.5	1.0-0.5	1.0-0.5	2-1	3-2	12-10
1.5-1.0	1.5-1.0	1.5-1.0	1.5-1.0	1.5-1.0	3-2	4-3	14-12
2.0-1.5	2.0-1.5	2.0-1.5	2.0-1.5	2.0-1.5	4-3	5-4	16-14
2.5-2.0	2.5-2.0	2.5-2.0	2.5-2.0	2.5-2.0	5-4	6-5	18-16
3.0-2.5	3.0-2.5	3-2	3-2	3-2	6-5	7-6	20-18
3.5-3.0	3.5-3.0	4-3	4-3	4-3	7-6	8-7	22-20
4.0-3.5	4.0-3.5	5-4	5-4	5-4	8-7	9-8	24-22
4.5-4.0	4.5-4.0	6-5	6-5	6-5	9-8	10-9	26-24
5.0-4.5	5.0-4.5	7-6	7-6	7-6	10-9	11-10	28-26
	5.5-5.0	8-7	8-7	8-7	11-10	12-11	30-28
	6.0-5.5	9-8	9-8	9-8	12-11	13-12	32-30
	6.5-6.0	10-9	10-9	10-9	13-12	14-13	34-32
	7.0-6.5		11-10	11-10	14-13	15-14	
			12-11	12-11	15-14	16-15	
			13-12	13-12	16-15	17-16	
				14-13	17-16	18-17	
				15-14	18-17	19-18	
				16-15	19-18	20-19	
					20-19	21-20	
						22-21	
						23-22	
						24-23	
						25-24	
						26-25	



SK 筒夹 SK Collets

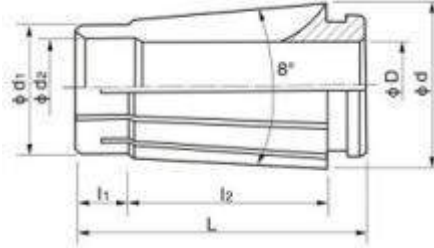

65Mn
HRC:44~48.
$\leq 0.005\text{mm}$



Size	Inside Diameter	d	d1	L	L1	L2
SK10	2, 2.5, 3, 3.5, 4, 4.5, 5, 5.5, 6, 6.5, 7, 7.5, 8, 8.5, 9, 9.5, 10, mm	15.5	12	30.5	5.1	21.3
SK16	3, 4, 4.5, 5, 5.5, 6, 6.5, 7, 7.5, 8, 8.5, 9, 9.5, 10, 10.5, 11, 11.5, 12, 12.5, 13, 13.5, 14, 14.5, 15, 15.5, 16, mm	24.5	18.8	45	7.5	32.4
SK20	7.5, 8, 9.5, 10, 11.5, 12, 15.5, 16, 16.5, 17, 17.5, 18, 18.5, 19, 19.5, 20, mm	29.1	22.6	54	8	40.7
SK25	7.5, 8, 9.5, 10, 11.5, 12, 15.5, 16, 16.5, 17, 17.5, 18, 18.5, 19, 19.5, 20, 20.5, 21, 21.5, 22, 22.5, 23, 23.5, 24, 24.5, 25, mm	35.7	28.9	57	8.4	43.1

EOC 筒夹 EOC Collets

EOCA=OZ



EOCA



EOCB

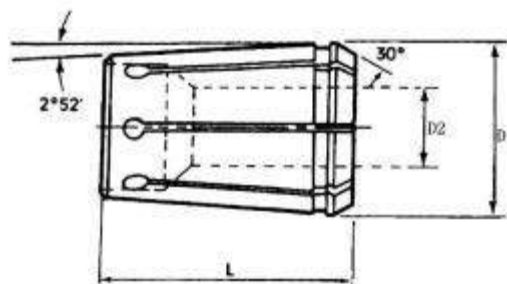

DIN6388
$\leq 0.015\text{mm}$
65Mn
Taper : 1:10

Model	D1	L	D2	
EOC25	35.5	52	Metric	3,4,5,6,7,8,9,10,11,12,13,14,15,16,17,18,19,20,21,22,23,24,25
			Inch	1/8", 3/16"; 1/4", 5/16", 3/8", 7/16", 1/2", 9/16", 5/8", 11/16", 3/4", 13/16", 7/8", 15/16", 1"
EOC32	44	60	Metric	6,7,8,9,10,11,12,13,14,15,16,17,18,19,20,21,22,23,24,25,26,27,28,29,30,31,32,
			Inch	1/4", 5/16", 3/8", 7/16", 1/2", 9/16", 5/8", 11/16", 3/4", 13/16", 7/8", 15/16", 1"; 1-1/8"; 1-1/4"

直柄筒夹 Straight Collets

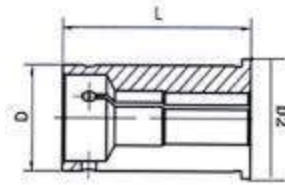

65Mn
HRC:44~48
≤0.01mm

Size	Inside Diameter	D	D2	L
C20	3,4,5,6,8,10,12,16mm	20	25	52
C25	3,4,5,6,8,10,12,16,18,20mm	25	31	60
C32	3,4,5,6,8,10,12,16,18,22,24,20,25mm	32	37	73
C42	3,4,5,6,8,10,12,16,18,20,22,24,25,28,30,32mm	42	48	80

刀库导套 Tool Holder Sleeve

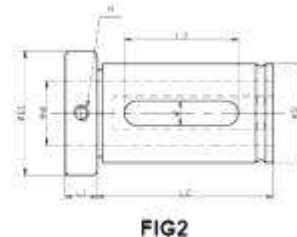
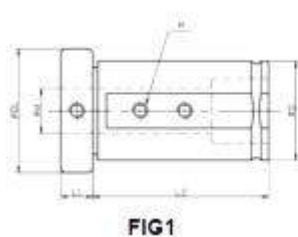

用途：用于数控加工中心（转塔）刀架加持刀具。

Function: Suitable to hold cylindrical shank tools on turret at CNC lathe.

Model	D	D1	L1	L2	L3	W	M	Fig
D40 (7PCS)	8; 10; 12; 16; 20	46.5	15	80			M8	1
	25; 32	46.5	15	80	65	12		2
D32 (6PCS)	8; 10; 12; 16	39	14	70			M8	1
	20; 25	39	14	70	58	10		2
D25 (4PCS)	8; 10; 12	33	14	50			M8	1
	16	33	14	50	42	10		2
D20 (3PCS)	8; 10	28	12	50			M8	1
	12	28	12	50	42	8		2
D16 (2PCS)	8	24	10	40			M8	1
	10	24	10	40	34	6		2

Edge Finders

光电寻边器 Edge Finders with Sound & Lamp



Model	D(mm)	L(mm)	D(mm)	Wt.
ES-20	20	160	10	0.28

机械寻边器 Machine Edge Finders



Model	D(mm)	L1	Fig
PM10-A	10	90	1
PM10-B	10	83	2

Z-Axis Scale Zero Setters

量表式 z 轴设定仪(磁性) Z-Axis Scale Zero Setters with Magnetic



Model	Pattern	Gross Attitude
ZDI-50A	Volume-adjusting	50

Features:

1. Used in the computer milling machine/lathe for the tool length.
2. Height: 50.00±0.01mm
3. Large measuring surface. Easy to use
4. Low force spring, avoiding the fracture of small cutter and drill.
5. Easy to be calibrated by a grade parallel or gauge block
6. Better parallelism, sensitivity, and precision for use.

光电式 z 轴设定仪 Z-Axis Scale Zero Setters with Electro-optic



Model	Pattern	Gross Attitude
ZOP-50	Volume-adjusting	50

Features:

1. Height: 50mm.
2. With magnetic base.
3. The red lamp will be lighted up when touched.
4. Accuracy: 0.005mm.
5. Combined vertical and horizontal in a unit.
6. Weight: 0.5kgs.

ER 螺帽 ER Nuts

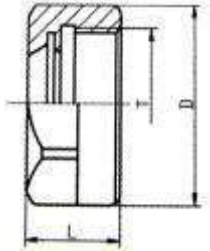

A Hexagonal 六角型

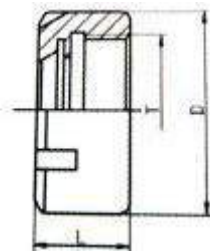

M Mini. 迷你型

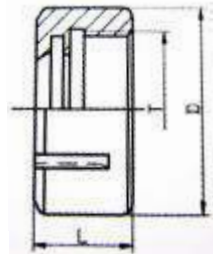

UM Standard 标准型

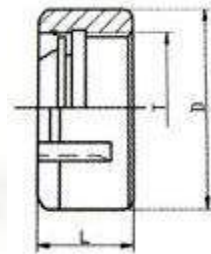

EOC With Bearings 强力型 (EOC only)

42CrMo	HRC48-52	DIN6499-D/E	≤0.005mm
--------	----------	-------------	----------

Type	Model	D	L	T	Wt.
A	ER11	19	11.3	M14×0.75P	0.02
	ER16	28	17.5	M22×1.5P	0.05
	ER20	34	19	M25×1.5P	0.10
M	ER8	12	10.8	M10×0.75P	0.005
	ER11	16	12	M13×1.75P	0.01
	ER16	22	18	M19×1.0P	0.05
	ER20	28	19	M24×1.0P	0.05
	ER25	35	20	M30×1.0P	0.08
UM	ER25	42	20	M32×1.5P	0.14
	ER32	50	22.5	M40×1.5P	0.20
	ER40	63	25.5	M50×1.5P	0.30
	ER50	78	35.5	M64×2.0P	0.50
EOC	EOC20	50	28	M42×2.0P	0.13
	EOC25	60	30	M48×2.0P	0.28
	EOC32	72	33.5	M68×2.5P	0.50
	EOC40	100	43	M80×2.5P	0.72

ER 扳手 ER Wrenches

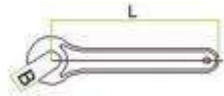

Model	B	L	Clampig Nut	Model	B	L	Clamping Nut
WA-40	40	120	ER11-A	WM-13	13	75	ER8-M
WA-53	53	140	ER16-A	WM-17	17	95	ER11-M
WA-60	60	160	ER20-A	WM-22.5	22.5	117	ER16-M
				WM-28.5	28.5	129	ER20-M

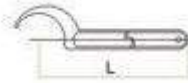

Model	B	L	Clamping Nut	Model	B	L	ClampingNut
WTG-42	38-42	168	ER25	WUK-37	37	210	ER25
WTG-52	45-52	190	ER32	WUK-45	45	250	ER32
WTG-63	55-63	210	ER40	WUK-58	58	290	ER40
WTG-85	78-85	240	ER50	WUK-72	72	350	ER50

拉钉 Pull Studs

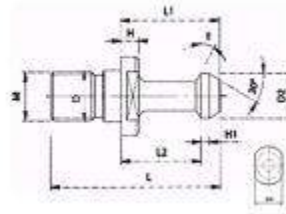

HRC48
40CrMo
MAS403

Model	D	M	L	H	H1	Φ
BT30	12.5	M12	43	5	2.5	45°/60°/90°
BT40	17	M16	60	6	3	45°/60°/90°
BT50	25	M24	85	10	5	45°/60°/90°

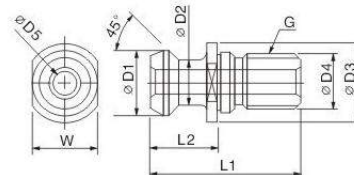

Model	L1	L2	D1	D2	D3	D4	D5	W	G
MAZAK-BT40	44.1	19.1	18.8	12.45	22	17	7	19	M16
MAZAK-BT50	65.2	25.2	29	20.83	37	25	10	30	M24

F1 型粗镗头与镗刀 F1 Rough Boring Heads

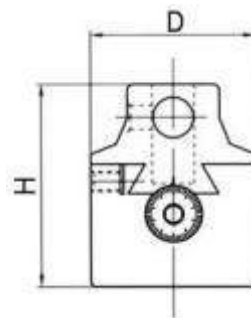

Model	D	H	Max Offset	Boring Bar Dia.	Min Graduation	Dia. of Boring
F1-2"	2"	2-7/16"	5/8"	1/2"	0.01mm	3/8"-5"
F1-3"	3"	3-5/32"	1"	3/4"	0.01mm	1/2"-9"
F1-4"	4"	3-1/2"	1-5/8"	1"	0.01mm	5/8"- 25"
F1-12mm	50	63	16mm	12mm	0.01mm	10-125mm
F1-18mm	75	80	25mm	18mm	0.01mm	12-225mm
F1-25mm	100	88	41mm	25mm	0.01mm	15-630mm

F1 型 镗刀 F1 Rough Boring Cutters



9PCS for 12mm



12PCS for 18mm



6PCS for 25mm

Metric			Inch		Qty. of Boring Cutters	Bar Thread
Dia. of Boring Holes	Dia. of Boring Heads	Boring Capacity	Dia. of Boring Holes	Dia. of Boring Heads		
F1--12 mm	50mm	10-125mm	F1-2"	1/2"	9PCS	7/8-20 1-1/2-18
F1-- 18mm	75mm	12-225mm	F1- 3"	3/4"	12PCS	1-1/2-18
F1--25mm	100mm	15-320mm	F1- 4"	1"	6PCS	1-1/2-18

F1 Rough Boring Heads

F1 型镗头连接柄

F1 Rough Boring Heads Shanks



Model	T	L	Wt.
BT40	M16×2.0P	102	1.24
BT50	M24×3.0P	134	3.97
NT30	1/2×UNC	102	0.6
NT30	M12×1.75P	102	0.6
NT40	5/8×UNC	135	1.2
NT40	M16×2.0P	135	1.2
NT50	1"×8UNC	168	3.14
NT50	M24×3.0P	168	3.14
MT2	3/8×16UNC	93	0.4
MT2	M10×1.5P	108	0.4
MT3	3/8×16UNC	110	0.44
MT3	1/2×13UNC	110	0.44
MT3	1/2×12UNC	110	0.44
MT3	M12×1.75P	128	0.44
MT4	5/8"×11UNC	133	0.95
MT4	M16×2.0P	154	0.95
MT5	1"×8UNC	160	1.7
MT5	M24×3.0P	185	1.7
R8	7/16×20UNF	132.5	0.6

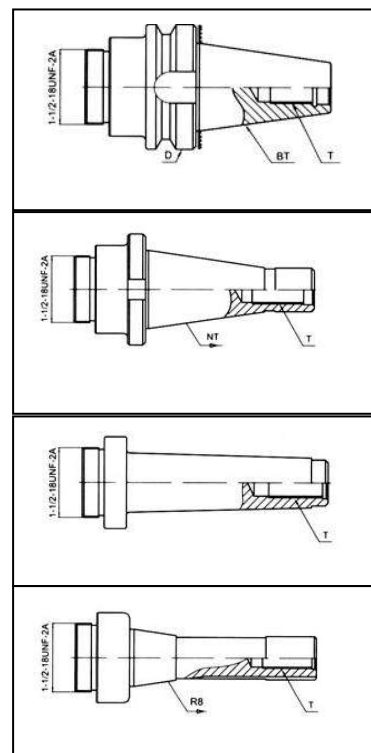

*Please state the detailed size when ordering; e.g.: F1- R8-18mm



NBH 微调精镗头 NBH2084 组件

NBH2084 Micro Boring

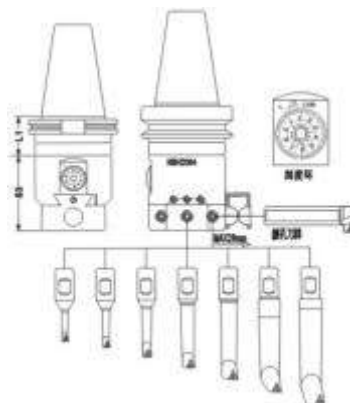

型号	镗孔范围	调整精度	调整行程	重量(KG)
NBH2084	8-280mm	0.01mm / 格	28.0mm	3.0

镗孔刀片	范围	深度 BM	镗刀片	螺丝	扳手	重量(KG)
BJ2208-32	8-11	32	TBGT060102L	SB-1STR-M2	T6	0.095
BJ2010-40	10-13	40				0.095
BJ2012-53	12-17	53	TBGH090202L	SB-2STR-M2.5	T8	0.12
BJ2016-68	16-21	68				0.16
BJ2020-83	20-130	83	TPGH110302L	SB-3STR-M3	T8	0.22
BJ2025-96	25-135	96				0.34
BJ2030-115	30-140	115				0.54
BJ20-20	120-280	84+BT bar				0.23

NBH 微调精镗头 NBH2084 套装

NBH2084 Micro Boring Head Sets

Model	Boring Range	Type	Wt.
BT30-NBH2084-8PCS	08-280	M12×1.75P	8.0
BT40-NBH2084-8PCS	08-280	M16×2.0P	9.5
BT50-NBH2084-8PCS	08-280	M24×3.0P	12.0
R8-NBH2084-8PCS	08-280	7/16"-20UNC	10.0
NT30-NBH2084-8PCS	08-280	M12×1.75P	8.0
NT40-NBH2084-8PCS	08-280	M16×2.0P	9.5
NT50-NBH2084-8PCS	08-280	M24×3.0P	10.8
MT3-NBH2084-8PCS	08-280	TANG	7.8
MT4-NBH2084-8PCS	08-280	TANG	10.3
MT5-NBH2084-8PCS	08-280	TANG	10..8

微调精镗头 NBJ16 组件

NBJ16 Micro Boring

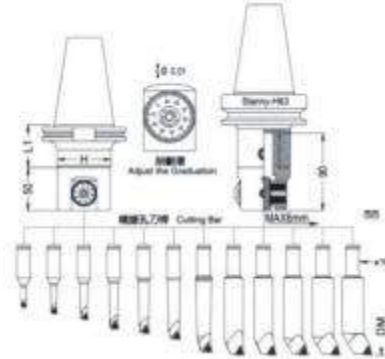

型号	镗孔范围	调整精度	调整行程	重量(KG)
NBJ16	6-51mm	0.01mm / 格	6.0mm	1.20

镗孔刀片	范围	深度 BM	镗刀片	螺丝	扳手	重量(KG)
BJ1606-24	6-9	24	WBGT0601-L	SB-1STR-M2	T6	0.08
BJ1608-32	8-11	32	TBGT0601-L			0.08
BJ1610-40	10-13	40				0.08
BJ1612-53	12-15	53	TBGH0902-L	SB-2TR-M2.5	T8	0.10
BJ1614-60	14-17	60				0.10
BJ1616-68	16-21	68				0.12
BJ1620-83	20-26	83	TPGH1103-L	SB-3TR-M3	T8	0.20
BJ1625-90	25-31	90				0.30
BJ1630-90	30-36	90				0.32
BJ1635-90	35-41	90				0.32
BJ1640-90	40-46	90				0.38
BJ1645-90	45-51	90				0.38

微调精镗头 NBJ16 套装

NBJ16 Micro Boring Head Sets

Model	Boring Range	组合系统+主轴柄规格	L1	重量 (KG)
BT30-NBJ16	6-51	MAS403 BT30-H63-55	55	9.1
BT40-NBJ16		MAS403 BT40-H63-65	65	11.7
BT50-NBJ16		MAS403 BT50-H63-85	85	12.2
NT40-NBJ16		DIN2080 ISO40-H63-55	55	9.3
NT50-NBJ16		DIN2080 ISO50-H63-55	65	11.2

RBH 可调式双刃粗镗头

RBH Indexable Twin-bit Rough Boring Heads

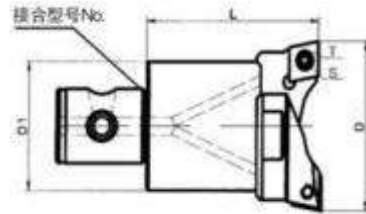

Model	Boring Range	D	L	HCK No.	Insert	Screw	Wrench	
RBH25-35LA-C	25--35	24	50	HCK2	CC..0602	M2.5 - 6.0	T8	
RBH32-45LA-C	32--45	31	60	HCK3		- 3.5		
RBH32-45LA-T					TC..1102	- 6.0		
RBH40-55LA-C	40--55	39	74	HCK4	CC..09T3	M4-10-5.7-60	T15	
RBH40-55LA-T					TC..16T3	M4-10-5.0-43		
RBH52-75LA-C	52--75	50	80	HCK5	CC..09T3	M4-10-5.7-60		
RBH52-75LA-T					TC..16T3	M4-10-5.0-43		
RBH68-100LA-C	68--100	66	90	HCK6	CC..1204	M5-11-7.0-5.5		T20
RBH68-100LA-T					TC..16T3	M4-10-5.0-4.3		T15
RBH90-130LA-C	90--130	88	100		CC..1204	M5-11-7.0-5.5	T20	
RBH90-130LA-T					TC..16T3	M4-10-5.0-4.3	T15	
RBH120-164LA-C	120--164	100	95	BST series	CC..1204	M5-11-7.0-5.5	T20	
RBH120-164LA-T					TC..2204			
RBH160-164LA-C	160--204	130			CC..1204			
RBH160-164LA-T					TC..2204			

※ RBH120 = RBH120LA; RBH160 = RBH160LA .

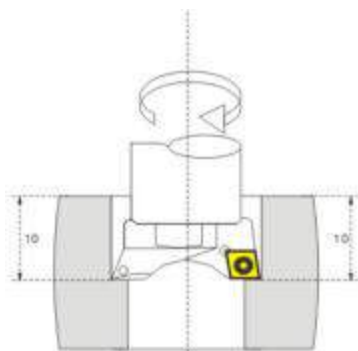

双刃等高加工

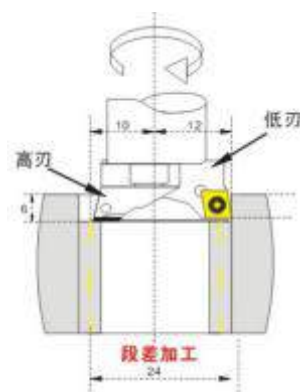

CBA Micro Boring Heads

CBA 微调精镗刀

CBA Micro Finish Boring Heads

CBA=CBH

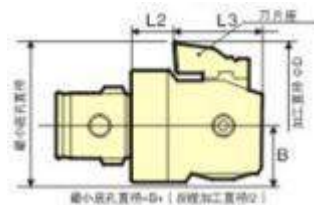
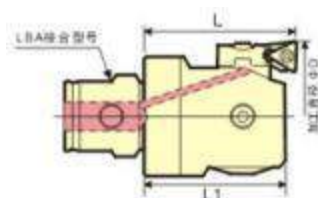

Model	Insert seat	Sck. No.	Internal Boring			External Boring				Insert/ Screw/ Wrench
			Range	L	L1	Range	L2	L3	B	
CBA20 (20-36)	ENH1-1	LBA1	20-26	35	32	-	10.5	19	10	TP08
	ENH1-2		25-31			30-31				
	ENH1-3		30-36			30-36				
CBA25 (25-47)	ENH2-1	LBA2	25-33	40	37	-	11.5	21	12.5	TP08
	ENH2-2		32-40			36-40				
	ENH2-3		39-47			39-47				
CBA32 (32-60)	ENH3-1	LBA3	32-42	40	37	-	10	25	16	TP08
	ENH3-2		41-51			46-51				
	ENH3-3		50-60			50-60				
CBA40 (40-79)	ENH4-1	LBA4	40-55	50	47	-	14	29	20	TC11
	ENH4-2		61-65			53-63				
	ENH4-3		64-79			64-79				
CBA52 (52-112)	ENH5-1	LBA5	52-75	60	56	62-70	19	34	25.5	TC11
	ENH5-2		70-93			65-82				TC11
	ENH5-3		89-112			78-95				TC11
CBA68 (68-150)	ENH6-1	LBA6	68-100	70	66	80-100	22	45.2	32.5	TC11
	ENH6-2		94-125			94-126				TC11
	ENH6-3		118-150			118-150				TC11
CBA100 (100-203)	ENH6-1	LBA6	100-153	70	66	112-153	22	45.2	45.5	TC11
	ENH6-2		126-179			126-179				TC11
	ENH6-3		150-203			150-203				TC11
CBA150 (150-210)		LBA6/ BST	150-210	70	66	150-203	38	45.2	45.5	TC11

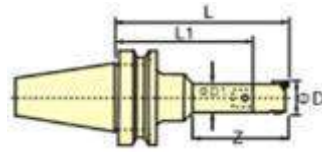

Fig1

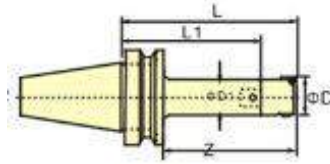

Fig2

MAS403
20CrMnTi

Combination		Height Z	Range Ø D	Fig.	L	L1	Ø D1	Wt.
LBA Shanks	CBA Head							
BT30-LBA1-70	CBA20	75	20-26-36	2	105	70	19	0.6
BT30-LBA2-80	CBA25	90	25-33-47		120	80	24	0.8
BT30-LBA3-80	CBA32		31				1.0	
BT30-LBA4-70	CBA40		39				1.3	
BT30-LBA5-60	CBA52		50				1.8	
BT30-LBA6-60	CBA68	100	68-102-150		130	60	64	3.0
BT40-LBA1-75	CBA20	75	20-26-36	2	110	75	19	1.1
BT40-LBA1-105		105			140	105		1.3
BT40-LBA2-85	CBA25	90	25-33-47		125	85	24	1.3
BT40-LBA2-115		120			155	115		1.6
BT40-LBA3-95	CBA32	100	32-42-60		135	95	31	1.5
BT40-LBA3-125		130			165	125		1.8
BT40-LBA3-155		160			195	155		2.0
BT40-LBA4-85	CBA40	100	40-55-79		135	85	39	1.8
BT40-LBA4-130		145			180	130		2.4
BT40-LBA4-175		190			225	175		2.7
BT40-LBA5-75	CBA52	100	52-75-112		135	75	50	2.3
BT40-LBA5-125		150			185	125		3.3
BT40-LBA5-175		200			235	175		4.0
BT40-LBA6-65	CBA68	100	68-102-150		135	65	64	3.3
BT40-LBA6-115		150			185	115		4.7
BT40-LBA6-165		200			235	165		5.9
BT40-LBA6-65	CBA100	100	100-152-203		135	65	64	4.2
BT40-LBA6-115		150			185	115		5.6
BT40-LBA6-165		200			235	165		6.8
BT40-LBA6-65	CBA150	100	150-202		135	65	64	5.5
BT40-LBA6-115		150			185	115		6.9
BT40-LBA6-165		200			235	165		8.1

Combination		Height Z	Range Ø D	Fig.	L	L1	Ø D1	Wt.
LBA Shanks	CBA Head							
BT50-LBA1-115	CBA20	75	20-26-36	1	150	115	31/19	4.1
BT50-LBA1-145		105			180	145		4.2
BT50-LBA2-110	CBA25	105	25-33-47		150	110	24	4.1
BT50-LBA2-140		135			180	140		4.2
BT50-LBA3-125	CBA32	120	32-42-60		165	125	31	4.4
BT50-LBA3-155		150			195	155		4.5
BT50-LBA4-115	CBA40	120	40-55-79		165	115	39	4.8
BT50-LBA4-145		150			195	145		4.9
BT50-LBA4-175		180			225	175		5.3
BT50-LBA4-205		210			225	205		5.4
BT50-LBA5-105	CBA52	120	52-75-112		165	105	50	5.5
BT50-LBA5-180		195			240	180		6.5
BT50-LBA5-240		255			300	240		7.2
BT50-LBA5-300		255			360	300		8.6
BT50-LBA6-95	CBA68	120	68-102-150		165	95	64/50	6.5
BT50-LBA6-170		195			240	170		8.3
BT50-LBA6-230		255		300	230	9.6		
BT50-LBA6-290		315		360	290	11.0		
BT50-LBA6-350		375		420	350	15.5		
BT50-LBA6-350		375		420	350	90/64	13.2	



90°直角台肩壳型铣刀盘

90° Right Angle Shoulder Face Mills



Cat.NO	Size(mm)						Circular Cushin	Applicable inserts	Clamp screw	Wrench
	D	C	H	W	T	a				
TAP400R-50-22-4T	50	22	50	10.4	6.3	14	-	APMT 1604 PDER	M4×10	T15
TAP400R-63-22-4T	63	22	50	10.4	6.3	14	-			
TAP400R-80-27-6T	80	27	50	12.4	7	14	-			
TAP400R-100-32-6T	100	32	50	14.4	8	14	FMB-32-SHIM			
TAP400R-125-40-6T	125	40	63	14.4	8	14	FMB-40-SHIM			
TAP400R-160-40-9T	160	40	63	14.4	8	14	FMB-40-SHIM			
TAP400R-200-60-12T	200	60	63	25.7	14	14				
TAP400R-250-60-12T	250	60	63	25.7	14	14				

KM-45° 壳型铣刀盘

KM-45° Face Mills

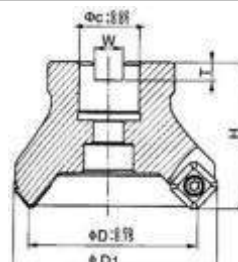

Model	Size(mm)					Circular Cushin	Applicable inserts	Clamp screw	Wrench
	D	C	H	W	T				
KM12 - 50-22-4T	50	22	50	10.4	6.3	-	SEKT1204	A501105D M5×11	T20F T20
KM12 - 63-22-4T	63	22	50	10.4	6.3	-			
KM12 - 80-27-5T	80	27	50	12.4	7	-			
KM12-100-32-5T	100	32	50	14.4	8	FMB-32-SHIM			
KM12-125-40-6T	125	40	63	16.4	9	FMB-40-SHIM			
KM12-160-40-9T	160	40	63	16.4	9	FMB-40-SHIM			

RAP-75° 壳型铣刀盘

RAP-75° Face Mills

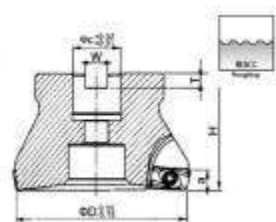

Cat.NO	Size(mm)						Circular Cushin	Applicable inserts	Clamp screw	Wrench
	D	C	H	W	T	a				
RAP400R-50-22-4T	50	22	45	8.5	5	8	-	APMT 1604 PDER	M4×10	T15
RAP400R-63-22-4T	63	22	50	10.4	6.3	8	-			
RAP400R-80-27-5T	80	27	50	12.4	7	8	-			
RAP400R-100-32-6T	100	32	50	14.4	8	8	FMB-32-SHIM			
RAP400R-125-40-6T	125	40	63	16.4	9	8	FMB-40-SHIM			
RAP400R-160-40-6T	160	40	63	16.4	9	8	FMB-40-SHIM			
RAP400R-200-60-9T	200	60	63	25.7	14	8	-			

EMR 通用型圆鼻铣刀盘

EMR Round Dowel Face Mills

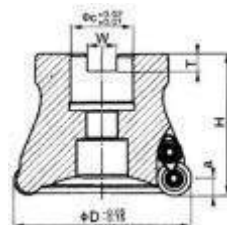

Cat. NO	Size(mm)						Circular Cushin	Applicable inserts	Clamp piece	Clamp screw	Wrench
	D	c	H	W	T	a					
EMR-5R-50-22-4T	50	22	50	10.4	6.3	5	-	PRMW 1003 MO PRMW 10T3 MOE	A-5R	M4×10	T15
EMR-5R-63-22-4T	63	22	50	10.4	6.3	5	-				
EMR-5R-80-27-6T	80	27	50	12.4	7	5	FMB-32-SHIM				
EMR-5R-100-32-6T	100	32	50	14.4	8	5					
EMR-6R-50-22-4T	50	22	50	10.4	6.3	6	-	PRMW 1204 MO PRMW 1204 MO	A-6R	M4×10	T15
EMR-6R-63-22-4T	63	22	50	10.4	6.3	6	-				
EMR-6R-80-27-6T	80	27	50	12.4	7	6	-				
EMR-6R-100-32-6T	100	32	50	14.4	8	6	FMB-32-SHIM				
EMR-6R-125-40-6T	125	40	63	16.4	9	6	FMB-40-SHIM				

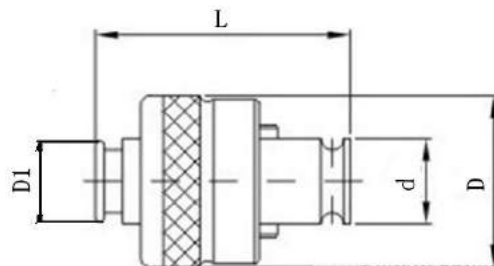

MODEL	Capacity	d	D	D1(ISO)	W(ISO)	L	Model	
GT12	-3	M3	19	38	3.15	2.5	54	7PCS (M3-M12)
	-4	M4			4	3		
	-5	M5			5	4		
	-6	M6			6.3	5		
	-8	M8			6.3	5		
	-10	M10			8	6.3		
	-12	M12			9	7.1		
GT24	-12	M12	30	58	9	7.1	79.5	7PCS (M12-M24)
	-14	M14			11.2	9		
	-16	M16			12.5	10		
	-18	M18			14	11.2		
	-20	M20			14	11.2		
	-22	M22			16	12.5		
	-24	M24			18	14.05		
GT42	-24	M24	45	85	18	14.05	117	7PCS (M24-M42)
	-27	M27			20	16.05		
	-30	M30			20	16.05		
	-33	M33			22.4	18.05		
	-36	M36			25	20.05		
	-39	M39			28	22.45		
	-42	M42			28	22.45		

*With Function of over-loading protection. 带过载保护功能。

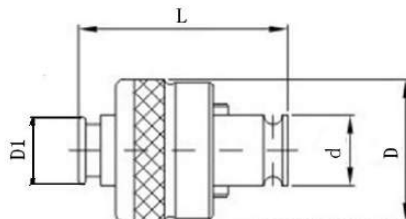

MODEL	Capacity	d	D	D1(JIS)	W(JIS)	L	Model	
GT12	-3	M3	19	38	4	3.2	54	7PCS (M3-M12)
	-4	M4			5	4		
	-5	M5			5.5	4.5		
	-6	M6			6	4.5		
	-8	M8			6.2	5		
	-10	M10			7	5.5		
	-12	M12			8.5	6.5		
GT24	-12	M12	30	58	8.5	6.5	79.5	7PCS (M12-M24)
	-14	M14			10.5	8		
	-16	M16			12.5	10		
	-18	M18			14	11		
	-20	M20			15	12		
	-22	M22			17	13		
	-24	M24			19	15		
GT42	-24	M24	45	85	19	15	117	7PCS (M24-M42)
	-27	M27			21	17		
	-30	M30			23	17		
	-33	M33			-	-		
	-36	M36			-	-		
	-39	M39			-	-		
	-42	M42			-	-		

**With Function of over-loading protection. 带过载保护功能。



攻丝夹头套装 Tapping Collets Chuck Sets



Model	Sizes of Collets	
MT 3 / 4 / 5 -- GT12 -- 7PCS	GT12	M3, M4, M5, M6, M8, M10, M12
NT30 / 40 / 50 -- GT12 -- 7PCS		
BT 30 / 40 / 50 -- GT12 -- 7PCS		
MT 3 / 4 / 5 -- GT24 -- 7PCS	GT24	M12, M14, M16, M18, M20, M22, M24
NT 30 / 40 / 50 -- GT24 -- 7PCS		
BT 40 / 50 -- GT24 -- 7PCS		
MT 3 / 4 / 5 -- GT42 -- 7PCS	GT42	M24, M27, M30, M33, M36, M39, M42
NT 30 / 40 / 50 -- GT42 -- 7PCS		
BT40 / 50 -- GT42 -- 7PCS		

Please state the detailed size when ordering. e.g.: **BT40-GT24 / 7PCS.**



J4012 型快换夹头 J4012 Type Quick Change Chucks



Model	Mount	
J4012	B16	M3、M4、M5、M6-M8、M10、M12
J4016	B18	M5、M6-M8、M10、M12、M14、M16

Other Accessories 其它附件



新款数控回转顶尖 New Type Live Centers for CNC

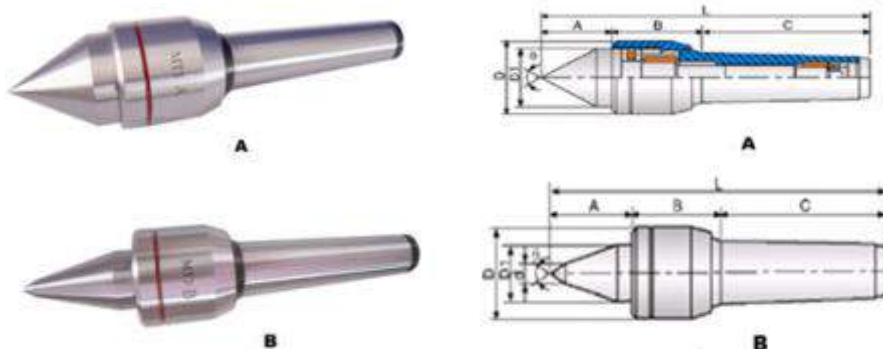

Model	A	B	C	D	d	L	Max speed
MT2A	28	35	69	32	-	132	5000
MT3A	36	44	86	41	-	166	3500
MT4A	41	51	108	47	-	200	3000
MT5A	54	72	136	65	-	262	2000
MT3B	46	44	86	41	10	176	3500
MT4B	55	51	108	47	12	2214	3000

高速防水回转顶尖 High Speed Live Centers with water proof

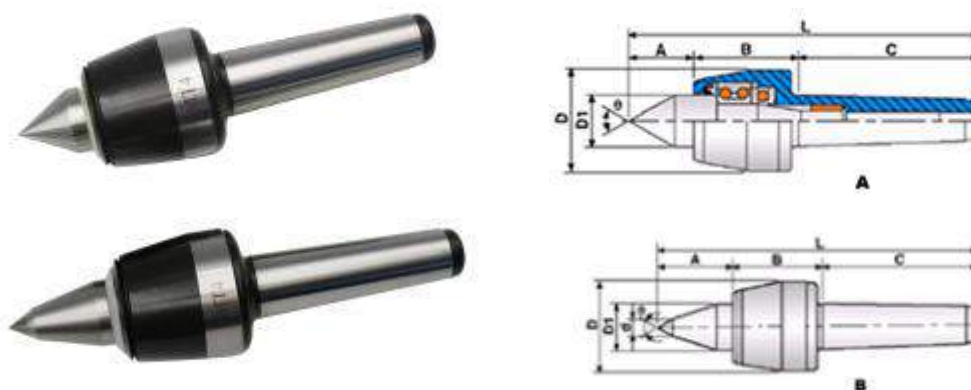

Model	A	B	C	D	D1	L	Max speed
MT3A	39	55	86	53	30	180	5000
MT4A	42	62	108	63	32	208	4500
MT5A	49	71	136	83	40	256	3500
MT3B	45	55	86	53	30	186	5000
MT4B	52	62	108	63	32	218	4500
MT5B	59	71	136	83	40	266	3500

*With bearings of SKF brand from Sweden.

高精数控回转顶尖 CNC Live Centers with High Speed & Accuracy

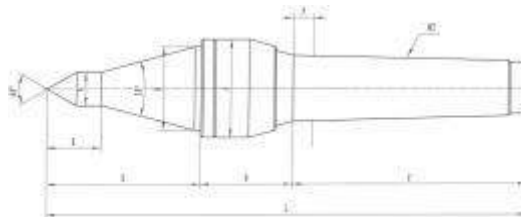

Model	A	B	C	D	E	F	G	K	L	Max speed	Max Run Out
MT2	27.7	23.8	69	28	42	4.5	10	14	139	3000	0.003
MT3	34	28	85	32	50	5	10	14	167	3000	0.003
MT4	45	40	108	48	80	6	12.5	24	236	3000	0.003
MT5	62	54	136	54	110	8	12.5	24	300	2000	0.003

重型回转顶尖 Heavy Duty Live Centers

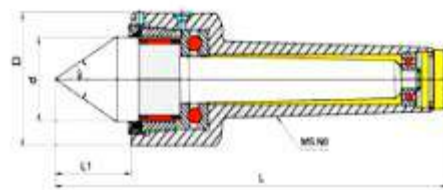

Model	D	d	L	L1	Max load	Max speed
MT4	55	35	194	37.5	1300	3500
MT5	70	45	240	47	2000	3500
MT6	90	60	318	62	4000	6000

中型回转顶尖 Medium Duty Live Centers

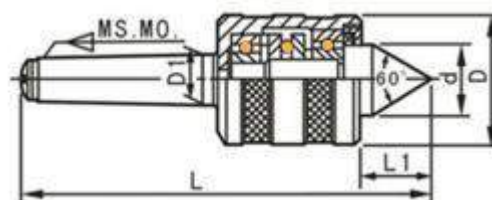

Model	MS.NO	L	L1	D	D1	Wt .
MT3	3	170	30	52	23.825	0.93
MT4	4	205.7	34.7	60	31.267	1.70
MT5	5	254	45	77	44.399	3.39

镶合金回转顶尖

Carbide Tipped Live Centers

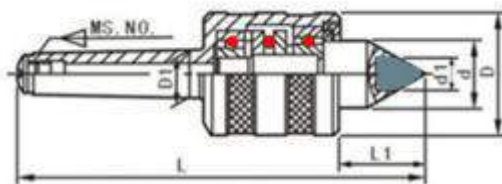

Model	L	L1	D	d	D1	d1	Max speed
MT3	170	30	52	28	23.825	15	4200
MT4	205.7	34.7	60	32	31.267	18	3200
MT5	254	45	77	45	44.399	24	2000
MT6	362	68.5	125	75	63.348	40	1600

加长型回转顶尖

Live Centers with Extension Tip

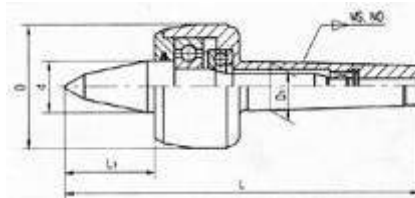

Model	L	D	L1	d	D1	Max Speed
MT3	176.5	60	47	25	23.825	5000
MT4	217	70	53	32	31.267	3800
MT5	273	90	65	40	44.399	3000

伞型回转顶尖

Bull Nose Live Centers

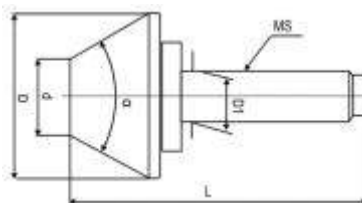

Model	D	D1	L	d	α
MT2 × 60	60	17.780	137	20	60°
MT3 × 90	90	23.825	169	32	60°
MT4 × 110	110	31.267	184	35	75°
MT5 × 120	120	44.399	251	40	60°
MT5 × 200	200	44.399	252	40	75°
MT6 × 250	250	63.348	335	56	75°

阴性顶尖 Live Center with 60°concave hole

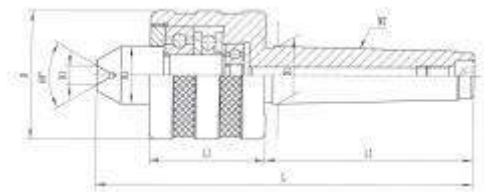

Model	L	L1	L2	D	D1	D2	D3
MT3	156	86	48	52	23.825	24	7
MT4	191	109	58	58	31.267	27	8

插入式回转顶尖 Multi-purpose Live Centers for Wood-working Machines

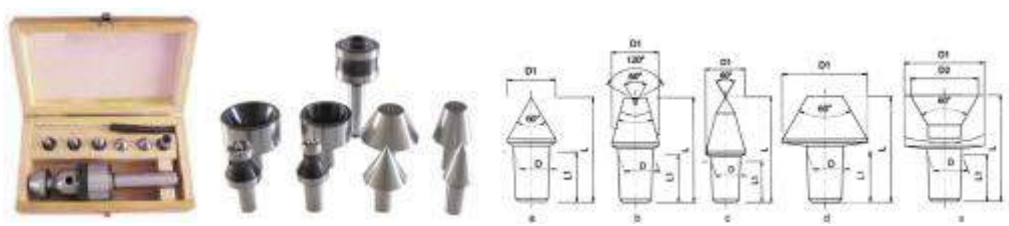

MT.NO	D	L1	a	b	c	d	e	
			D1				D1	D2
MT2	10	14	20	15	20	35	16	6
MT3	12	18	24	18	24	45	22	10

木工顶尖 Live Centers for Wood-working Machines

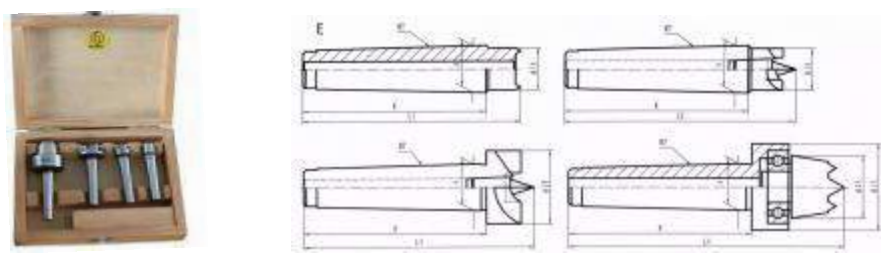

Model	L1	L2	L3	L4	A	B
MT1	69	74	74	91	12.065	56
MT2	82	87	87	104	17.78	69

木工顶尖 Live Centers for Wood-working Machines

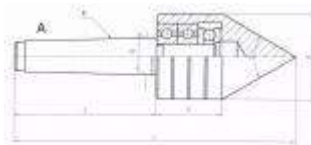

Model	L	A	B	C	D
MT1	136	17.78	42	69	32
MT2	160	23.825	46	86	34

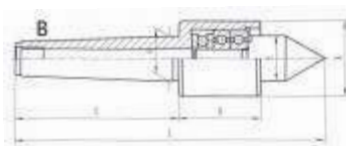

Model	L	A	B	C	D
MT1	146	17.78	40	69	43
MT2	163	23.825	40	86	43

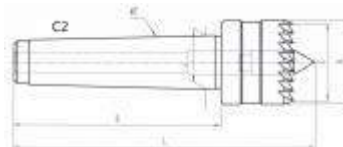

Model	L	A	B	C	D
MT1	87	12.065	22	19.05	56
MT2	100	17.78	28	25.4	69

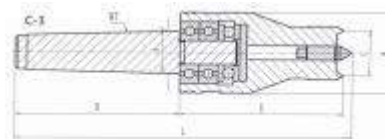

Model	L	A	B	C	D
MT1	152	17.78	48	22	69
MT2	173	23.825	58	24	86

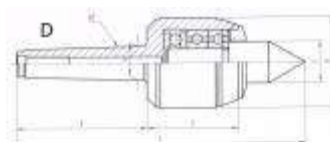

Model	L	A	B	C	D
MT1	128	12.065	34	19.05	56
MT2	141	17.78	34	19.05	69

固定顶尖 Dead Center

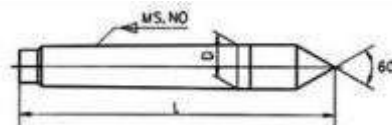

Model	D	L	Wt.	Model	D	L	Wt.
MT2	17.780	100	0.150	MT4	31.267	160	0.746
MT3	23.825	125	0.335	MT5	44.399	200	1.826

硬质合金固定顶尖 Carbide Dead Centers

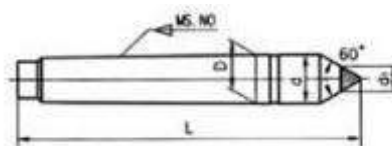

Model	D	L	Wt.	Model	D	L	Wt.
MT2	17.780	100	0.143	MT4	31.267	160	0.703
MT3	23.825	125	0.323	MT5	44.399	200	1.826

半缺固定顶尖 Half-notched Dead Centers

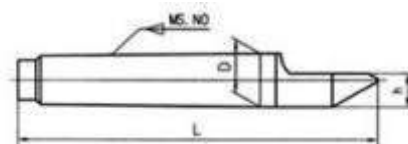

Model	D	L	Wt.	Model	D	L	Wt.
MT2	17.780	100	0.150	MT4	31.267	160	0.746
MT3	23.825	125	0.334	MT5	44.399	200	1.826

半缺硬质合金固定顶尖 Half-notched Carbide Dead Centers

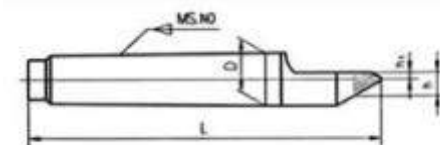

Model	D	L	Wt.	Model	D	L	Wt.
MT2	17.780	100	0.15	MT4	31.267	160	0.71
MT3	23.825	125	0.34	MT5	44.399	200	1.78

Keyless Drill Chuck

自紧式钻夹头

Keyless Drill Chucks

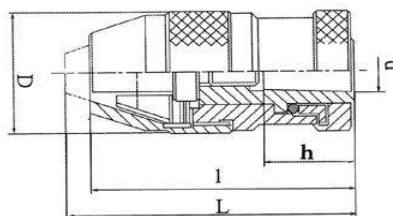

$D \leq 0.06\text{mm}$
 $M \leq 0.12\text{mm}$
 $P \leq 0.20\text{mm}$

C45S20

锥孔自紧式钻夹头 Taper-fitting Keyless Drill Chucks

Model	Capacity	Taper	d	h	D	L	I
J0106	0.5-6	B10	10.094	14.5	35	67	61
J0110	1-10	B12	12.065	18.5	42	86	78
J0113	1-13	B16	15.733	24	44	97	88
J0116	3-16	B18	17.78	32	48	108	98
J0116A	1-16	B16	15.733	24	48	108	98
J0120	5-20	B22	21.3	30.5	53	115	103
J0206	1/64"-1/4"	JT1	9.754	16.669	35	67	61
J0210	1/32"-3/8"	JT2	14.199	22.225	42	86	78
J0213	1/32"-1/2"	JT33	15.85	25.4	44	97	88
J0216	1/8"-5/8"	JT6	17.17	25.4	48	102	92
J0216	1/8"-5/8"	JT3	20.599	30.956	48	108	98
J0220	3/16"-3/4"	JT3	20.599	30.956	53	115	103



Above 6 kinds of types with different costs for choice. 上面六款不同外观与成本供选择。

自紧式钻夹头

Keyless Drill Chucks

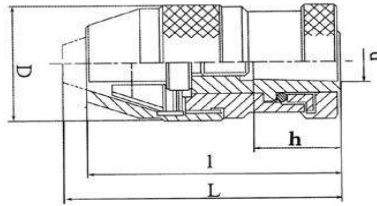

$D \leq 0.10\text{mm}$
 $M \leq 0.20\text{mm}$
 $P \leq 0.30\text{mm}$

螺纹孔自紧式钻夹头 Thread mounted Keyless Drill Chucks

Model	Capacity		Thread	h	D	L	I
J0306	1/64"-1/4"	0.5-6	3/8"-24UNF	14	35	67	61
J0308	1/64"-5/16"	0.5-8	3/8"-24UNF	14	42	86	78
J0310A	1/32"-3/8"	1-10	3/8"-24UNF	14	42	86	78
J0310B	1/32"-3/8"	1-10	1/2"-20UNF	16	42	86	78
J0313A	1/32"-1/2"	1-13	1/2"-20UNF	16	44	90	81
J0313B	1/32"-1/2"	1-13	3/8"-24UNF	14	44	90	81
J0316A	1/8"-5/8"	3-16	1/2"-20UNF	16	48	102	92
J0316C	1/8"-5/8"	3-16	5/8"-16UN	18	48	102	92

* Please state light or heavy duty as you prefer when ordering. 订货时请注明是轻型还是重型。

Integrated Keyless Drill Chuck with Morse Taper, Straight or R8 Shanks

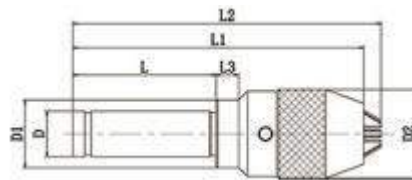

Model	Capacity		Dimensions				
	mm	Inch	D	D1	L	L1	L2
MT3-13	1.0- 13	1/32-1/2	23.825	51	99.5	182.5	195
MT3-16	1.0- 16	1/32-5/8	23.825	57	99.5	208	219.5
MT4-13	1.0- 13	1/32-1/2	31.542	51	125	207	218.5
MT4-16	1.0- 16	1/32-5/8	31.542	56.5	125	219	234.5
C20-13	1.0- 13	1/32-1/2	20	51	60	143	155.5
C20-16	1.0- 16	1/32-5/8	20	57	60	153	167.5
R8-13	1.0- 13	1/32-1/2	31.75	51	102	183.5	195
R8-16	1.0- 16	1/32-5/8	31.75	57	102	195	210

Drill Chucks

扳手型锥孔钻夹头 Key-type Drill Chucks with taper fitting

重型 Heavy Duty



Model	Capacity	Mounts	D	L1	L2
J216	0.6-6	B10, JT1	30.3	50	39.5
J2110	1-10	B12, JT2	43.4	69.7	54
J2113	1-13	B16, JT6, JT33	53.2	86	67
J2116A	1-16	B18, B16, JT3	57	93	75
J2120	5-20	B22, JT3	65.3	110	82

Drill Chucks for Power Tools

扳手型螺纹孔钻夹头 Key-type Drill Chucks with Thread mounted

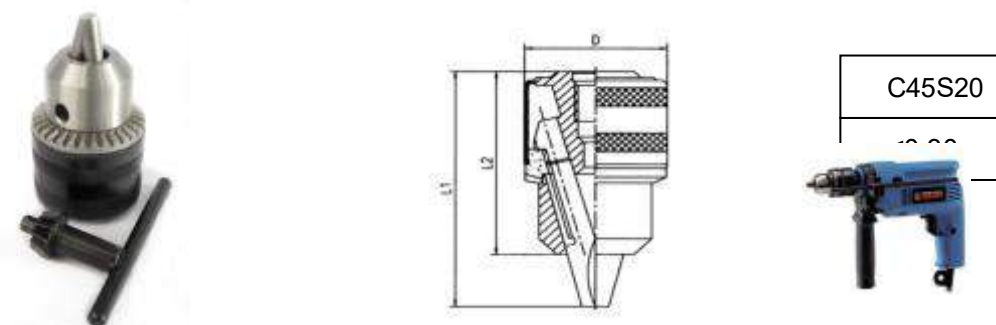

Model	Capacity	Mounts	D	L1	L2
J3506B	0.6-6	3/8-24UNF	30.3	49	40
J3510D	1.5-10	M10×1	34	58.5	49
J3510C	1.5-10	3/8-24UNF	34	58.5	49
J3510G	1.5-10	1/2-20UNF	34	58.5	49
J3513D	1.5-13	M12×1.25	42	71.5	59
J3513A	1.5-13	1/2-20UNF	42	71.5	59
J3513B	1.5-13	3/8-24UNF	42	71.5	59
J3516A	3-16	1/2-20UNF	52	86	67
J3516A	3-16	5/8-16UN	52	86	67

Stainless Steel Drill Chucks

不锈钢钻夹头 Stainless Steel Drill Chucks

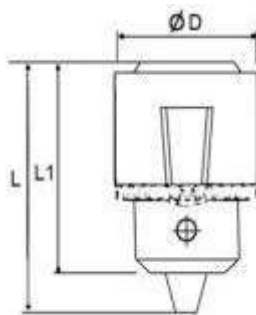

Material: 3Cr13

Capacity	Connecting Hole	D	L	L1
0.3-4	JT0; 3/8"-24UNF	20	36	30
0.6-6	JT1; B10; 3/8"-24UNF	28	47	38
0.6-8	JT1; B103/8"-24UNF	30	50	42
1.0-10	JT2; B12; 3/8"-24UNF	34	60	50
1.0-13	JT6; JT33; B161/2"-20UNF	42	70	56



Carbon Steel

Remarks: 4mm-JT0 can be made from carbon steel for engraving machines.

注：也可提供碳钢钻夹头 4mm-JT0，适用于雕刻机上。

Drill Chuck Arbors

扁尾式接杆 Morse Taper Drill Chuck Arbors with Tang Form

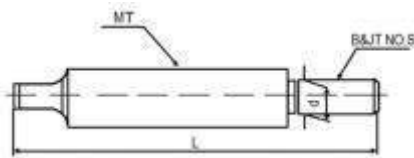

DIN238A
C45
≥85%

Model	L	d	Model	L	d
B16-MT2	112	15.733	JT33-MT3	127	15.85
B16-MT3	131	15.733	JT33-MT4	152	17.17
B16-MT4	156	15.733	JT33-MT5	184	15.85
B18-MT3	139	17.788	JT3-MT5	190	20.599
B18-MT4	164	17.788	JT4-MT4	169	28.55
B18-MT5	196	17.788	JT4-MT5	201	28.55

后拉式接杆 Drill Chuck Arbor with Draw Bar

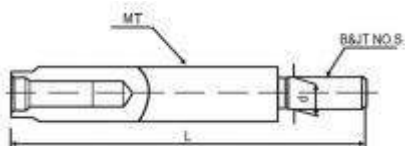

DIN228
C45
≥85%

Model	L	d	Model	L	d
B16-MT2	103	15.733	JT33-MT3	114	15.85
B16-MT3	118	15.733	JT33-MT4	137	15.850
B16-MT4	141	15.733	JT3-MT2	103	20.599
B18-MT3	126	17.788	JT3-MT3	120	20.599
B18-MT4	149	17.780	JT3-MT4	143	20.599
B18-MT5	176	17.788	JT3-MT5	170	20.599

R8 钻接杆 R8 Drill Chuck Arbors

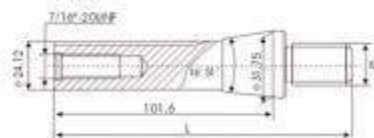

≥85%
C45

Model	D	L	Model	D	L
R8-JT33	132	15.85	R8-B12	128	12.065
R8-JT6	132	17.17	R8-B16	135	15.733
R8-JT3	137	20.599	R8-B18	143	17.78

Remarks: Back Bar thread at Metric of M12*1.25P and Inch of 7/16-20unf for your choice .

注: R8 后尾内孔可做公英制两种螺纹供选择。

MT 变径套 MT Drill Sleeves

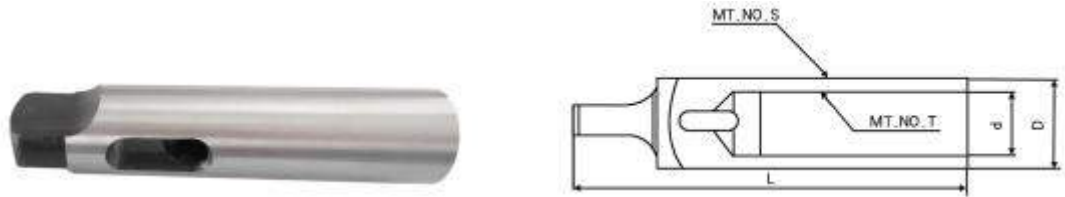

DIN2185

40Cr

≥85%

Model	MT. No. S	MT. No. T	D	d	L	Wt.
MT2×1	2	1	18.6	12.065	90	0.10
MT3×1	3	1	24.1	12.065	99	0.24
MT3×2	3	2	24.7	17.78	108	0.12
MT4×2	4	2	31.6	17.780	124	0.50
MT4×3	4	3	32.4	23.825	132	0.38
MT5×3	5	3	44.7	23.825	156	1.36
MT5×4	5	4	45.5	31.267	164	0.95
MT6×4	6	4	63.8	31.267	218	3.12
MT6×5	6	5	63.8	44.399	218	1.95

加长变径套 Extension Drill Sleeves

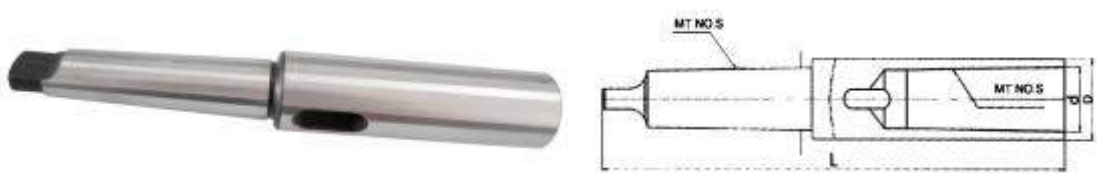

DIN2187

40Cr

≥85%

Model	MT. No. S	MT. No. T	D	d	L	Wt.
MT3×2	3	2	30	17.780	194	0.62
MT3×3	3	3	36	23.825	215	0.89
MT3×4	3	4	48	31.267	240	1.55
MT3×5	3	5	63	44.399	275	2.80
MT4×3	4	3	36	23.825	240	1.27
MT4×4	4	4	48	31.267	265	1.93
MT4×5	4	5	63	44.399	300	3.18
MT4×6	4	6	85	63.348	368	6.50

拆卸铁

Morse Shank Puller



Model	MS. NO	L
DIN317/ 0	0	90
DIN317/ 1-2	1-2	140
DIN317/3	3	190
DIN317/ 4	4	225
DIN317/5-6	5-6	265

半自动拆卸铁

Half Automatic Morse Shank Puller



Model	MS. NO	L
DIN318/1-3	1-3	317
DIN318/ 4-6	4-6	380

万能夹具组 Steel Clamping Kits



M 8 - M16



M18- M24

Model	Taiwan Code	Table Slot	Stud Sizes	G.W.	GB
M 8	CK-08	10	8-1.25P	7	-
M10	CK-10	12	10-1.25P	9	3/8-16
M12	CK-12	14	12-1.75P	10	1/2-12
M14	CK-14	16	14-2.0P	11	-
M16	CK-16	18	16-2.0P	13	5/8-11
M18	CK-18	20	18-2.5P	25	-
M20	CK-20	22	20-2.5P	26	3/4-10
M22	CK-22	24	24-3.0P	30	7/8-9

Lathe Chucks

K11 系列三爪自定心卡盘

K11 Series 3-jaw Self-centering Chucks

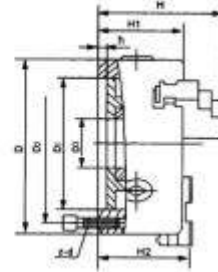
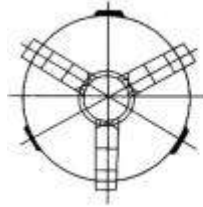

HT300

Size	D1	D2	D3	H	H1	h	z-d
80	55	66	16	66.5	50	4	3-M6
100	72	84	22	74.5	55	3	3-M8
125	95	108	30	84.5	58	4	3-M8
160	130	142	40	94	65	5	3-M8
200	165	180	65	109	75	5	3-M10
250	206	226	80	120	80	5	3-M12
315A	260	285	100	155.5	90	5	3-M12
400A	340	368	130	170.5	100	6	3-M16
500A	440	465	200	203	115	6	6-M16
630A	560	595	260	218	130	7	6-M16

K12 系列四爪自定心卡盘

K12 Series 4-jaw Self-centering Chucks

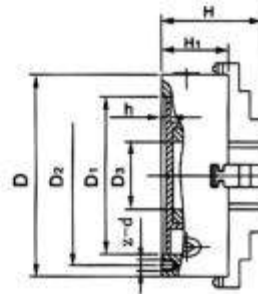
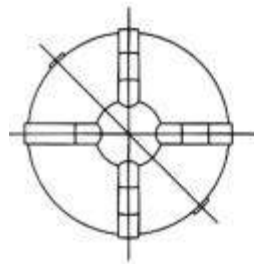

HT300

Size	D1	D2	D3	H	H1	h	z-d
80	55	66	16	66	50	3.5	3-M6
100	72	84	22	73	53.5	3.5	3-M8
125	95	108	30	84	58	3.5	3-M8
160	130	142	40	95	65	5	3-M8
200	165	180	65	109	75	5	3-M10
250	206	226	80	120	80	5	3-M12
250A	206	226	80	136	80	5	3-M12

315A	260	285	100	157	90	6	3-M16
------	-----	-----	-----	-----	----	---	-------

K72 系列四爪单动卡盘

K72 Series 4-jaw Independent Chucks

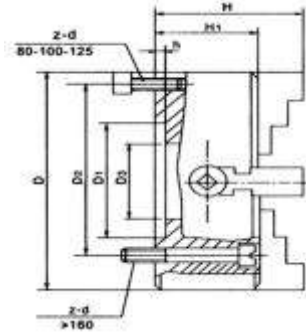

HT300

Size	Size D inch	D1	D2	D3	H	H1	h	z-d
80	3	55	66	22	58	42	3.5	4-M6
100	4	72	84	25	77	54	4	4-M8
125	5	95	108	30	78	56	4.5	4-M8
160	6	65	95	45	96.5	65	5	4-M10
200	8	125	104.8	50	110	75	6	4-M10
250	10	100	120	65	117.5	82	6	4-M12
315	12	140	165	95	134	90	6	4-M16
400	16	160	185	125	143	95	8	4-M16
500	20	200	236	160	161	106	8	4-M20
630	25	220	258	180	180	115	10	4-M20
800	32	250	300	210	210	135	12	8-M20
1000	40	320	370	260	241	150	15	8-M20
2000	80	450	560	350	290	190	20	8-M30

K13 大直径自定心卡盘

K13 Series Large Diameter Self-centering Chucks



Sizes (规格): 1250 -- 2600mm

K78 大直径重型四爪单动卡盘

K78 Series Large diameter Heavy-duty 4-jaw Independent Chucks

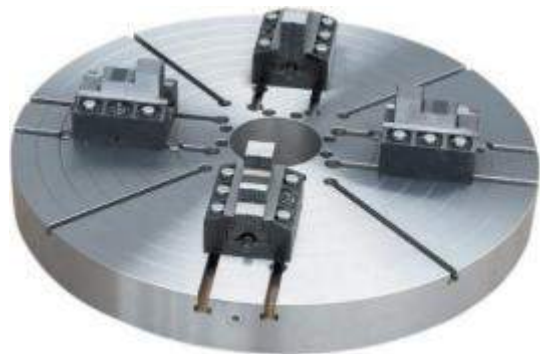

Sizes (规格): 1600--3000mm

Any other sizes can be supplied as ordered. 其它规格可按订单生产供货。

Steel Clamping Kit

万能夹具组

Steel Clamping Kits

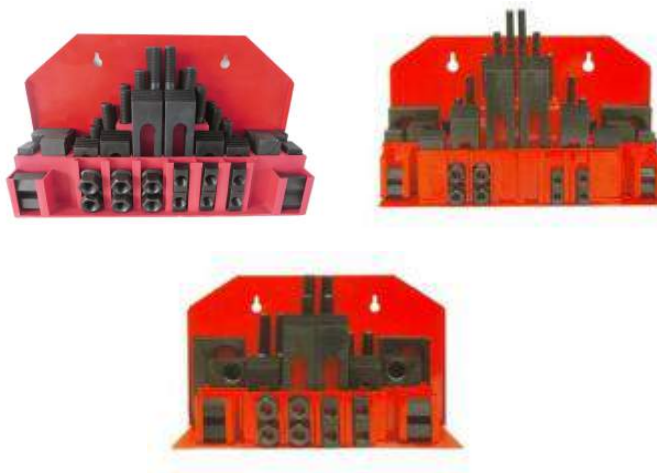

52PCS / SET

42PCS / SET

36PCS / SET

Model	Studs	T-Nuts	Coupling Nuts	Flange Nuts	Step Clamps	Step Blocks
52PCS	24	6	4	6	6	6 / 12
42PCS	12	4	4	4	6	6 / 12
36PCS	12	4	4	4	4	4 / 8

Material 材料: S45C; Hardness 硬度 HRC 32±5.
Heat treated steel black oxide finish. 表面氧化热处理;

Usage: Apply for fixing each kind of working-piece on machining table.

用途：用在各种机械工作台上固定或夹持模具，治具板等。

Set in plastic rack or wooden plate consists of (Block size 25mm):

- 24PCS Studs** 24 根双端螺栓 75 / 100 / 125 / 150 / 175 / 200mm
- 6PCS T-Nuts** 6 只 T 型槽螺母
- 4PCS Coupling Nuts** 4 只连接螺母
- 6PCS Flange Nuts** 6 只法兰螺母
- 6PCS Step Clamps** 6 块阶梯压板
- 12PCS Step Blocks** 6 / 12 块阶梯垫铁



Studs 双端螺栓



T-Nuts T 型槽螺母



Coupling Nuts 连接螺母



Flange Nuts 法兰螺母



Step Clamps 阶梯压板



Step Blocks 阶梯垫铁

T 型螺母

T-Nuts

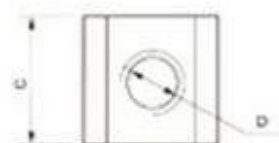
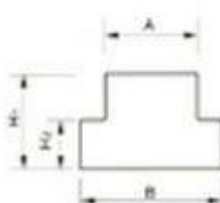

D	A	B	C	H1	H2
M8	10	15	15	12	6
M10	12	18	20	14	7
M12	14	22	25	16	8
M14	16	25	25	16	10
M16	18	29	30	19	10.5
M18	20	34	34	28	14

M20	22	34	34	28	14
M22	24	40	40	28	15



M 8 - M16



M18- M24

Model	Taiwan Code	Table Slot	Stud Sizes	G.W.	GB
M 8	CK-08	10	8-1.25P	7	-
M10	CK-10	12	10-1.25P	9	3/8-16
M12	CK-12	14	12-1.75P	10	1/2-12
M14	CK-14	16	14-2.0P	11	-
M16	CK-16	18	16-2.0P	13	5/8-11
M18	CK-18	20	18-2.5P	25	-
M20	CK-20	22	20-2.5P	26	3/4-10
M22	CK-22	24	24-3.0P	30	7/8-9

Bench Vices

83 型活动带砧式台钳(重型)

83 Type Heavy Duty Bench Vices with Anvil Swivel Base



MODEL	SIZE	Width of jaw	QTY/Case	G.W./N.W.
8303	3"	75	4	28/26
8304	4"	100	2	23/22
8305	5"	125	1	20/19
8306	6"	150	1	30/29
8308	8"	200	1	44/42
8310	10"	250	1	70/62
8312	12"	300	1	75/68

83 型固定带砧式台钳(重型)

83 Type Heavy Duty Bench Vices with Anvil Stationary Base



MODEL	SIZE	Width of jaw	QTY/Case	G.W./N.W.
8323	3"	75	4	22/20
8324	4"	100	2	22/20
8325	5"	125	1	18/17
8326	6"	150	1	28/26
8328	8"	200	1	42/40

83 型活动无砧式台钳(重型)

83 Type Heavy Duty Bench Vices without Anvil Swivel Base



MODEL	SIZE	Width of jaw	QTY/Case	G.W./N.W.
8353	3"	75	4	24/22
8354	4"	100	2	22/20
8355	5"	125	1	18/17
8356	6"	150	1	28/26
8358	8"	200	1	42/40

83 型固定无砧式台钳(重型)

83 Type Heavy Duty Bench Vices without Anvil Stationary Base



MODEL	SIZE	Width of jaw	QTY/Case	G.W./N.W.
8363	3"	75	4	24/22
8364	4"	100	2	22/20
8365	5"	125	1	18/17
8366	6"	150	1	28/26
8368	8"	200	1	42/40

Bench Vices

89 型活动带砧式台钳(轻型)

89 Type Light Duty Bench Vices with Anvil Swivel Base



MODEL	SIZE	Width of jaw	QTY/Case	G.W./N.W.
8903	3"	75	4	20/18
8904	4"	100	4	30/28
8905	5"	125	2	28/26
8906	6"	150	1	21/20
8908	8"	200	1	31/30
8910	10"	250	1	46/44

89 型固定带砧式台钳(轻型)

89 Type Light Duty Bench Vices with Anvil Stationary Base



MODEL	SIZE	Width of jaw	QTY/Case	G.W./N.W.
8924	4"	100	4	30/28
8925	5"	125	2	28/26
8926	6"	150	1	21/20
8928	8"	200	1	31/30

89 型活动无砧式台钳(轻型)

89 Type Light Duty Bench Vices without Anvil Swivel Base



MODEL	SIZE	Width of jaw	QTY/Case	G.W./N.W.
8954	4"	100	4	30/28
8955	5"	125	2	28/26
8956	6"	150	1	21/20
8958	8"	200	1	31/30

89 型固定无砧式台钳(轻型)

89 Type Light Duty Bench Vices without Anvil Stationary Base



MODEL	SIZE	Width of jaw	QTY/Case	G.W./N.W.
8964	4"	100	4	22/20
8965	5"	125	2	22/20
8966	6"	150	1	18/17
8968	8"	200	1	26/25

Bench Vices

96 型活动带砧式台钳(超轻型)

96 Type Super Light Duty Bench Vices with Anvil Swivel Base



MODEL	SIZE	Width of jaw	QTY/Case	G.W./N.W.
9604	4"	100	4	22/20
9605	5"	125	2	17/15
9606	6"	150	1	12/11
9608	8"	200	1	24/22

96 型固定带砧式台钳(超轻型)

96 Type Super Light Duty Bench Vices with Anvil Stationary Base



MODEL	SIZE	Width of jaw	QTY/Case	G.W./N.W.
9624	4"	100	4	22/20
9625	5"	125	2	17/15
9626	6"	150	1	12/11
9628	8"	200	1	24/22

93 型活动带砧美式台钳

93 Type Bench Vices with Anvil Swivel Base (American Type)



MODEL	SIZE	Width of jaw	QTY/Case	G.W./N.W.
9303	3.5"	87.5	6	30/27
9304	4"	100	4	21.5/19

95 型活动带砧美式台钳

95 Type Bench Vices with Anvil Swivel Base (American Type)



MODEL	SIZE	Width of jaw	Max.Opening	QTY/Case	G.W./N.W.
9504	4"	100	127	2	28/26
9505	5"	125	152	1	19/18
9506	6"	150	178	1	29/27

Bench Vices

98 重型法式活动带砧台钳

98 Type Heavy Duty Bench Vices with Anvil Swivel Base (French Type)



MODEL	SIZE	Width of jaw	Max. Opening	QTY/Case	G.W./N.W.
9803	3"	75	75	4	20/19
9804	4"	100	100	2	16/14
9805	5"	125	125	1	11.4/10.6
9806	6"	150	150	1	17.5/16.5

98 重型法式固定带砧台钳

98 Type Heavy Duty Bench Vices with Anvil Stationary Base(French Type)



MODEL	SIZE	Width of jaw	Max. Opening	QTY/Case	G.W./N.W.
9823	3"	75	75	4	18/16
9824	4"	100	100	2	13/12
9825	5"	125	125	1	20/18.6
9826	6"	150	150	1	15.5/14.5

98 轻型法式活动带砧台钳

98 Type Light Duty Bench Vices with Anvil Swivel Base (French Type)



MODEL	SIZE	Width of jaw	Max. Opening	QTY/Case	G.W./N.W.
9833	3"	75	75	4	20/18
9804	4"	100	100	2	11/10
9805	5"	125	125	1	8.5/7.5
9806	6"	150	150	1	12.5/11.5

98 轻型法式固定带砧台钳

98 Type Light Duty Bench Vices with Anvil Stationary Base(French Type)



MODEL	SIZE	Width of jaw	Max. Opening	QTY/Case	G.W./N.W.
9843	3"	75	75	4	18/16
9844	4"	100	100	2	10/9
9845	5"	125	125	1	8/7
9846	6"	150	150	1	11.5/10.5

铣床平口钳

QH Milling Machine Vices(QH=Q12)



Performance and character 性能及特点

1. It is made of ductile cast iron(HT200). 由延展性较强的铸铁制作而成。（球墨铸铁 200）
2. The accuracy of vice is parallelism at 0.025mm/100mm and squareness at 0.025.
两钳口的平行度是 0.025mm/100mm，两钳口对导轨面的垂直度是 0.025mm
3. It is widely used on milling and drilling machine for making some kinds of slots, holes and faces.
广泛用于铣床、刨床、钻床等各种平面、沟槽、角度、孔等加工。

Model	Width of jaw	Height of jaw	Max. Opening	G.W./N.W.
QH80	80	30	60	38/28(4PCS)
QH100	100	35	80	40/28(4PCS)
QH125	125	40	100	17/16
QH160	160	52	125	38/36
QH200	200	63	160	54/52

刨床平口钳

QB Planning Machine Vices(QB=Q13)



Performance and character 性能及特点

1. It is made of ductile cast iron(HT200).由延展性较强的铸铁制作而成（球墨铸铁 200）
2. The accuracy of vice is parallelism at 0.025mm/100mm and squareness at 0.025.
两钳口的平行度是 0.025mm/100mm，两钳口对导轨面的垂直度是 0.025mm
3. The vice can be used with single or settled side by side on the machine Worktable.
平口钳可单台使用，也可多台并排使用。
4. It is widely used on machining center and other precision machine.广泛用于加工中心等精密机床。

Model	Width of jaw	Height of jaw	Max. Opening	G.W./N.W.
QB136	136	36	170	15/14
QB160	160	51	180	22/21
QB200	200	64	280	36/35
QB250	250	64	280	51/50

QB320	320	81	360	74/70
-------	-----	----	-----	-------

角固式平口钳

QM16 Accu-lock Machine Vices



Performance and character 性能及特点

- 1.It is made of ductile cast iron(HT200).由延展性较强的铸铁制作而成（球墨铸铁 200）
- 2.The accuracy of vice is parallelism at 0.025mm/100mm and squareness at 0.025.
两钳口的平行度是 0.025mm/100mm, 两钳口对导轨面的垂直度是 0.025mm
- 3.The vice can be used with single or settled side by side on the machine Worktable.
平口钳可单台使用, 也可多台并排使用。
- 4.It is widely used on machining center and other precision machine.
广泛用于加工中心等精密机床。

Model	Width of jaw	Height of jaw	Max. Opening	G.W./N.W.
QM16100	100	32	100	17/16
QM16160	160	45	160	37/36
QM16200	200	50	190	62/56

角固式精密平口钳

QM16N Accu-lock Precision Machine

Vices

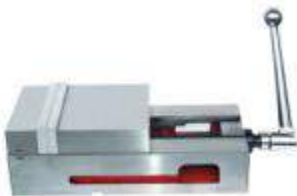

Performance and character 性能及特点

- 1.It is made of ductile cast iron(HT200).由延展性较强的铸铁制作而成（球墨铸铁 200）
- 2.The accuracy of vice is parallelism at 0.025mm/100mm and squareness at 0.025.
两钳口的平行度是 0.025mm/100mm, 两钳口对导轨面的垂直度是 0.025mm
- 3.The vice can be used with single or settled side by side on the machine Worktable.
平口钳可单台使用, 也可多台并排使用。
4. It is widely used on machining center and other precision machine.
广泛用于加工中心等精密机床。

Model	Width of jaw	Height of jaw	Max. Opening	G.W./N.W.
QM16100N	100	32	100	17/16
QM16160N	160	45	160	37/36
QM16200N	200	50	190	45/44

Q52 型液压增力平口钳

QM52 Hydraulic Power Machine Vices



Performance and character 性能及特点

- 1.It is made of ductile cast iron(HT200).由延展性较强的铸铁制作而成（球墨铸铁 200）
- 2.The accuracy of vice is parallelism at 0.025mm/100mm and squareness at 0.025.
两钳口的平行度是 0.025mm/100mm, 两钳口对导轨面的垂直度是 0.025mm

Model	Width of jaw	Height of jaw	Max. Opening	G.W./N.W.
Q52150L	152	52	320	45/43
Q52320	320	80	345	105/103
Q52400	400	85	130	163/159

Machine Vices

QHK 型可倾平口钳

QHK Declinable Machine Vices(QHK=Q41)



Performance and character 性能及特点

- 1.It is made of ductile cast iron(HT200).
由延展性较强的铸铁制作而成（球墨铸铁 200）
- 2.The accuracy of vice is parallelism at 0.025mm/100mm and squareness at 0.025.
两钳口的平行度是 0.025mm/100mm，两钳口对导轨面的垂直度是 0.025mm
- 3.It is widely used on machine tool in making some kinds of slots, holes and faces .
广泛用于加工中心等精密机床。

Model	Width of jaw	Height of jaw	Max. Opening	G.W./N.W.
QHK100	100	41	80	19/18
QHK125	125	46	100	29/27.5
QHK25L	125	46	140	29/27.5
QHK160	160	50	125	43/41.5

QW 型万向平口钳

QW Universal Machine Vices



Performance and character:性能及特点

1. It is made of high-quality cast iron.采用高质量的铸铁材料。
2. The accuracy of vice is parallelism at 0.025mm/100mm and squareness at 0.025.
两钳口的平行度是 0.025mm/100mm，两钳口对导轨面的垂直度是 0.025mm
3. It used on machining and EDM complex parts.
广泛采用机械加工、电加工等复杂零件的使用。

Model	Width of jaw	Height of jaw	Max. Opening	G.W./N.W.
QW100	105	40	105	31/26
QW125	125	44	125	33/28

Q93 型双向角度压紧平口钳 Q93 Double-action Angle Tight Vices



Model	Width of jaw	Height of Jaw	Max. Opening	QTY/Case	G.W./N.W
Q93100	100	35	76	1	19/17
Q93160	160	50	100	1	54/47

Machine Vice

QGG 精密工具平口钳

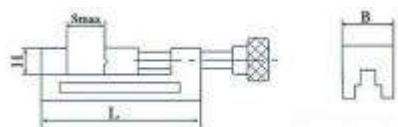

QGG Precision Tool Vices

Model	B	H	S-max	L	Wt .
QGG50	50	25	65	155	3
QGG63	63	32	85	190	3.8
QGG80	80	40	100	220	6.5
QGG100	100	45	125	260	13
QGG125	125	50	210	350	23
QGG150	150	50	175	315	23.8

QKG 精密工具平口钳

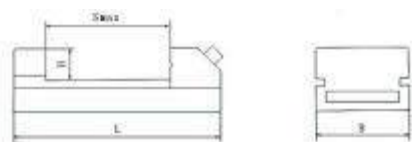

QKG Precision Tool Vices

Model	B	H	S-max	L	Wt .
QKG25	25	9.15	22	65.4	0.5
QKG50	50	25	65	140	2.0
QKG63	63	32	85	175	3.0
QKG73	73	35	100	190	4.1
QKG80	80	40	100	200	5.5
QKG88	88	40	125	235	7.3
QKG100	100	45	125	245	10.0
QKG125	125	50	160	285	18.0
QKG150	150	50	200	330	21.5

GT 精密组合平口钳

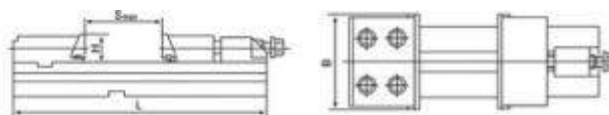

GT Precision Modular Vises

Model	Size	B	H	Smax	L	Clamping Force
GT125	125×40×150	125	40	150	345	3000

GT150A	150×50×200	150	50	200	420	5000
GT175A	175×60×200	175	60	200	455	6000
GT175B	175×60×300	175	60	300	555	6000
GT200C	200×60×400	200	65	400	695	10000
GT200D	200×60×500	200	65	500	795	10000
GT300C	300×80×400	300	80	400	735	12000
GT300D	300×80×500	300	80	500	835	12000

Machine Vices

Q19 德式钻床平口钳

Q19 Drilling Machine Vices(German)



Model	Width of jaw	Max. Opening	G.W./N.W.
Q1965	65	45	11.5/10(10PCS)
Q1975/80	75/80	50	22/20(10PCS)
Q19100	100	75	34/31(10PCS)
Q19125	125	100	39/37(8PCS)
Q19150	150	125	37/35(5PCS)
Q19200	200	175	49/46(4PCS)

Q19E 丝杠缩入式平口钳

Q19E Guild-screw leading-in Drilling Vices



Model	Width of jaw	Max. Opening	G.W./N.W.
Q1985E	85	60	32/30(10PCS)
Q19100E	100	75	38/36(8PCS)
Q19120E	120	100	40/38(6PCS)
Q19150E	150	125	36/34(4PCS)

Q19A 美式钻床平口钳

Q19A Drilling Machine Vices(American)



Model	Width of jaw	Max. Opening	G.W./N.W.
Q192-1/2A	67	70	21/19(10PCS)
Q193A	78	78	22/20(10PCS)
Q194A	100	110	32/30(10PCS)
Q195A	125	128	44/42(8PCS)
Q196A	150	150	36/34(5PCS)

SY 手板压力机

SY Arbor Presses



Model	Pressure	KN	Opening	G.W./N.W.
0.5t	5	500	90	11/10
1t	10	1000	110	17/16
2t	20	2000	180	39/38
3t	30	3000	285	69/67
5t	50	5000	430	176/154

Tailstock

WZK 系列可调尾座

Adjustable Tailstock, WZK Series



Note : Type WZK100-1 adjustable tailstock is matched FNL100B.Type WZK140 adjustable tailstock is matched to TSL160.Type WZK180 Adjustable tailstock is matched to TSL200 and TSL250.WZK224 adjustable tailstock is Matched to TSL320.

Items	WZK100-1	WZK140	WZK180	WZK224
Distance between taper center to base mm	Max.100 Min.80	Max.140 Min.100	Max.180 Min.140	Max.224 Min.180
Taper of Center			MT2	MT2
Width of locating key mm	12	14	14	18
Tilting angle of center axes	±11°			
Stroke of center mm	25			
Matched Rotary Tables	FNL100B	TSL160	TSL200, 250	TSL320
Net weight kg	6	8	14.5	16.5
Gross weight kg	8	10	18.5	21
Case dimensions mm	257×230×192	284×230×194	353×308×223	398×308×223

WZ 系列固定尾座

Tailstock, WZ series



Items	WZ70	TSL400-2
Distance between taper center to base mm	70	260
Taper of Center	-	MT3
Width of locating key mm	10	18
Stroke of center mm	12	30
Net weight kgs	2.5	28
Gross weight kgs	3	32
Case dimensions mm	200×120×202	375×355×260

Dividing Head

台湾款分度头

Semi-universal Dividing Heads

BS0 & BS1

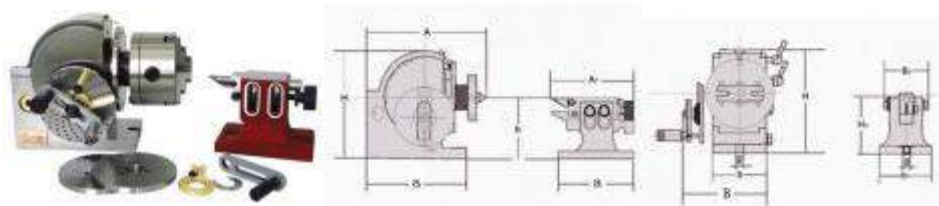

BS2

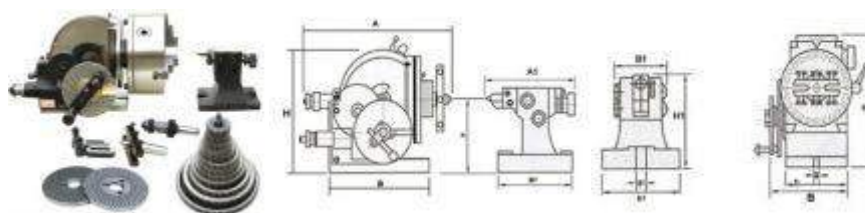

SEMI-UNIVERSAL INDEX CENTERS

Model	A		B		H		h		Taper of Center	N.W.	Matched Chucks
BS0	193	7.59	131	5.15	173	6.81	100	3.93	MT2	21	125mm
BS1	242	9.52	168	6.61	220	8.66	128	5.04	MT3	30	160mm
BS2	370	14.5	280	11.02	236	9.29	133	5.24	MT4	73	160mm;200mm

SEMI-UNIVERSAL INDEX CENTERS BS 0, BS 1, BS 2 (TAIL-STOCK)

Model	A1		B1		H1		h		a1		b1		g1	
BS0	175	6.89	87	3.42	12	4.02	109	3.93	130	5.12	92	3.62	16	0.63
BS1	183	7.20	87	3.42	137	5.39	128	5.04	158	6.22	110	4.33	16	0.63
BS2	183	7.20	87	3.42	156	6.14	133	5.24	175	6.89	122	4.80	16	0.63

蜂巢板 DIVIDING PLATES



Model	Dividing plates	Number of Holes		Used of Model
3PCS	A	15,16,17,18,19,20		<ul style="list-style-type: none"> • RT-HV4,HV6 • RT-6
	B	21,23,27,29,31,33		
	C	37,39,41,43,47,49		
2PCS	A	A1	26,30,34,38,41,44,47,51,57	<ul style="list-style-type: none"> • RT-HV8,HV10,HV12,HV14,HV16 • RT-8,10,12,14 CS-6",8"
		A2	28,32,37,39,43,46,49,53,59	
	B	B1	61,67,71,77,81,87,91,97	
		B2	63,69,73,79,83,89,93,99	

Dividing Heads

万能分度头

Universal Dividing Heads

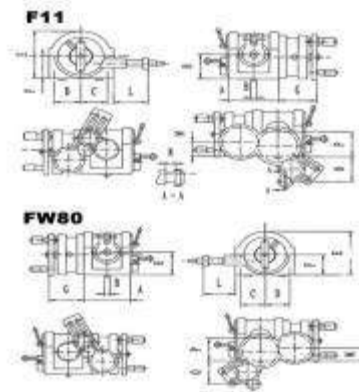

FW80、F11 Series Installation Sketch and Dimensions:

Model	A	B	C	D	E	F	G	H	L	M	N	O	P
FW80	139	14	77	73	147	77	98	80	106	43	30	60	80
F11100A	162	14	102	87	186	95	116	100	93	54.7	30	100	100
F11125A	209	18	116	98	224	117	120	125	103	68.5	34.5	100	125
F11160A	209	18	116	98	259	152	120	160	103	68.5	34.5	100	160

FW80、F11 Series Main Specifications:

Items	Specifications	FW80	F11100A	F11125A	F11160A
中心高 Center height mm		80	100	125	160

主轴由水平位置向上转动的角度 Swivel angle of spindle from it's horizontal position	≤90°	≤95°		
主轴由水平位置向下转动的角度 Horizontal position (downward)	≤6°	≤5°		
分度手轮每转，主轴回转角度 Rotating angle of spindle for one complete Revolution of dividing handle	9°(540 grad., 1' each)			
游标最小示值 Min .reading of Vernier	10"			
蜗杆副传动比 Worm gear ratio	1:40			
主轴孔锥度（莫式） Taper of spindle bore	MT3		MT4	
定位键宽度 Width of locating key. mm	14		18	
主轴法兰盘定位短锥直径 Diameter of short taper of Sindle-nose for mounting flange mm	Φ36.541	Φ41.275	Φ53.975	Φ53.975
分度盘孔数 Hole numbers on index plate	第一面 1st plate	24,25,28,30,34,37,38,39,41,42,43		
	第二面 2nd plate	46,47,49,51,53,54,57,58,59,62,66		
变换齿轮 Change Gear	模数 Module	1.5	2	
	齿数 Teeth Numbers	25,30,35,40,50,55,60,70,80,90,100		
最大承载 Max. bearing Kg	80	100	130	160
可配卡盘 Matched Chucks	100mm	125mm	160mm	200mm

Dividing Heads

F2 型立卧等分分度头

Direct Dividing Head, Type F2

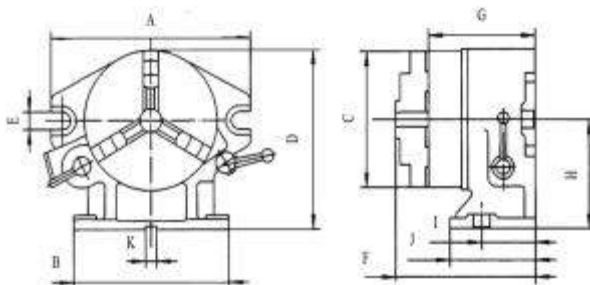

Installation sketch and dimensions:

Model	A	B	C	D	E	F	G	H	I	J	K
F2-8	310	255	Φ210	255.25	18	214	171.5	149.25	80	150	16
F2-6	260	220	Φ167	220	18	197.5	155.5	130	70	130	16

Main specifications

Items	Specifications	F2-8	F2-6
中心高 Center height mm		149.25	30
主轴定心直径 Center diameter of the spindle mm		Φ119.774	Φ80
可分等分数 Divisions		2、3、4、6、8、12、24	

主轴轴肩支撑面至底面高度 (主轴直立时) Height between external centering diameter of the spindle to the base (in vertical position)mm	96	89.5
主轴轴肩直径 Locating diameter of the spindle mm	Φ212	Φ170
定位键宽度 Width of the locating key mm	16	
可配卡盘 Matched chuck	K31210A	K31167
24 等分单个分度误差 24 divisions individual error	25"	

FNL100B 型立卧等分分度头

FNL 100B Horizontal / Vertical Collets Index



Items	FNL100B
中心高 Center height mm	10.16
Min. ID of spindle mm	Φ31.75
可分等分数 Divisions	2、3、4、6、8、12、24
Spindle screw	2.25×8
Collets	5C
等分精度 Dividing accuracy	±3'
净重 Net weight kg	12
毛重 Gross weight kg	15
包装尺寸 Case dimensions mm	284×250×260

Dividing Heads

F3 型立卧等分分度头

Direct Dividing Head

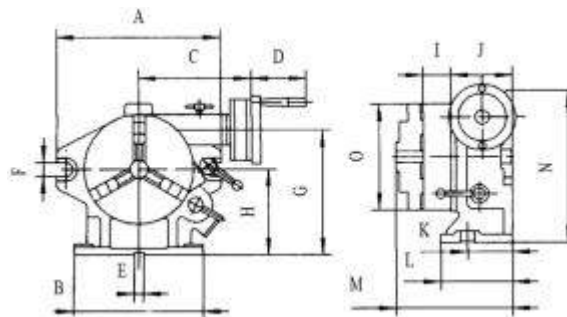

Installation Sketch and Dimensions:

Model	A	B	C	D	E	F	H	I	J	K	L	M	L	O
F3-8	310	255	200	78	16	18	150	75	126	90	155	244	285	Φ210
F3-6	250	220	188	78	16	18	130	66	112	80	150	220	235	Φ167

Main Specifications

Items	Specifications	F3-8	F3-6
中心高 Center height mm		150	130
主轴定心直径 Center diameter of the spindle mm		Φ119.774	Φ80
主轴轴肩直径 Diameter of spindle shoulder mm		Φ212	Φ170
可分等分数 Divisions		2、3、4、6、8、12、24	
主轴的圆周刻度 Graduated disc of spindle		360°	
蜗轮副模数 Modules of worm and worm gear		1.5	1.25
蜗轮副传动比 Transmission ratio of worm and worm gear		1:90	
蜗轮每转所代表的转台度数 Showed degree of worktable per revolution of worm		4°	
游标量小示值 Minimum value of Vernier		10"	
定位键宽度 Width of the locating key mm		16	
可配卡盘 Matched chuck		K31210A	K31167
24 等分单个分度误差 24 divisions individual error		25"	
蜗轮副等分度误差 Worm gear dividing error		±60"	
包装尺寸 Case dimensions mm		490×425×380	470×350×360

Rotary Tables

立卧回转工作台

Vertical/Horizontal Rotary Tables

Material:HT200

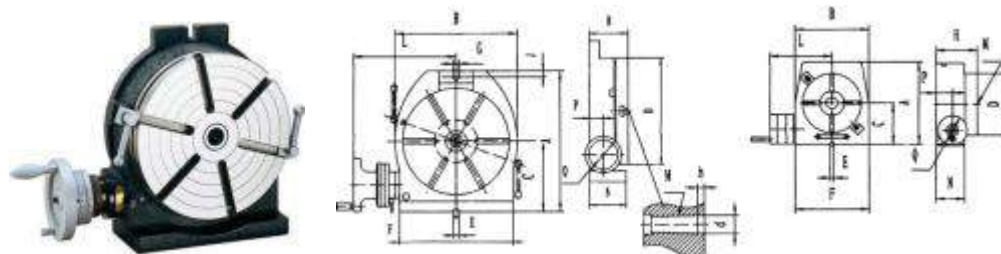

Main Specifications

Specifications Items	HV-4"	HV-6"	HV-8"	HV-10"	HV-12"	HV-16"
工作台直径 Diameter of table mm	Φ100	Φ160	Φ200	Φ250	Φ320	Φ400
台面中心孔锥度（莫式） Morse taper of the center hole	2#		3#		4#	
台面定位孔直径 Diameter of the center hole mm	Φ20×8	Φ25×6	Φ30×6		Φ40×10	
工作台垂直时中心高 Height of center for Vert. mounting	70	125	150	170	210	260
台面 T 型槽宽度 Width of the T-slot mm	6	10	12		14	
台面 T 型槽相邻角度 Adjacent angle of table T-slot	90°			60°		
定位键宽度 Width of locating key mm	10	12	14		18	
蜗轮副模数 Module of the worm gear	1	1.5	1.75	2	2.5	3.5
蜗轮副转动比 Transmission ratio of the worm gear	1:72	1:90				
工作台圆周刻度 Graduation of the table	360°					
转台手轮刻度值 Readout of the handwheel	2'	1'				
游标量小示值 Minimum reading of the vernier	10"					
分度精度 Indexing accuracy	120"	80"	60"			
最大承载（卧式） Max.bearing(with table Hor.)kg	20	100	150	200	250	300
最大承载（立式） Max.bearing(with table Vert.)kg	10	50	75	100	125	150
毛重 Gross weight Kg	8	30	42	57	92	175

Rotary Tables

可倾回转工作台

Tilting Rotary Tables

Material:HT200

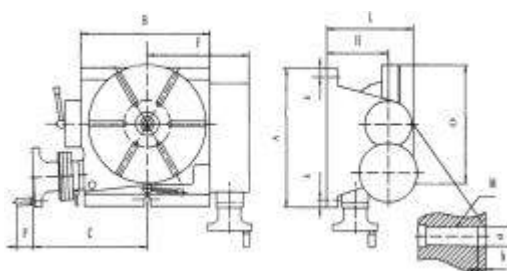

Main Specifications

Specifications	TSK160	TSK200	TSK250	TSK320	TSK400
Items					
工作台直径 Diameter of table mm	Φ160	Φ200	Φ250	Φ320	Φ400
台面中心孔锥度 (莫式) Morse taper of the center hole	2#	3#		4#	
台面定位孔直径 Diameter of the center hole mm	Φ25×6	Φ30×6		Φ40×10	
台面 T 型槽宽度 Width of the T-slot mm	10	12		14	
蜗轮副模数 Module of the worm gear	1.5	2		2.5	3.5
定位键宽度 Width of the locating key mm	12	14		18	
台面 T 型槽相邻角度 Adjacent angle of table T-slot	90°		60		
蜗轮副转动比 Transmission ratio of the worm gear	1:90				
工作台圆周刻度 Graduation of the table	360°				
工作台可倾角度 Tilting angle	0°~90°				
转台手轮刻度值 Readout of the hand wheel	1'				
游标量小示值 Minimum reading of the vernier	10"				
可倾游标量最小示值 Minimum reading of the tilting vernier	2'				
分度精度 Indexing accuracy	8"	60"			
最大承载 (卧式) Max. bearing(with table Hor.)kgs	100	150	200	250	300
最大承载 (立式) Max. bearing(with table Vert.)kgs	50	75	100	125	150
毛重 Cross Weight kgs	44	67	93	150	305
可配卡盘 Matching Chuck	K11125	K11160	K11200	K11250	K11325

Rotary Tables

卧式回转工作台

TS Horizontal Rotary Tables

Material:HT200

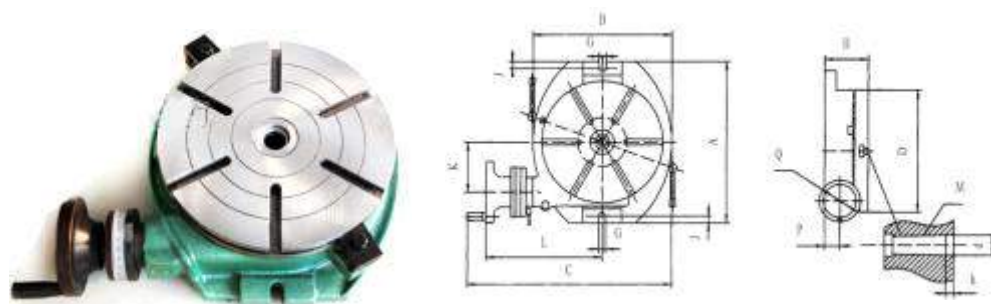

Main Specifications

Specifications Items	TS160A	TS200A	TS250A	TS320A	TS400A	TS500A	TS630A	TS800A	TS1000A
工作台直径 Table diameter mm	Φ160	Φ200	Φ250	Φ320	Φ400	Φ500	Φ630	Φ800	Φ1000
台面中心孔锥度 Morse taper of the hole mm	2#	3#		4#		5#		6#	
台面 T 型槽宽度 Width of the T-slot mm	10	12		14		18		22	
台面 T 型槽相邻角度 Adjacent angle of table T-slot	90°	60°				45°			
蜗轮副转动比 Transmission ratio of the worm gear	1:90					1:120			
工作台圆周刻度 Graduation of the table	360°								
蜗轮每转所代表的转台度数 Rotating angle of table with one revolution of the worm	4°(1' per graduation)					3°(1' per graduation)			
游标量小示值 Minimum value of vernier	10"								
分度精度 Indexing accuracy	80"	60"							
工作台最大承载 Max.workload kgs	100	150	200	250	300	550	700	1250	2000
毛重 Gross Weight kg	21.5	31	44.5	76	145	238	377	855	1400
可配卡盘 MatchedChuck	K11125	K11160	K11200	K11250	K11325	K11400	K11500A	K11630A	K11630A

矩形电磁吸盘

Rectangular Electro-Magnetic Chucks; X11 Series

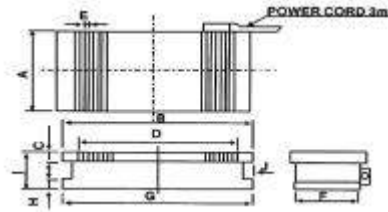

Force: 100N/CM²

Metric	Inch	主要尺寸 Dimension mm								额定电压 (DCV)	额定电流 (A)
		A	B	C	D	F	G	I	J		
X11 200×630	8"×25"	200	630	30	550	192	616	100	30	110	1
X11 250×500	10"×20"	250	500	22	400	244	494	95	30	110	1
X11 300×600	12"×24"	300	600	30	510	285	590	88	30	110	1.1
X11 300×800	12"×32"	300	800	30	730	296	795	116	12	110	1.46

矩形密极电磁吸盘

Rectangular Dense Magnetic-pole Chucks; XM11 Series

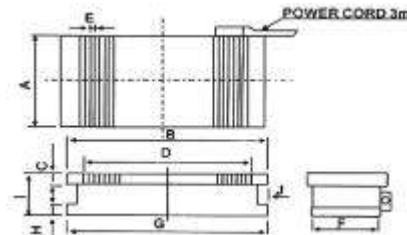

Force: 100N/CM²

Metric	Inch	主要尺寸 Dimension mm										额定电压 (DCV)	额定电流 (A)
		A	B	C	D	F	G	H	I	J			
XM11 250×500	10"×20"	250	500	22	400	244	494	20	95	30	110	1	
XM11 300×600	12"×24"	300	600	30	510	285	590	20	88	30	110	1.1	
XM11 300×800	12"×32"	300	800	30	730	296	795	20	116	12	110	1.8	

圆形电磁吸盘

Circular Electric Magnetic Chucks; X21 Series

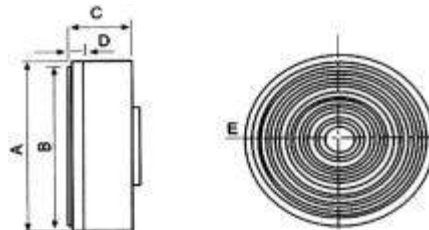

Metric	Inch	Dimension					额定电流 (A)	直流电压 (DCV)
		A	B	C	D	E		
X21 500	20"	510	500	100	25	12	1.8	110
X21 630	25"	650	630	130	30	14	1.7	110
X21 800	32"	810	800	180	35	13	2.5	110
X21 1000	40"	1060	1036	156	35	20	4.6	110

Magnetic Chucks

矩形永磁吸盘 Permanent Magnetic Chucks, Rectangular;
X41 Series;

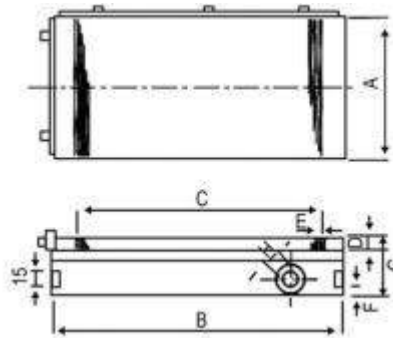

Force: 90N/CM²

Metric	Inch	主要尺寸 Dimension mm								净重
		A	B	C	D	E	F	G	H	N.W. (kg)
X41 125x250	5"x10"	125	250	204	20	4.8(1+3.8)	10	55	12	15
X41 150x150	6"x6"	150	150	104	20	4.8(1+3.8)	10	55	12	9.4
X41 150x300	6"x12"	150	300	254	20	4.8(1+3.8)	10	55	12	19
X41 150x350	6"x14"	150	350	304	20	4.8(1+3.8)	10	55	12	22

强力密极永磁吸盘 Powerful Dense Permanent Magnetic Chucks;
XM91 Series

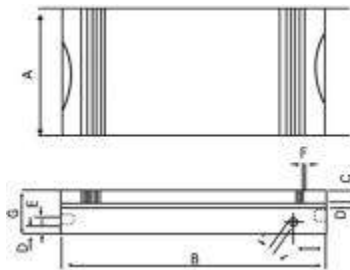

Force: 100N/CM²

Metric Model	Inch Model	主要尺寸 Dimension mm								净重
		A	B	C	D	E	F	G	I	N.W. (kg)
XM91 100x175	4"x7"	100	175	18	10	10	2(0.5+1.5)	53	12	7
XM91 125x250	5"x10"	125	250	18	10	10	2(0.5+1.5)	53	12	13
XM91 150x150	6"x6"	150	150	18	10	10	2(0.5+1.5)	53	12	9.4
XM91 150x300	6"x12"	150	300	18	10	10	2(0.5+1.5)	53	12	19

XM91 150×350	6"×14"	150	350	18	10	10	2(0.5+1.5)	53	12	22
---------------------	---------------	-----	-----	----	----	----	------------	----	----	----

Magnetic Chucks

圆形永磁吸盘

Circular Permanent Magnetic Chucks; X51 Series

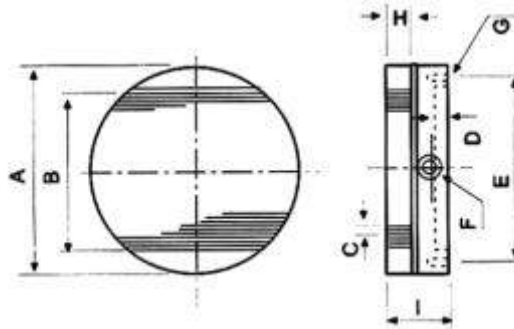
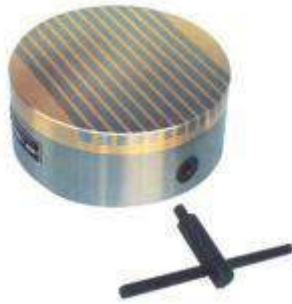

Metric Model	Inch Model	主要尺寸 Dimension mm								
		A	B	C	D	E	F	G	H	I
X51 125	5"	125	80	2.8(1+1.8)	2	112	10	M6	20	58
X51 160	6"	160	115	2.8(1+1.8)	2	140	10	M8	20	58
X51 200	8"	200	155	2.8(1+1.8)	2	180	10	M10	20	58
X51 250	10"	250	205	2.8(1+1.8)	2	224	10	M10	20	58
X51 300	12"	300	300	2.8(1+1.8)	2	260	10	M10	20	58

圆形密极永磁吸盘

Circular Dense Permanent Magnetic Chucks; XM51 Series

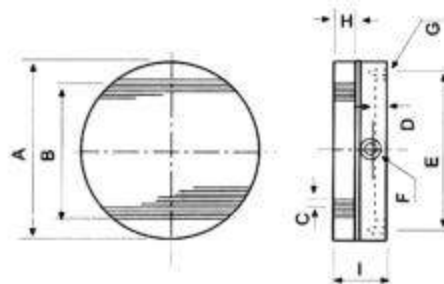
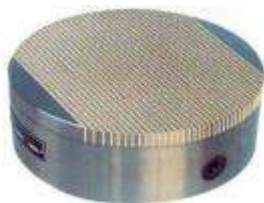

Metric	Inch	主要尺寸 Dimension mm								
		A	B	C	D	E	F	G	H	I
XM51 200	8"	200	155	2.5(1+1.5)	2	180	10	M10	20	58
XM51 300	12"	300	255	2.5(1+1.5)	2	260	10	M10	20	58
XM51 400	16"	400	355	2.5(1+1.5)	2	350	10	M10	20	58

XM51 500	20"	500	455	2.5(1+1.5)	2	440	10	M12	20	58
XM51 600	24"	600	555	2.5(1+1.5)	2	550	10	M12	20	58

白剛刀

HSS Tool Bits

圓形 Round



Size	Overall Length	Overall Length	Overall Length	Size	Overall Length	Overall Length	Overall Length
3.0	100	150	---	9.5	100	150	200
3.5	100	150	200	10.0	100	150	200
4.0	100	150	200	12.0	100	150	200
4.5	100	150	200	14.0	100	150	200
5.0	100	150	200	16.0	100	150	200
5.5	100	150	200	18.0	100	150	200
6.0	100	150	200	20.0	100	150	200
3.5	100	150	200	22.0	100	150	200
7.0	100	150	200	24.0	100	150	200

方形 Square



Size	Overall Length	Overall Length	Overall Length	Overall Length	Size	Overall Length	Overall Length	Overall Length	Overall Length
8	100	150	200	300	34	100	150	200	300
10	100	150	200	300	36	100	150	200	300
12	100	150	200	300	38	100	150	200	300
14	100	150	200	300	40	100	150	200	300
16	100	150	200	300	42	100	150	200	300
18	100	150	200	300	44	100	150	200	300
20	100	150	200	300	46	100	150	200	300
22	100	150	200	300	48	100	150	200	300
24	100	150	200	300	50	100	150	200	300

扁形 Flat



Size	Overall Length	Overall Length	Overall Length	Size	Overall Length	Overall Length	Overall Length
3x8	100	150	200	1/8 x 5/16	4"	6"	8"
5x8	100	150	200	3/16 x 5/16	4"	6"	8"
3x10	100	150	200	1/4 x 5/16	4"	6"	8"
6x10	100	150	200	1/8 x 3/8	4"	6"	8"
8x12	100	150	200	3/16 x 3/8	4"	6"	8"
10x12	100	150	200	1/4 x 3/8	4"	6"	8"
6x16	100	150	200	5/16 x 1/2	4"	6"	8"
8x16	100	150	200	3/8 x 1/2	4"	6"	8"
12x16	100	150	200	5/16 x 5/8	4"	6"	8"
6x20	100	14"	200	1/2 x 5/8	4"	6"	8"
8x20	100	16"	200	1/4 x 3/4	4"	6"	8"
10x20	100	17"	200	5/16 x 3/4	4"	6"	8"

梯形车刀 Parting Off Blades, Bevel type



size	size	size
3/32 x 3/8 x 4"	1/8 x 3/4 x 6	3/16 x 1 x 8
3/32 x 1/2 x 4"	1/8 x 7/8 x 5	1/4 x 3/4 x 6
1/8 x 3/8 x 5"	3/16 x 3/4 x 6	1/4 x 1 x 6
1/8 x 1/2 x 4-1/2"	3/16 x 1 x 6	1/4 x 3/4 x 8
1/8 x 5/8 x 6	3/16 x 3/4 x 8	1/4 x 1 x 8

Remarks:

All above with different HSS of M42,M35,M2,W4(4341), and 4241 for your choice .

Die Stocks

板牙铰手

Die Stocks Coated Zinc



C45

DIN225

Coated Zinc

Size	For Taps			Length
	Metric	UNC/UNF	Pipe	
16×5	M1 - M2.6	1/16 - 3/32		160
20×5	M3 - M4	1/8 - 5/32		200
20×7	M4.5 - M6	3/16 - 1/4		200
25×9	M7 - M9	5/16 - 3/8	G1/16	224
30×11	M10 - M11	3/8 - 7/16	G1/8	280
38×14	M12 - M14	1/2 - 9/16		315
45×18	M16 - M20	5/8 - 3/4		450
55×22	M22 - M24	7/8 - 1"		560
65×25	M27 - M36	1-1/8 - 1-3/8		630

中心钻

HSS Center Drills

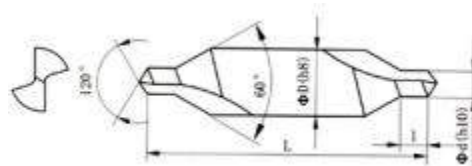

Dia 直径	Flute Length 沟长	Total Length 总长	Edge Number 刃数	Shank dia. 柄径
1.00	1.30	31.50	2	3.15
2.00	2.50	40.00	2	5.00
3.15	3.90	50.00	2	8.00
4.00	5.00	56.00	2	10.00
5.00	6.30	63.00	2	12.00

6.30	8.00	71.00	2	16.00
8.00	10.10	80.00	2	20.00
10.00	12.80	100.00	2	25.00

Tap Wrenches

丝锥铰手 Tap Wrenches



C45
DIN1814
Coated Zinc

Size	For Taps			Length
	Metric	UNC/UNF	Pipe	
0#	M1 - M8	1/16 - 5/16	-	125
1#	M3 - M10	1/8 - 3/8	-	180
1-1/2#	M3 - M12	1/8 - 1/2	G1/8	200
2#	M4 - M12	3/16 - 5/8	G1/8-G3/8	280
3#	M5 - M20	1/4 - 3/4	G1/8-G1/2	375
4#	M10 - M27	3/8 - 1"	G1/8-G3/4	500
5#	M14 - M33	5/8 - 1-1/4	G1/4-G1-11	750

棘轮铰手 Ratchet Tap Holders

Size	For Taps			Length
	Metric	Inch	Pipe	
1#	M3 - M10	1/8 - 3/8	-	85 mm
2#	M5 - M12	7/32 - 1/2	G1/8	100 mm
10#	M3 - M10	1/8 - 3/8		250 mm
20#	M5 - M12	7/32 - 1/2	G1/8	300 mm



T 型铰手 Type T Tap Wrenches



Size	For Taps		Length
	Metric	Inch	
1#	M3 - M8	1/8 - 5/16	70mm
2#	M5 - M10	7/32 - 3/8	80 mm
3#	M6 - M12	1/4 - 1/2	90 mm

Size			Standard	Material
Metric	UNC/UNF	BSW/BSF		
M3-M6	UNC/UNF No.4	BSW1/8	ISO2568	HSS Alloy Steel
	UNC/UNF No.12	BSW/BSF1/4	DIN352, 351 / 371, 376	
M7-M30	UNC/UNF 1/4	BSF1/4	ASME/ANSI B94.9	
	NC/UNF 1/8	BSW/BSF1-1/8	JIS	

直槽机用和手用丝锥 Straight Flute Machine & Hand Taps



M3 - M6



M7 - M30

Size			Standard	Material
Metric	UNC/UNF	BSW/BSF		
M3-M6	UNC/UNF No.4	BSW1/8	ISO2568	HSS Alloy Steel
	UNC/UNF No.12	BSW/BSF1/4	DIN371, 376	
M7-M30	UNC/UNF 1/4	BSF1/4	ASME/ANSI B94.9	
	UNC/UNF 1/8	BSW/BSF1-1/8	JIS	

螺尖机用丝锥 Spiral Point Machine Taps



M3 - M6



M7 - M30

螺旋槽机用丝锥

Spiral Flute Machine Taps



Size			Standard	Material
Metric	UNC/UNF	BSW/BSF		
M3-M6	UNC/UNF No.4	BSW1/8	ISO2568 DIN	HSS Alloy Steel
	UNC/UNF No.12	BSW/BSF1/4		
M7-M30	UNC/UNF 1/4	BSF1/4	ASME/ANSI B94.9 JIS	
	UNC/UNF 3/4	BSW/BSF3/4		

M3 - M6

M7 - M30

挤压丝锥

Forming Machine Taps



M3 - M6

M7 - M30

直管和锥管机用丝锥

Pipe Taps



Straight Pipe Tap

直管丝锥

Taper Pipe Tap

锥管丝锥

Size			Standard	Material
Metric	UNC/UNF	BSW/BSF		
M3-M6	UNC/UNF No.4	BSW1/8	ISO2568 DIN371, 376	HSS Alloy Steel
	UNC/UNF No.12	BSW/BSF1/4		
M7-M30	UNC/UNF 1/4	BSF1/4	ASME/ANSI B94.9 JIS	
	UNC/UNF 1/8	BSW/BSF1-1/8		

Size	Standard	Material
G1/8×28--G3"×8	ISO2568 DIN5156, DIN5157 ASME/ANSI B94.9 JIS	HSS
Rc1/8×28--Rc3"×8		
NPT1/8×27--NPT3"×8		



机用和手用圆板牙

Round Dies



开口调节式圆板牙

Adjustable Round Dies

Size			Outside	Standard	Material
Metric	UNC/UNF	BSW/BSF			
M3-M6	UNC/UNF No.4	BSW 1/8	19×5mm-19×7mm 22×9mm-60×25mm 60×25mm-85×36mm	ISO DIN ASME/ANSI B94.9 JIS	HSS Alloy Steel
	UNC/UNF No.12	BSW/BSF 1/4			
M7-M30	UNC/UNF 1/4	BSF 1/4			
	UNC/UNF 1-1/8	BSW/BSF 1-1/8			



六方板牙

Hex Dies

Size			Outside	Standard	Material
Metric	UNC/UNF	BSW/BSF			
M3-M6	UNC/UNF No.4	BSW 1/8	12×3mm-16×5mm 20×5mm-20×7mm	ISO DIN ASME/ANSI B94.9 JIS	HSS Alloy Steel
	UNC/UNF No.12	BSW/BSF 1/4			
M7-M30	UNC/UNF 1/4	BSF 1/4	25×9mm-65×25mm 65×18mm-150×36mm		
	UNC/UNF 1-1/8	BSW/BSF 1-1/8			



Size			Outside	Standard	Material
Metric	UNC/UNF	BSW/BSF			
M3-M6	UNC/UNF No.4	BSW 1/8	13/16"-1"	ISO DIN ASME/ANSI B94.9 JIS	HSS Alloy Steel
	UNC/UNF No.12	BSW/BSF 1/4	13/16"-1"		
M7-M30	UNC/UNF 1/4	BSF 1/4	1"-2-1/2"		
	UNC/UNF 1-1/8	BSW/BSF 1-1/8	2-1/2"-3"		