

16AWG Red Exposed length 700mm 250 Buckle female terminal
 18AWG Yellow-green Exposed length 700mm inner hole φ5.2 Ground terminal
 16AWG Black Exposed length 700mm 250 Buckle female terminal

A	283
B	110
C	45
D	103.5
E	35
F	140
G	700

Technical Specifications:

1. Voltage: DC180V
2. Power: 1.5HP
3. Steering: CW
4. No load current: $\leq 1.0A$ Speed = $4600 \pm 5\%$ rpm
5. Rated current: 7.5A Speed = $4000 \pm 8\%$ rpm
6. Pressure resistance: AC1500V/3mA/1s
7. Hole number of photoelectric coded disk: 36 holes

Annex:

1. Light sensing bracket 1PC
2. M4×8 Screw (With flat washer and spring washer) 2PCS

General dimensional tolerance:

0.5 to 6.0	± 0.10
6.0 to 30	± 0.30
30 to 120	± 0.50
Angle	$\pm 1^\circ$
圆角和倒角	0.50

 Guangdong G-motor Health Technology Co., Ltd

Product name	DC treadmill motor				
Model	GC103				
Drawer		Reviewer		Approval	

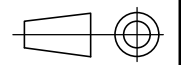

Date	2017-12-18
Unit	mm
1	1
	A0

标记	变更前内容	变更后内容	签名	日期
----	-------	-------	----	----