

HSF

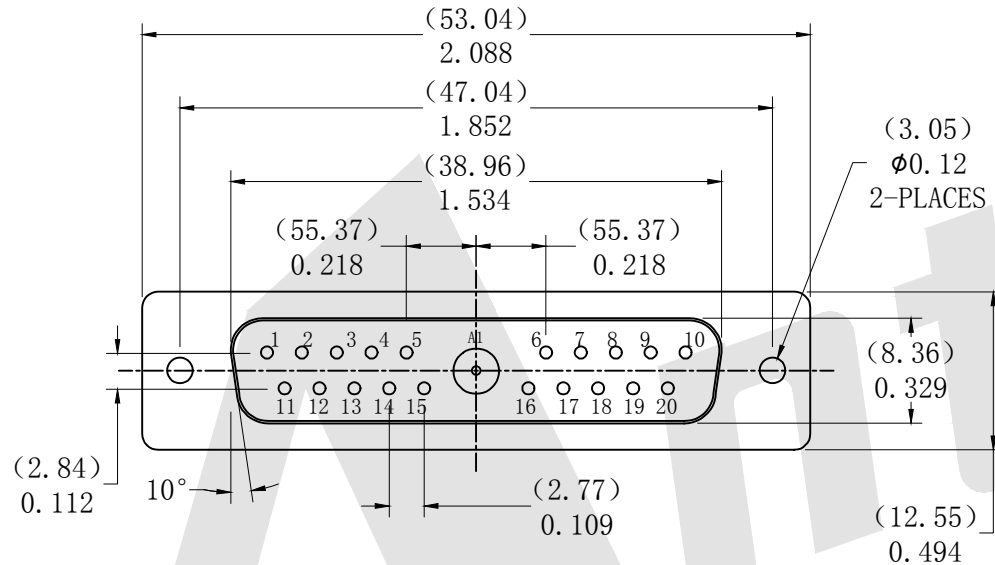

NOTE:  
SIGNAL AND POWER CONTACTS  
COME PRE-LOADED INTO INSULATORS

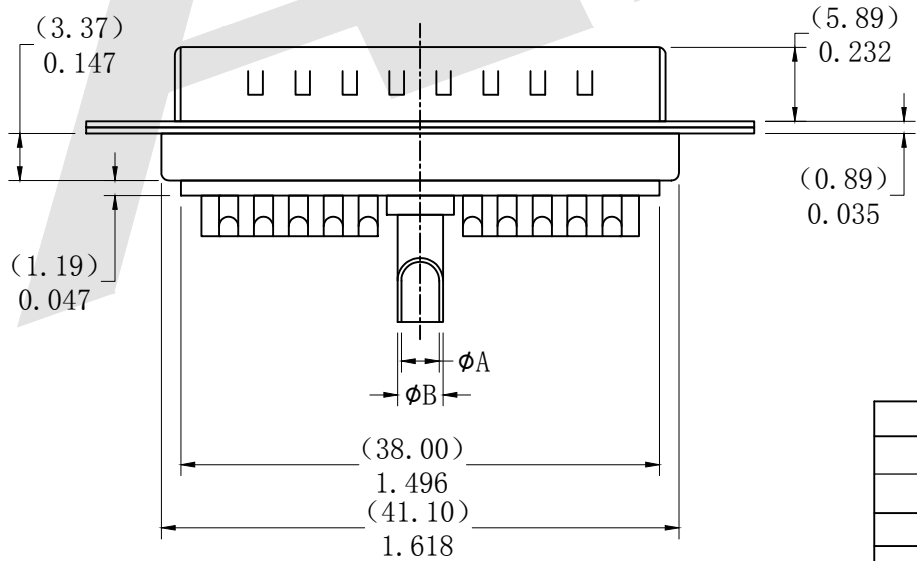
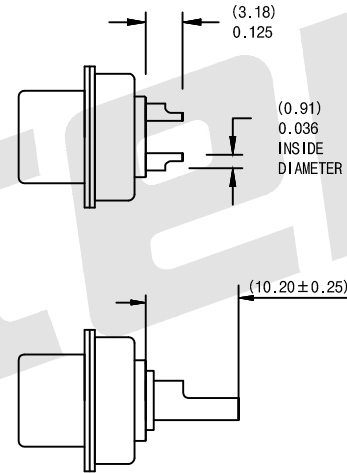

40 AMPS	Ø4.6	Ø5.5
30 AMPS	Ø3.4	Ø4.4
20 AMPS	Ø2.6	Ø3.6
10 AMPS	Ø1.75	Ø2.54
Current Rating	ØA	ØB
	Dimension	

**SPECIFICATIONS:**

**ELECTRICAL:**  
 INSULATOR RESISTANCE: 5,000 MegOHMS Min.  
 DIELECTRIC WITHSTANDING: 1,000 VAC r. m. s.  
 OPERATING TEMPERATURE: -55°C ~ +125°C  
 CONTACT RESISTANCE: 30 MILLIOHMS Max.  
 POWER PINS: SEE PART No. BELOW  
 SIGNAL PINS: 3AMPS  
**MECHANICAL:**  
 CONTACT INSERTION FORCE: 4.5kg Max  
 CONTACT SEPARATOR FORCE: 0.3kg Min  
**MATERIALS:**  
 CONTACTS: BRASS  
 INSULATOR: PBT UL94V-0 RATED, 230°C PROCESS TEMP.  
**SHELL:** STEEL  
**FINISH:** NICKEL

Ordering Code:

PDB21W1 -M -G0 -B -20  
 ① ② ③ ④ ⑤

- ① Series
- ② Contact Type:  
M:Male F:Female
- ③ Contact NO.:  
G0: Gold flash G1: 3u" Gold  
G2: 5u" Gold G3: 10u" Gold  
G4: 15u" Gold G5: 30u" Gold
- ④ Insulation Color Code:  
B:Black L:Blue  
W:White
- ⑤ Power AMP:  
10 = 10AMPS; 20 = 20AMPS;  
30 = 30AMPS; 40 = 40AMPS;

Unless Otherwise specified tolerance  
 X. ±0.35 X.XX: ±0.20  
 X.X: ±0.25 X.XXX: ±0.15



SCALE: As Shown	UNIT: mm
DRAW Lv Xun Hua	DATE 27/05/2019
CHECK BobYang	DATE 27/05/2019

TITLE:	POWER D-SUB 21W1 SOLDER CUP-MALE
DRAWING NO:	PDB21W1-MXXX
PRODUCT NO:	PDB21W1-MXXX



REV	DESCRIPTION	DATE