

3D VIEW

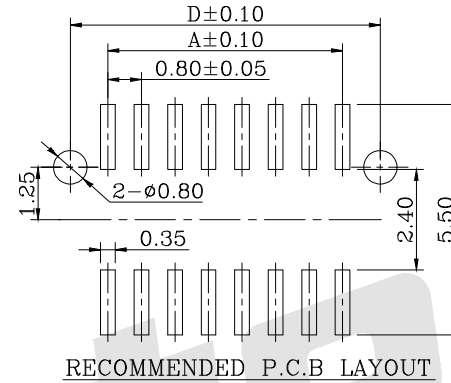
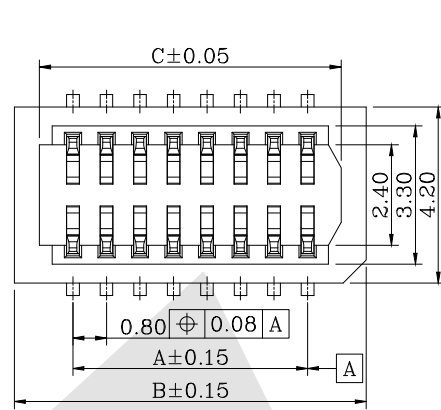

RECOMMENDED P.C.B LAYOUT

- 1: Specif tition
- a.1 Current rating:0.5A AC/DC
 - a.2 Voieage rating:50v AC/DC
 - a.3 Contact resistance:20m milliohms max
 - a.4 Cnsulation Resistance:100Mega ohmsmin
 - a.5 Wiehstandingvoltage:500vAC/minute
 - a.6 Temperature range:-25° cto+80° c
- 2.Materialand plating
- b.1 Cnsulator:pa9t. piastic (ul94v-0)
 - b.2 Contact:Brass
 - b.3 Finsh:Gola plated

Ordering Code:

BB0.8 - F - $\frac{X}{1}$ - $\frac{X}{2}$ - $\frac{X}{3}$ - $\frac{X}{4}$ - $\frac{X}{5}$ - $\frac{X}{6}$ - $\frac{X}{7}$

CIRCUITS	DIM A	DIM B	DIM C	DIM D
2x5	3.20	6.00	4.80	5.00
2x6	4.00	6.80	5.60	5.80
2x7	4.80	7.60	6.40	5.60
2x8	5.60	8.40	7.20	7.40
2x9	6.40	9.20	8.00	8.20
2x10	7.20	10.00	8.80	9.00
2x11	8.00	10.80	9.60	9.80
2x12	8.80	11.60	10.40	10.60
2x13	9.60	12.40	11.20	11.40
2x14	10.40	13.20	12.00	12.20
2x15	11.20	14.00	12.80	13.00
2x16	12.00	14.80	13.60	13.80
2x17	12.80	15.60	14.40	14.60
2x18	13.60	16.40	15.20	15.40
2x19	14.40	17.20	16.00	16.20
2x20	15.20	18.00	16.80	17.00
2x21	16.00	18.80	17.60	17.80
2x22	16.80	19.60	18.40	18.60
2x23	17.60	20.40	19.20	19.40
2x24	18.40	21.20	20.00	20.20
2x25	19.20	22.00	20.80	21.00

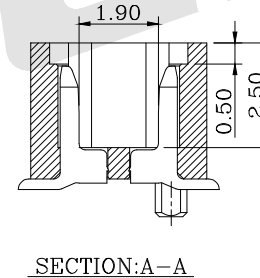
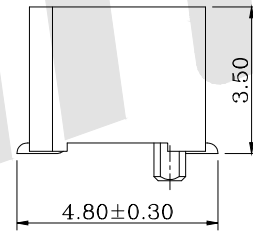
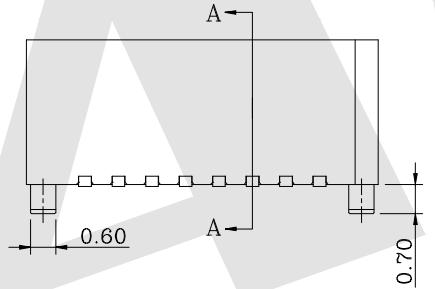

SECTION:A-A

- ① Series NO:
0.8mm Board to Board connector
- ② M:Male F:Female
- ③ mating Height:
H:4.5=4.50mm
H:5.0=5.00mm
- ④ NO. of contacts:
see table
For example
24:24poles
- ⑤ Contact Plating
G0: Gold flash
G1: 3u" Gold
G2: 5u" Gold
G3: 10u" Gold
G4: 15u" Gold
G5: 30u" Gold
SN: Tin
- ⑥ Packing
T:Tube A:Tray
B:Bag U:Tube+CAP
R:tape&Reel
W:tape&Reel+CAP
- ⑦ serial number: 01

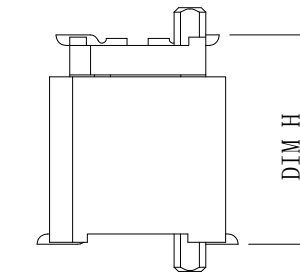
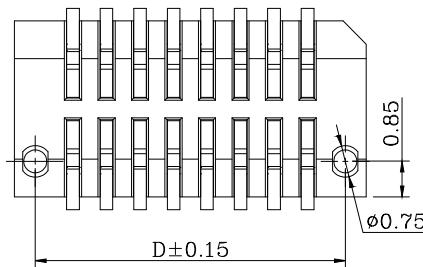

MATING HEIGHT:4.50mm

Unless Otherwise specified tolerance
X. ±0.35 X.XX:±0.20
X.X:±0.25 X.XXX:±0.15

SCALE: As Shown	UNIT: mm
DRAW Mo Guo Xuan	DATE 12/11/2018
CHECK BobYang	DATE 12/11/2018

 ANTENK ELECTRONICS CO.,LTD
Http://www.antenk.com
E-mail:sales@antenk.com

TITLE: 0.8mm Board to Board connector, female, mating Height=4.5~5.0mm

DRAWING NO: BB0.8F-XXXX01

PRODUCT NO: BB0.8F-XXXX01



3rd ANGLE PROJECTION

REV	DESCRIPTION	DATE