

220 HP

SD22F

King of the Forest

- ▶ Engine model: Cummins NT855-C280S10
- ▶ Net power: 162 kW/220HP/1800 rpm
- ▶ Operating weight: 24.7 t

Product features

The SD22F forest type bulldozer is specially designed for operations in wooded areas. The SD22F has advanced performance, high reliability, low fuel consumption and convenient maintenance. It's equipped with a ROPS canopy and cab, a wider track (610 mm) and a mechanical winch. The SD22F has excellent maneuverability and self-rescue capabilities. The SD22F easily adapts to logging, stacking, hauling and transporting work in wooded areas.



shantui e-shop

SHANTUI

VALUE THAT WORKS

Shantui Construction Machinery Co., Ltd.

ADDRESS:
No. 58, G327 Highway
Jining City, Shandong, CHINA

TEL: +86-537-2909369
FAX: +86-537-2311219
EMAIL: trade@shantui.com







220 HP

SD22F

Technical specifications:

Blade Type	Straight-tilt
Min. ground clearance:	405 mm
Ground pressure:	0.066 MPa
Minimum turning radius:	3.3 m
Gradeability:	30°
Track gauge:	2000 mm

SD22F

	ENGINE	Model & type	Cummins NT855-C280S10; In-line, water-cooled 4-cycle, overhead valve direct injection, turbocharged diesel			
		Horsepower	Gross power: 175/235/1800 kW/HP/rpm // Net power: 162/220/1800 kW/HP/rpm			
		Number of cylinders	6-139.7 x 152.4 mm (bore x stroke)			
		Piston displacement	14.01 L			
		Min. fuel consumption	205 g/kW-h			
		Maximum torque	1030 N-m@1250rpm			
	POWER TRANSMISSION SYSTEM	Torque converter	3-element, 1 stage, 1 phase			
		Transmission	Planetary gear, multi-disc clutch, power shift, forced lubrication			
		Main drive	Spiral bevel gear, splash lubrication, single-stage speed reduction			
		Steering clutch	Wet, multi-disc, spring loaded, hydraulically separated, hydraulic control			
		Steering brake	Wet, floating band, foot brake with hydraulic booster			
		Final drive	2-stage speed reduction of spur gear, splash lubrication			
	TRAVEL SPEED	Gear	1st	2nd	3rd	
		Forward	0~3.6 km/h	0~6.5 km/h	0~11.2 km/h	
		Reverse	0~4.3 km/h	0~7.7 km/h	0~13.2 km/h	
		Type		Swing type of sprayed beam, suspended structure of equalizer bar		
	UNDERCARRIAGE SYSTEM	Carrier rollers	2 each side			
		Track rollers	6 each side			
		Track type	Assembled, single-grouser			
		Width of track shoes	610 mm			
		Pitch	216 mm			
	HYDRAULIC SYSTEM	Maximum pressure	14 MPa			
		Pump type	Gear pump			
		Discharge	262 L/min			
		Bore of working cylinder × no.	120 mm × 2			
	BLADE	Blade type	Straight-tilt	Angle	U-blade	Semi-U-blade
		Dozing capacity	6.4 m³	4.7 m³	7.5 m³	7.0 m³
		Efficiency (Theoretical value 40 m)	330 m³/h	245 m³/h	365 m³/h	365 m³/h
		Blade width	3725 mm	4365 mm	3800 mm	3725 mm
		Blade height	1315 mm	1055 mm	1343 mm	1374 mm
		Maximum drop below ground	540 mm	535 mm	540 mm	540 mm
		Lifting height of blade	1210 mm	1290 mm	1210 mm	1210 mm
		Weight of blade	2830 kg	3254 kg	3419 kg	3419 kg
	WINCH (OPTIONAL)	Model	TJM20/200 kN			
		Drawing force of full drum	220 kN			
		Drawing speed of full drum	15.9 m/min			
		Drawing force of bare drum	350 kN			
		Overall dimension (l x w x h)	1683 x 1364 x 1365 mm			
		Cable dimension	28 x 7000 mm			
Weight of winch	3000 kg					

OVERALL DIMENSIONS Straight-tilt blade

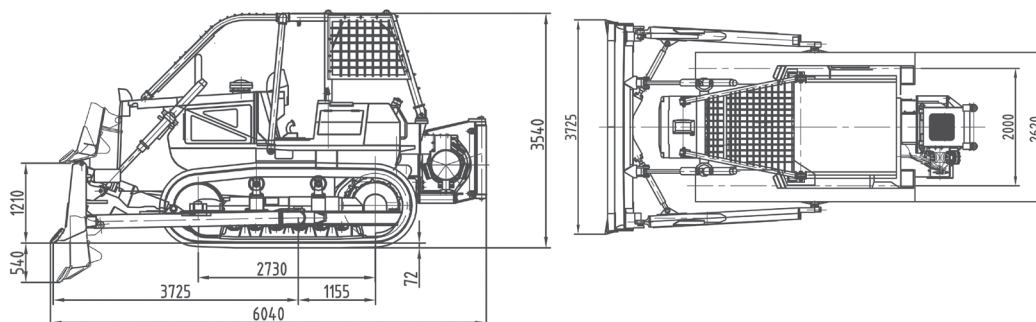

▶ THE SPECIFICATIONS ARE SUBJECT TO CHANGE WITHOUT NOTICE. THE PICTURES MAY INCLUDE OPTIONS. THE ACTUAL COLOR & APPEARANCE OF THE PRODUCT MAY DIFFER FROM WHAT IS SHOWN.