

160 HP

SD16C

King of Coal

- ▶ Engine model: Shangchai SC11CB184G2B1/Weichai WD10G178E25
- ▶ Net power: 120 kW/160HP/1850 rpm
- ▶ Operating weight: 16.8 t

Product features

Powered by Shangchai or Weichai engines and featuring advanced technology to get your coal handling jobs done, the 16.8-ton SD16C features a hydraulic drive system with hydraulic control technology and comes equipped with a 3900 x 1200 U-blade.



shantui e-shop

SHANTUI

VALUE THAT WORKS

Shantui Construction Machinery Co., Ltd.

ADDRESS:
No. 58, G327 Highway
Jining City, Shandong, CHINA

TEL: +86-537-2909369
FAX: +86-537-2311219
EMAIL: trade@shantui.com







160 HP

SD16C

Technical specifications:

Blade Type	Coal blade
Minimum ground clearance:	400 mm
Ground pressure:	0.056 MPa
Minimum turning radius:	4.466 m
Gradeability:	30°
Track gauge:	1880 mm

SD16C

	ENGINE	Model & type	Shanghai SC11CB184G2B1/Weichai WD10G178E25; water-cooled, in-line, 4-stroke direct injection		
		Horsepower	Gross power: 131/175/1850 kW/HP/rpm // Net power: 120/160/1850 kW/HP/rpm		
		Number of cylinders	6-126 x 130 mm (bore x stroke)		
		Piston displacement	9.726 L		
		Min. fuel consumption	214 g/kW-h		
		Maximum torque	765 N-m@1300 rpm		
	POWER TRANSMISSION SYSTEM	Torque converter	3-element, 1 stage, 1 phase		
		Transmission	Planetary gear type, power-shift, forced lubrication		
		Main drive	Spiral bevel gear, single-stage speed reduction, splash lubrication		
		Steering clutch	Wet, multi-disc, spring loaded, hand hydraulically separated, inter-linking with steering brake		
		Steering brake	Wet, floating band structure, foot brake with hydraulic booster		
		Final drive	2-stage speed reduction of spur gear, splash lubrication		
	TRAVEL SPEED	Gear	1st	2nd	3rd
		Forward	0~3.29 km/h	0~5.82 km/h	0~9.63 km/h
		Reverse	0~4.28 km/h	0~7.59 km/h	0~12.53 km/h
	UNDERCARRIAGE SYSTEM	Type	Sprayed beam, suspended structure of equalizer		
		Carrier rollers	2 each side		
		Track rollers	6 each side		
		Track type	Assembled, single-grouser		
		Width of track shoes	610 mm		
		Pitch	203.2 mm		
	HYDRAULIC SYSTEM	Maximum pressure	14 MPa		
		Pump type	Gear pump		
		Discharge	243 L/min		
		Bore of working cylinder × no.	110 mm × 2		
	BLADE	Blade type	Coal blade		
		Dozing capacity	6.04 m ³		
		Efficiency (Theoretical value 40 m)	250 m ³ /h		
		Blade width	3900 mm		
		Blade height	1200 mm		
		Maximum drop below ground	540 mm		
		Lifting height of blade	1095 mm		
	RIPPER (OPTIONAL)	Maximum digging depth of 3-shank ripper	572 mm		
		Maximum lift above ground	592 mm		
		Weight of 3-shank ripper	1709 kg		

OVERALL DIMENSIONS Coal blade

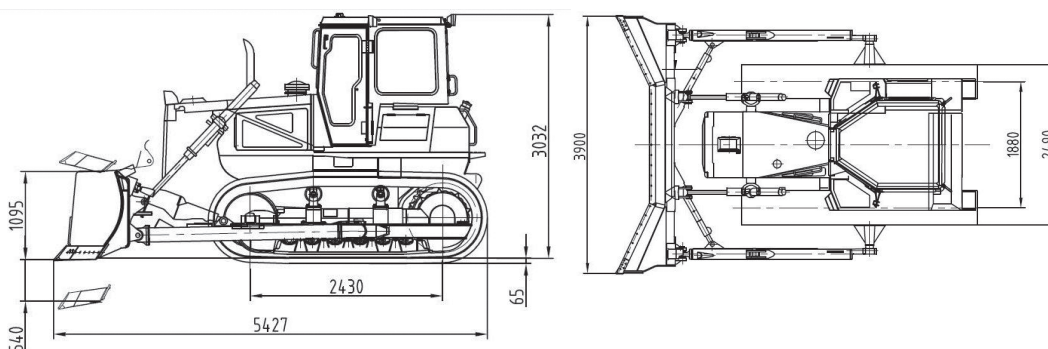

▶ THE SPECIFICATIONS ARE SUBJECT TO CHANGE WITHOUT NOTICE. THE PICTURES MAY INCLUDE OPTIONS. THE ACTUAL COLOR & APPEARANCE OF THE PRODUCT MAY DIFFER FROM WHAT IS SHOWN.