

TANDEM ROLLER

# SR13D

A big workhorse for top surface pavement treatment

- ▶ Engine model: Cummins 4BTAA3.9-C
- ▶ Rated power: 93 kW/2200 rpm
- ▶ Operating weight: 13.0 t

### Product features

This workhorse comes standard with an Dongfeng Cummins 4BTAA3.9-C non electric controlled diesel engine. It features a modular design that is highly conducive for easy access repairs and maintenance. Its articulated frame and static amplitude characteristics provide a great deal of stable operations. It also has a high-frequency (50 Hz) vibratory design built into it for excellent use on thin layers. The machine sports a three-stage vibration-reduction system and a well-sealed cabin for optimal operator comfort.



# SHANTUI

VALUE THAT WORKS

Shantui Construction Machinery Co., Ltd.

ADDRESS:

No. 58, G327 Highway  
Jining City, Shandong, CHINA

TEL: +86-537-2909351 2909368 2909369

FAX: +86-537-2311219

EMAIL: trade@shantui.com

TANDEM ROLLER

# SR13D

Technical specifications:

Overall length: 5775 mm

Minimum turning radius: 3870/6000 mm

Overall width: 2225 mm

Steering angle (Grad): ±23°

Overall height: 3135 mm

Oscillating angle (Grad): ±12°

SR13D

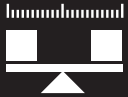
	WEIGHT AND DIMENSIONS	Weights	Operating weight	13000 kg
			Axle load, drum	6500 kg
			Axle load, wheel	6500 kg
			Static linear load (at drum)	300/300 N/cm
		Drum and tires	Maximum working width	2130 mm
			Drum diameter	1250 mm
Drum shell thickness	20 mm			

	VIBRATORY SYSTEM	Frequency	High amplitude	50 Hz
			Low amplitude	50 Hz
		Nominal amplitude	High	0.66 mm
			Low	0.36 mm
		Centrifugal force	Maximum	160 kN
			Minimum	86 kN

	DRIVE TRAIN	Forward speed	I	0~10km/h
		Reverse speed	I	0~10 km/h
		Maxium climbing ability	30%	
		Drive system	Hydrostatic	

	POWER TRAIN	Make & model	Cummins 4BTAA3.9-C	
		Type	Turbocharged	
		Fuel capacity	300 L	
		Cool	Water	
		Number of cylinders	4-105X120	
		Rated power	93 kW	
		Rated speed	2200 rpm	

	CABIN & CONTROLS	Brakes	Service brake	Hydrostatic
			Parking brake	Hydrostatic
		Steering	Steering system	Oscillating, articulating
			Steering method	Hydrostatic

OVERALL DIMENSIONS

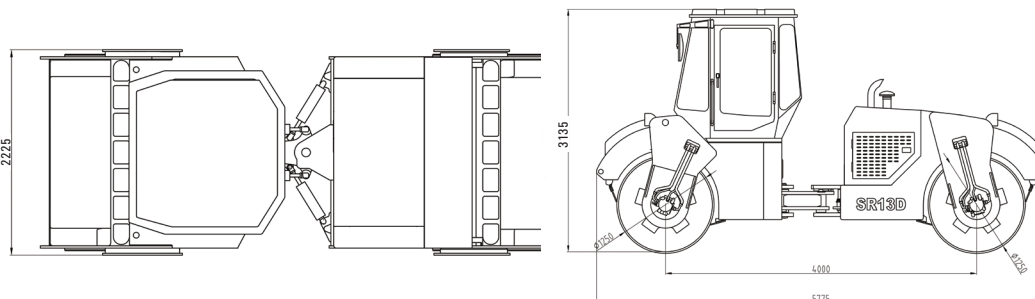

▶ THE SPECIFICATIONS ARE SUBJECT TO CHANGE WITHOUT NOTICE. THE PICTURES MAY INCLUDE OPTIONS. THE ACTUAL COLOR & APPEARANCE OF THE PRODUCT MAY DIFFER FROM WHAT IS SHOWN.