

FY 液下泵

FYW 污水液下泵

Series FY Vertical Submerged Pump

Series FYW Vertical Sewage Submerged Pump



● 公司简介 Enterprise Profile

石家庄翔浩机械有限公司，是以矿山、电力用渣浆泵、脱硫泵、疏浚泵、清水泵为主的工业水泵专业生产企业，集研发、设计、制造、营销、服务为一体，具有严格的质量保证及科学完善的服务体系。

公司技术力量雄厚，拥有资深的水泵设计、制造、应用工程师团队，立足持续为用户带来更大价值，不断提高服务水平与质量。我们不单单向用户提供产品，还可依据客户的工矿需求，采用系统一体化的设计方法，为客户提供渣浆输送的一整套解决方案，使得用户在环保、节能、运营持久、降低产品使用成本等方面取得了显著效果。

公司坚持“技术创新化、管理严格化、生产定制化、服务专业化”的经营理念，全力提升企业现代化管理水平，使企业实现了持续快速发展。

公司的主要产品为ZGB、ZJ、AH、HH、M型渣浆泵、WN型挖泥泵、TL型脱硫泵、G型砂砾泵、SP型液下泵、HDSN型双吸泵、WQ型潜污泵、IS型清水泵、FY污水泵等，广泛应用于环境保护工程、污水处理、城市工厂给排水、各种水利工程、冶金、矿山、电力、煤炭、疏浚、采砂、石油化工、建材、火电烟气脱硫等等诸多领域。国内市场占有率逐年递增，国际市场的占有份额不断提升，产品出口至东南亚、北美、欧洲、中亚、东亚等多个国家和地区。

长期以来，本公司坚持“诚信为本、客户至上”的原则，与众多厂家建立了长期合作关系，并赢得了广大客户的一致好评！

坚信凭借我们更优的产品，完善的服务，良好的信誉，必将赢得更多用户！

Shijiazhuang Soarho Machinery CO.,LTD, is a professional manufacture base of slurry pump, mine pump, FGD pump, dredge pump and clean water pump, combining scientific research, design, manufacture, marketing and service in one, with strict quality control system and science complete service system.

Having strong technical force, the company which has a senior pump design, manufacturing and application engineer team, continues to improves level and quality of service in order to bring greater value to the users. We not only provide products to users, but also provide a complete solution for slurry transportation for user to achieve a significant effect in environmental protection , energy saving , lasting trouble-free operation and cost reduction and so on, adopting a systematic and integrated design method and according to the working condition and the needing of user.

Adhering to the concept of 'technical innovation', 'strict management', 'customized production' and 'professional service', we strive to improve the modern management level and make the enterprises achieve sustained and rapid development.

The main products of the company are ZGB,ZJ,AH,HH,M slurry pumps ,WN dredge pumps , TL FGD pumps, G gravel pumps, SP sump pumps, HDSN double suction pumps. WQ submersible sewage pumps, IS clean water pumps ,FY submerged pumps and so on. They are widely used in many fields, such as environmental protection engineering, sewage treatment, municipal factory and water supply and drainage, various water conservancy projects, metallurgy, mine, electric power, coal, dredging, sand mining, petrochemical, building materials, thermal power flue gas desulfurization etc. The share of domestic market is increasing year by year, and the share of the international market is increasing. Products exported to Southeast Asia, North America, Europe, Central Asia, East Asia and many other countries and regions.

For a long time, adhering to the principle of "honesty and customer first", our company has established a long-term cooperative relationship with many manufacturers, and has won the praise of the customers.

Firmly believe that we will win more users by virtue of our better products, perfect service and good reputation.

● 产品介绍 Product Introduction

FY、FYW 系列液下泵属单级单吸立式耐腐蚀离心泵，是我公司的一种成熟、完善的产品。该产品结构合理，性能稳定，目前已有 100 多种规格。

FY 型液下泵用于输送不含固体颗粒及不易结晶的介质，FYW 型为污水液下泵，叶轮形式有开式、半开式、闭式及旋流式等，可输送有颗粒及杂质的污水，广泛适用于化工、石油、冶金、工程施工部门的集水坑污水排送或其它介质的输送。

FY, FYW series submerged pumps are single-stage, single-suction vertical anticorrosive centrifugal pump, which is a mature and perfect product of our company. This product structure is reasonable, performance is stable, at present already had more than 100 specifications

FY series submerged pump is applied for pumping the liquid that is not contained solid granules and uneasily crystallized. FYW series is a sewage submerged pump, its impeller takes shape of opening, semi-opening, close or torque flow type etc., available to pumping sewage with granules and impurity, being applied broadly on sewage or other liquid from pits of chemical industry, petroleum, metallurgical department and construction department.

● 性能范围 Range of Performance

流量 Capacity: 1.8 ~ 14400m³/h

扬程 Head: 8 ~ 100m

工作温度 Operating temperature: -20℃ ~ 105℃

● 型号说明 Model Code

80 FY (W) - 38 A

泵叶轮外径经一次切割，流量、扬程降低

Diameter of impeller through once cutting, its capacity and head will be degraded.

泵扬程 38m

Head 38m

FY 型为普通液下泵，FYW 为污水液下泵

FY --- Vertical submerged pump

FYW----Sewage vertical submerged pump

泵吸入口通径为 80mm

Suction Diameter 80mm

● 产品特点 Product Feature

该系列泵叶轮浸没在介质中，进口不需装底阀及抽真空设备，就能启动工作，泵占地面积小，轴封无泄漏。

泵主要零件有泵体、叶轮、泵盖、轴、接管、出液管，轴承架、轴承盒、轴承套等。液上轴承为滚动轴承，分别承受轴向力和径向力。液下轴承为滑动轴承（导轴承），保证轴的 对中性 和承受径向力。详见泵结构图。

结构图 1 用于: 25 FY-16, 50FYW-14

结构图 2 用于: 25FY-25, 25FY-41, 40FY-16, 40FY-26, 40FY-40, 40FY-65, 50FYW-10, 50FY-16, 50FY-25, 50FY-63, 50FY-80, 50FY-100, 65FYW-10, 65FY-16, 65FYW-16, 65FY-20, 65FY-25, 65FYW-25, 65FY-40, 65FY-64, 65FY-80, 65FY-125, 80FY-15, 80FY-20, 80FY-24, 80FY-32, 80FY-38, 80FYW-38, 80FY-60, 80FYW-60, 100FY-20, 100FY-23, 100FY-37, 100FYW-37, 100FY-57, 125FY-20

结构图 3 用于: 40FYW-8, 40FYW-30, 40FYW-40, 50FYW-30, 50FYW-40, 50FY-40, 65FYW-40

结构图 4 用于: 150FYW-30, 150FY-35, 150FY-56, 200FY-30, 200FY-34

结构图 5 用于: 100FY-32, 125FY-32, 125FY-50, 150FY-22, 150FYW-22, 200FY-21, 300FY-14

结构图 6 用于: 80FY-97, 80FY-125, 100FY-80, 125FY-74, 150FY-80, 200FY-50, 200FY-63, 250FY-39, 250FY-60, 300FY-16, 300FY-32, 300FY-52, 350FY-39

结构图 7 用于: 100FYW-22, 100FYW-23, 100FYW-24

对于液下深度较深的泵，都设有中间导轴承，并且轴由几段轴通过刚性联轴器而接成一条长轴。中间导轴承润滑采用自润滑方式(FY 型)或外接润滑液方式(FYW 型)。因泵轴向尺寸较长，考虑到尺寸累计误差较大，为保证叶轮和泵体的流道对中，泵转子轴向位置可利用轴承套处的两个圆螺母进行调整，而对于结构图 3 和结构图 4 的泵，轴向位置只能通过加减纸垫的方法进行调整。

本系列泵有两种转向，详见泵上的转向牌。本系列泵进口一般情况下不装吸入管，而直接从泵体进口抽液体。如果液面变化很大，并且每次起动时都能保证介质浸过叶轮，这时可考虑在泵进口加装吸入管，这样同样能达到需要的抽吸深度，而相对缩短了泵轴、接管及出液管的长度，有利于提高泵的可靠性，使泵运转平稳、寿命长，并且泵成本也可大大降低（这种结构不适用于要求随时启动的工况）。

The pump impeller is submerged completely into the liquid, the pump can start work without foot valve and vacuum-making equipment, and the pump accommodates a small area, none leakage in shaft seal.

The main parts of pump are pump casing, impeller, pump cover, shaft, joint-pipe, liquid-discharging pipe, bearing seat, bearing box, bearing sleeve etc. the bearing up liquid is ball-bearing, undertaking axial force and radial force respectively. The bearing submerged is sliding bearing (guide bush), which guarantees the alignment to the center and bearing radial force. Seeing pump structure chart in details.

Chart 1 for: 25 FY-16, 50FYW-14

Chart 2 for: 25FY-25, 25FY-41, 40FY-16, 40FY-26, 40FY-40, 40FY-65, 50FYW-10, 50FY-16,

50FY-25, 50FY-63, 50FY-80, 50FY-100, 65FYW-10, 65FY-16, 65FYW-16, 65FY-20, 65FY-25, 65FYW-25, 65FY-40, 65FY-64, 65FY-80, 65FY-125, 80FY-15, 80FY-20, 80FY-24, 80FY-32, 80FY-38, 80FYW-38, 80FY-60, 80FYW-60, 100FY-20, 100FY-23, 100FY-37, 100FYW-37, 100FY-57, 125FY-20

Chart 3 for: 40FYW-8, 40FYW-30, 40FYW-40, 50FYW-30, 50FY-40, 50FYW-40, 65FYW-40

Chart 4 for: 150FYW-30, 150FY-35, 150FY-56, 200FY-30, 200FY-34

Chart 5 for: 100FY-32, 125FY-32, 125FY-50, 150FY-22, 150FYW-22, 200FY-21, 300FY-14

Chart 6 for: 80FY-97, 80FY-125, 100FY-80, 125FY-74, 150FY-80, 200FY-50, 200FY-63, 250FY-39,

250FY-60, 300FY-16, 300FY-32, 300FY-52, 350FY-39

Chart 7 for: 100FYW-22, 100FYW-23, 100FYW-24

There has set up a middle guide bearing for submerged depth deeply, and through steel coupling to connect several shafts to be a long shaft. The lubrication of middle guide bearing adopts self-lubricating type (FY series) or with an outside flush pipe for lubricant (FYW series). For the size of shaft is longer, considering the error accumulated by sizes, for guarantee of alignment to the center of flowing way of impeller and pump casing, the axial position of pump rotor can be adjusted by turning two round nuts on the bearing sleeve, the axial position can only adjusted by adding up or deducting paper pad for chart 3 and chart 4.

There are two rotations in this series, seeing the label of rotation on the pump.

The suction of the pump of this series is not equipped with sucking pipe in general, and directly suck the liquid from tank (or pool). If the level of liquid is much changeable, and needing guaranteeing liquid to submerge over impeller each time of start, then it is advisable to equip with a sucking pipe in the suction of pump, by doing so, it can reach the depth of pumping required, and relatively shorten the length of pump shaft, joint-pipe and liquid-discharging pipe, that will raise the reliability of the pump, making it operate smoothly and longer life time, and what is more, the cost of pump will be decreased greatly (this structure is not adapted to the condition of starting work at any time required).

● 泵用材质 **Materials of Pump**

根据输送介质不同，液下触液零件将采用不同的材质，常用材质有 HT200、ZG25、1Cr18Ni9、1Cr18Ni12Mo2Ti、304、316、316L 等材质，液下导轴承采用填充四氟乙烯、石墨、青铜等材质，并且还可根据用户要求采用其它耐腐蚀材质。

According to the different liquid, it is to adopt different material for the making of the submerged parts which contact with liquid. The common use materials are casting iron, carbon steel, 1Cr18Ni9, 1Cr18Ni12Mo2Ti, 304, 316, 316L etc., the submerged guide bush adopts PTFE, graphite and bronze, and being available to application of other materials resistant to erosion according to the demand of users.

● 结构图 Construction description

泵结构图 1 Structure Chart 1

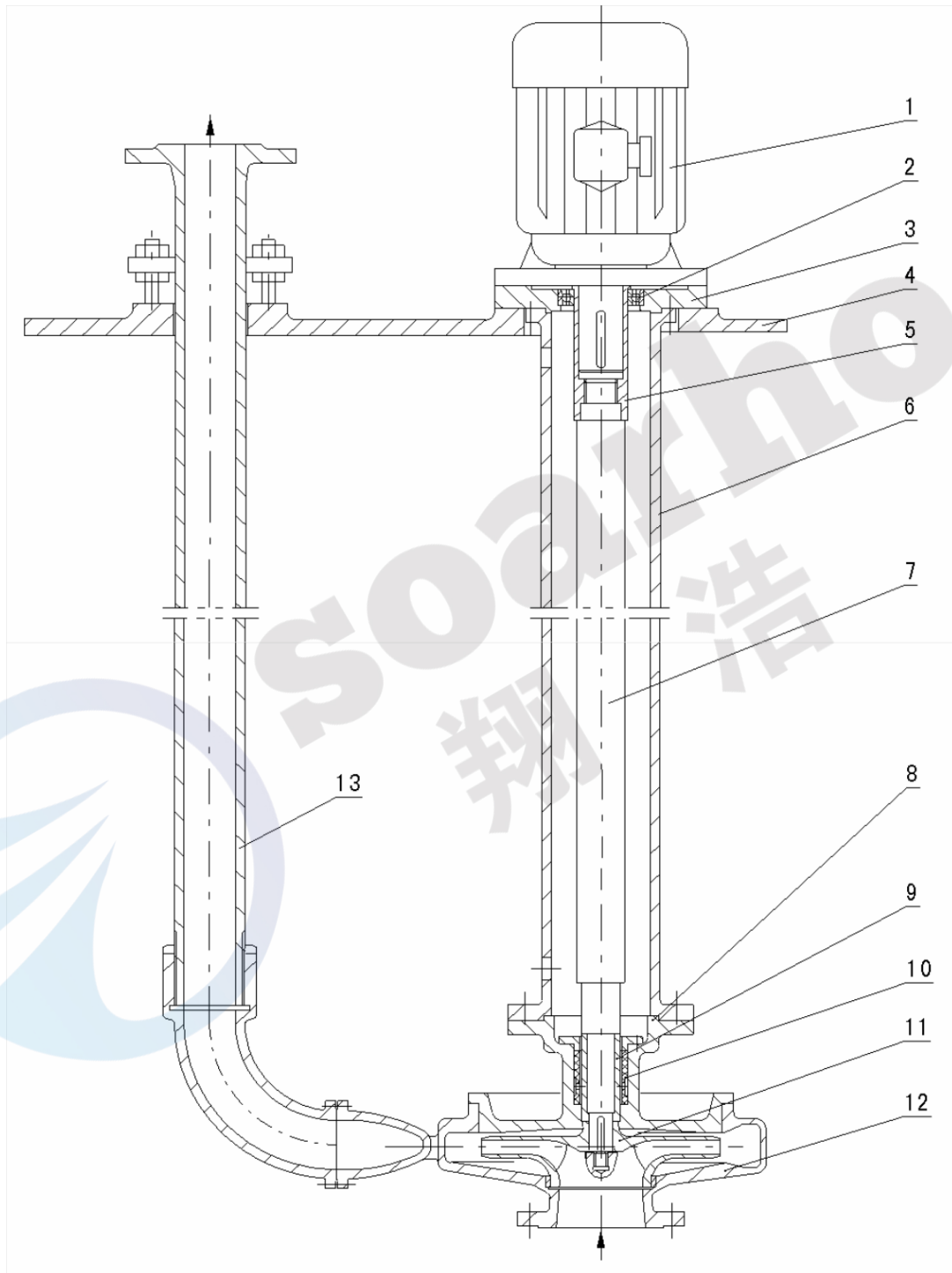

- | | | | |
|---------------------------|-------------------------------|---------------------|------------------|
| 1. 电机 Motor | 2. 轴承 Bearing | 3. 轴承座 Bearing seat | 4. 底座 Baseplate |
| 5. 连轴套 Joint-shaft sleeve | 6. 接管 Joint-pipe | 7. 轴 Shaft | 8. 泵盖 Pump cover |
| 9. 下轴套 Lower shaft sleeve | 10. 导轴承 Guide bush | 11. 叶轮 Impeller | |
| 12. 泵体 Pump casing | 13. 出液管 Liquid-discharge pipe | | |

泵结构图 2 Structure Chart 2

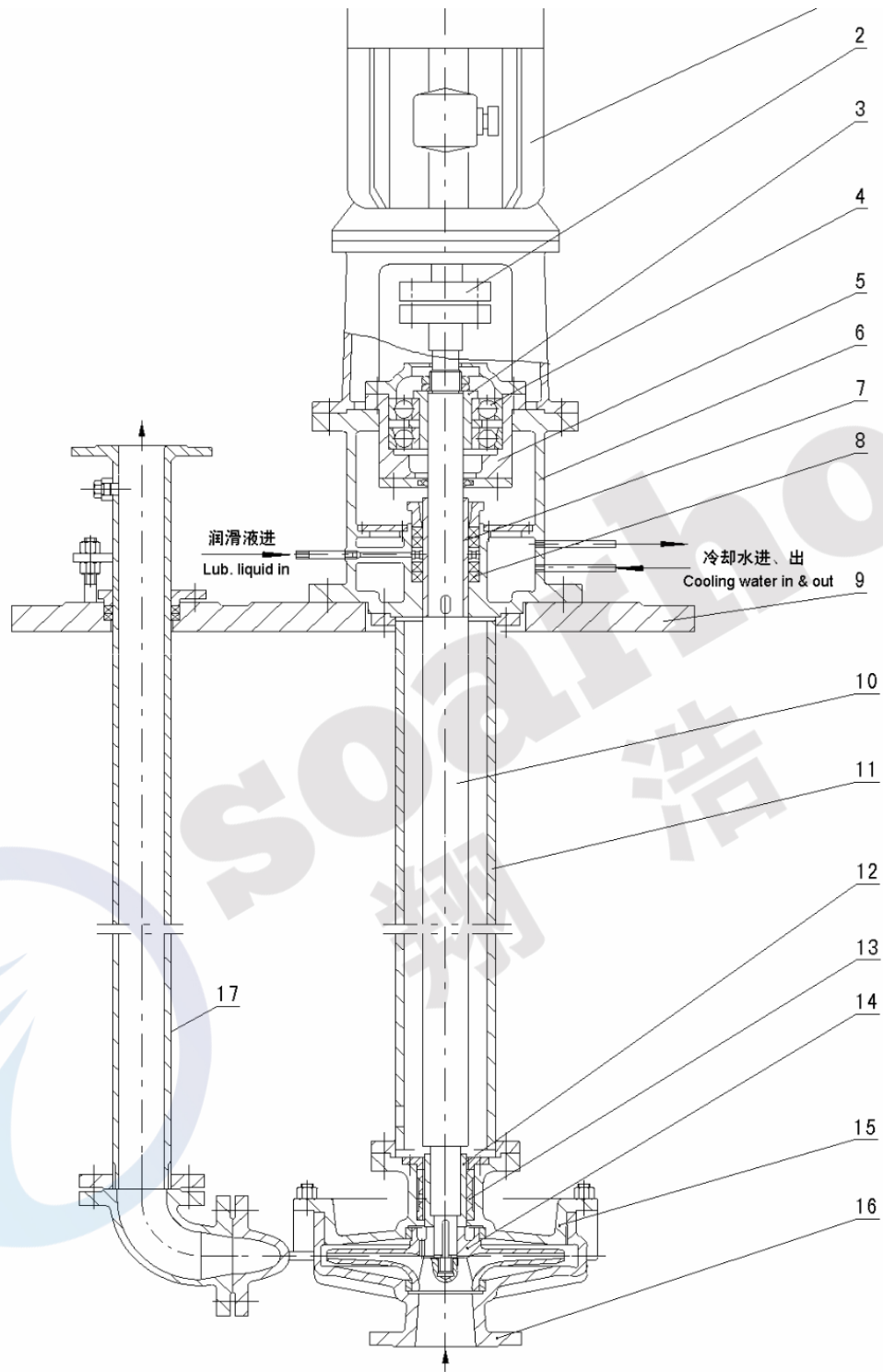

- | | | | |
|------------------------------|--------------------|--------------------------|---------------------------|
| 1.电机 Motor | 2.联轴器 Coupling | 3.轴承套 Bearing sleeve | 4.轴承 Bearing |
| 5.轴承盒 Bearing box | 6.轴承座 Bearing Seat | 7.上轴套 Upper shaft sleeve | 8.填料 Stuffing |
| 9.底座 Baseplate | 10.轴 Shaft | 11.接管 Joint-pipe | 12.下轴套 Lower shaft sleeve |
| 13.导轴承 Guide bush | 14.叶轮 Impeller | 15.泵盖 Pump cover | 16.泵体 Pump casing |
| 17.出液管 Liquid-discharge pipe | | | |

泵结构图 3 Structure Chart 3

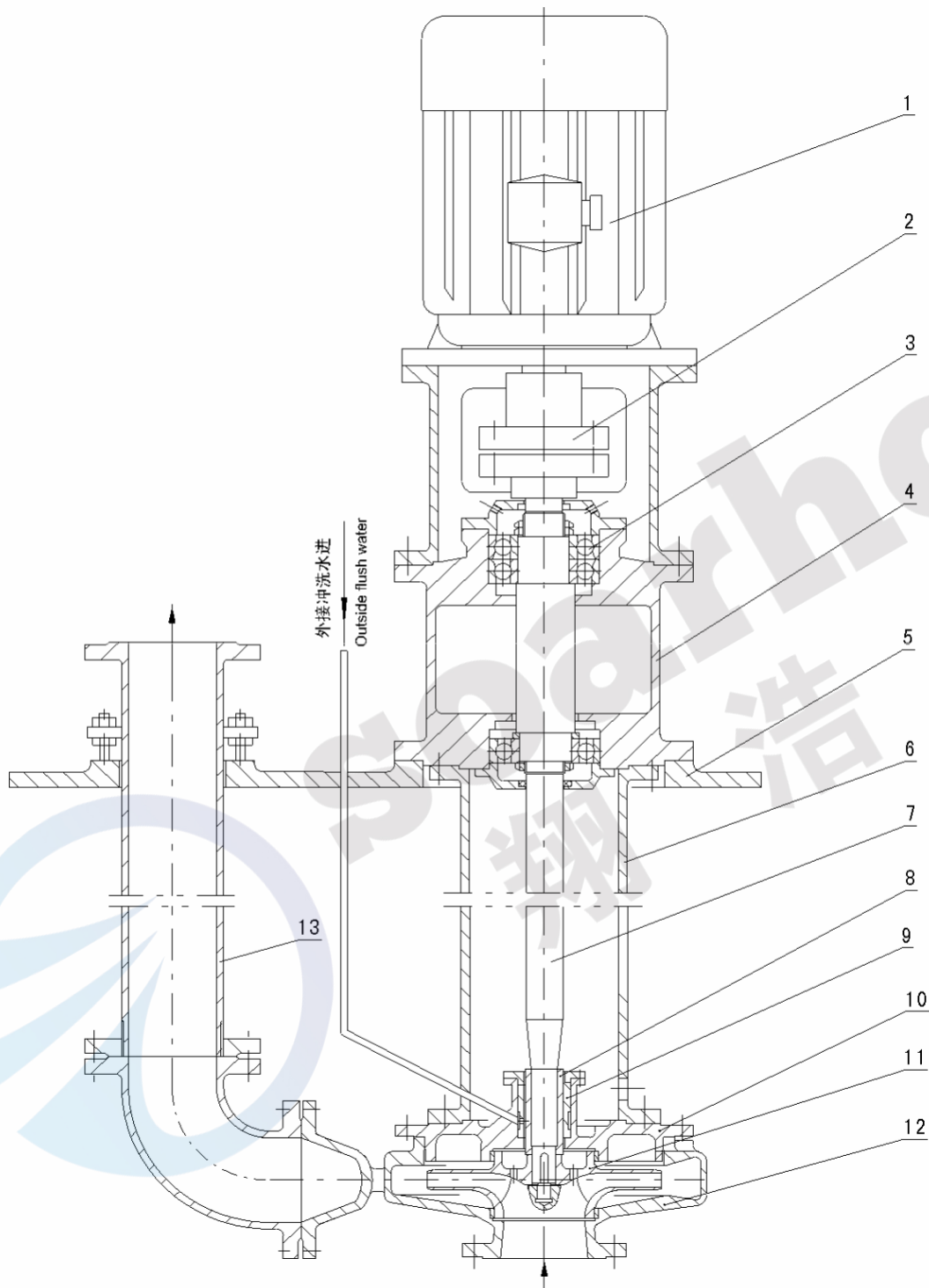

- | | | | |
|-------------------------------|-------------------|-----------------|---------------------------|
| 1. 电机 Motor | 2. 联轴器 Coupling | 3. 轴承 Bearing | 4. 轴承座 Bearing seat |
| 5. 底座 Baseplate | 6. 接管 Joint-pipe | 7. 轴 Shaft | 8. 下轴套 Lower shaft sleeve |
| 9. 导轴承 Guide bush | 10. 泵盖 Pump cover | 11. 叶轮 Impeller | 12. 泵体 Pump casing |
| 13. 出液管 Liquid-discharge pipe | | | |

泵结构图 4

Structure Chart 4

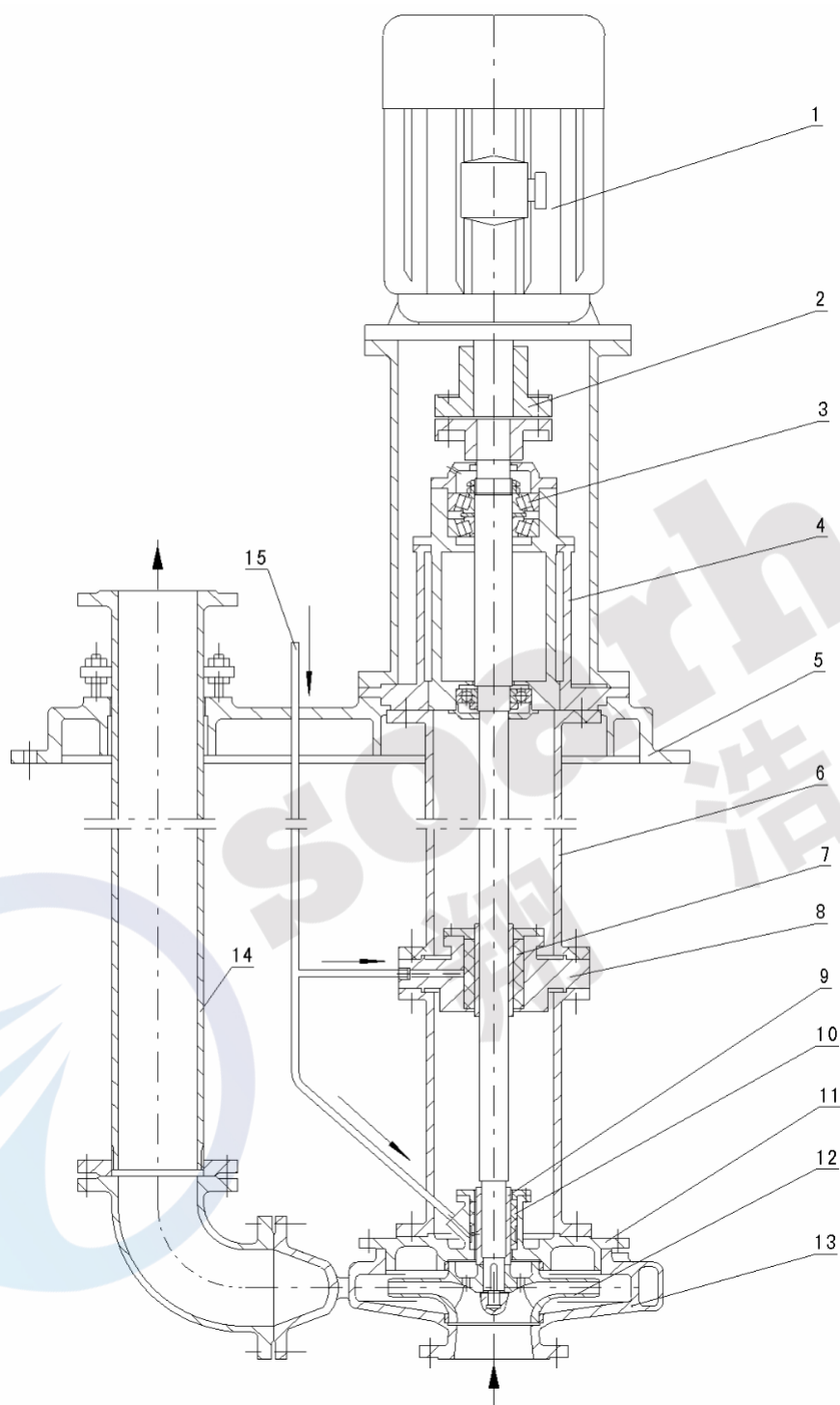

1. 电机 Motor

2. 联轴器 Coupling

3. 轴承 Bearing

4. 轴承从支座 Bearing seat

5. 底座 Baseplate

6. 接管 Joint-pipe

7. 中间导轴承 Medium guide bush

8. 导轴承座 Guide bush seat

9. 下轴套 Lower shaft sleeve

10. 导轴承 Guide bush

11. 泵盖 Pump cover

12. 叶轮 Impeller

13. 泵体 Pump casing

14. 出液管 Liquid-discharge pipe

15. 外部冲洗液管 Outside flush pipe

泵结构图 5 Structure Chart 5

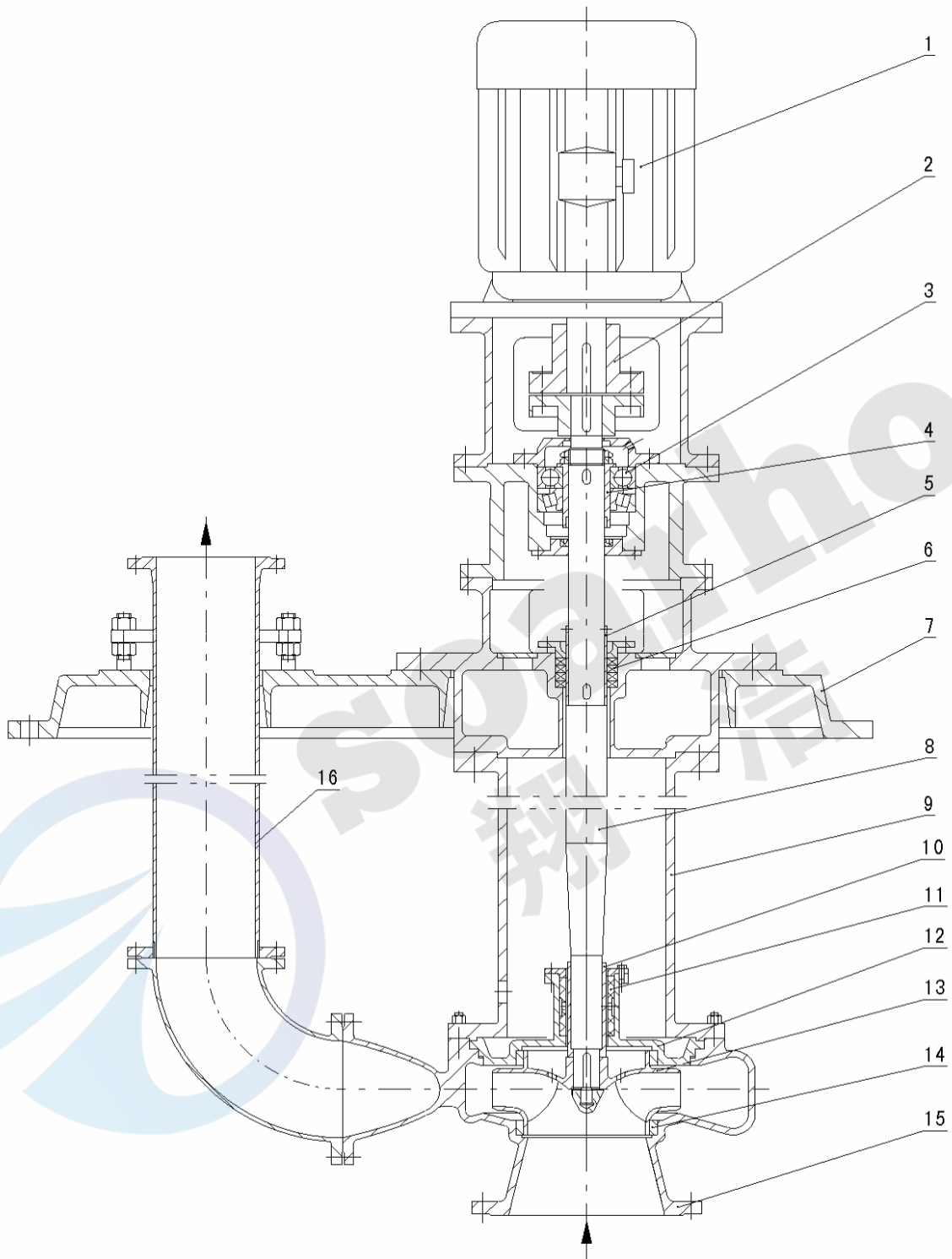

- | | | | |
|---------------------------|-------------------------------|--------------------|-----------------------|
| 1. 电机 Motor | 2. 联轴器 Coupling | 3. 轴承 Bearing | 4. 轴承套 Bearing sleeve |
| 5. 上轴套 Upper shaft sleeve | 6. 填料 Stuffing | 7. 底座 Baseplate | 8. 轴 Shaft |
| 9. 接管 Joint-pipe | 10. 下轴套 Lower shaft sleeve | 11. 导轴承 Guide bush | |
| 12. 泵盖 Pump cover | 13. 叶轮 Impeller | 14. 密封环 Seal ring | |
| 15. 泵体 Pump casing | 16. 出液管 Liquid-discharge pipe | | |

泵结构图 6 Structure Chart 6

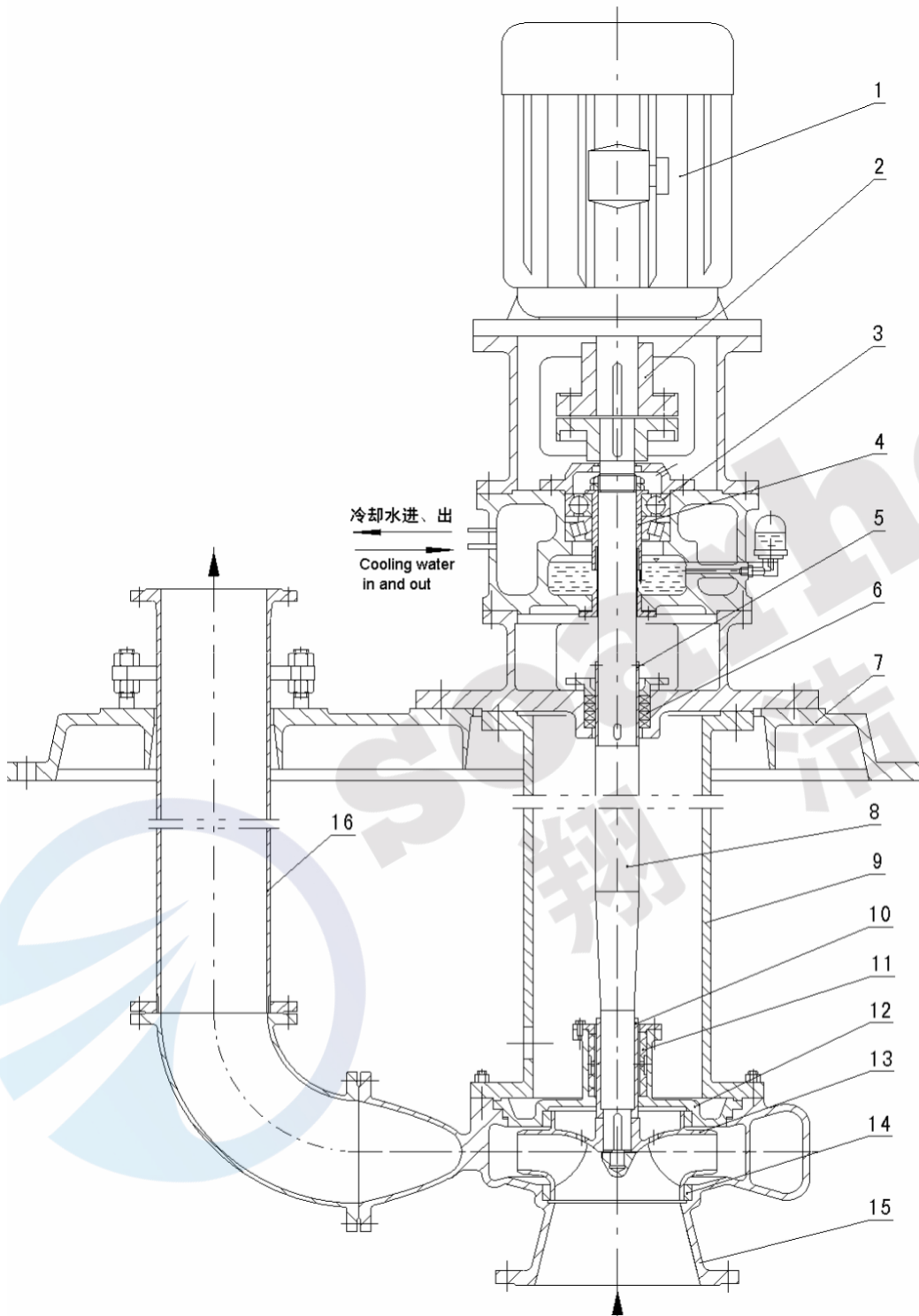

- | | | | |
|---------------------------|--------------------|-------------------------------|-----------------------|
| 1. 电机 Motor | 2. 联轴器 Coupling | 3. 轴承 Bearing | 4. 轴承套 Bearing sleeve |
| 5. 上轴套 Upper shaft sleeve | 6. 填料 Stuffing | 7. 底座 Baseplate | |
| 8. 轴 Shaft | 9. 接管 Joint-pipe | 10. 下轴套 Lower shaft sleeve | |
| 11. 导轴承 Guide bush | 12. 泵盖 Pump cover | 13. 叶轮 Impeller | |
| 14. 密封环 Seal ring | 15. 泵体 Pump casing | 16. 出液管 Liquid-discharge pipe | |

泵结构图 7 Structure Chart 7

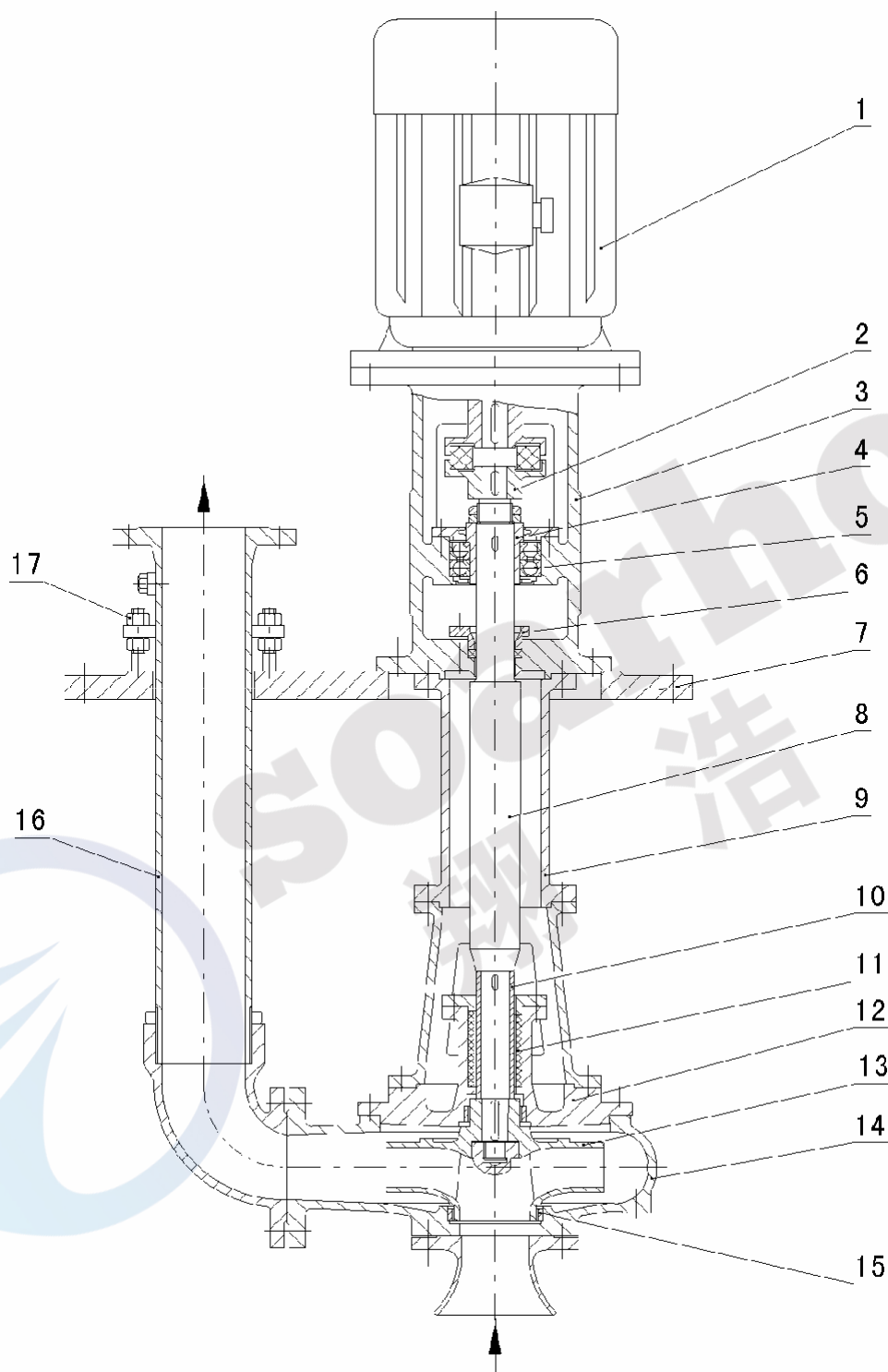

- | | | | |
|------------------|------------------------------|--------------------|----------------------|
| 1.电机 Motor | 2.联轴器 Coupling | 3.轴承座 Bearing seat | 4.轴承套 Bearing sleeve |
| 5.轴承 Bearing | 6.填料压盖 Stuffing gland | 7.底座 Baseplate | 8.轴 Shaft |
| 9.接管 Joint-pipe | 10.下轴套 Lower shaft sleeve | 11.导轴承 Guide bush | |
| 12.泵盖 Pump cover | 13.叶轮 Impeller | 14.泵体 Pump casing | |
| 15.密封环 Seal ring | 16.出液管 Liquid-discharge pipe | 17.固定螺栓 Set bolts | |

● 安装说明 Description of Installation

1. 由于液下泵轴较长，轴对中的好坏将直接影响泵的运行，因此，泵出口法兰不能承受较大的外力和外力矩，否则它将拉弯泵接管而损害泵的良好运行和可靠性，常常引起：a. 振动超过正常值；b. 转子静止时难于用手转动转子。因此，外部管路系统要以泵出液管法兰面为基准进行安装，并且不能随意调整泵底座上的出液管定位螺栓(参见第 30 页)。

2. 部份液下泵的轴承座下部都设有冷却夹套，装有两根短管（一根进水，一根出水），可视输送介质的温度高低酌情通入冷却水（见结构图 2）。在这两根冷却水管的对面有一根润滑液管，用于润滑、冷却填料盘根，润滑液可用清洁水或其它清洁介质，如输送的介质忌与水混合，则不能用水做润滑液，应以与输送介质相容的介质。使用时仅需通入很少量的润滑液。如果输送的介质温度不高，也可不通入润滑液，这时应采用浸油石棉盘根，并且放松填料压盖螺栓，在使用过程中还应经常检查该部位温度。

3. 对于 FYW 型污水液下泵，一般需外接冲洗、润滑液，冲洗液下导轴承，以保证导轴承正常工作及使用寿命，冲洗液流量 $0.3\sim 0.6\text{m}^3/\text{h}$ ，压力 $0.2\sim 0.4\text{Mpa}$ ，开机前必须先通入冲洗液，才能开机。FY 型泵一般采用自润滑方式，不需外接冲洗液。

4. 对于 FY 型液下泵，如果介质含有少量杂质、颗粒时，应在泵进口装滤网。对于半开式、开式叶轮的 FYW 型泵，进口可不装滤网，闭式叶轮的 FYW 型泵，进口也应装滤网。

5. 泵出水管路中，一般应装压力表、闸阀、止回阀，并且压力表应装在泵出口法兰与闸阀之间，以便于观察及控制泵出口压力。

6. 为方便大修时向上吊起泵组，泵组上方应留有足够的空间并且在泵出口应装有一个易拆卸的弯管。

1. For the shaft of submerged pump is longer, the alignment to the center of the shaft is vital important to operation of the pump. Therefore, the bigger external forces and moments are not allowed to act the discharge nozzle. Otherwise it will cause the joint-pipe curved and damage the operation and reliability of the pump, and often causing: a) vibration exceeding the normal value; b) when rotor is stillness, it is difficult to turn the rotor by hand. Therefore, the pipe system on the outside shall be installed on the basis of flange surface of liquid-discharging pipe, and it is not permitted to adjust the set bolts that fixed on the pump baseplate for fixing the liquid-discharging pipe (see page30).

2. For some pumps, there set up cooling pipe in the lower part of bearing seat, equipped with two short pipes (one for inlet and one for outlet), it is advisable to convey cooling water according to temperature of the pumping liquid (seeing chart 2). There is a pipe of lubricant on the opposite of two cooling pipes, which is for lubrication and cooling the stuffing. The lubricant can use clear water or other

clear liquid, in case that the liquid by pumping cannot mix with water, then water cannot be used as lubricant, and using other liquid that is compatible to the liquid by pumping, it needs a little lubricant only when pump running. If the temperature of the liquid by pumping is not high enough, then it is not necessary to fill in lubricant, then it is to adopt a soaked-oil asbestos stuffing, and slacken the nut of stuffing gland, and frequently checking the temperature in that part.

3. For FYW series sewage submerge pump, it is necessary to connect flush lubricant for flushing guide bearing submerged, so to guarantee a regular operation of the guide bearing and its life time. The flush liquid flow $0.3\sim 0.6\text{m}^3/\text{h}$, pressure $0.2\sim 0.4\text{MPa}$, before operation it is necessary to fill in flush liquid, then starting the pump. FY series pump adopts the way of self-lubrication generally, so not necessary to connect lubricant pipe from the outside.

4. For FY series submerged pump, if the liquid contains a little granules and impurity, it should equip with a strainer. For semi-opening, opening impeller FYW series pump, the suction don't need to fix a strainer; as for closed impeller FYW series pump, it is better to fix a strainer in the inlet.

5. In the pipe of outlet of the pump, it is usually to fix pressure meter, gate valve, check valve, and the pressure meter should be fixed in the place between the flange of liquid-discharging pipe and the gate valve, in order to control and observe the pressure on the outlet of the pump.

6. It is necessary to leave enough space over the pump unit and fix an elbow pipe (easy disassembly) in the discharge of pump for hoisting the pump unit in the period of major overhaul.

● 使用说明 Description of Use

1. 使用前的准备

- a. 检查泵的转向是否与泵上转向牌所示方向一致。
- b. 用手转动联轴器，感觉应松紧均匀，无卡擦现象。
- c. 检查润滑油情况，大部份泵采用钙基润滑脂润滑，只有 80FY-97, 80FY-125, 100FY-80, 125FY-74, 150FY-80, 200FY-50, 200FY-63, 250FY-39, 250FY-60, 300FY-16, 300FY-32, 300FY-52, 350FY-39 采用 N32 号机械油润滑。加油方法见附 1。
- d. 检查出水管闸阀、压力表安装是否正确，并将旋塞闭上（如果泵上装有这些附件）

2. 起动与停止

- a. 准备工作完成后，启动电动机，打开压力表旋塞，并通过调节出口闸阀开度使泵在规定 范围内运行，同时，注意观察电机电流，确保电机在额定电流内运行，否则将造成泵超负荷运行以至烧坏电机。
- b. 当要停止水泵时，先慢慢关闭出水管路闸阀，再停止电动机，然后关闭压力表旋塞。

1. Preparation before use

- a) Check the direction of rotation of the pump whether it is in conformity with the direction of rotation signed in the label.
- b) Turn the coupling by hand, the feeling should be smooth and even, and without friction phenomenon.
- c) Check lubricant oil, most pumps adopt Ca-base grease for lubrication, only 80FY-97, 80FY-125, 100FY-80, 125FY-74, 150FY-80, 200FY-50, 200FY-63, 250FY-39, 250FY-60, 300FY-16, 300FY-32, 300FY-52, 350FY-39 adopt N32 mechanical oil, and the method of adding up oil is in the addition 1.
- d) Check to see if the installations of the gate valve and pressure meter are correct, and close the cock (if the pump fixes these accessories).

2. Starting and stop.

- a) After preparation is completed, start the motor and the cock of the pressure meter, it should get through regulation opening degree to make the pump running within the range ruled. At the same time, observe the electric current of motor, ensuring that the motor is running within the rate electric current. Otherwise it will cause the pump running in an over-loaded condition that shall damage the motor.
- b) When the pump will be stopped, slowly close the gate valve, and stop the motor, then close the cock of the pressure meter.

● 运转及维护保养 Operation and Maintenance

- a) 泵只允许在规定的参数范围内运转。
 - b) 注意泵轴承温度不应超过环境温度 35℃，最高温度不应大于 80℃。
 - c) 经 2000 小时，更换轴承盒内的润滑脂。以稀油润滑的泵，在第一个月内，经 100 小时，更换轴承体内润滑油，以后泵每工作 1500 小时换油一次。
 - d) 定期检查联轴器，注意电动机轴承温升。
 - e) 运转过程中，如发现不寻常声音时，应立即停车，检查其原因。
 - f) 如水泵长期不用，应定期让水泵运转 30 分钟，以防液下零件锈死而影响今后使用。
-
- a) The pump must operate only in regulate rate arrange.
 - b) Pay attention to the bearing temperature does not exceed the ambient temperature as 35℃ or by 80℃ at most.
 - c) After operating for 2000 hours, to change lubricant grease in bearing box. And to lubricate the bearing by oil, during the first month, through 100 hours, to change oil in the bearing house, then every 1500 hours of work to change oil once.
 - d) A periodical inspection of the coupling should be made. Pat attention to the temperature rise of the motor bearing.

- e) Stop the motor for inspection when discover noise or abnormal sounds in running.
- f) If the pump is in idling case for a longer time, it should let the pump operate for 30 minutes regularly, so to avoid being rusty of parts submerged in liquid and influence after use.

附 1：加油方法

(仅用于 80FY-97, 80FY-125, 100FY-80, 125FY-74, 150FY-80, 200FY-50, 200FY-63, 250FY-39, 250FY-60, 300FY-16, 300FY-32, 300FY-52, 350FY-39)

请按 (1), (2) 步骤加油。

(润滑油牌号: N32 号机械油)

- (1) 往轴承盖上部的加油孔加入润
- (2) 拧松油位计上的螺钉, 将油位计向上抽出, 加油的同时观察油位计中的油位, 油位没过油位计内部的斜口即可, 不得多加油, 否则泵运转时会造成漏油。
- (3) 翻转油位计往油位计中加入适然后将油位计装回原位即可。

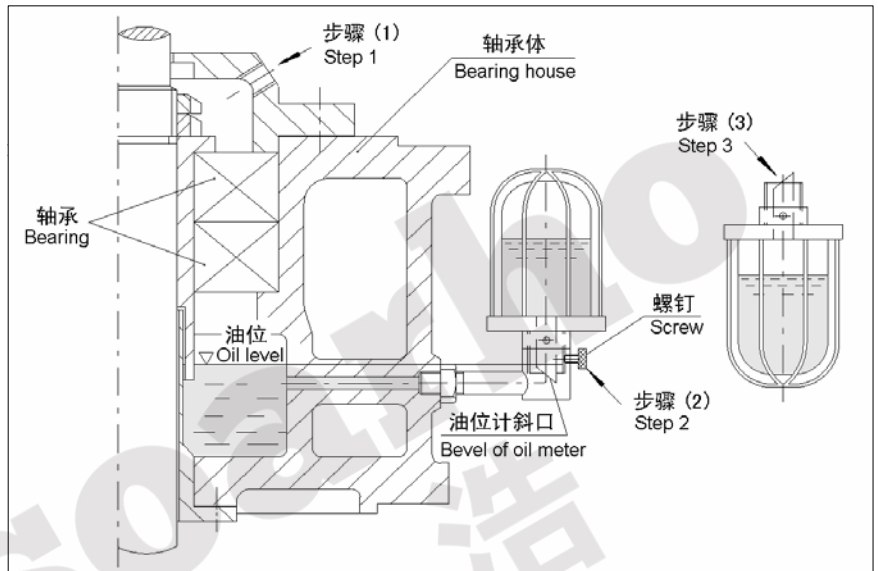

Addition 1: The Method of Filling Oil. (For 80FY-97, 80FY-125, 100FY-80, 125FY-74, 150FY-80, 200FY-50, 200FY-63, 250FY-39, 250FY-60, 300FY-16, 300FY-32, 300FY-52, 350FY-39 only)

(Oil grade: N32 machine oil)

Please fill the machine oil step by step as followed.

Step 1: Filling the machine oil from oil hole on the bearing cover.

Step 2: To loose the screw when filling oil, then draw out the oil meter to observe the oil level that immerge the bevel of oil meter only. Don't permit to fill more oil, otherwise the oil will leak when pump running.

Step 3: Turn over the oil meter to fill some oil into it, then fit the oil meter to the original place.

附 2：泵用轴承

Addition 2: The Bearing of Pump

泵型号 Pump Model	轴承 Bearing	
	型号 Model	数量 Qty.
25FY-16, 50FYW-14	60106	1
25FY-25, 25FY-41, 40FY-16, 40FY-26, 40FY-40, 40FY-65, 50FYW-10 50FY-16, 50FY-25, 65FYW-10, 65FY-16, 65FYW-16, 65FY-25 65FYW-25,	46309	2
40FYW-8, 40FYW-30, 40FYW-40, 50FYW-30, 50FY-40, 50FYW-40, 65FYW-40	46309	2
	310	1
50FY-63, 50FY-80, 50FY-100, 65FY-20, 65FY-40, 65FY-64, 65FY-80, 65FY-125, 80FY-15, 80FY-20, 80FY-24, 80FY-32, 80FY-38, 80FYW-38, 80FY-60, 80FYW-60, 100FY-20, 100FY-23, 100FY-37, 100FYW-37, 100FY-57, 125FY-20	46312	1
	312	1
100FYW-22, 100FYW-23, 100FYW-24,	46212	1
	212	1
150FYW-30, 150FY-35, 150FY-56,	7314	1
	315	1
100FY-32, 125FY-32, 125FY-50, 150FY-22, 150FYW-22, 200FY-21, 300FY-14, 300FY-16, 300FY-32	7318	1
	318	1
200FY-30, 200FY-34	7316	2
	318	1
80FY-97, 80FY-125, 100FY-80, 150FY-80	46318	1
	318	1
200FY-50, 200FY-63, 250FY-60, 300FY-52, 350FY-39	7322	1
	322	1

● 可能发生的故障及解决方法

故障	原因	解决方法
水泵不吸水	<ul style="list-style-type: none"> ● 起动时，液面未浸没过叶轮。 	<ul style="list-style-type: none"> ● 起动时，液位必须浸过叶轮，才能起动
出水压力不足	<ul style="list-style-type: none"> ● 叶轮被异物堵塞； ● 转向不对； ● 电机转速未达到规定转速。 	<ul style="list-style-type: none"> ● 吊起泵组，清洗叶轮； ● 改变电机转向； ● 增加电机转速。
流量不足	<ul style="list-style-type: none"> ● 出水管阻力大； ● 出水管路堵塞； ● 密封环磨损过大。 	<ul style="list-style-type: none"> ● 加大出水管管径或增加泵扬程； ● 清理管路；检修闸阀及止回阀； ● 更换密封环。
电机外壳过热	<ul style="list-style-type: none"> ● 泵转子部件有卡擦现象； ● 泵工作在超大流量区。 	<ul style="list-style-type: none"> ● 拆泵检查，排出卡擦现象； ● 控制泵出口闸阀，使泵工作在规定的范围内。
水泵振动	<ul style="list-style-type: none"> ● 泵轴弯曲； ● 液下支撑接管等零件不同心； ● 泵联轴器与电机联轴器不对中； ● 下轴套、导轴承严重磨损； ● 较大的外力或外力矩作用在泵出液管法兰上而拉弯泵主接管。 	<ul style="list-style-type: none"> ● 校正泵轴； ● 更换不合格零件； ● 调正泵联轴器与电机联轴器； ● 更换下轴套、导轴承及密封环； ● 松开泵出液管法兰螺栓，检查泵出液管法兰与外部管路法兰是否错位，如错位太多，应重新安装出水管路。
泵轴承过热	<ul style="list-style-type: none"> ● 没有油或油太脏； ● 轴承盖压得太紧； ● 轴承外圈与轴承盒配合太紧。 	<ul style="list-style-type: none"> ● 更换润滑油； ● 轴承盖下适当加纸垫； ● 适当配松。
用手转动联轴器转不动	<ul style="list-style-type: none"> ● 长期未使用，液下零件锈死； ● 轴承套位的锁紧螺母松动，整个转子部件下坠。 	<ul style="list-style-type: none"> ● 拆泵、清洗； ● 调整螺母并锁紧，使转子部件上提；

Possible Malfunctions and Solutions

Malfunctions	Causes	Solution
Failed to suck liquid	<ul style="list-style-type: none"> ● When starting, the level of liquid is not submerged over impeller. 	<ul style="list-style-type: none"> ● Before starting, look out that level of liquid must submerge over impeller.
Pressure is not good enough	<ul style="list-style-type: none"> ● Impeller may be blocked up. ● The direction of the rotary is incorrect. ● Speed is low 	<ul style="list-style-type: none"> ● Hoisting pump and cleaning impeller. ● Change the direction of motor. ● Increase the speed.
Capacity is not enough	<ul style="list-style-type: none"> ● Resistance of the discharge pipe is too large. ● Discharge pipe is blocked up. ● Seal ring is worn out 	<ul style="list-style-type: none"> ● Enlarge the diameter of discharge pipe or increase head of the pump; ● Cleaning pipe route; Check gate valve and check valve. ● Replace the seal ring.
Over heat on the outside of the motor	<ul style="list-style-type: none"> ● There is a friction on the pump rotor parts ● Pump work in super-flow area. 	<ul style="list-style-type: none"> ● Dismantle pump for check, to eliminate the friction; ● control the outlet gate valve, to make the pump work in regulate rate arrange.
Pump vibrate	<ul style="list-style-type: none"> ● Pump shaft becomes curved ● The parts submerged such as joint-pipe are not in line ● The pump shaft and motor shaft are not in alignment. ● Under shaft sleeve and guide bushing are seriously worn out; ● Bigger external forces and moments act the discharge nozzle and cause the pump joint-pipe curved. 	<ul style="list-style-type: none"> ● Adjust the pump shaft; ● Renew unqualified parts; ● Readjust pump coupling and motor coupling. ● Renew under shaft sleeve and guide bushing and seal ring; ● Slacken nuts of the liquid-discharging pipe flange, check whether flange of liquid-charging pipe and flange of outside pipe mistake places, if so; It should re-fix outlet pipe.
Over heat in pump bearing	<ul style="list-style-type: none"> ● The grease or oil is lacking, or very dirty. ● The bearing cover is too tight. ● Match too tighten between bearing and bearing box 	<ul style="list-style-type: none"> ● Filling or renewing it. ● Suitable put paper spacer under the bearing cover. ● make repairs bearing box, loose little bit moderately.
Fail to turn the coupling by hand	<ul style="list-style-type: none"> ● Idling for a long time, and parts submerged becomes rusty; ● Nuts at bearing sleeve are slackened, so the whole rotor falls down. 	<ul style="list-style-type: none"> ● Dismantle the pump, and cleaning it; ● Adjust nuts and tighten them, so to raise and restore the rotor to the right position.

● 泵性能参数表 Table of Performance Data

泵型号 Pump model	流量 Capacity Q (m ³ /h)	扬程 Head H (m)	转速 Speed n (r/min)	效率 Eff. η (%)	功率 P Power (kW)		叶轮直径 Impeller diameter (mm)
					轴功率 Brake horsepower	配电机 Motor Power	
25FY-16	1.98	18	2960	26	0.37	0.75	Φ108
	3.60	16		35	0.45		
	3.96	14.6		37	0.43		
25FY-16A	1.8	14	2960	26	0.26	0.75	Φ100
	3.27	12.5		33	0.34		
	3.61	11		36	0.30		
25FY-25	1.98	26.8	2960	16	0.90	1.5	Φ142
	3.6	25		26	0.94		
	3.96	24.4		28	0.94		
25FY-25A	1.8	22.2	2960	16	0.68	1.1	Φ133
	3.27	21.2		24	0.79		
	3.60	20.2		28	0.71		
25FY-41	2.16	42.2	2960	13	1.91	3	Φ182
	3.6	41		20	2.01		
	3.96	40.5		21	2.08		
25FY-41A	1.96	35	2960	12	1.56	2.2	Φ168
	3.28	34		19	1.60		
	3.6	33.6		20	1.65		
40FYW-8	1.8	8.1	1450	12	0.33	0.75	Φ154
	3.2	8		20	0.35		
	4	7.9		23	0.37		
40FYW-8A	1.5	5.1	1450	12	0.17	0.75	Φ130
	3	5		20	0.20		
	3.8	4.9		23	0.22		
40FY-16	3.96	18.5	2960	38	0.52	1.1	Φ117
	7.2	15.5		47	0.65		
	9	14		49	0.70		
40FY-16A	3.59	15	2960	38	0.39	0.75	Φ106
	6.55	13		45	0.52		
	8.16	11		46	0.53		
40FY-26	3.96	28	2960	30	1.01	2.2	Φ144
	7.2	25.5		37	1.35		
	9	24		41	1.43		
40FY-26A	3.59	22.8	2960	26	0.86	1.5	Φ135
	6.55	20.5		35	1.04		
	8.16	19		36.5	1.16		
40FYW-30	4.8	30.1	2900	21	1.87	4	Φ137
	8	30		26	2.51		
	10	29.9		30	2.71		
40FYW-30A	4.2	25.1	2900	19	1.51	3	Φ130
	7	25		24	1.98		
	8.8	24.9		28	2.13		

注：表中轴功率以清水为介质计算。

Notes: The brake horsepower in the table is calculated with water as the medium.

泵性能参数表

Table of Performance Data

泵型号 Pump model	流量 Capacity Q (m ³ /h)	扬程 Head H (m)	转速 Speed n (r/min)	效率 Eff. η (%)	功率 P Power (kW)		叶轮直径 Impeller diameter (mm)
					轴功率 Brake horsepower	配电机 Motor Power	
40FYW-40	3.96	40.2	2900	13	3.33	5.5	Φ 162
	7.2	40		21	3.73		
	8.6	39.6		24	3.86		
40FYW-40A	3.6	32.2	2900	13	2.43	4	Φ 140
	6.55	32		21	2.72		
	7.2	31.7		23	2.70		
40FY-40	3.96	42.2	2960	32.5	2.02	3	Φ 175
	7.20	40.0		35.0	2.24		
	7.92	39.2		36.5	2.32		
40FY-40A	3.62	35.2	2960	22.5	1.54	2.2	Φ 162
	6.55	33.4		35.0	1.71		
	7.24	32.8		36.5	1.77		
40FY-65	4.67	67	2960	18	4.73	7.5	Φ 224
	7.2	65		24	5.31		
	8.64	63.5		25.5	5.86		
40FY-65A	4.36	58.4	2960	18	3.85	5.5	Φ 208
	6.72	56		24	4.27		
	8.05	55.4		25	4.86		
40FY-65B	3.6	50.5	2960	17	2.91	5.5	Φ 198
	6.4	49		23	3.71		
	7.2	47.5		24	3.88		
50FYW-10	4	10.3	1450	18	0.56	1.1	Φ 162
	7.2	10		30	0.65		
	8.7	9.8		32	0.73		
50FYW-14	7.2	15.5	2900	42	0.72	1.1	Φ 109
	12	14		50	0.91		
	14.4	12		50	0.94		
50FY-16	7.92	20	2960	50	0.86	1.5	Φ 125
	14.4	15.7		56	1.10		
	15.8	14.6		52	1.21		
50FY-16A	7.2	15.5	2960	48	0.63	1.1	Φ 115
	13.1	12		54	0.79		
	14.4	10.7		53	0.79		
50FY-25	7.92	27.5	2960	46	1.29	3	Φ 145
	14.4	24.5		53.5	1.80		
	15.8	23.5		54	1.87		
50FY-25A	7.2	23	2960	40	1.13	2.2	Φ 132
	13.1	20.5		50	1.46		
	14.4	19.5		51	1.50		
50FYW-30	7.2	31.5	1450	21	2.94	5.5	Φ 310
	12	30		29	3.38		
	15	28.5		31	3.75		

泵性能参数表

Table of Performance Data

泵型号 Pump model	流量 Capacity Q (m ³ /h)	扬程 Head H (m)	转速 Speed n (r/min)	效率 Eff. η (%)	功率 P Power (kW)		叶轮直径 Impeller diameter (mm)
					轴功率 Brake horsepower	配电机 Motor Power	
50FYW-30A	6.8	28	1450	20	2.59	4	Φ 300
	11.4	27		28	2.99		
	13.6	26		30	3.21		
50FYW-40	7.92	41	2900	21	4.21	7.5	Φ 162
	14.4	40		33	4.75		
	17.5	38.8		35	5.28		
50FYW-40A	7.2	34.1	2900	21	3.18	5.5	Φ 148
	13.1	33		31.5	3.74		
	16	32		34	4.10		
50FY-40	7.92	42.5	2960	44	2.08	5.5	Φ 195
	14.4	40		46	3.41		
	19.5	35		43	4.32		
50FY-40A	7.2	35	2960	41	1.67	4	Φ 180
	13.1	32		43	2.65		
	14.4	28		40	2.74		
50FY-63	7.92	65	2960	23.5	5.96	11	Φ 220
	14.4	63		35.0	7.06		
	18	60		38.5	7.64		
50FY-63A	7.2	56.5	2960	21.5	5.15	11	Φ 208
	13.5	55		33.5	6.03		
	18	52		38.5	6.62		
50FY-63B	7.37	49.6	2960	20.5	4.85	7.5	Φ 195
	12.6	48		32.5	5.07		
	16.8	46.2		36.0	5.87		
50FY-80	7.5	81.5	2960	24	6.93	11	Φ 247
	12.5	80		35	7.78		
	15	79		38	8.49		
50FY-80A	7	71	2960	22	6.15	11	Φ 231
	11.7	70		33	6.76		
	14	69		36	7.30		
50FY-80B	6.5	60.8	2960	20	5.38	7.5	Φ 215
	10.8	60		31	5.69		
	13	59		34	6.14		
50FY-100	10.8	102	2960	17	17.6	22	Φ 278
	14.4	100		21	18.7		
	18	98		24	20.0		
50FY-100A	10.1	90	2960	15	16.5	22	Φ 262
	13.4	88		19	16.9		
	16.9	86.2		22	18.0		
65FYW-10	8	10.3	1450	22	1.02	2.2	Φ 166
	14.4	10		31	1.26		
	16.5	9.8		32	1.38		

泵性能参数表

Table of Performance Data

泵型号 Pump model	流量 Capacity Q (m ³ /h)	扬程 Head H (m)	转速 Speed n (r/min)	效率 Eff. η (%)	功率 P Power (kW)		叶轮直径 Impeller diameter (mm)
					轴功率 Brake horsepower	配电机 Motor Power	
65FYW-16	9 14.4 17	17.2 15.7 14.4	1450	33 45 46	1.28 1.37 1.45	3	Φ 220
65FYW-16A	8.2 13.1 15.6	14.2 13 11.9	1450	34 43 45	0.93 1.08 1.12	2.2	Φ 200
65FY-16	18 28.8 33.1	19 16 14	2960	60 64 63	1.55 1.96 2.00	3	Φ 124
65FY-16A	16.4 26.2 30.1	15.7 13 11.5	2960	58 62 61	1.21 1.50 1.55	2.2	Φ 114
65FY-20	7.5 12.5 15	21 20 19.4	1450	33 43 44	1.30 1.58 1.80	2.2	Φ 256
65FY-20A	7 11.7 14	18.2 17.5 16.9	1450	31 41 43	1.12 1.36 1.50	2.2	Φ 240
65FYW-25	18 28.8 33.1	29.2 25 22.5	2960	40 50 50	3.58 3.92 4.05	5.5	Φ 170
65FYW-25A	16.2 26.2 30.2	24.5 20.7 18.5	2960	39 50 49	2.77 2.95 3.10	4	Φ 156
65FY-25	18 28.8 33.1	28 25 23.5	2960	52 63 64	2.64 3.11 3.31	5.5	Φ 148
65FY-25A	16.2 26.2 30.2	24 21.5 20	2960	54 61 61.5	1.96 2.51 2.67	4	Φ 135
65FYW-40	15.8 28.8 33.1	42 40 39.2	2960	24 34 35	7.53 9.22 10.1	15	Φ 166
65FYW-40A	14.4 26.2 30.2	33.5 32.7 31.2	2960	23 33 34	5.71 7.07 7.54	11	Φ 138
65FY-40	15.8 28.8 33.1	42 40 38	2960	48 60 61	3.76 5.23 5.61	7.5	Φ 182
65FY-40A	14.4 26.3 30.2	36 32 29.5	2960	46 58 59	3.07 3.95 4.11	5.5	Φ 166

泵性能参数表

Table of Performance Data

泵型号 Pump model	流量 Capacity Q (m ³ /h)	扬程 Head H (m)	转速 Speed n (r/min)	效率 Eff. η (%)	功率 P Power (kW)		叶轮直径 Impeller diameter (mm)
					轴功率 Brake horsepower	配电机 Motor Power	
65FY-64	18 28.8 36	65.8 64 61.2	2960	45 53 52	7.16 9.47 11.5	15	Φ 220
65FY-64A	16.2 25.2 32.4	56.4 54 50	2960	43 52 50	5.78 7.12 8.82	11	Φ 198
65FY-64B	15.9 25.4 31.7	55 50 45.2	2960	43 51 50	5.54 6.78 7.80	11	Φ 192
65FY-80	15 25 30	82 80 78	2960	35 47 49	9.57 11.6 13.0	15	Φ 256
65FY-80A	14 23.4 28	72 70 68.2	2960	34 45 47	8.07 9.91 11.0	15	Φ 240
65FY-125	15 25 30	127 125 123	2960	26 37 41	19.9 23.0 24.5	30	Φ 315
65FY-125A	14.3 23.9 28.7	116 114 113	2960	25 35 39	18.1 21.2 22.6	30	Φ 302
65FY-125B	13.6 22.7 27.3	104 103 102	2960	24 34 36	19.0 18.7 21.1	30	Φ 288
65FY-125C	12.9 21.4 25.7	94 92 91	2960	25 34 36	13.2 15.8 17.7	22	Φ 273
80FY-15	33.5 54 65	17.5 15 12	2960	60 70 65	2.66 3.15 3.27	5.5	Φ 125
80FY-15A	29.6 49.1 62.4	14.2 12.4 9	2960	60 68 62	1.91 2.44 2.47	4	Φ 114
80FY-20	15 25 30	21.5 20 17.8	1450	36 45 46	2.44 3.02 3.32	5.5	Φ 250
80FY-20A	15 23 27	18 17 16	1450	34 43 44	2.16 2.48 2.67	4	Φ 234
80FY-24	32.4 54 64.8	28 24 20	2960	64 72 66	3.86 4.91 5.35	7.5	Φ 146

泵性能参数表

Table of Performance Data

泵型号 Pump model	流量 Capacity Q (m ³ /h)	扬程 Head H (m)	转速 Speed n (r/min)	效率 Eff. η (%)	功率 P Power (kW)		叶轮直径 Impeller diameter (mm)
					轴功率 Brake horsepower	配电机 Motor Power	
80FY-24A	28.8	22	2960	58	2.98	5.5	Φ 137
	46.8	19.5		66	3.76		
	57.6	17		61.5	4.34		
80FYG-32	15	33.3	1450	37	3.68	7.5	Φ 313
	25	32		49	4.44		
	30	31		52	4.87		
80FYG-32A	14	30	1450	36	3.18	5.5	Φ 299
	23.8	28.5		48	3.85		
	29	27.5		51	4.26		
80FYG-32B	13.5	27	1450	35	2.84	5.5	Φ 284
	22.7	25.8		47	3.39		
	27.5	24.5		50	3.67		
80FYW-38	32.4	43	2960	49	7.74	15	Φ 188
	54	38		60	9.31		
	68.4	35		59.7	10.9		
80FYW-38A	29.6	35.8	2960	47	6.14	11	Φ 173
	49.1	31.5		58	7.26		
	62.3	27		57.8	7.92		
80FY-38	32.4	40.5	2960	55	6.49	15	Φ 180
	57.6	37		67	8.66		
	68.4	33.4		65	9.57		
80FY-38A	29.6	34.2	2960	50	5.51	11	Φ 167
	52.2	31		62	7.11		
	62.3	28		60	7.91		
80FYW-60	32.4	68	2960	48	12.5	22	Φ 224
	54	60		58	15.2		
	68.4	52		57	17.0		
80FYW-60A	31	61	2960	47	11.0	18.5	Φ 216
	52.2	53		57	13.2		
	64	46		56	14.3		
80FYW-60B	26.4	51.5	2960	45	8.22	15	Φ 206
	47.5	46		55	10.8		
	60.2	39		54	11.8		
80FY-60	32.4	67	2960	54	10.9	22	Φ 220
	54	60		63	14.0		
	68.4	52		60	16.1		
80FY-60A	30.6	58	2960	51	9.47	18.5	Φ 210
	50.5	52		59	12.1		
	64.1	45		58	13.5		
80FY-60B	26.4	52	2960	48	7.79	15	Φ 200
	47.5	46		57	10.4		
	60.2	39		55	11.6		

泵性能参数表

Table of Performance Data

泵型号 Pump model	流量 Capacity Q (m ³ /h)	扬程 Head H (m)	转速 Speed n (r/min)	效率 Eff. η (%)	功率 P Power (kW)		叶轮直径 Impeller diameter (mm)
					轴功率 Brake horsepower	配电机 Motor Power	
80FY-97	34.2 54 64.8	101 96.5 88	2960	47 56 54	20.0 25.3 28.6	37	Φ 275
80FY-97A	30.2 50.5 63.9	91 84 74	2960	46 56 55	16.3 20.6 23.4	30	Φ 252
80FY-97B	28.5 47.5 61.0	80.5 74 65.5	2960	45 55 54	14.0 17.4 20.1	30	Φ 238
80FY-125	30 50 60	129 125 122	2960	40 51 53	26.3 33.4 37.6	45	Φ 313
80FY-125A	29 47.7 57.5	117 114 112	2960	37 49 51	25.0 30.2 34.4	37	Φ 299
80FY-125B	27.5 45.4 54.5	107 103 101	2960	35 47 49	22.9 27.1 30.6	37	Φ 284
100FY-20	30 50 60	21.3 20 19	1480	51 64 65	3.41 4.25 4.77	5.5	Φ 255
100FY-20A	28 46.8 56	18.8 17.5 16.7	1480	49 62 63	2.92 3.60 4.04	5.5	Φ 239
100FYW-22	45 60 90	21.8 21 19.2	1480	49 57 60	5.45 6.02 7.84	11	Φ 262
100FYW-22A	36 55 80	17.6 17 15.5	1480	45 53 56	3.83 4.80 6.03	7.5	Φ 242
100FYW-23	60 100.8 120	25 22.5 21	1480	53 61 60	7.70 10.1 11.4	15	Φ 260
100FYW-23A	55 91.8 110	20.5 18.6 17.2	1480	52 60 59	5.90 7.75 8.73	11	Φ 238
100FY-23	68.4 100.8 126	25 22.5 21	2960	62 75 73	7.51 8.23 9.87	11	Φ 152
100FY-23A	42.2 91.8 114	20 17.5 15.5	2960	45 71 71	5.11 6.16 6.91	7.5	Φ 137

泵性能参数表

Table of Performance Data

泵型号 Pump model	流量 Capacity Q (m ³ /h)	扬程 Head H (m)	转速 Speed n (r/min)	效率 Eff. η (%)	功率 P Power (kW)		叶轮直径 Impeller diameter (mm)
					轴功率 Brake horsepower	配电机 Motor Power	
100FYW-24	60 100.8 120	26.5 24 22.5	1450	53 61 60	8.17 10.8 12.3	15	Φ268
100FY-32	30 50 60	33.5 32 30.5	1450	44 58 60	6.22 7.51 8.30	11	Φ307
100FY-32A	28.6 47.7 57.5	30 28.5 27.5	1450	42 56 58	5.56 6.61 7.42	11	Φ293
100FY-32B	27 45.4 54.5	27 25.8 24.7	1450	41 55 56	4.82 5.80 6.54	7.5	Φ280
100FYW-37	61.3 100.8 120.8	42.5 37 33	2960	44 50 49	16.1 20.3 22.1	30	Φ198
100FYW-37A	55.8 91.8 110	35 30 28	2960	43 50 49	12.4 15.0 17.1	18.5	Φ178
100FY-37	61.3 100.8 120.8	42.5 36.5 30.5	2960	68 73 72	10.4 13.7 13.9	18.5	Φ185
100FY-37A	50 91.8 110	35 29 25	2960	63 73 69	7.56 9.93 10.8	15	Φ170
100FY-57	64.9 100.8 105.2	62 57 55.5	2960	59 69 68	18.6 22.7 23.4	30	Φ225
100FY-57A	60.5 93.4 98.0	54 49.5 48	2960	58 68 67	15.3 18.5 19.1	22	Φ210
100FY-57B	57 89 92.3	47 44.2 43.2	2960	57 67 66	12.8 16.0 16.5	18.5	Φ198
100FY-80	60 100 120	87 80 74.5	2960	55 69 70	25.8 31.6 34.6	37	Φ255
100FY-80A	56 93.5 112	76 70 64.5	2960	51 66 68	22.7 27.0 28.9	37	Φ239
100FY-80B	52 86.6 104	64 60 55	2960	49 64 66	18.5 22.1 23.6	30	Φ222

泵性能参数表

Table of Performance Data

泵型号 Pump model	流量 Capacity Q (m ³ /h)	扬程 Head H (m)	转速 Speed n (r/min)	效率 Eff. η (%)	功率 P Power (kW)		叶轮直径 Impeller diameter (mm)
					轴功率 Brake horsepower	配电机 Motor Power	
125FY-20	60 100 120	21.9 20 18.8	1480	57 70 69	6.28 7.78 8.85	11	Φ 255
125FY-20A	56 93.5 112	19 17.5 16	1480	54 69 69	5.36 6.46 7.07	11	Φ 239
125FY-32	60 100 120	34 32 30.5	1480	52 62 63	11.6 14.1 15.8	18.5	Φ 308
125FY-32A	57.5 95.5 115	30.3 28.5 27.2	1480	50 60 61	9.49 12.3 14.0	18.5	Φ 290
125FY-32B	54.5 90.8 109	27.5 25.8 24.2	1480	49 59 60	8.33 10.8 12.0	15	Φ 272
125FY-50	60 100 120	54.5 50 47	1480	50 62 62	17.8 22.0 24.8	30	Φ 395
125FY-50A	55 93.5 115	47.5 44 41.5	1480	48 61 61	14.8 18.4 21.3	30	Φ 371
125FY-50B	50 86.5 105	42 38 35	1480	48 59 58	12.7 15.2 16.7	22	Φ 345
125FY-74	120 200 240	85 74 62.5	2950	64 72 66	43.4 56.0 61.9	75	Φ 255
125FY-74A	110 180 220	75.1 68 59	2950	58 69 66	38.8 48.3 53.5	75	Φ 371
125FY-74B	100 170 210	65.1 60 51	2950	55 67 65	32.2 41.4 45.7	55	Φ 236
150FYW-22	115 190 234	24.6 22 18.6	1480	59 72 67	13.1 15.8 17.7	22	Φ 218
150FYW-22A	105 173 230	19.5 17.5 13.7	1480	58 71 66	9.61 11.6 13.0	18.5	Φ 245
150FY-22	115.2 190.8 234	23.6 22 20.5	1480	63 77 76	11.7 14.9 17.1	22	Φ 267

泵性能参数表

Table of Performance Data

泵型号 Pump model	流量 Capacity Q (m ³ /h)	扬程 Head H (m)	转速 Speed n (r/min)	效率 Eff. η (%)	功率 P Power (kW)		叶轮直径 Impeller diameter (mm)
					轴功率 Brake horsepower	配电机 Motor Power	
150FY-22A	105	20.2	1480	62	9.30	18.5	Φ244
	173.5	18		75	11.3		
	213	16.2		73	12.8		
150FYW-30	122	31.5	1450	69	15.2	30	Φ316
	150	30		71	17.3		
	175	28		72.5	18.4		
150FYW-30A	113.9	27.4	1450	67	12.7	22	Φ302
	140	26		69	14.4		
	163.3	24.4		70	15.5		
150FY-35	115.2	39.8	1480	62	20.1	30	Φ347
	190.8	34.7		75	24.0		
	234	29.7		72	26.3		
150FY-35A	105	33	1480	61	15.5	30	Φ321
	173.5	28		74	17.9		
	213	24.6		71	20.1		
150FY-56	126	58.8	1480	60	33.6	55	Φ400
	190.8	55.5		70	41.2		
	234	50.8		68	47.6		
150FY-56A	100	52	1480	58	24.4	45	Φ384
	150	50		68	30.0		
	200	46		67	37.4		
150FY-56B	90	42.8	1480	51	20.6	45	Φ350
	150	40		62	26.3		
	200	35.5		60	32.2		
150FY-80	215	90	2950	65	81.0	132	Φ267
	360	80		76	103.2		
	430	68		74	107.6		
150FY-80A	200	79	2950	63	68.3	110	Φ244
	335	70		74	86.3		
	400	62		72	93.8		
150FY-80B	185	67.5	2950	61	55.7	90	Φ236
	310	60		72	70.3		
	380	52		70	76.8		
200FY-21	216	21.7	1480	69	18.5	37	Φ270
	360	21		83	24.8		
	414	20		80	28.2		
200FY-21A	196	17.9	1480	67	14.3	30	Φ250
	327	17.3		80	19.2		
	376	16.8		79	21.8		
200FY-21B	170	15.5	1480	63	11.4	22	Φ235
	300	15		77	15.9		
	350	14.5		76	18.2		

泵性能参数表

Table of Performance Data

泵型号 Pump model	流量 Capacity Q (m ³ /h)	扬程 Head H (m)	转速 Speed n (r/min)	效率 Eff. η (%)	功率 P Power (kW)		叶轮直径 Impeller diameter (mm)
					轴功率 Brake horsepower	配电机 Motor Power	
200FY-30	252	33.5	1480	72	31.9	55	Φ 334
	360	30		80	36.8		
	468	25.2		78	41.2		
200FY-30A	220	28.2	1480	67	25.2	37	Φ 311
	340	25		79	29.3		
	440	20.5		76	32.3		
200FY-34	216	38.5	1480	70	32.3	55	Φ 346
	360	34		82	40.6		
	414	31.5		80	44.4		
200FY-34A	196	31.7	1480	68	24.9	45	Φ 315
	327	28		80	31.2		
	376	26		78	34.1		
200FY-50	216	53	1480	62	50.3	90	Φ 409
	360	46		74	60.9		
	450	39		69	69.2		
200FY-50A	204	46.8	1480	62	41.9	75	Φ 399
	340	40		74	50.0		
	430	34		69	57.7		
200FY-50B	195	40.5	1480	60	35.8	75	Φ 383
	324	35		73	42.3		
	400	30		69	47.3		
200FY-63	180	69.5	1480	57	59.7	110	Φ 450
	280	63		65	73.9		
	340	57		60	87.9		
200FY-63A	165	56	1480	55	45.7	75	Φ 412
	270	50		62	59.3		
	320	45.5		58	68.3		
250FY-39	300	44	1480	68	52.8	90	Φ 370
	485	39		77	66.9		
	550	35		72	72.8		
250FY-39A	280	36	1480	66	41.6	75	Φ 342
	465	30.5		75	51.5		
	530	26		70	53.6		
250FY-39B	260	31.7	1480	64	35.1	55	Φ 324
	445	26		73	43.1		
	510	22.5		68	45.9		
250FY-60	290	66.8	1480	63	83.7	160	Φ 452
	485	60		74	107.0		
	560	56		72	118.6		
250FY-60A	270	58	1480	61	69.9	132	Φ 432
	450	52		72	88.5		
	520	48.5		68	101.0		

泵性能参数表

Table of Performance Data

泵型号 Pump model	流量 Capacity Q (m ³ /h)	扬程 Head H (m)	转速 Speed n (r/min)	效率 Eff. η (%)	功率 P Power (kW)		叶轮直径 Impeller diameter (mm)
					轴功率 Brake horsepower	配电机 Motor Power	
250FY-60B	240	49	1480	59	54.3	110	Φ 404
	415	44		70	71.0		
	500	40		66	82.5		
300FY-14	366	17	980	64	26.5	37	Φ 360
	550	14		70	29.9		
	600	12.9		69	30.5		
300FY-14A	320	12	980	60	17.4	30	Φ 340
	470	10		69	18.5		
	590	7.8		68	18.4		
300FY-16	500	19	1480	65	39.8	55	Φ 280
	720	16		72	43.6		
	860	13		69	44.1		
300FY-16A	450	16.2	1480	61	32.5	45	Φ 265
	650	13.5		70	34.1		
	800	11		68	35.2		
300FY-32	550	37.5	1480	65	86.4	110	Φ 360
	790	32		73	94.3		
	900	28.5		73	95.7		
300FY-32A	500	29	1480	63	62.7	75	Φ 330
	650	26		71	59.8		
	800	22		71	67.5		
300FY-32B	500	26	1480	62	57.1	75	Φ 319
	650	23		70	58.1		
	800	19		70	59.1		
300FY-32C	400	21.9	1480	61	39.1	55	Φ 300
	550	20		69	43.4		
	700	16.8		69	46.4		
300FY-52	550	61	1480	69	132.4	185	Φ 425
	790	52		74	151.1		
	900	46.5		71	160.5		
300FY-52A	515	52.7	1480	68	108.7	160	Φ 414
	740	46		73	126.9		
	840	41		70	133.9		
300FY-52B	480	49	1480	67	95.6	132	Φ 400
	690	43.5		72	113.5		
	785	39.5		69	122.3		
350FY-39	720	47	1480	66	139.6	185	Φ 405
	1200	39		78	163.3		
	1440	32.5		75	169.9		
350FY-39A	650	38	1480	64	105.1	160	Φ 384
	1080	32		76	123.8		
	1300	27		73	130.9		

● 泵外形及安装尺寸 Overall and Installation Dimensions

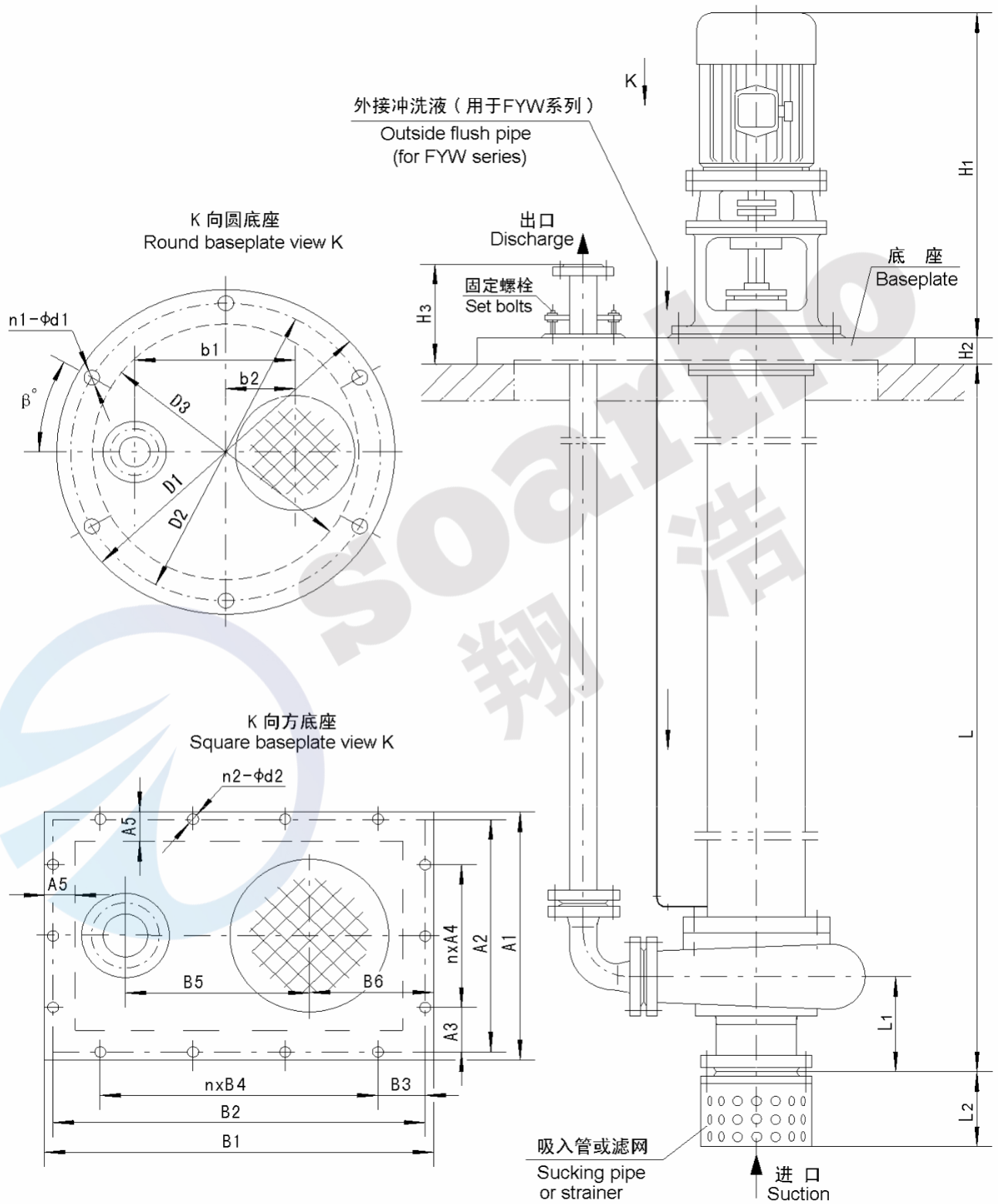

泵外形及安装尺寸表 Overall and Installation Dimensions

泵型号 Pump model	外形及安装尺寸 Overall and installation dimensions (mm)																						电机 Motor (kW)					
	L (Submerged depth)	L ₁	L ₂	H ₁	H ₂	H ₃	圆底座 Round baseplate							方底座 Square baseplate										型号 Model	功率 Power			
							D ₁	D ₂	D ₃	b ₁	b ₂	β	n ₁ -Φd ₁	B ₁	B ₂	B ₃	n×B ₄	B ₅	B ₆	A ₁	A ₂	A ₃	n×A ₄			A ₅	n ₂ -Φd ₂	
25FY-16	550, 900, 1000, 1100 1200, 1300, 1543, 1870 1943, 1994, 2455, 2255	80	75	285	20	160	/	/	/	/	/	/	/	460	420	80	2×150	190	155	310	270	60	1×150	40	10-Φ19	Y80 ₁ -2	0.75	
25FY-25	820,1000,1105,1415, 1735,1795,2000,3998	80	85	675	25	205	520	480	410	231	85	22	6-Φ18	/	/	/	/	/	/	/	/	/	/	/	/	/	Y90S-2	1.5
				650																							Y80 ₂ -2	1.1
25FY-41	650,1129,1300,1390, 1439,1600,1916,2094	100	85	750	25	205	520	480	410	231	85	22	6-Φ18	/	/	/	/	/	/	/	/	/	/	/	/	/	Y100L-2	3
				700																							Y90L-2	2.2
40FYW-8	1500,1800,2000,2300, 2500,3000,4000	80	100	745	30	210	/	/	/	/	/	/	/	610	570	105	2×200	250	235	480	440	100	1×240	50	10-Φ19	Y80 ₂ -4	0.75	
40FY-16	415,720,900,1000, 1095,1405,1600,1725, 2300	70	100	650	25	205	520	480	410	231	85	22	6-Φ18	/	/	/	/	/	/	/	/	/	/	/	/	/	Y80 ₂ -2	1.1
																											Y80 ₁ -2	0.75
40FY-26	1105,1415,1500,1657, 1735,2405,2500,2805, 3985	80	100	700	25	205	520	480	410	231	85	22	6-Φ18	/	/	/	/	/	/	/	/	/	/	/	/	/	Y90L-2	2.2
				650																							Y90S-2	1.5
40FYW-30	800,1085,1100,1500 1800,2000	80	100	860	30	210	/	/	/	/	/	/	/	610	570	105	2×200	250	235	480	440	100	1×240	50	10-Φ19	Y112M-2	4	
				840																						Y100L-2	3	
40FYW-40	800,1000,1500,1735, 1800,2000,2500	80	100	935	30	210	/	/	/	/	/	/	/	610	570	105	2×200	250	235	480	440	100	1×240	50	10-Φ19	Y132S ₁ -2	5.5	
				860																						Y112M-2	4	
40FY-40	670,800,915,1105 1315,1415,1635,1735 2030,2300,2600,2700	80	100	745	25	205	565	525	465	271	95	20	6-Φ18	/	/	/	/	/	/	/	/	/	/	/	/	Y100L-2	3	
				700																						Y90L-2	2.2	
40FY-65	1105,1415,2000,2800 3000	80	100	805	25	205	565	525	465	271	95	20	6-Φ18	/	/	/	/	/	/	/	/	/	/	/	/	Y132S ₂ -2	7.5	
																										Y132S ₁ -2	5.5	
50FYW-10	937,1232	80	125	700	30	210	/	/	/	/	/	/	/	610	570	105	2×200	250	235	480	440	100	1×240	50	10-Φ19	Y80 ₂ -4	0.75	
				650																						Y90S-4	1.1	

注：液下深度(L)还可根据用户要求定制。

Note: The submerged depth (L) can also be decided by user's requirement.

泵外形及安装尺寸表 Overall and Installation Dimensions

泵型号 Pump model	外形及安装尺寸 Overall and installation dimensions (mm)																							电机 Motor (kW)			
	L (Submerged depth)	L ₁	L ₂	H ₁	H ₂	H ₃	圆底座 Round baseplate							方底座 Square baseplate												型号 Model	功率 Power
							D ₁	D ₂	D ₃	b ₁	b ₂	β	n ₁ -Φd ₁	B ₁	B ₂	B ₃	nxB ₄	B ₅	B ₆	A ₁	A ₂	A ₃	nxA ₄	A ₅	n ₂ -Φd ₂		
50FYW-14	800,930,987,1042 1430,1600,1830,2342 2501,2700	57	/	285	15	269	/	/	/	/	/	/	/	545	505	252.5	0	84	306	545	505	219.5	1x66	52.5	6-Φ20	Y80 ₂ -2	1.1
50FY-16	600,1000,1105,1415, 1735,2405,2500,2700 2900,3175	80	125	700	25	205	540	500	450	253	90	12	6-Φ18	560	520	80	2x200	240	190	400	360	80	1x200	50	10-Φ19	Y90S-2	1.5
				650																						Y80 ₂ -2	1.1
50FY-25	735,820,1000,1105, 1250,1415,1500,1600, 1735,1900,2030,2780, 2800,3300	80	125	745	25	205	565	525	465	271	95	20	6-Φ18	/	/	/	/	/	/	/	/	/	/	/	/	Y100L-2	3
				700																						Y90L-2	2.2
50FYW-30	1250,1800,2500	125	125	990	35	160	/	/	/	/	/	/	/	820	760	0	0	400	280	540	480	0	0	50	4-Φ20	Y132S-4	5.5
				935																						Y112M-4	4
50FYW-40	937,1232	80	125	1000	30	210	/	/	/	/	/	/	/	610	570	85	2x200	250	235	480	440	100	1x240	50	10-Φ19	Y132S ₂ -2	7.5
																										Y132S ₁ -2	5.5
50FY-40	820,930,1076,1100, 1415,1750,1880,2100, 2160,2500,2760	80	125	995	35	230	/	/	/	/	/	/	/	670	610	0	0	250	580	540	480	0	0	50	4-Φ20	Y132S ₁ -2	5.5
				935																						Y112M-2	4
50FY-63	1100,1420,1740,2035, 2499	80	125	1060	30	215	700	650	590	296	100	22	6-Φ18	/	/	/	/	/	/	/	/	/	/	/	/	Y160M ₁ -2	11
																										Y132S ₂ -2	7.5
50FY-80	3600,	100	125	1060	30	215	700	650	590	327	136	23	6-Φ18	/	/	/	/	/	/	/	/	/	/	/	/	Y160M ₁ -2	11
				920																						Y132S ₂ -2	7.5
50FY-100	1500,1750,2000	80	125	1120	35	215	760	680	600	321	110	22.5	8-Φ23	/	/	/	/	/	/	/	/	/	/	/	/	Y180M-2	22
				1100																						Y160L-2	18.5
65FYW-10	1500,1750,2000,2500, 3150	85	130	750	30	210	/	/	/	/	/	/	/	610	570	85	2x200	250	235	480	440	100	1x240	50	10-Φ19	Y100L ₁ -4	2.2
65FYW-16	800,1000,1175,1485 1705,1805,2100,3235 3255	140	130	745	25	205	/	/	/	/	/	/	/	660	600	30	4x150	300	210	420	360	180	0	60	12-Φ18	Y100L ₂ -4	3
																										Y100L ₁ -4	2.2
65FY-16	700,1000,1100,1175, 1410,1500,1600,1730 2310,2500,2785,3300 4905	75	130	765	25	205	540	500	450	253	90	12	6-Φ18	560	520	80	2x200	240	190	400	360	80	1x200	50	10-Φ19	Y100L-2	3
				710																						Y90L-2	2.2

泵外形及安装尺寸表 Overall and Installation Dimensions

泵型号 Pump model	外形及安装尺寸 Overall and installation dimensions (mm)																							电机 Motor (kW)				
	L (Submerged depth)	L ₁	L ₂	H ₁	H ₂	H ₃	圆底座 Round baseplate							方底座 Square baseplate											型号 Model	功率 Power		
							D ₁	D ₂	D ₃	b ₁	b ₂	β	n ₁ -Φd ₁	B ₁	B ₂	B ₃	nxB ₄	B ₅	B ₆	A ₁	A ₂	A ₃	nxA ₄	A ₅			n ₂ -Φd ₂	
65FY-20	1500,1750,2000	100	130	830 790	30	215	760	680	600	321	110	22.5	8-Φ23	/	/	/	/	/	/	/	/	/	/	/	/	/	Y100L1-4	2.2
																										Y90L-4	1.5	
65FYW-25	600,1110,1420,1500, 1740,1825,2300	85	130	840 765	25	205	565	525	465	271	95	20	6-Φ18	/	/	/	/	/	/	/	/	/	/	/	/	/	Y132S1-2	5.5
																										Y112M-2	4	
65FY-25	1000,1100,1420,1430, 1500,1525,1740,1880 2035,2500,2800,3025 3655,4440	85	130	840 765	25	205	565	525	465	271	95	20	6-Φ18	/	/	/	/	/	/	/	/	/	/	/	/	/	Y132S1-2	5.5
																										Y112M-2	4	
65FYW-40	1300,1700,2700,3150	85	130	1085 1085 1000	30	210	/	/	/	/	/	/	/	610	570	85	2x200	250	235	480	440	100	1x240	50	10-Φ19	Y160M2-2	15	
																										Y160M1-2	11	
																										Y132S2-2	7.5	
65FY-40	1000,1115,1425,1745 2040,2160,2300,2800 3000,4445,4900	85	130	900	30	210	700	650	590	296	100	22	6-Φ18	/	/	/	/	/	/	/	/	/	/	/	/	/	Y132S2-2	7.5
																										Y132S1-2	5.5	
65FY-64	1150,1500,1700,2115 2600,2800,3000	100	130	1060	30	215	700	650	590	327	136	23	6-Φ18	/	/	/	/	/	/	/	/	/	/	/	/	/	Y160M2-2	15
																										Y160M1-2	11	
65FY-80	1500,1750,2000	100	130	1060	30	215	760	680	600	321	110	22.5	8-Φ23	/	/	/	/	/	/	/	/	/	/	/	/	/	Y160M2-2	15
																										Y160M1-2	11	
65FY-125	1500,1750,2000	125	130	1230 1120	30	215	900	840	700	345	112	22.5	8-Φ25	/	/	/	/	/	/	/	/	/	/	/	/	/	Y200L1-2	30
																										Y180M-2	22	
80FY-15	540,800,890,1120 1437,1600,1750,2640 2799,3240	90	150	900 825	30	215	700	650	590	296	100	22	6-Φ18	/	/	/	/	/	/	/	/	/	/	/	/	/	Y132S1-2	5.5
																										Y112M-2	4	
80FY-20	1500,1750,2000,2200	125	150	930 850	35	210	760	680	600	300	106	22.5	8-Φ23	/	/	/	/	/	/	/	/	/	/	/	/	/	Y132S-4	5.5
																										Y112M-4	4	
80FY-24	490,600,640,1115 1390,1425,1500,1690 1745,1840,2380,3500 4140	85	150	900	30	215	700	650	590	296	100	22	6-Φ18	/	/	/	/	/	/	/	/	/	/	/	/	/	Y132S2-2	7.5
																										Y132S1-2	5.5	
80FY-32	1500,1750,2000	125	150	970 930	35	255	900	840	750	400	122	22.5	8-Φ25	/	/	/	/	/	/	/	/	/	/	/	/	/	Y132M-4	7.5
																										Y132S-4	5.5	

泵外形及安装尺寸表 Overall and Installation Dimensions

泵型号 Pump model	外形及安装尺寸 Overall and installation dimensions (mm)																							电机 Motor (kW)								
	L (Submerged depth)	L ₁	L ₂	H ₁	H ₂	H ₃	圆底座 Round baseplate							方底座 Square baseplate											型号 Model	功率 Power						
							D ₁	D ₂	D ₃	b ₁	b ₂	β°	n ₁ -Φd ₁	B ₁	B ₂	B ₃	nxB ₄	B ₅	B ₆	A ₁	A ₂	A ₃	nxA ₄	A ₅			n ₂ -Φd ₂					
80FYW-38	1045,1340,1650,2390 2550,2800,3540,3700	164	150	1060	30	210	700	650	590	296	100	22	6-Φ18	/	/	/	/	/	/	/	/	/	/	/	/	Y160M ₂ -2	15					
														/	/	/	/	/	/	/	/	/	/	/	/	/	/	/	/	/	/	Y160M ₁ -2
80FY-38	910,1053,1100,1590 1930,2040,2390,2725 3540,4340	90	150	1060	30	210	700	650	590	296	100	22	6-Φ18	/	/	/	/	/	/	/	/	/	/	/	/	Y160M ₂ -2	15					
														/	/	/	/	/	/	/	/	/	/	/	/	/	/	/	/	/	/	Y160M ₁ -2
80FYW-60	1500,2000,2640,3000 3500	194	160	1130	30	210	700	650	590	300	100	30	6-Φ18	/	/	/	/	/	/	/	/	/	/	/	/	Y180M-2	22					
				1060										/	/	/	/	/	/	/	/	/	/	/	/	/	/	/	/	Y160L-2	18.5	
				1060										/	/	/	/	/	/	/	/	/	/	/	/	/	/	/	/	/	/	/
80FY-60	1130,1440,1760,2095 2800	100	150	1180	30	215	700	650	590	327	136	23	6-Φ18	/	/	/	/	/	/	/	/	/	/	/	/	Y180M-2	22					
				1130										/	/	/	/	/	/	/	/	/	/	/	/	/	/	/	/	/	Y160L-2	18.5
				1060										/	/	/	/	/	/	/	/	/	/	/	/	/	/	/	/	/	/	/
80FY-97	1312,1500,1750,2000 2400	125	150	1440	35	220	900	840	700	400	122	22.5	8-Φ25	/	/	/	/	/	/	/	/	/	/	/	/	Y200L ₂ -2	37					
				1440										/	/	/	/	/	/	/	/	/	/	/	/	/	/	/	/	/	Y200L ₁ -2	30
				1380										/	/	/	/	/	/	/	/	/	/	/	/	/	/	/	/	/	/	/
80FY-125	1500,1750,2000	125	150	1500	35	255	900	840	750	400	122	22.5	8-Φ25	/	/	/	/	/	/	/	/	/	/	/	/	Y225M-2	45					
				1440										/	/	/	/	/	/	/	/	/	/	/	/	/	/	/	/	/	/	Y200L ₂ -2
100FY-20	1500,1750,2000,2400	125	200	930	25	340	900	840	700	380	150	22.5	8-Φ25	/	/	/	/	/	/	/	/	/	/	/	/	Y132S-4	5.5					
				850										/	/	/	/	/	/	/	/	/	/	/	/	/	/	/	/	/	/	Y112M-4
100FYW-22	550,1116,1411,1670 1721,1797,2033,2400 2711,2753,3000,3326 3626	185	/	875	30	215	755	705	650	350	140	22.5	16-Φ25	/	/	/	/	/	/	/	/	/	/	/	/	Y160M-4	11					
				745										/	/	/	/	/	/	/	/	/	/	/	/	/	/	/	/	/	/	Y132M-4
100FYW-23 100FYW-24	550,1116,1411,1670 1721,1797,2033,2400 2711,2753,3000,3326 3626	185	/	920	30	215	755	705	650	350	140	22.5	16-Φ25	/	/	/	/	/	/	/	/	/	/	/	/	Y160L-4	15					
				875										/	/	/	/	/	/	/	/	/	/	/	/	/	/	/	/	/	/	Y160M-4
100FY-23	600,1930,2112,2300 2587	100	200	1030	35	215	/	/	/	/	/	/	/	800	752	150	2x225	279	260	550	502	101	1x300	50	10-Φ18	Y160M ₁ -2	11					
							/	/	/	/	/	/	/	/	/	/	/	/	/	/	/	/	/	/	/	/	/	/	Y132S ₂ -2	7.5		

泵外形及安装尺寸表 Overall and Installation Dimensions

泵型号 Pump model	外形及安装尺寸 Overall and installation dimensions (mm)																							电机 Motor (kW)				
	L (Submerged depth)	L ₁	L ₂	H ₁	H ₂	H ₃	圆底座 Round baseplate							方底座 Square baseplate											型号 Model	功率 Power		
							D ₁	D ₂	D ₃	b ₁	b ₂	β	n ₁ -Φd ₁	B ₁	B ₂	B ₃	nxB ₄	B ₅	B ₆	A ₁	A ₂	A ₃	nxA ₄	A ₅			n ₂ -Φd ₂	
100FY-32	1760	125	200	1270 1180	25	340	/	/	/	/	/	/	/	1280	1220	180	2x430	635	370	820	760	150	1x460	95	10-Φ25	Y160M-4	11	
																										Y132M-4	7.5	
100FYW-37	1129,1411,1850,2350 3540	100	200	1285 1180 1130	35	230	/	/	/	/	/	/	/	720	670	60	3x200	298	250	500	450	105	1x240	55	10-Φ20	Y200L ₁ -2	30	
																										Y180M-2	22	
																										Y160L-2	18.5	
100FY-37	1065,1670,1760,1850 1990,2350,2500,2750 3000,3325,3540	100	200	1130 1060	35	230	/	/	/	/	/	/	/	720	670	60	3x200	298	250	500	450	105	1x240	55	10-Φ20	Y160L-2	18.5	
																										Y160M ₂ -2	15	
100FY-57	1385,1450,1770,2105 2350,2800	100	200	1210 1100 1080	30	225	700	650	590	327	136	23	6-Φ18	/	/	/	/	/	/	/	/	/	/	/	/	/	Y200L ₁ -2	30
																										Y180M-2	22	
																										Y160L-2	18.5	
100FY-80	1500,1750,2000,2200 2500	125	200	1450 1450	25	340	900	840	700	380	150	22.5	8-Φ25	/	/	/	/	/	/	/	/	/	/	/	/	Y200L ₂ -2	37	
																										Y200L ₁ -2	30	
125FY-20	1800,2200,2500,3600	140	300	1270 1180	25	340	/	/	/	/	/	/	/	1060	1000	180	2x320	430	340	740	680	180	1x320	110	10-Φ25	Y160M-4	11	
																										Y132M-4	7.5	
125FY-32	4260,5800	140	300	1380 1360	30	340	/	/	/	/	/	/	/	1100	1040	100	3x280	440	403	820	760	100	2x280	110	14-Φ25	Y180M-4	18.5	
																										Y160L-4	15	
125FY-50	1750	140	300	1450 1380	30	340	/	/	/	/	/	/	/	1180	1120	140	3x280	480	403	820	760	100	2x280	110	14-Φ25	Y200L ₁ -2	30	
																										Y180M-2	22	
125FY-74	1800,2200,2500,3000 3600	140	300	1650 1580	25	340	/	/	/	/	/	/	/	1060	1000	180	2x320	430	340	740	680	180	1x320	110	10-Φ25	Y280S-2	75	
																										Y250M-2	55	
150FYW-22	1100,1900,8000	140	300	1420 1380	25	340	/	/	/	/	/	/	/	1280	1220	180	2x430	635	370	820	760	150	1x460	95	10-Φ25	Y180L-4	22	
																										Y180M-4	18.5	
150FY-22	1190,1357,1665,1900 2392,3300,3647	140	300	1420 1380	25	340	/	/	/	/	/	/	/	1280	1220	180	2x430	635	370	820	760	150	1x460	95	10-Φ25	Y180L-4	22	
																										Y180M-4	18.5	
150FYW-30	1223,1600,2000,3000 4447,5547	124	300	1450 1420	25	330	/	/	/	/	/	/	/	1280	1220	180	2x430	635	370	820	760	150	1x460	95	10-Φ25	Y200L-4	30	
																										Y180L-4	22	

泵外形及安装尺寸表 Overall and Installation Dimensions

泵型号 Pump model	外形及安装尺寸 Overall and installation dimensions (mm)																							电机 Motor (kW)			
	L (Submerged depth)	L ₁	L ₂	H ₁	H ₂	H ₃	圆底座 Round baseplate							方底座 Square baseplate											型号 Model	功率 Power	
							D ₁	D ₂	D ₃	b ₁	b ₂	β	n ₁ -Φd ₁	B ₁	B ₂	B ₃	n×B ₄	B ₅	B ₆	A ₁	A ₂	A ₃	n×A ₄	A ₅			n ₂ -Φd ₂
150FY-35	1223,1600,2000,3000 3699,4457,5557	124	300	1550	25	340	/	/	/	/	/	/	/	1280	1220	180	2×430	635	370	820	760	150	1×460	95	10-Φ25	Y225S-4	37
				1500																						Y200L-4	30
150FY-56	1000,1525,2500,3900	155	300	1700	25	340	/	/	/	/	/	/	/	1280	1220	180	2×430	635	370	820	760	150	1×460	95	10-Φ25	Y250M-4	55
				1480																						Y225M-4	45
150FY-80	1500,1760,2000	140	300	1900	25	340	/	/	/	/	/	/	/	1280	1220	180	2×430	635	370	820	760	150	1×460	95	10-Φ25	Y315S-2	110
				1710																						Y280M-2	90
				1660																						Y280S-2	75
200FY-21	1610,1800,1900,2100 2300,2400,3320,3810	240	310	1480	25	340	/	/	/	/	/	/	/	1280	1220	180	2×430	635	370	820	760	150	1×460	95	10-Φ25	Y225S-4	37
				1450																						Y200L-4	30
200FY-30	1000,1660,2160,2390, 4180,7060	160	310	1800	35	350	/	/	/	/	/	/	/	1730	1660	230	2×600	840	500	1100	1030	190	1×650	105	10-Φ28	Y250M-4	55
				1610																						Y225M-4	45
				1590																						Y225S-4	37
200FY-34	1000,1660,2160,3390 4180,7060	160	310	1800	35	350	/	/	/	/	/	/	/	1730	1660	230	2×600	840	500	1100	1030	190	1×650	105	10-Φ28	Y250M-4	55
				1610																						Y225M-4	45
200FY-50	1500,1800,2000,2200 2500,3000,4000,5000 6000	160	310	1850	35	380	/	/	/	/	/	/	/	1490	1430	160	3×370	660	500	1000	940	160	2×310	115	14-Φ27	Y280M-4	90
				1770																						Y280S-4	75
				1700																						Y250M-4	55
200FY-63	1800,2000,2200,2400 3000	180	310	2050	30	380	/	/	/	/	/	/	/	1490	1430	160	3×370	660	500	1000	940	160	2×310	115	14-Φ27	Y315S-4	110
				1850																						Y280M-4	90
				1770																						Y280S-4	75
250FY-39	1500,1800,2000,2200 2500,3000,4000,5000 6000	200	300	1770	30	380	/	/	/	/	/	/	/	1490	1430	160	3×370	660	500	1000	940	160	2×310	115	14-Φ27	Y280S-4	75
				1700																						Y250M-4	55
				1610																						Y225M-4	45

泵外形及安装尺寸表 Overall and Installation Dimensions

泵型号 Pump model	外形及安装尺寸 Overall and installation dimensions (mm)																							电机 Motor (kW)				
	L (Submerged depth)	L ₁	L ₂	H ₁	H ₂	H ₃	圆底座 Round baseplate							方底座 Square baseplate											型号 Model	功率 Power		
							D ₁	D ₂	D ₃	b ₁	b ₂	β	n ₁ -Φd ₁	B ₁	B ₂	B ₃	n×B ₄	B ₅	B ₆	A ₁	A ₂	A ₃	n×A ₄	A ₅			n ₂ -Φd ₂	
250FY-60	1800,2000,2400,3000	225	300	2300	30	380	/	/	/	/	/	/	/	1650	1590	95	4×350	770	515	1040	980	140	2×350	115	16-Φ27	Y315L1-4	160	
				2100																						Y315M-4	132	
				2050																						Y315S-4	110	
300FY-14	1500,2000,2500,3000 3500,3850	250	300	1600	30	340	/	/	/	/	/	/	/	1650	1590	95	4×350	740	515	1040	980	140	2×350	115	16-Φ27	Y250M-6	37	
				1510																						Y225M-6	30	
				1440																						Y200L2-6	22	
300FY-16	1500,1800,2000,2200 2500	250	380	1600	35	340	/	/	/	/	/	/	/	1490	1430	160	3×370	690	450	1000	940	160	2×310	115	14-Φ27	Y250M-4	55	
				1510																						Y225M-4	45	
				1485																						Y225S-4	37	
300FY-32	1800, 2000, 2200, 2400, 3100, 4900	250	300	1950	30	340	/	/	/	/	/	/	/	1650	1590	95	4×350	740	515	1040	980	140	2×350	115	16-Φ27	Y315S-4	110	
				1730																						Y280M-4	90	
				1680																						Y280S-4	75	
				1600																						Y250M-4	55	
300FY-52	1800, 2000, 2200, 2400, 3000	250	300	2200	30	400	/	/	/	/	/	/	/	1740	1680	140	4×350	800	515	1040	980	140	2×350	115	16-Φ27	Y315L-4	185	
				2200																						Y315L1-4	160	
				2100																						Y315M-4	132	

泵进出口法兰尺寸

The Dimensions of Suction & Discharge Flange

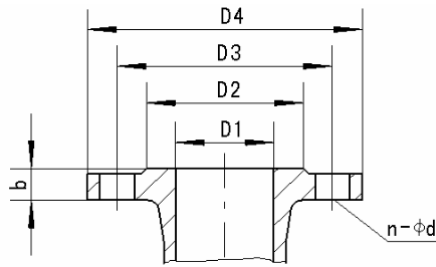

泵型号 Pump Model	进口法兰 Suction flange						出口法兰 Discharge flange (mm)					
	D1	D2	D3	D4	b	n-φd	D1	D2	D3	D4	b	n-φd
25FY-16	25	60	75	100	16	4-φ14	25	65	85	115	16	4-φ14
25FY-25, 25FY-41	25	65	85	115	16	4-φ14	25	65	85	115	16	4-φ14
40FY-16, 40FY-26,	40	80	100	130	16	4-φ14	25	65	85	115	16	4-φ14
40FY-40, 40FY-65	50	99	125	165	16	4-φ18	50	100	125	165	17	4-φ18
40FYW-8, 40FYW-30, 40FYW-40	40	80	100	130	16	4-φ14	50	100	125	165	17	4-φ18
50FYW-14	φ80 喇叭管 Flared pipe						50	100	125	165	17	4-φ18
50FY-16, 50FY-30, 50FY-40, 50FY-63	50	99	125	165	17	4-φ18	50	100	125	165	17	4-φ18
50FYW-10, 50FYW-40, 50FY-25	50	90	110	140	16	4-φ14	50	100	125	165	17	4-φ18
50FY-80, 50FY-100	50	90	110	140	16	4-φ14	32	76	100	140	18	4-φ18
65FYW-16	65	110	130	160	16	4-φ14	50	100	125	165	17	4-φ18
65FYW-10, 65FY-16, 65FY-20, 65FY-25, 65FYW-25,65FYW-40, 65FY-40, 65FY-64, 65FY-80,65FY-125	65	110	130	160	16	4-φ14	50	100	125	165	17	4-φ18
80FY-15, 80FY-20, 80FY-32,80FYW-38, 80FY-38, 80FY-24,80FY-60, 80FYW-60, 80FY-125	80	125	150	185	18	4-φ18	65	118	145	185	18	4-φ18
80FY-97	80	135	160	200	20	8-φ18	65	118	145	185	18	4-φ18
100FY-23, 100FYW-24,100FYW-37, 100FY-37,100FY-57	100	145	170	205	18	4-φ18	80	132	160	200	20	8-φ18
100FYW-22, 100FYW-23, 100FYW-24	φ140 喇叭管 Flared pipe						100	156	180	220	20	8-φ18
100FY-20, 100FY-32	100	156	180	220	22	8-φ18	80	132	160	200	20	8-φ18
100FY-80	100	156	180	220	22	8-φ18	100	156	180	220	20	8-φ18
125FY-20, 125FY-32, 125FY-50 125FY-74	125	184	210	250	22	8-φ18	100	156	180	220	20	8-φ18
150FY-22, 150FYW-30, 150FY-35, 150FYW-22, 150FY-80	150	210	240	285	22	8-φ23	150	/	240	285	22	8-φ18
150FY-56, 150FY-58	150	210	240	280	24	8-φ23	150	212	240	285	22	8-φ18
200FY-21,	200	263	295	340	30	12-φ18	150	212	240	285	22	8-φ18
200FY-30, 200FY-34	200	265	295	340	22	8-φ22	200	/	295	340	25	12-φ23
200FY-50, 200FY-63	200	266	295	340	22	12-φ22	200	266	295	340	25	12-φ23
250FY-39, 250FY-60	250	320	350	390	25	12-φ23	200	266	295	340	25	12-φ23
300FY-14, 300FY-16, 300FY-32,300FY-52	300	368	400	440	28	12-φ23	250	330	362	405	30	12-φ26