

KS Series

Tact Switches(Illuminated)



SPECIFICATIONS

- RATING** : 100mA max, 42 VAC/DC
- MECHANICAL LIFE** : 1,000,000 cycles
- CONTACT RESISTANCE** : 100mΩ max.(initial)
- INSULATION RESISTANCE** : 1000MΩ min.
- DIELECTRIC STRENGTH** : 1,000 VAC
- FORCE** : 3N±0.75N
- TRAVEL** : 0.6±0.2mm
- OPERATING TEMPERATURE RANG** : -25°C~+70°C

MATERIALS

- SWITCH HOUSING** : PBT
- TRANSPARENT ACTUATOR** : PC
- ACTUATOR** : ABS
- CONTACT** : Stainless,Au or Ag plated
- TERMINALS** : Brass,Au or Ag plated
- TERMINAL SEAL** : Epoxy

HOW TO ORDER

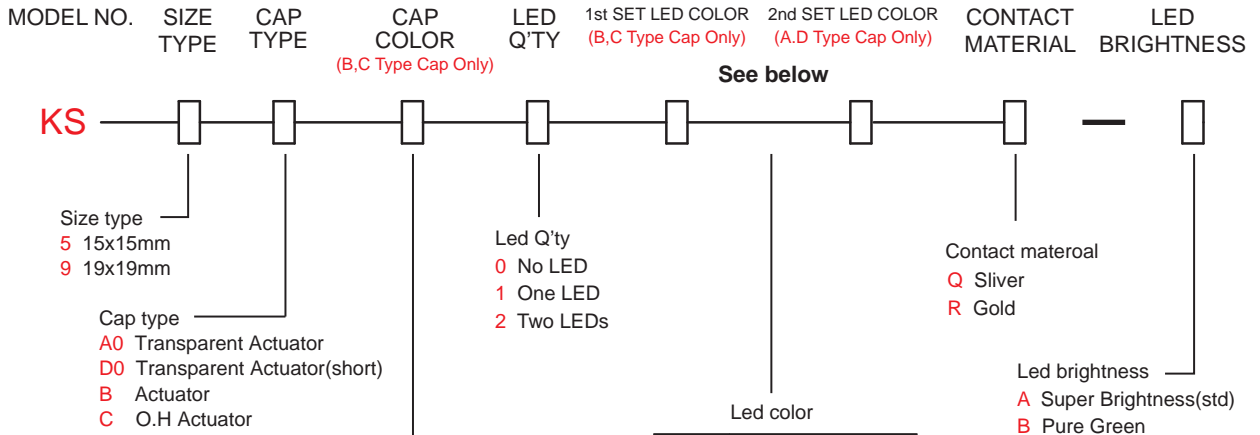

ITEM NO	COLOR
1	White (Std)
3	Red (Std)
4	Orange
5	Yellow
6	Green
7	Blue

ITEM NO	COLOR
0	Without LED
1	White
3	Red
5	Yellow
6	Green
7	Blue
DUAL COLOR LED	
A	Red&Pure Green
B	Yellow&Pure Green

* Besides standard color, other colors need to check stocks available.

EXAMPLE:
 KS5A0000R (Without LED)
 KS5A020 [] R-A
 |
 LED color
 KS5B [] 2 [] 0R-A
 | |
 LED color CAP color

P.C.B MOUNTING / CIRCUIT

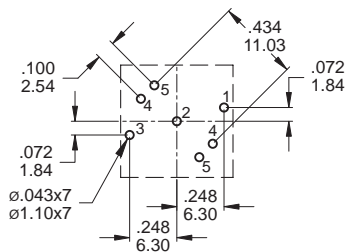

KS5A CAP Type
TOP VIEW

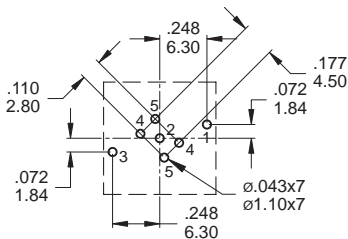

KS5B/C CAP Type
TOP VIEW

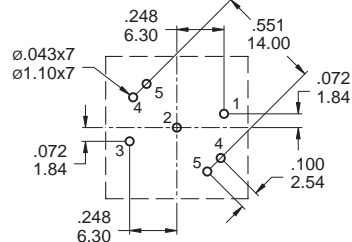

KS9A CAP Type
TOP VIEW

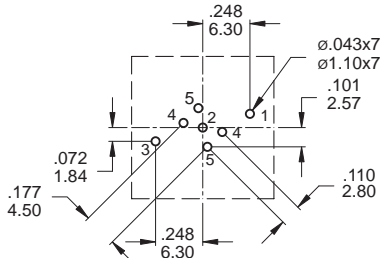

KS9B/C CAP Type
TOP VIEW

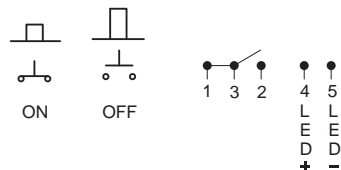

CIRCUIT

KS5A0

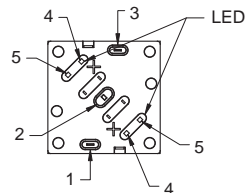
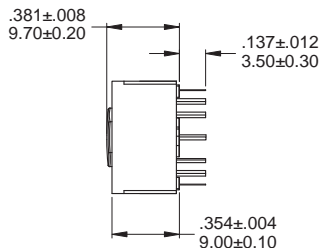
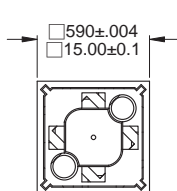

KS5D0

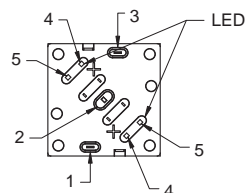
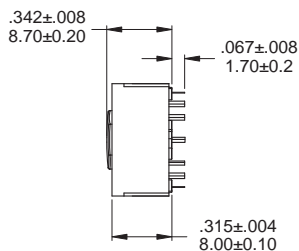
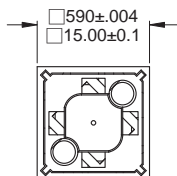

KS5B

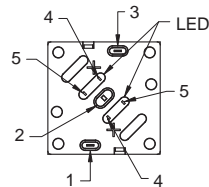
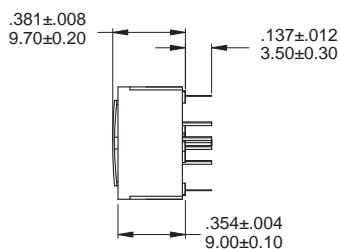
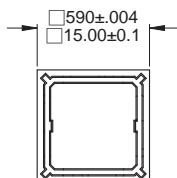

KS Series

Tact Switches(Illuminated)

KS5C

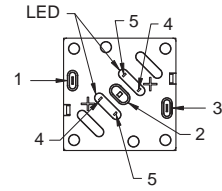
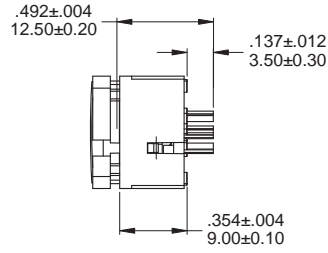
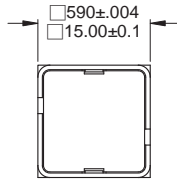

KS9A

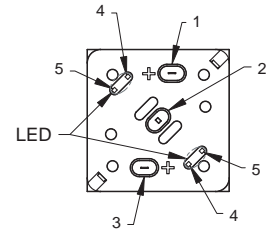
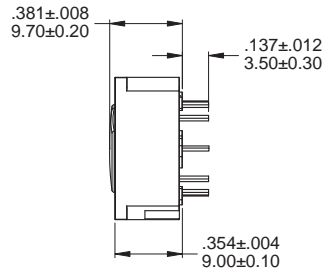
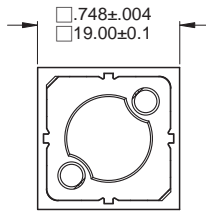

KS9B

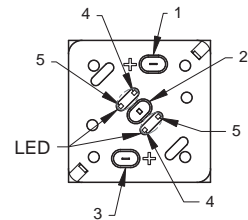
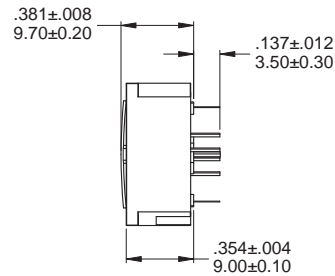
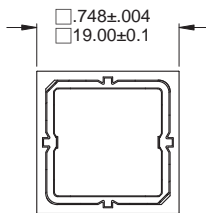
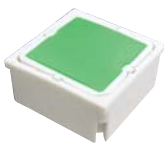

KS9C

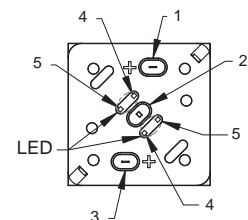
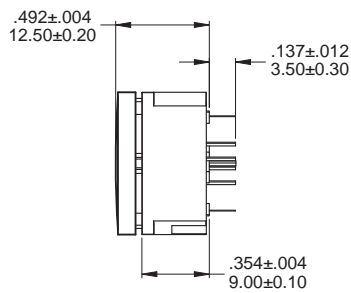
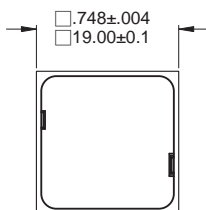

KS
Tact Switches