

INSTRUCTION MANUAL

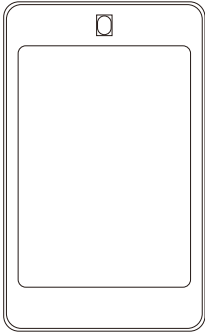

PIR Sensor

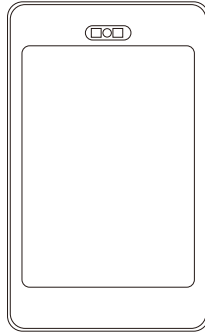

IR Sensor

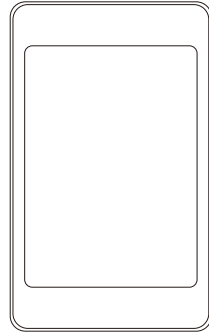

No Sensor

Features:

- 1.Safety Voltage: DC 12V/24V
- 2.Protection: IP20
- 3.Beam Angle: 120 degrees
- 4.Efficiency: >80Lm/W
- 5.CRI: >80

Function:

IR

- I. Shielding reflective sensor dimming. Effective sensing distance of obstruction (e.g.: hand) to the sensor is within 50mm.
- II. When in effective sensing distance,
 - A.Occlusion time <700ms, it's for ON-OFF function
 - B.Occlusion time >700ms, it's for Dimming function
- III. Power by default is OFF state. Dimming maximum brightness 100%, minimum brightness 2%
 - C.If operator action II Item A, showing the state of ON. the brightness automatically fade to maximum after 2 seconds. If operate again, it shows the opposite state.
 - D.If operator action II Item B, the brightness dimming from 0. Dimming ratio is the same with the ratio of the Occlusion duration, brightness adjustment time up to 5 seconds. If the operation above action again after remove the obstruction, it shows the opposite state.

PIR

The integrated PIR sensor offers touchless switching of the unit when opening the furniture door

Advantages:

1. Ultra thin Design, Side-Emitting,no LED Dot visible;
2. No UV or RF interference,Eco-friendly;
3. Long life time 50,000+hrs,3 years Warranty;
4. Surface mounted with screws or 3M Tape;
5. IR Sensor and PIR Sensor Build-in.
6. CRI 80/90/95 Available.
7. Replace 35W Halogen Lamp.

Applications:

Windows, shelves,cabinets, display cabinets,furniture,bars,showrooms, museums,reading room.

Notice

- After opening the package, please check the lamps are intact. Check for scratches the surface, the lack of accessories.
- Make sure that the lamp does not have any damage during transport. Otherwise, please do not install.
- Before installing or cleaning, please turn off the power.
- This product installation requires facing away from the sun or other infrared light emitters, so as not to interfere with trigger or sensor malfunction.
- The packaging materials should be away from children to prevent child swallowed.
- Please use a dry towel to clean the lamp, do not wipe with alcohol and other corrosive liquids.
- Non-professionals do not disassemble or repair the product, if unauthorized removal or repair, we will not be warranty.
- The installation instructions diagram for reference only, please prevail in kind
- Sure the lamps connected correctly to avoid damage to the power supply.

Dimensions: mm

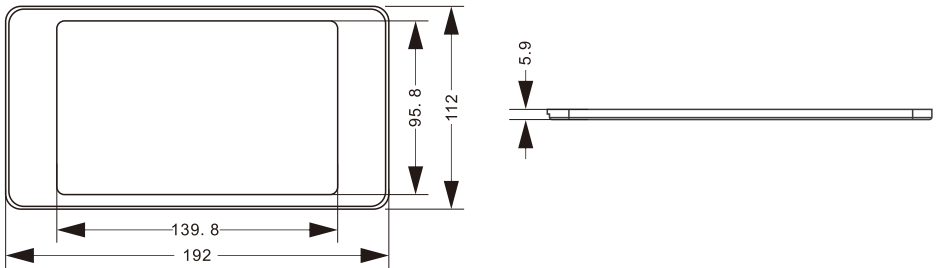

Specification:

Model No.	Size/MM	Luminance	Efficiency	Voltage	Power	CCT	CRI
PL192-112-072 (No Sensor)	192*112*6.7	350LM	>80%	DC12V/24V	5W	2700k,3000k 4000k,5000k	84
PL192-112-073 (IR Sensor)	192*112*6.7	350LM	>80%	DC12V/24V	5W	2700k,3000k 4000k,5000k	84
PL192-112-074 (PIR Sensor)	192*112*6.7	350LM	>80%	DC12V/24V	5W	2700k,3000k 4000k,5000k	84

Accessories:

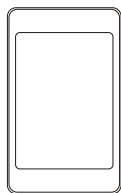

Light



Screw

Installations(single lighting)

1 Open the front cover.

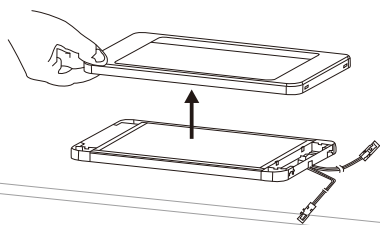

2 Drilling after measuring the hole.

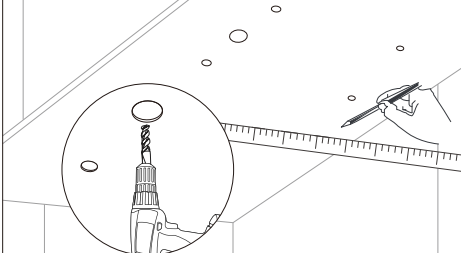

3 Install with screws aligning to the located hole.

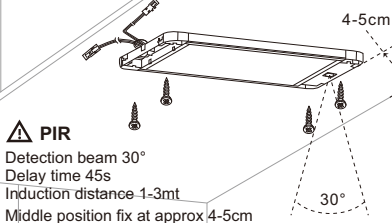

PIR
Detection beam 30°
Delay time 45s
Induction distance 1-3m
Middle position fix at approx 4-5cm

4 Plug with driver, cover with the front cover.

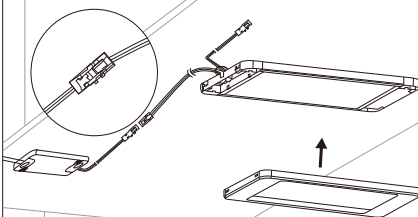

3-1 with max 3 lights and 2m cable can be connected.

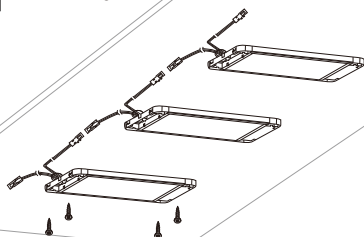

4-1 Connect the lights in turns.

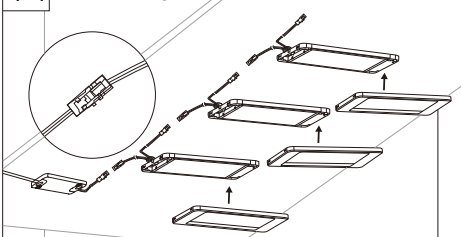

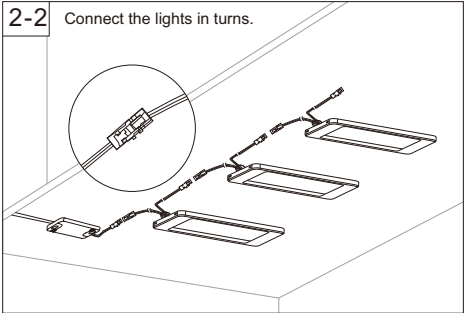
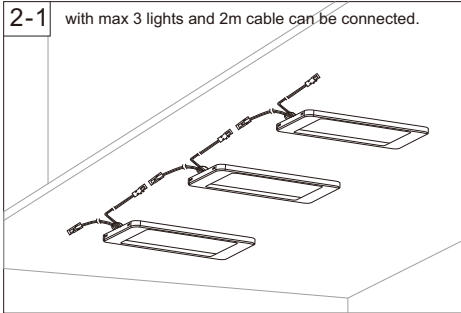
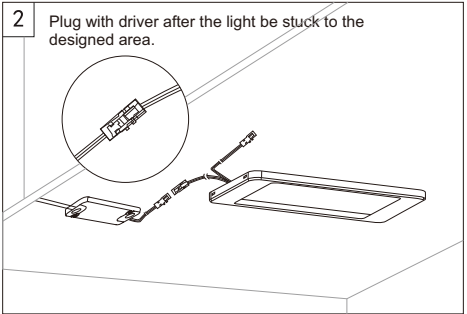
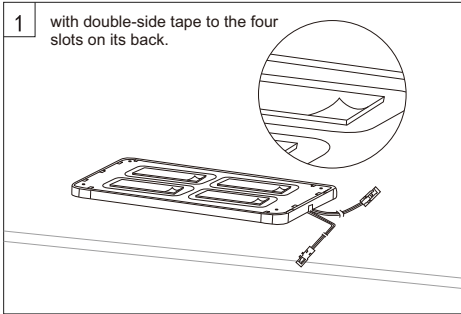

C.How to order

Part Number	Panel light (Qty)	LED driver (Qty)	Max Output Wattage	DC Output Voltage	Current Accuracy	Efficiency(typical)		Certification
						110VAC	230VAC	
PWB010N012BPCCA	1	1	10W	12V	±3%	80%	81%	
PWB010N024BPCCA				24V				
PWB010N012BPCCA	2	1	10W	12V	±3%	80%	81%	
PWB010N024BPCCA				24V				
PWB015N012BPCCA	3	1	15W	12V	±3%	82%	83%	
PWB015N024BPCCA				24V				

⚠ Wiring Diagram:

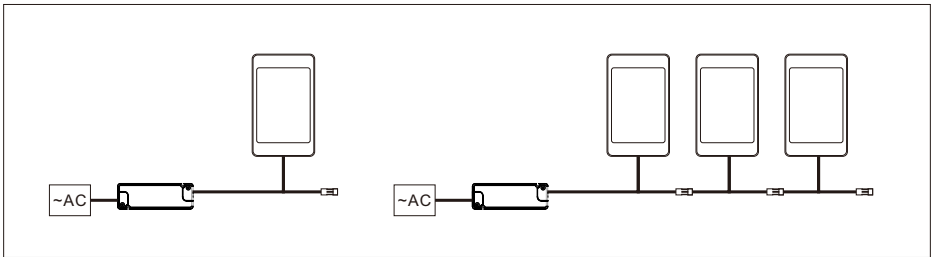

After-sale service:

- In the warranty period of the product, the quality problem caused by the proper operation, we provide three years warranty. Barring:
- earthquake, fire, flood and other natural disasters; power network fault, pollution and chemical corrosion caused by damage.
 - damage caused by improper operation, improper storage, improper removal or improper maintenance.
 - in the development of maintenance point, change the program or the replacement of components caused by damage.