

管材粉碎机RG-36P
Pipe centralized granulator

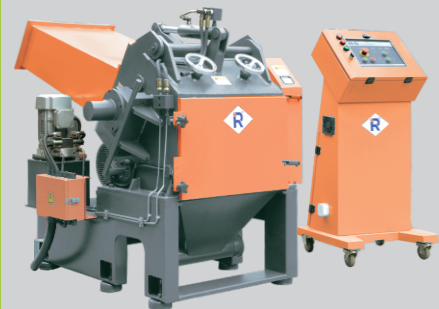

片材在线粉碎机RG-21QX
Sheet on-line granulator

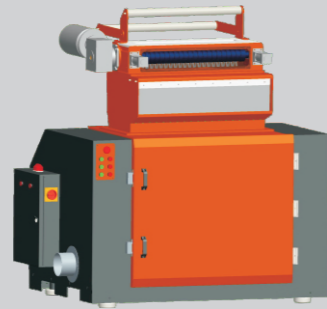

块料撕碎机RG-22SS
Block single shaft shredder



管材粉碎机，专为长尺寸管材和型材设计，较低的喂料口，更是适合长尺寸材料的喂料。

片材在线粉碎机，专为片材挤出及压塑生产过程中产生的边角料回收而设计，可自动进行喂料且回收材料可投入生产线再利用。

块料撕碎机专为回收注塑和吹塑行业的中小型块料而设计，如机头料，通过撕碎机粗粉碎再通过粉碎机进一步粉碎后重新回到生产线。

Description:

Pipe centralized granulators are mainly used to directly granulate the PVC and PE tubings, PVC sectional and profiled bar. The machine is applicable for crushing long pipes and profiles.

Sheet on-line granulators are mainly used for plastic edges recycling system during producing in the process of sheet extrusion and compression molding. This kind of granulator can feed material automatically into cutting chamber and conveying the regrind material back to production line.

Block single shaft shredders are mainly used to crush sprue, head material, block from injection molding machine or blow molding machine. After shredding into Dia40mm material, recrushed into Dia12mm by granulators. Special design to ensure the material out of pollution and overheat.



宁波北仑日宏机械制造有限公司
Ningbo Beilun Rhong Machinery Manufacturing Co., Ltd

地址：浙江·宁波·北仑·小港街道·东岗碶
Donggangqi, Xiaogang Subdistrict, Beilun,
Ningbo, Zhejiang Province, China.

T +86-574-55019010, +86-137 7723 9417
F +86-574-55019017

E-mail: rhong@plastic-auxiliary-equipment.com



wechat



website

更多咨询请访问：

www.rhongmachinery.com (EN)

管材粉碎机RG-36P
Pipe centralized granulator

片材在线粉碎机RG-21QX
Sheet on-line granulator

块料撕碎机RG-22SS
Block single shaft shredder



轴承安装在机体外,粉尘不易侵入,散热良好,保养及维护简便易行。
Outside bearing design,hard to enter into dust,better cooling efficiency , maintainance.

前门与粉碎室上箱设有安全开关,保证在打开时,刀具停止运转。
Safety switch for front door and upside parts of cutting chamber,to make sure rotor stop running absolutely when opening front door or upper part of cutting chamber.

品牌电机,质量稳定,使用寿命长。
Famous brand motor,stable quality,long time using

配置了可调节避震脚,减小了因地面不平而导致的震动与产生的噪音。
Equip with adjustable shock absorber because of uneven ground , can reduce noise and vibration.

独立电控箱设计,客户可以按照需求放置,方便灵活。内置电机过载保护器,保护电机安全。
Independent control box design,easy to move the correct place according to customer requirement overload device to protect motor.

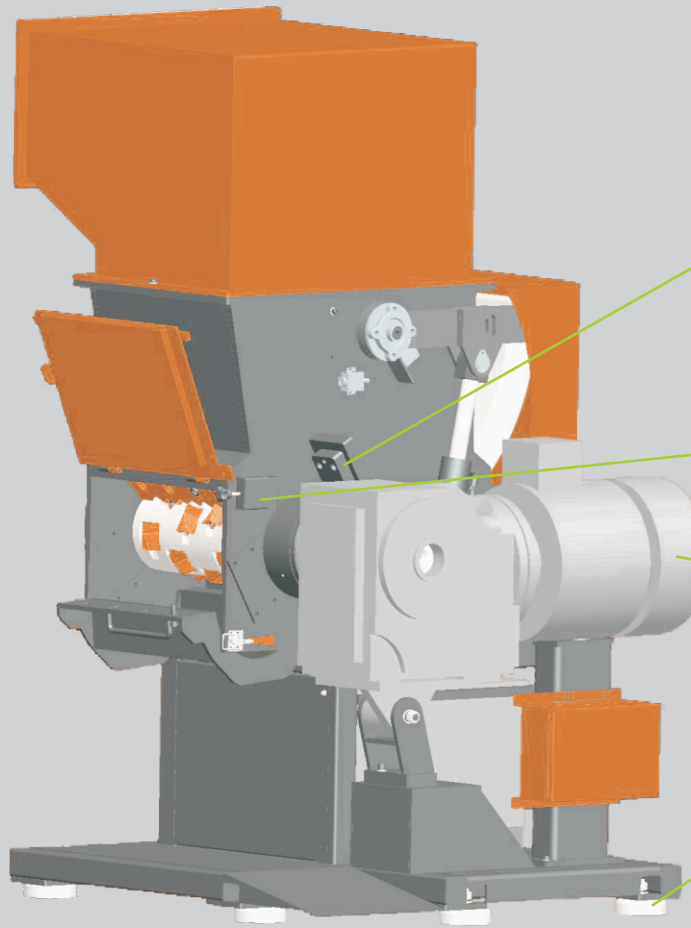

动刀为中间有凹槽的方形刀片设计,有利于撕碎大块的废料,动刀的四角可以交替使用,即每片动刀可连续使用四次。
Grooved and Square shape rotating blades design,better to shred big block material,the four corners of rotating knife can be used alternately by four times.

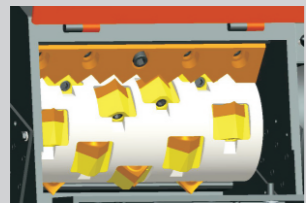

主轴的设计灵活,动刀和动刀座可方便更换及清理。
Updated design of main shaft, rotating blades and rotating seat can be replaced and cleaned.

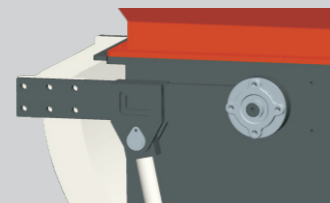

推料器与重型定向轴承巧妙结合,使操作安全可靠。
Push plate and heavy directional bearing work together, operate easily and securely.

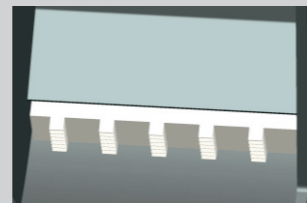

锯齿状的推料板,利于破碎大块实心料。
Serrated push plate,better to crush solid block material.

配输送带及强力粉碎机系统示例
Equip with conveyor belt and powerful granulator working process as following.

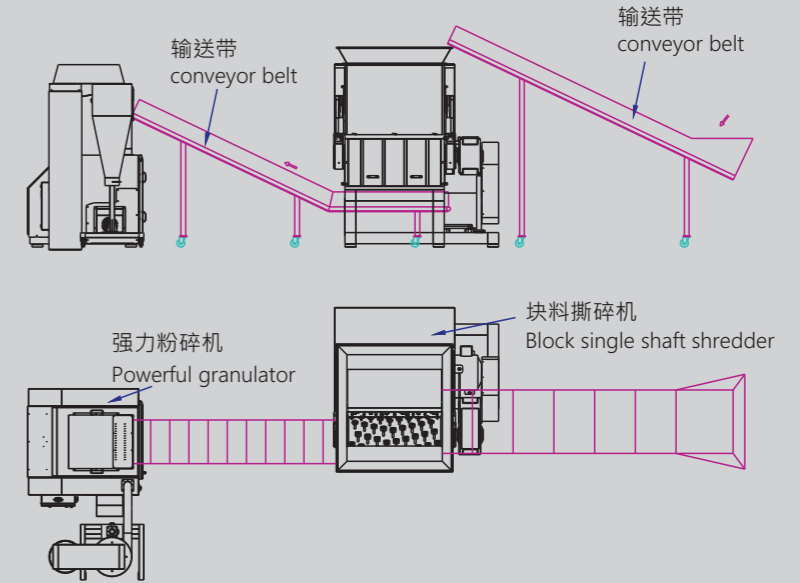

规格表 Specifications

机型 Model		RG-2240SS	RG-48120SS
电机功率 Power	Kw	11	45
主轴转速 Rotor speed	rpm	64	75
回转直径 Rotation diameter	mm	φ220	φ480
活动刀 Rotating blades	PCS	18	84
固定刀 Fixed blades	PCS	2	6
筛网孔径 Screen replacement	mm	φ40	φ40
粉碎室尺寸 Cutting chamber size	mm	300X660	1200X1340
进料口尺寸 Feeding mouth	mm	430X660	1200X13400
筛网更换 Screen replacement		Manual	Manual
液压站功率 Hydraulic motor power	kw	1.5	2.2
粉碎能力 Output	kg/h	100~200	1000~1500
粉碎时噪音 Noise	dB(A)	80~95	100~120
重量 Weight	kg	500	6800
外形尺寸(L×W×H) External size	mm	1080X1160X1870	2080X2090X2530

产品规格若有变更,恕不另行通知。
Please excuse for not note if some specifications of products are changed.

Note 注:

- 1) "●"为标配, "○"为选购。
"●"is standard allocation, "○"is selection purchase.
- 2) 最大粉碎量取决于筛网孔径及粉碎材料等因素。
The max. shredding quantity depend on the mesh hole diameter and shredding material quality.
- 3) 机器电压规格为3Φ,380V,50Hz。
The machine voltage specification is 3Φ,380V,50Hz.
The voltage can be changed as you require.

