

PRESSURE SEAL GATE VALVE

900Lb

KOLINK
VALVES & PIPE FITTINGS

Features:

Pressure Seal Bonnet
OS&Y, Rising Stem, Non-rising Handwheel
Flexible Wedge
Renewable Seat
Flanged or Butt-welding Ends
Bevel Gear or Actuator Available

Applicable Standards:

Design: API 600 / API 6D / BS 1414
Wall Thickness: API 600 / BS 1414
Face-to-face: ASME B16.10 / API 6D
Flange Ends: ASME B16.5 / B16.47
Butt-welding End: ASME B16.25
Testing: API 598 / API 6D / BS 6755 Part 1

Materials of parts

No	Part Name	ASTM Material		
		Carbon Steel	Alloy steel	Stainless Steel
1	Body	A216-WCB	A217-WC6	A351-CF8M
2	Yoke	A216-WCB	A217-WC6	A351-CF8M
3	Wedge	A216-WCB+HF	A217-WC6+HF	A351-CF8M+HF
4	Stem	A182-F6a	A182-F6a	A182-F316
5	Seat Ring	A105+HF	A182-F11+HF	A276-316+HF
6	Stuffing Box	A105	A182-F11	A182-F316
7	Bonnet Gasket ¹⁾	304+Graphite		
8	Washer	A105	A276-420	A276-316
9	Split Ring	Carbon Steel	A276-420	A276-316
10	Yoke	A216-WCB	A217-WC6	A351-CF8M
11	Bonnet Bolt	A193-B7	A193-B16	A193-B8M
12	Bonnet Bolt Nut	A194-2H	A194-7	A194-8M
13	Packing	Graphite		
14	Gland	A276-420	A276-420	A276-316
15	Gland Flange	A216-WCB	A217-WC6	A351-CF8M
16	Eyebolt Pin	Stainless Steel		
17	Eyebolt	Carbon Steel	A193-B7	A193-B8
18	Eyebolt Nut	Carbon Steel	A194-2H	A194-8
19	Grease Fitting	Brass+Steel		
20	Yokesleeve	Aluminum-Bronze ²⁾		
21	Yokesleeve Jam Nut	Carbon Steel		
22	Handwheel	Malleable Iron		
23	Handwheel Nut	Carbon Steel		

Note: 1). Graphite optional

2). Ductile Ni-Resist optional

3). Wedge and seat ring may either be solid facing material or a base material equal to or better than the body/bonnet material with facing as shown.

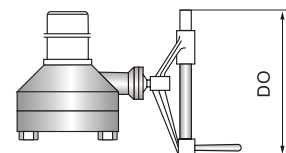
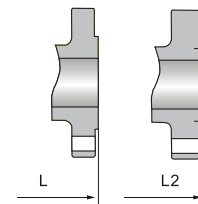
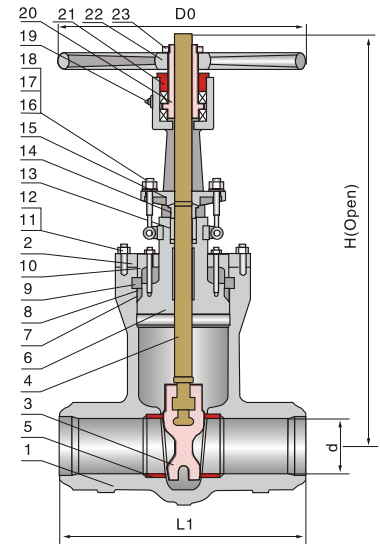

Dimensions data

NPS	2	2½	3	4	6	8	10	12	14	16	18	20	24	26	28	32	34	36	in
DN	50	65	80	100	150	200	250	300	350	400	450	500	600	650	700	800	850	900	mm
ANSI Class 900Lb																			
L1 (BW)	8.50	10.00	12.00	14.00	20.00	26.00	31.00	36.00	39.00	43.00	47.99	52.00	60.98	61.96	65.47	70.00	72.99	80.00	in
	216	254	305	356	508	660	787	914	991	1092	1219	1321	1549	1574	1663	1778	1854	2032	mm
L (RF)	14.50	16.50	15.00	18.00	24.00	29.00	33.00	38.00	40.50	44.50	47.99	52.00	60.98	61.96	65.47	70.00	72.99	80.00	in
	368	419	381	457	610	737	838	965	1029	1130	1219	1321	1549	1574	1663	1778	1854	2032	mm
L2 (RTJ)	14.62	16.62	15.12	18.12	24.12	29.12	33.12	38.12	40.88	44.88	48.50	52.51	61.73	-	-	-	-	-	in
	371	422	384	460	613	740	841	968	1038	1140	1232	1334	1568	-	-	-	-	-	mm
H (OPEN)	17.62	17.62	19.5	22.88	32.62	67.62	45.5	53.12	59	70.5	93.74	96.49	116.96	131.96	145.47	157.48	163.97	180.98	in
	448	448	495	580	830	955	1155	1350	1500	1790	2381	2451	2971	3352	3695	4000	4165	4597	mm
D0	14	14	14	14	18	24	28	34	34	34	29.92	29.92	35.43	35.43	35.43	35.43	35.43	35.43	in
	350	350	350	350	450	600	700	850	850	850	760	760	900	900	900	900	900	900	mm
WT (kg)	39	39	48	69	158	289	482	710	998	1390	2340	2800	3420	4270	5454	7392	9042	10874	BW
	69	69	72	110	253	430	710	1025	1452	1960	2750	3400	4400	5500	6900	9000	11000	13500	RF/RT

PRESSURE SEAL GATE VALVE

1500Lb~2500Lb

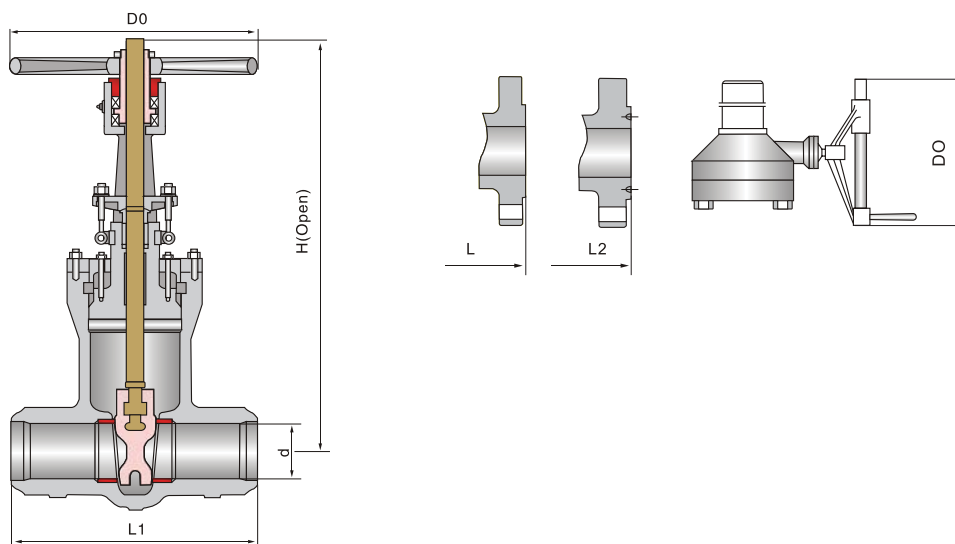

Dimensions data

NPS DN	2 50	2½ 65	3 80	4 100	6 150	8 200	10 250	12 300	14 350	16 400	18 450	20 500	24 600	26 650	28 700	32 800	34 850	36 900	in mm
ANSI Class 1500Lb																			
L1 (BW)	8.50 216	10.00 254	12.00 305	16.00 406	22.00 559	28.00 711	34.00 864	39.00 991	42.00 1067	47.00 1194	52.99 1346	57.99 1473	76.49 1943	80.00 2033	86.96 2209	90.00 2286	95.00 2413	100.98 2565	in mm
L (RF)	14.50 368	16.50 419	18.50 470	21.50 546	27.75 705	32.75 832	39.00 991	44.50 1130	49.50 1257	54.50 1384	60.51 1537	65.51 1664	76.49 1943	80.00 2033	86.96 2209	90.00 2286	95.00 2413	100.98 2565	in mm
L2 (RTJ)	14.62 371	16.62 422	18.62 473	21.62 549	28.00 711	33.12 841	39.38 1000	45.12 1146	50.25 1276	55.38 1407	61.37 1559	66.37 1686	77.63 1972	-	-	-	-	-	in mm
H (OPEN)	17.62 448	17.62 448	21.62 550	25.25 640	33.5 850	38.62 980	46.5 1180	62.25 1580	70.5 1790	78 1980	86.96 2209	93.97 2387	110.00 2794	121.96 3098	133.97 3403	147.48 3746	120.00 3048	127.99 3251	in mm
D0	14 350	14 350	14 350	18 450	24 600	28 700	34 850	34 850	34 850	34 850	33.85 860	33.85 860	33.85 860	40.15 1020	40.15 1020	40.15 1020	-	-	in mm
WT (kg)	39 69	45 80	55 95	77 123	175 283	323 481	540 795	795 1148	1115 1626	1556 2195	4000 5225	4800 6310	7500 9050	8900 9934	10000 11174	13500 14852	16000 17443	18900 21246	BW RF/RTJ

NPS DN	2 50	2½ 65	3 80	4 100	6 150	8 200	10 250	12 300	14 350	16 400	18 450	20 500	24 600	26 650	28 700	32 800	34 850	36 900	in mm
ANSI Class 2500Lb																			
L1 (BW)	11.00 279	13.00 330	14.50 368	18.00 457	24.00 610	30.00 762	36.00 914	41.00 1041	44.01 1118	49.01 1245	55.00 1397	55.00 1397	63.97 1625	70.00 1778	75.00 1905	80.00 2032	85.98 2184	95.00 2413	in mm
L (RF)	17.75 451	20.00 508	22.75 578	26.50 673	36.00 914	40.25 1022	50.00 1270	56.00 1422	-	-	-	-	-	-	-	-	-	-	in mm
L2 (RTJ)	17.88 454	20.50 514	23.00 584	26.88 683	36.50 927	40.88 1038	50.88 1292	56.88 1445	-	-	-	-	-	-	-	-	-	-	in mm
H (OPEN)	22.5 570	22.5 570	25.62 650	30 760	36.62 930	41.38 1050	44.88 1140	60.25 1530	54.29 1379	58.30 1481	65.00 1651	71.29 1811	75.00 1905	80.00 2032	82.99 2108	92.99 2362	96.96 2463	120.59 3063	in mm
D0	14 350	14 350	18 450	24 600	28 700	34 850	34 850	34 850	40.15 1020	40.15 1020	40.15 1020	40.15 1020	-	-	-	-	-	-	in mm
WT (kg)	110 165	110 195	150 235	175 316	380 635	575 910	980 1780	1570 2680	3200	4100	5200	6800	9500	11000	13100	17200	19300	25000	BW RF/RTJ