**Specifications:**

Insulator Material: High Temp, Thermoplastic, UL94V-0 Board Lock Material: Brass  
 Contact Material: Phosphor Bronze  
 Contact Plating: Au ( $1\mu$ " /  $5\mu$ " /  $30\mu$ " Min.) on Contact Area.  
 Au ( $1\mu$ " Min.) or Sn ( $100\mu$ " Min.) on Solder tail.  
 Nickel (Contact -  $80\mu$ " Min. / Solder tail -  $50\mu$ " Min.)  
 Board Lock Plating: Sn ( $100\mu$ " Min.) over Nickel ( $40\mu$ " Min.)  
 Current Resistance: 1.2A Max. Voltage-Withstand: 500V AC For 1 Minute  
 Conductor Resistance: Max:  $25m\Omega$  Insulation Resistance: Min:  $1000M\Omega$  Min  
 Operating Temp.:  $-55^{\circ}C \sim +125^{\circ}C$   
 Max. Processing Temp.:  $230^{\circ}C$  for 30~60 seconds.  $260^{\circ}C$  for 10 seconds.  
 Durability Test: 500 mating cycles Insertion Force: 0.8N Max. (Per Contact)  
 Withdrawal Force: 0.4N Min. (Per Contact)

**ORDERING CODE:**

ATK-SMC02 XX XX X X  
 Series NO. 1.27 SMC Female Connector Vertical SMT Type  
 CONTACT POSITION See DIM-TABLE.  
 Packing Standing Height:  
 A: Tray A: 6.25, X=1.05  
 B: Bag B: 9.05, X=3.85  
 T: Tube C: 13.65, X=8.45  
 U: Tube+CAP  
 R: Tape&Reel  
 W: Tape&Reel+CAP

**Contact Plating:**

G0: Gold flash S0: Selective  
 G1: 3u" Gold S1: Selective 3u"  
 G2: 5u" Gold S2: Selective 5u"  
 G3: 10u" Gold S3: Selective 10u"  
 G4: 15u" Gold S4: Selective 15u"  
 G5: 30u" Gold S5: Selective 30u"  
 SN: Tin

**DIM-TABLE**

| PIN NO. | DIM A | DIM B | DIM C | DIM D | DIM E | DIM F | DIM G |
|---------|-------|-------|-------|-------|-------|-------|-------|
| 12      | 12.70 | 8.37  | 6.35  | 9.37  | 10.77 | 11.34 | 10.57 |
| 16      | 15.24 | 10.91 | 8.89  | 11.91 | 13.31 | 13.88 | 13.11 |
| 20      | 17.78 | 13.45 | 11.43 | 14.45 | 15.85 | 16.42 | 15.65 |
| 24      | 20.32 | 15.99 | 13.97 | 16.99 | 18.39 | 18.96 | 18.19 |
| 26      | 21.59 | 17.26 | 15.24 | 18.26 | 19.66 | 20.23 | 19.46 |
| 30      | 24.13 | 19.80 | 17.78 | 20.80 | 22.20 | 22.77 | 22.00 |
| 32      | 25.40 | 21.07 | 19.05 | 22.07 | 23.47 | 24.04 | 23.27 |
| 40      | 30.48 | 26.15 | 24.13 | 27.15 | 28.55 | 29.12 | 28.35 |
| 50      | 36.83 | 32.50 | 30.48 | 33.50 | 34.90 | 35.47 | 34.70 |
| 68      | 48.26 | 43.93 | 41.91 | 44.93 | 46.33 | 46.90 | 46.13 |
| 80      | 55.88 | 51.55 | 49.53 | 52.55 | 53.95 | 54.52 | 53.75 |

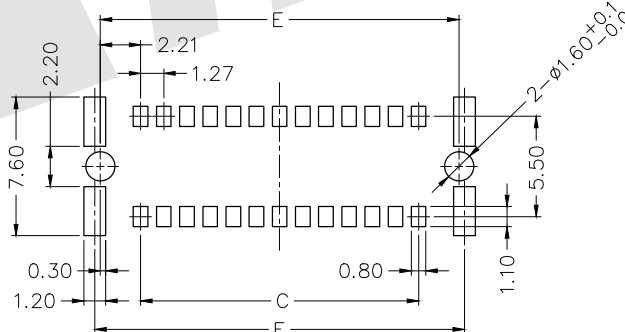
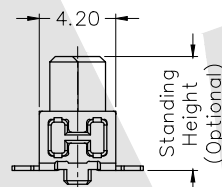
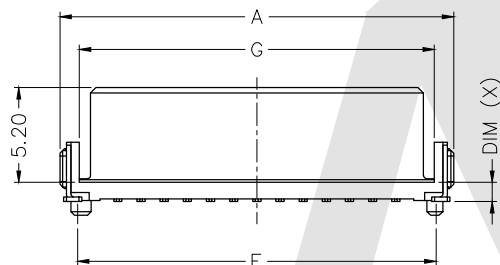

**RECOMMENDED PCB LAYOUT**  
 TOLERANCE:  $\pm 0.05$

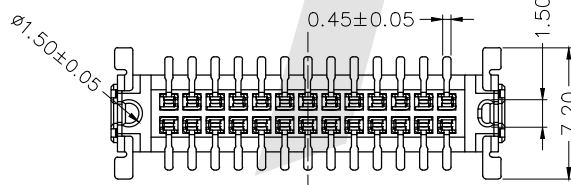

Unless Otherwise specified tolerance  
 X.  $\pm 0.35$  X.XX:  $\pm 0.20$   
 X.X:  $\pm 0.25$  X.XXX:  $\pm 0.15$

SCALE: As Shown UNIT: mm  
 DRAW: Wu Feng Rong DATE: 24/03/2020  
 CHECK: BobYang DATE: 24/03/2020

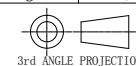

**Antenk**® ANTENK ELECTRONICS CO., LTD  
 Http://www.antenk.com  
 E-mail: sales@antenk.com

TITLE:  
 1.27 SMC Female Connector Vertical SMT Type

DRAWING NO: ATK-SMC02XXXXXX

PRODUCT NO: ATK-SMC02XXXXXX

REV DESCRIPTION DATE

1 2 3 4 5 6 7 8

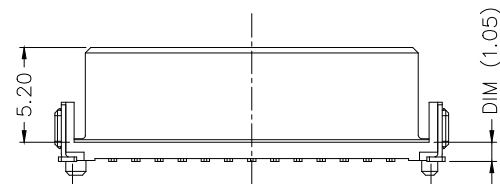

STANDING HEIGHT : A  
DIMENSION (X)

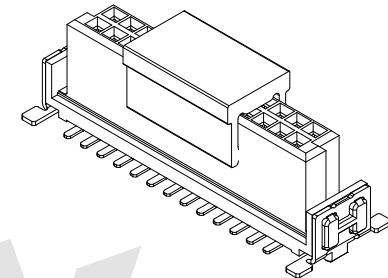
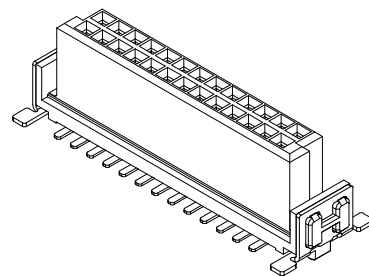

STANDING HEIGHT : A  
With Cap Type

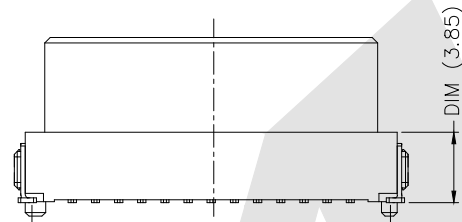

STANDING HEIGHT : B  
DIMENSION (X)

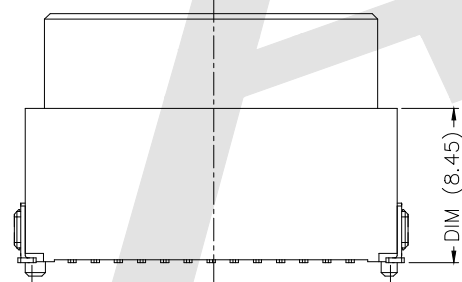
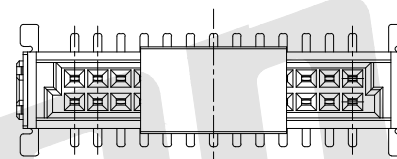
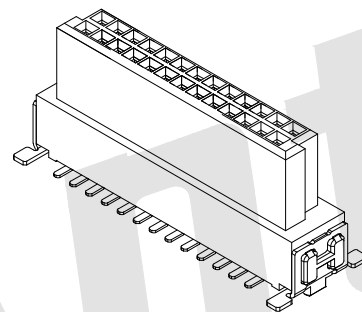

STANDING HEIGHT : C  
DIMENSION (X)

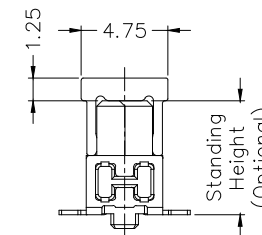
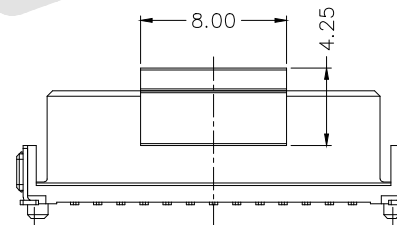
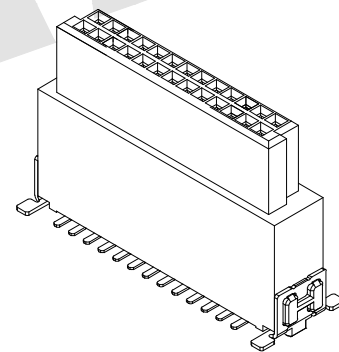

Unless Otherwise specified tolerance  
 X. ±0.35 X.XX: ±0.20  
 X.X: ±0.25 X.XXX: ±0.15

|                      |                    |
|----------------------|--------------------|
| SCALE:<br>As Shown   | UNIT:<br>mm        |
| DRAW<br>Wu Feng Rong | DATE<br>24/03/2020 |
| CHECK<br>BobYang     | DATE<br>24/03/2020 |

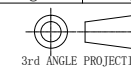

**Antenk**® ANTENK ELECTRONICS CO., LTD  
[Http://www.antenk.com](http://www.antenk.com)  
 E-mail:sales@antenk.com

TITLE:  
 1.27 SMC Female Connector Right Angle SMT Type

DRAWING NO: ATK-SMC02XXXXXX

PRODUCT NO: ATK-SMC02XXXXXX

| REV | DESCRIPTION | DATE |
|-----|-------------|------|
|     |             |      |
|     |             |      |
|     |             |      |