

SPECIFICATIONS:

- Voltage rating: 100V AC/DC
- Current rating: 1A AC/DC
- Withstanding Voltage: 500V AC/minute
- Insulation resistance: 500MΩ Min.
- Temperature range: -40°C To +105°C
- Contact resistance: 20mΩ Max.

Standards

HSF



RoHS

Wire to Board

Assembly Layout

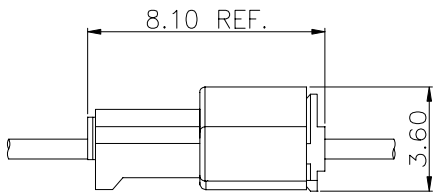

Wire To Wire

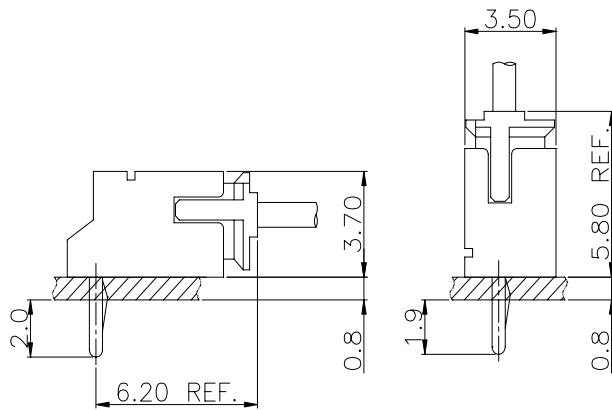

DIP TYPE

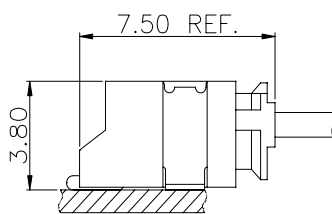
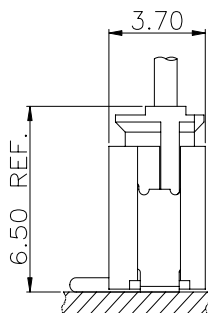

SMT TYPE

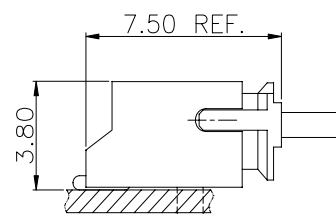

Connectors Expert Around You

1.50mm Pitch housing connector

HOUSING

- Part NO.:AH1501-xP
- Suitable:AT1501T series Terminal
- Mates with:AW1501 series Wafer and AH1501M series Housing
- Material:Nylon 66,UL94V-0
- Color:White

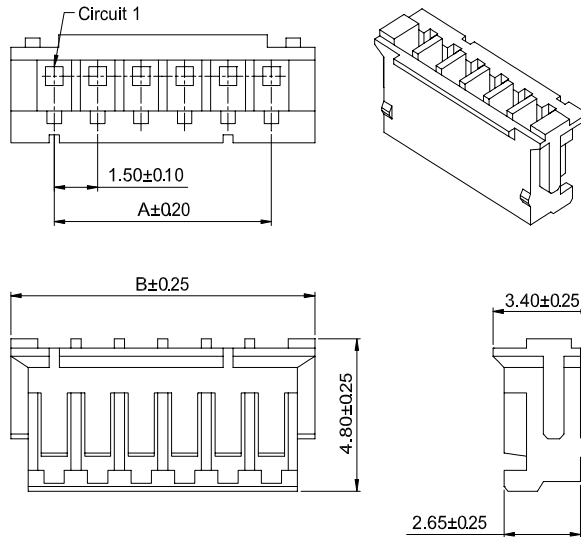

Ordering Information & Dimensions:

Poles	Part No.	Dimensions (mm)	
		A	B
02	AH1501-02P	1.50	4.50
03	AH1501-03P	3.00	6.00
04	AH1501-04P	4.50	7.50
05	AH1501-05P	6.00	9.00
06	AH1501-06P	7.50	10.50
07	AH1501-07P	9.00	12.00
08	AH1501-08P	10.50	13.50
09	AH1501-09P	12.00	15.00
10	AH1501-10P	13.50	16.50
11	AH1501-11P	15.00	18.00
12	AH1501-12P	16.50	19.50
13	AH1501-13P	18.00	21.00
15	AH1501-15P	21.00	24.00

Wire to Board

1.50mm Pitch crimp terminal connector

TERMINAL

- Part NO:AT1501T-xP
- Applicable wire:AWG#26-#32
- Material:Phosphor Bronze
- Finish:Tin Plated or Gold
- Used in AH1501 series Housing

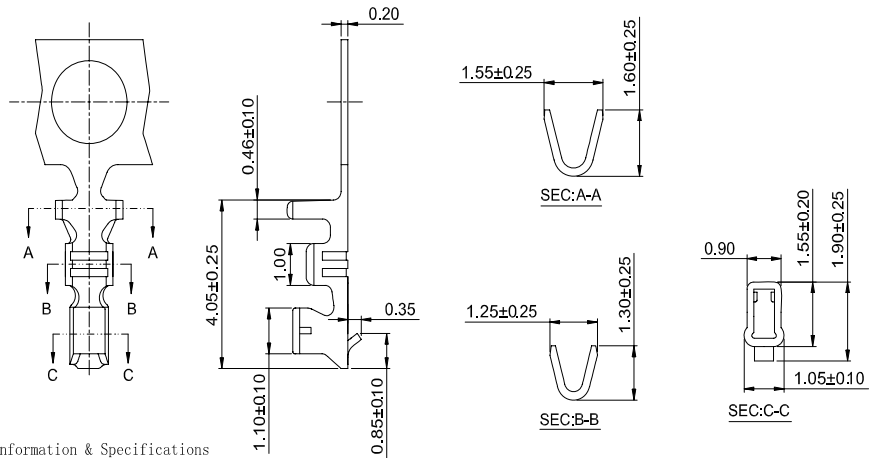

Ordering information & Specifications

Part NO.	Wire Range	Insulation O.D.	Material	Finish	Qty/reel
AT1501T-TP	AWG#26-#32	1.10mm(max)	Phosphor Bronze	Tin over Nickel	10,000 PCS
AT1501T-GP	AWG#26-#32	1.10mm(max)	Phosphor Bronze	Gold over Nickel	10,000 PCS

1.50mm Pitch crimp terminal connector

TERMINAL

- Part NO:AT1501T-xP-H
- Applicable wire:AWG#24-#30
- Material:Phosphor Bronze
- Finish:Tin Plated or Gold
- Used in AH1501 series Housing

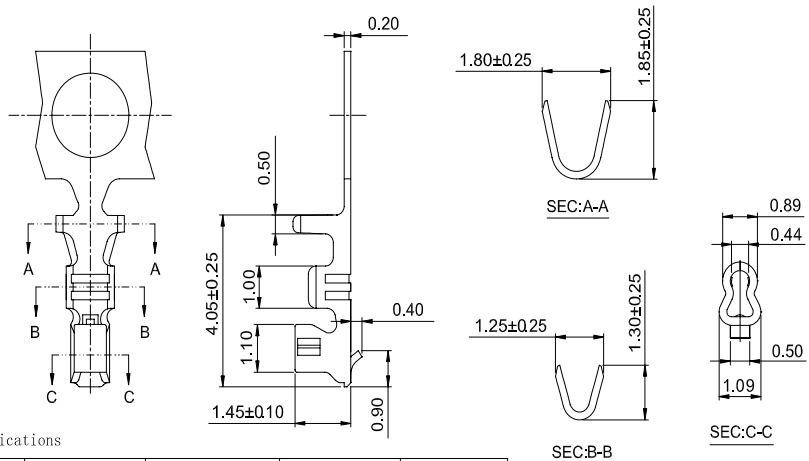

Ordering information & Specifications

Part NO.	Wire Range	Insulation O.D.	Material	Finish	Qty/reel
AT1501T-TP-H	AWG#24-#30	1.10mm(max)	Phosphor Bronze	Tin over Nickel	15,000 PCS
AT1501T-GP-H	AWG#24-#30	1.10mm(max)	Phosphor Bronze	Gold over Nickel	15,000 PCS

Connectors Expert Around You

1.50mm Pitch 90° wafer connector

WAFER

- Part NO:AW1501R-xP
- Material:Pin:Brass/Tin over Nickel
- Insulator:Nylon 66, UL94V-0
- Mates with:AH1501 series Housing
- Color: Brown

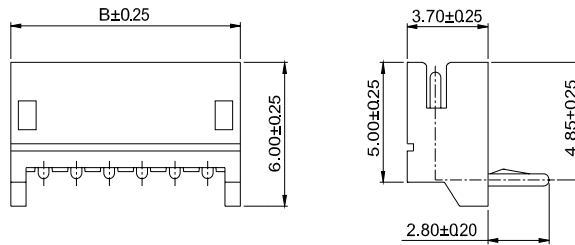
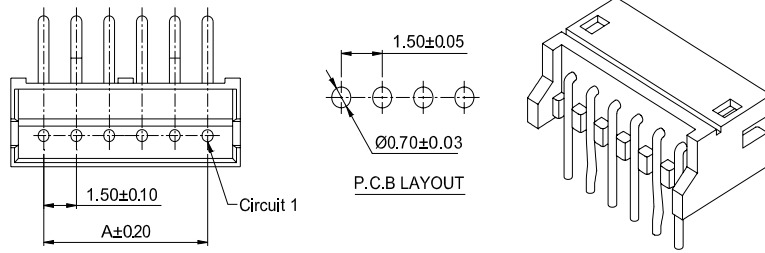

Ordering Information & Dimensions:

Poles	Part No.	Dimensions(mm)	
		A	B
02	AW1501R-02P	1.50	4.50
03	AW1501R-03P	3.00	6.00
04	AW1501R-04P	4.50	7.50
05	AW1501R-05P	6.00	9.00
06	AW1501R-06P	7.50	10.50
07	AW1501R-07P	9.00	12.00
08	AW1501R-08P	10.50	13.50
09	AW1501R-09P	12.00	15.00
10	AW1501R-10P	13.50	16.50
11	AW1501R-11P	15.00	18.00
12	AW1501R-12P	16.50	19.50
13	AW1501R-13P	18.00	21.00
15	AW1501R-15P	21.00	24.00

Wire to Board

1.50mm Pitch 180° smt wafer connector

WAFER

- Part NO:AW1501V-S-xP
- Material:Pin:Brass/Tin over Nickel
- Solder Tabs:Brass/Gold over Nickel
- Insulator:Nylon 6T, UL94V-0
- Cap:Nylon 6T, UL94V-0
- Mates with:AH1501 series Housing
- Color: Ivory

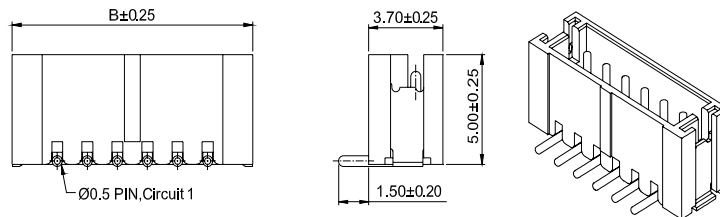
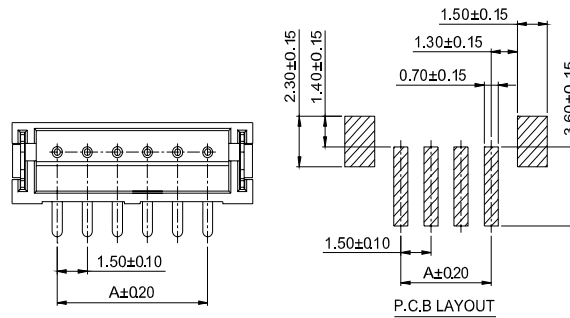

Ordering Information & Dimensions:

Poles	Part No.	Dimensions(mm)	
		A	B
02	AW1501V-S-02P	1.50	6.00
03	AW1501V-S-03P	3.00	7.50
04	AW1501V-S-04P	4.50	9.00
05	AW1501V-S-05P	6.00	10.50
06	AW1501V-S-06P	7.50	12.00
07	AW1501V-S-07P	9.00	13.50
08	AW1501V-S-08P	10.50	15.00
09	AW1501V-S-09P	12.00	16.50
10	AW1501V-S-10P	13.50	18.00
11	AW1501V-S-11P	15.00	19.50
12	AW1501V-S-12P	16.50	21.00
13	AW1501V-S-13P	18.00	22.50

1.50mm Pitch 90° smt wafer connector

WAFER

- Part NO:AW1501R-S-xP
- Material:Pin:Brass/Tin over Nickel
- Solder Tabs:Brass/Gold over Nickel
- Insulator:Nylon 6T, UL94V-0
- Mates with:AH1501 series Housing
- Color:Ivory

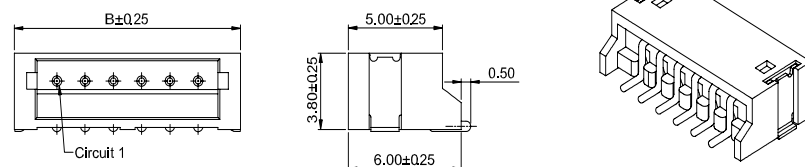
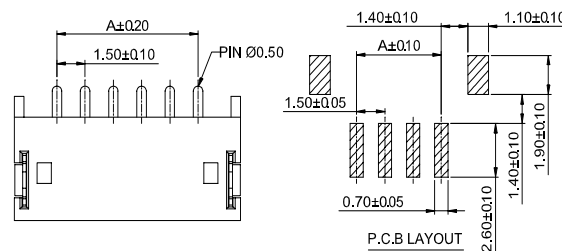

Ordering Information & Dimensions:

Poles	Part No.	Dimensions(mm)	
		A	B
02	AW1501R-S-02P	1.50	6.00
03	AW1501R-S-03P	3.00	7.50
04	AW1501R-S-04P	4.50	9.00
05	AW1501R-S-05P	6.00	10.50
06	AW1501R-S-06P	7.50	12.00
07	AW1501R-S-07P	9.00	13.50
08	AW1501R-S-08P	10.50	15.00
09	AW1501R-S-09P	12.00	16.50
10	AW1501R-S-10P	13.50	18.00
11	AW1501R-S-11P	15.00	19.50
12	AW1501R-S-12P	16.50	21.00
13	AW1501R-S-13P	18.00	22.50

Connectors Expert Around You

1.50mm Pitch housing connector

HOUSING

- Part NO.:AH1501M-xP
- Suitable:AT1501MT series Terminal
- Mates with:AH1501 series Housing
- Material:Nylon 66,UL94V-0
- Color:White

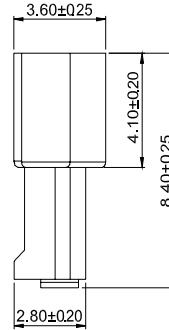
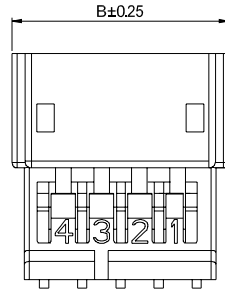
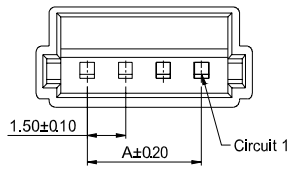

Ordering Information & Dimensions:

Poles	Part No.	Dimensions(mm)	
		A	B
02	AH1501M-02P	1.50	5.55
03	AH1501M-03P	3.00	7.05
04	AH1501M-04P	4.50	8.55
05	AH1501M-05P	6.00	10.05
06	AH1501M-06P	7.50	11.55
07	AH1501M-07P	9.00	13.05
08	AH1501M-08P	10.50	14.55
09	AH1501M-09P	12.00	16.05
10	AH1501M-10P	13.50	17.55
11	AH1501M-11P	15.00	19.05
12	AH1501M-12P	16.50	20.55
13	AH1501M-13P	18.00	22.05

Wire to Board

1.50mm Pitch crimp terminal connector

TERMINAL

- Part NO:AT1501MT-xP
- Applicable wire:AWG#28-#32
- Material:Phosphor Bronze
- Finish:Tin Plated or Gold
- Used in AH1501M series Housing

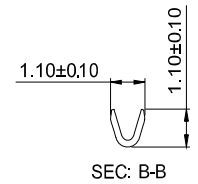
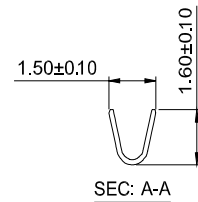
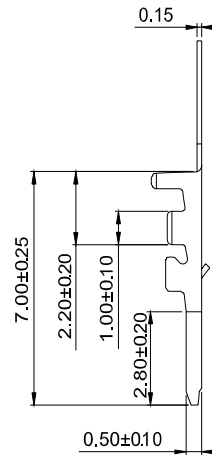
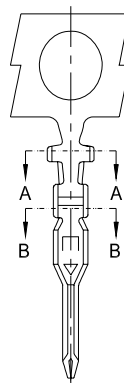

Ordering information & Specifications

Part NO.	Wire Range	Insulation O.D.	Material	Finish	Qty/reel
AT1501MT-TP	AWG#28-#32	0.90mm(max)	Phosphor Bronze	Tin over Nickel	15,000 PCS
AT1501MT-GP	AWG#28-#32	0.90mm(max)	Phosphor Bronze	Gold over Nickel	15,000 PCS

1.50mm Pitch 180° wafer connector

WAFER

- Part NO:AW1501V-xP
- Material:Pin:Brass/Tin over Nickel
- Insulator:Nylon 66, UL94V-0
- Mates with:AH1501 series Housing
- Color: Brown

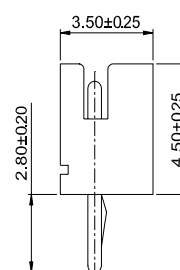
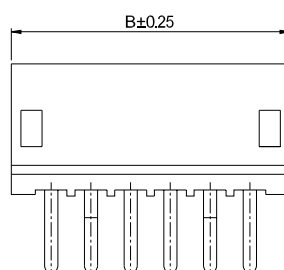
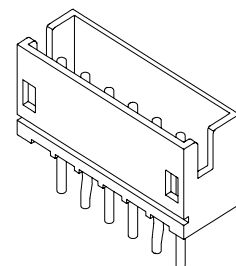
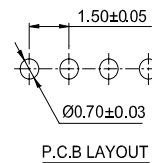
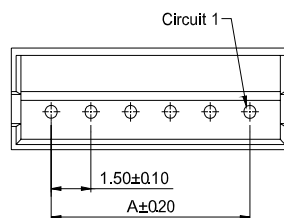

Ordering Information & Dimensions:

Poles	Part No.	Dimensions(mm)	
		A	B
02	AW1501V-02P	1.50	4.50
03	AW1501V-03P	3.00	6.00
04	AW1501V-04P	4.50	7.50
05	AW1501V-05P	6.00	9.00
06	AW1501V-06P	7.50	10.50
07	AW1501V-07P	9.00	12.00
08	AW1501V-08P	10.50	13.50
09	AW1501V-09P	12.00	15.00
10	AW1501V-10P	13.50	16.50
11	AW1501V-11P	15.00	18.00
12	AW1501V-12P	16.50	19.50
13	AW1501V-13P	18.00	21.00
15	AW1501V-15P	21.00	24.00