

SPECIFICATIONS:

- Voltage rating: 100V AC/DC
- Current rating: 1A AC/DC
- Withstanding Voltage: 500V AC/minute
- Insulation resistance: 500MΩ Min.
- Temperature range: -40°C To +105°C
- Contact resistance: 40mΩ Max.

Standards

HSF



RoHS

Assembly Layout

Right Angle Type

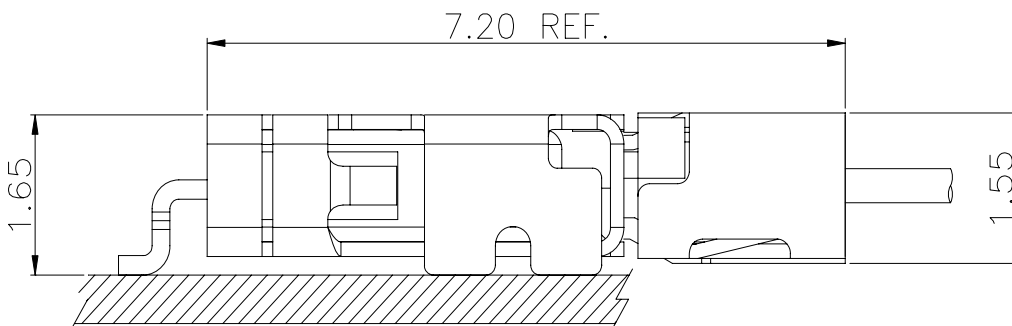

Connectors Expert Around You

1.00mm Pitch housing connector

HOUSING

- Part NO.:AH1004-xP
- Suitable:AT1004T-xP series Terminal
- Mates with:AW1004R-S-xP series Wafer
- Material:Insulator:Nylon 66,UL94V-0
- Shell:Phosphor Bronze/Tin over Nickel
- Color:Ivory

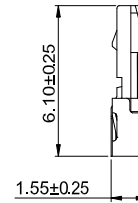
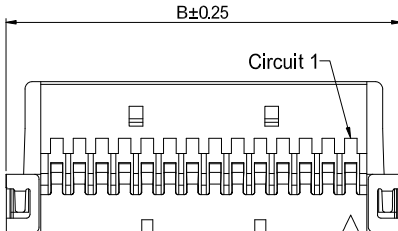
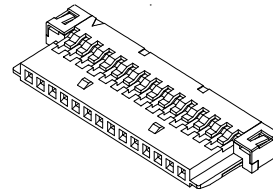
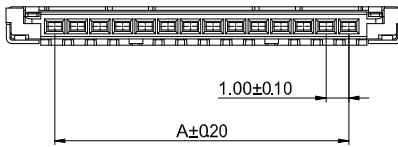

Ordering Information & Dimensions:

Part No.	Dimensions (mm)	
	A	B
AH1004-08P	7.00	11.50
AH1004-14P	13.00	17.50
AH1004-20P	19.00	23.50
AH1004-30P	29.00	33.50

Wire to Board

1.00mm Pitch crimp terminal connector

TERMINAL

- Part NO:AT1004T-xP
- Applicable wire:AWG#28-#32
- Material:Phosphor Bronze
- Finish:Gold over Nickel
- Used in AH1004-xP series Housing

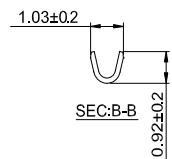
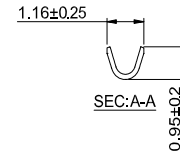
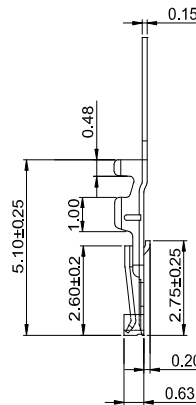
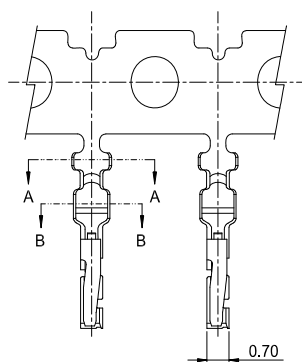

Ordering information & Specifications

Part NO.	Wire Range	Insulation O.D.	Material	Finish	Qty/reel
AT1004T-GP	AWG#28-#32	0.60mm(max)	Phosphor Bronze	Gold over Nickel	15,000 PCS

1.00mm Pitch 90° wafer-smt connector

WAFER

- Part NO:AW1004R-S-xP
- Material:Pin:Phosphor Bronze/Gold over Nickel
- Shell:Phosphor Bronze/Tin over Nickel
- Insulator:Nylon 6T, UL94V-0
- Mates with:AH1004-xP series Housing
- Color: Ivory

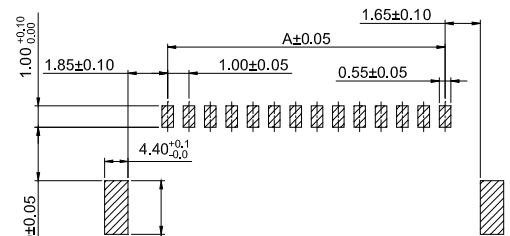
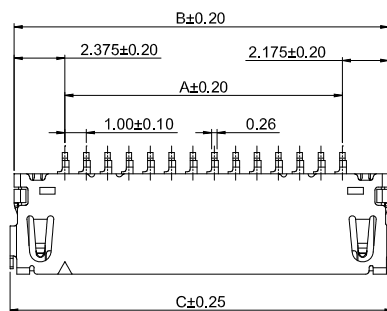

P.C.B LAYOUT

Ordering Information & Dimensions:

Part No.	Dimensions (mm)		
	A	B	C
AW1004R-S-08P	7.00	11.50	11.95
AW1004R-S-14P	13.00	17.50	17.95
AW1004R-S-20P	19.00	23.50	23.95
AW1004R-S-30P	29.00	33.50	33.95

Unit: mm

