

SPECIFICATIONS:

- Voltage rating: 250V AC/DC
- Current rating: 2A AC/DC
- Withstanding Voltage: 800V AC/minute
- Insulation resistance: 1000MΩ Min.
- Temperature range: -25°C To +85°C
- Contact resistance: 20mΩ Max.

Standards

HSF



RoHS

Wire to Board

Assembly Layout

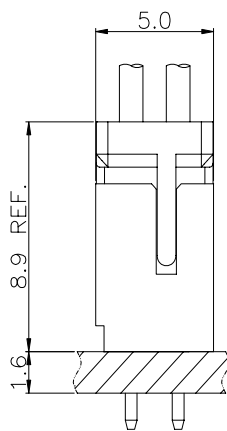

DIP TYPE

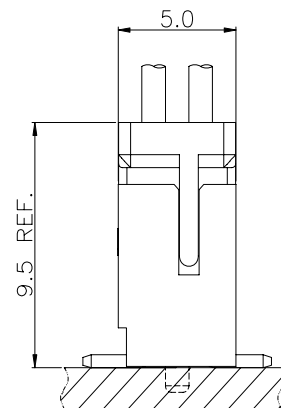
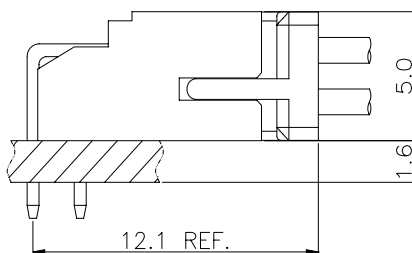

SMT TYPE

Connectors Expert Around You

2.00mm Pitch dual row housing connector

HOUSING

- Part NO.: AH2009-2xNP
- Poles: 06-40P
- Suitable: AT2009T series Terminal
- Mates with: AW2009 Dual Row series Wafer
- Material: Nylon 66, UL94v-0
- Color: Black

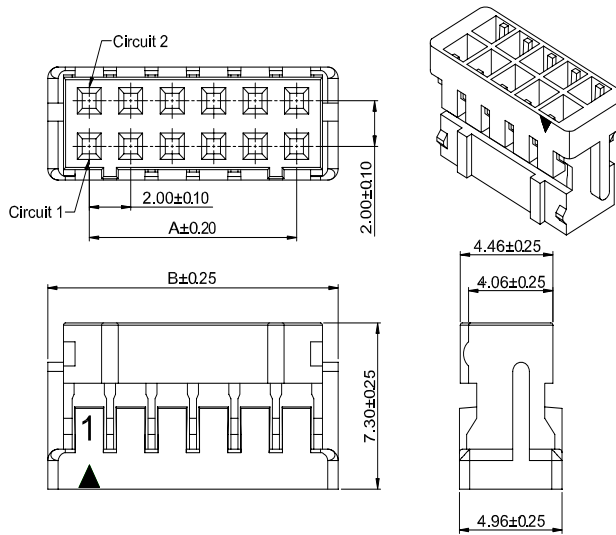

Ordering Information & Dimensions:

Poles	Part No.	Dimensions(mm)	
		A	B
4	AH2009-2x02P	2.00	6.00
6	AH2009-2x03P	4.00	8.00
8	AH2009-2x04P	6.00	10.00
10	AH2009-2x05P	8.00	12.00
12	AH2009-2x06P	10.00	14.00
14	AH2009-2x07P	12.00	16.00
16	AH2009-2x08P	14.00	18.00
18	AH2009-2x09P	16.00	20.00
20	AH2009-2x10P	18.00	22.00
22	AH2009-2x11P	20.00	24.00
24	AH2009-2x12P	22.00	26.00
26	AH2009-2x13P	24.00	28.00
28	AH2009-2x14P	26.00	30.00
30	AH2009-2x15P	28.00	32.00
32	AH2009-2x16P	30.00	34.00
34	AH2009-2x17P	32.00	36.00
36	AH2009-2x18P	34.00	38.00
38	AH2009-2x19P	36.00	40.00
40	AH2009-2x20P	38.00	42.00

Wire to Board

2.00mm Pitch crimp terminal connector

TERMINAL

- Part NO.: AT2009T-XP
- Applicable wire: AWG#22-#30
- Material: Phosphor Bronze
- Finish: Tin Plated or Gold
- Used in AH2009 series Housing

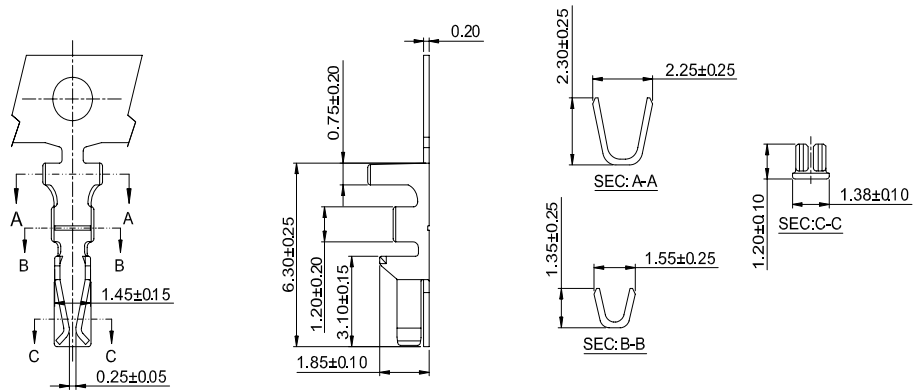

Ordering information & Specifications:

Part NO.	Wire Range	on O.D. Insulati	Material	Finish	Qty/reel
AT2009T-TP	AWG#22-#30	1.45mm(max)	Phosphor Bronze	Tin over Nickel	10,000 PCS
AT2009T-GP	AWG#22-#30	1.45mm(max)	Phosphor Bronze	Gold over Nickel	10,000 PCS

2.00mm Pitch 180° dual row wafer connector

WAFER

- Part NO.: AW2009V-2xNP
- Material: Pin: Brass/Tin over Nickel
- Insulator: Nylon 66, UL94V-0
- Mates with: AH2009 Dual Row series Housing
- Color: Black

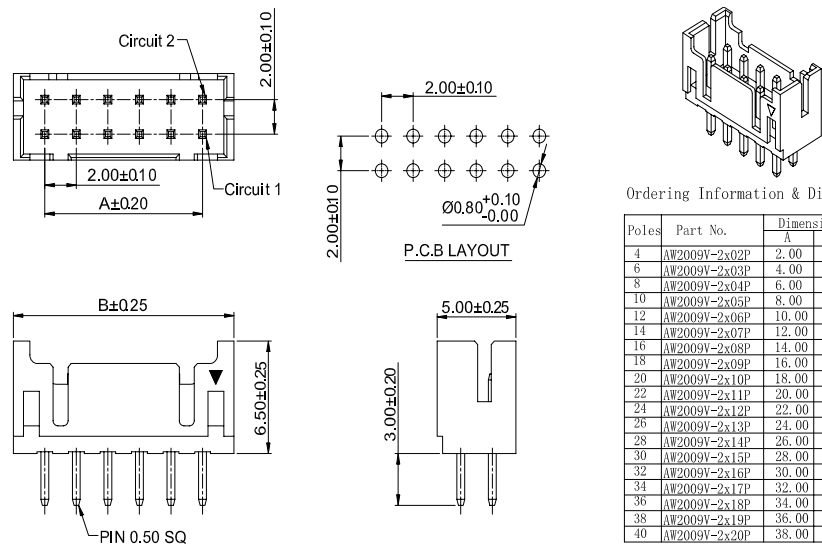

Ordering Information & Dimensions:

Poles	Part No.	Dimensions(mm)	
		A	B
4	AW2009V-2x02P	2.00	6.00
6	AW2009V-2x03P	4.00	8.00
8	AW2009V-2x04P	6.00	10.00
10	AW2009V-2x05P	8.00	12.00
12	AW2009V-2x06P	10.00	14.00
14	AW2009V-2x07P	12.00	16.00
16	AW2009V-2x08P	14.00	18.00
18	AW2009V-2x09P	16.00	20.00
20	AW2009V-2x10P	18.00	22.00
22	AW2009V-2x11P	20.00	24.00
24	AW2009V-2x12P	22.00	26.00
26	AW2009V-2x13P	24.00	28.00
28	AW2009V-2x14P	26.00	30.00
30	AW2009V-2x15P	28.00	32.00
32	AW2009V-2x16P	30.00	34.00
34	AW2009V-2x17P	32.00	36.00
36	AW2009V-2x18P	34.00	38.00
38	AW2009V-2x19P	36.00	40.00
40	AW2009V-2x20P	38.00	42.00

Connectors Expert Around You

2.00mm Pitch 90° dual row wafer connector

WAFER

- Part NO.:AW2009R-2xNP
- Material:Pin:Brass/Tin over Nickel
- Insulator:Nylon 66,UL94V-0
- Mates with:AH2009 Dual Row series Housing
- Color:Black

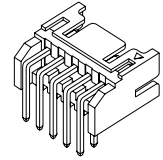
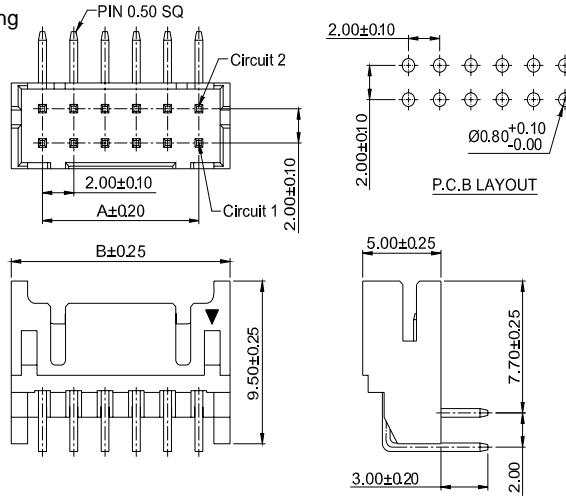

Ordering Information & Dimensions:

Poles	Part No.	Dimensions (mm)	
		A	B
4	AW2009R-2x02P	2.00	6.00
6	AW2009R-2x03P	4.00	8.00
8	AW2009R-2x04P	6.00	10.00
10	AW2009R-2x05P	8.00	12.00
12	AW2009R-2x06P	10.00	14.00
14	AW2009R-2x07P	12.00	16.00
16	AW2009R-2x08P	14.00	18.00
18	AW2009R-2x09P	16.00	20.00
20	AW2009R-2x10P	18.00	22.00
22	AW2009R-2x11P	20.00	24.00
24	AW2009R-2x12P	22.00	26.00
26	AW2009R-2x13P	24.00	28.00
28	AW2009R-2x14P	26.00	30.00
30	AW2009R-2x15P	28.00	32.00
32	AW2009R-2x16P	30.00	34.00
34	AW2009R-2x17P	32.00	36.00
36	AW2009R-2x18P	34.00	38.00
38	AW2009R-2x19P	36.00	40.00
40	AW2009R-2x20P	38.00	42.00

Wire to Board

2.00mm Pitch 180° dual row wafer with boss-smt connector

WAFER

- Part NO.:AW2009VA-S-F-2xNP
- Material:Pin:Brass/Tin over Nickel
- Insulator:Nylon 6T,UL94V-0
- Mates with:AH2009 Dual Row series Housing
- Color:Ivory

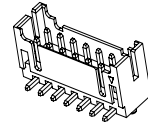
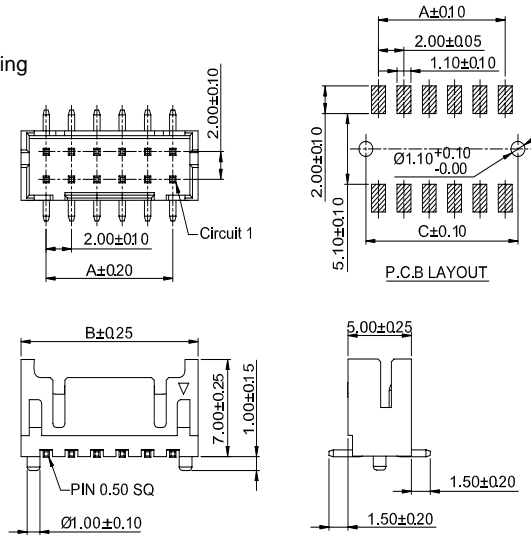

Ordering Information & Dimensions:

Poles	Part No.	Dimensions (mm)		
		A	B	C
4	AW2009VA-S-F-2x02P	2.00	6.00	4.00
6	AW2009VA-S-F-2x03P	4.00	8.00	6.00
8	AW2009VA-S-F-2x04P	6.00	10.00	8.00
10	AW2009VA-S-F-2x05P	8.00	12.00	10.00
12	AW2009VA-S-F-2x06P	10.00	14.00	12.00
14	AW2009VA-S-F-2x07P	12.00	16.00	14.00
16	AW2009VA-S-F-2x08P	14.00	18.00	16.00
18	AW2009VA-S-F-2x09P	16.00	20.00	18.00
20	AW2009VA-S-F-2x10P	18.00	22.00	20.00
22	AW2009VA-S-F-2x11P	20.00	24.00	22.00
24	AW2009VA-S-F-2x12P	22.00	26.00	24.00
26	AW2009VA-S-F-2x13P	24.00	28.00	26.00
28	AW2009VA-S-F-2x14P	26.00	30.00	28.00
30	AW2009VA-S-F-2x15P	28.00	32.00	30.00
32	AW2009VA-S-F-2x16P	30.00	34.00	32.00
34	AW2009VA-S-F-2x17P	32.00	36.00	34.00
36	AW2009VA-S-F-2x18P	34.00	38.00	36.00
38	AW2009VA-S-F-2x19P	36.00	40.00	38.00
40	AW2009VA-S-F-2x20P	38.00	42.00	40.00