

## SG21-3 EURO STAGE IIIA

On the level, our SG21-3 is one of the toughest motor graders in the market today

- ▶ Engine model: Dongfeng Cummins EE/QSC8.3-C215
- ▶ Rated power: 160 kW/2200 rpm
- ▶ Operating weight: 17.0 t

### Product features

Shantui's Motor Grader Series has been internally developed, based on the most advanced foreign technologies. The working devices employ external gears with high torque transference and a linked swing frame for easy operation. With a large cutting angle on the cutting edges and a strong resistance to external shocks, the working devices are capable of handling high workloads and can operate under the harshest of working conditions.



shantui e-shop

# SHANTUI

VALUE THAT WORKS

Shantui Construction Machinery Co., Ltd.

ADDRESS:  
No. 58, G327 Highway  
Jining City, Shandong, CHINA





TEL: +86-537-2909369  
FAX: +86-537-2311219  
EMAIL: trade@shantui.com

# SG21-3

## Technical specifications:

Operating weight: 17.0 t	Gradeability: 20°
Blade length: 3660/3965/4270 mm	Wheel base: 6560 mm
Minimum ground clearance: 430 mm	Maximum traction: 95 kN

SG21-3

	ENGINE	Engine model	Dongfeng Cummins EE/QSC8.3-C215					
		Engine type	In-line, 4-stroke, electric control high pressure common rail injection, turbocharged, charge air cooling					
		Rated power/speed	160 kW/2200 rpm					
		Number of cylinders (bore x stroke)	6 (114 x 135 mm)					
		Piston displacement	8.3 L					
		Maximum torque/speed	980 N-m/1500 rpm					
Minimum fuel consumption	223 g/kW-h							
	TRAVEL SPEED	Transmission and torque converter: Electronic controlled transmission with 6 forward gears and 3 reverse gears.						
		Gear	1st	2nd	3rd	4th	5th	6th
		Forward	0~5.3 km/h	0~9.2 km/h	0~12.0 km/h	0~20.3 km/h	0~25.2 km/h	0~39.0 km/h
		Reverse	0~5.3 km/h	0~12.0 km/h	0~25.2 km/h	-	-	-
	SYSTEMS	Balance box	Type	No-spin limited slip differential, heavy-duty roller chain drive				
			Oscillation angle	15° forward, 15° reverse				
		Tire	Type	17.5-25PR14				
			Pattern level	L-2A/L-3				
			Optional tire	17.5-25PR14				
		Steering system	Minimum turning radius	8200 mm				
			Front wheel tilting angle	±17°				
			Front wheel steering angle	±45°				
			Front axle oscillating angle	±15°				
		Brake system	Articulation angle	25°				
			Service brake	4-wheel pliers-pan brake, full hydraulic, foot brake				
			Parking brake	Hand brake with ratchet wheel				
Operating weight	Brake pressure	10 MPa						
	Total	17000 kg						
	Front axle load	5100 kg						
	Rear axle load	11900 kg						
	BLADE	Blade length	3660/3965/4270 mm					
		Blade height	635 mm					
		Blade rotational angle	360°					
		Cutting angle adjustment range	44~91°					
		Maximum cutting depth	500 mm					
		Cutting force per dozing	22.25/23.96/25.96 kN/m					
		Maximum lift above ground	440 mm					
		Maximum blade lateral extension (left/right)	1900/1950 mm					
	HYDRAULIC SYSTEM	Working pump	Tandem pump					
		Displacement of working pump	28*2ml/r					
		Working hydraulic pressure	16 MPa					

## OVERALL DIMENSIONS

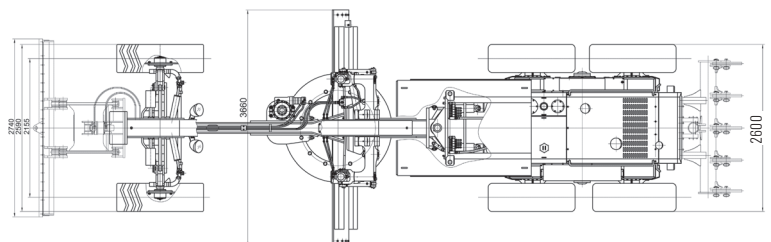
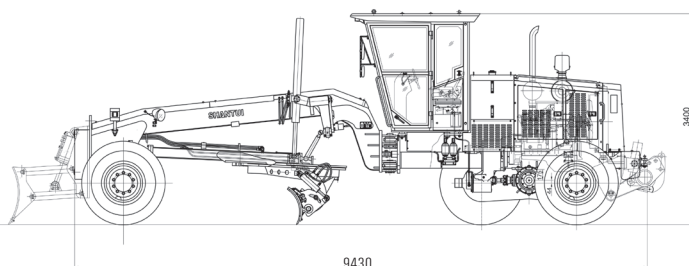

▶ THE SPECIFICATIONS ARE SUBJECT TO CHANGE WITHOUT NOTICE. THE PICTURES MAY INCLUDE OPTIONS. THE ACTUAL COLOR & APPEARANCE OF THE PRODUCT MAY DIFFER FROM WHAT IS SHOWN.