

Shelf tracking system

PS-NO-0001(Track)/PS-NO-0002(Input connector)/PS-NO-0003(Connector)



Features

- Avoid the repeated wiring of the lamps above the multilayer board
- Can create lighting effects in any space.
- Can be used on glass and wood simultaneously
- Warranty: 5 years

Parameter

Voltage	12V/24V
Max. Current	5A
Protection	IP20

Dimension(mm)

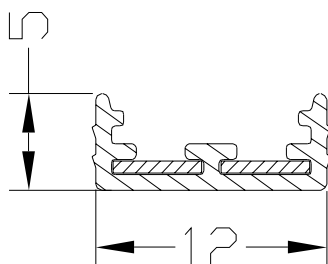

Installation diagram

① Slot on one side of the wood: W12.5mm*H 5.5mm

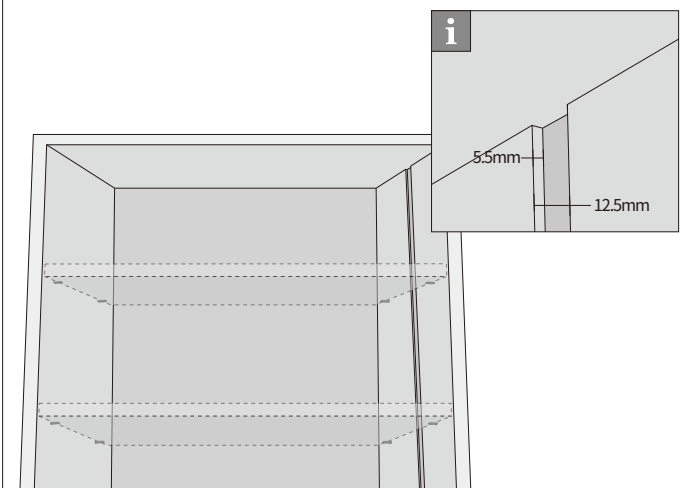

② Slot at the top: $\Phi 6\text{mm}$

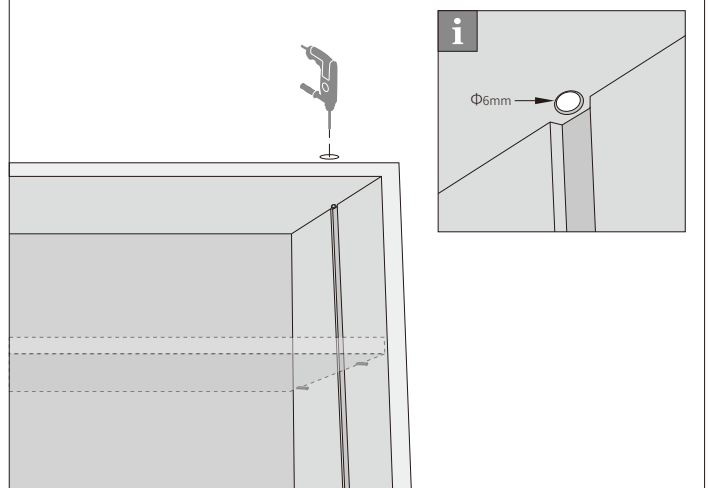

③ Cut the corresponding length of the track access strip and press down into the track

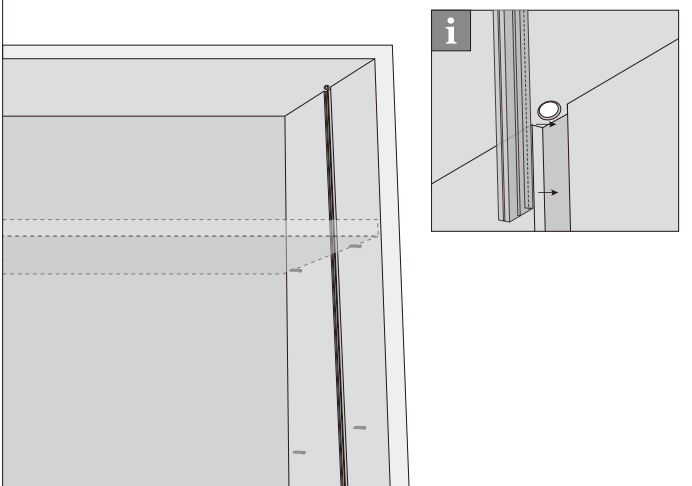

④ Connect input connector

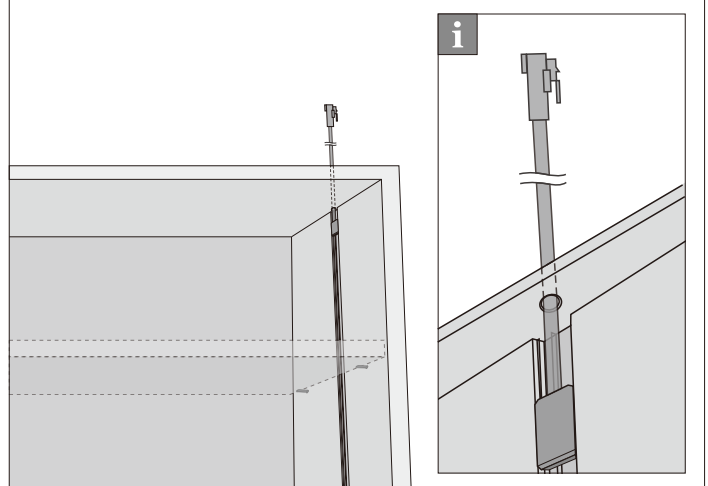

⑤ Open a hole $\Phi 12.5\text{mm}$ on the side of Laminate, and put in power adaptor

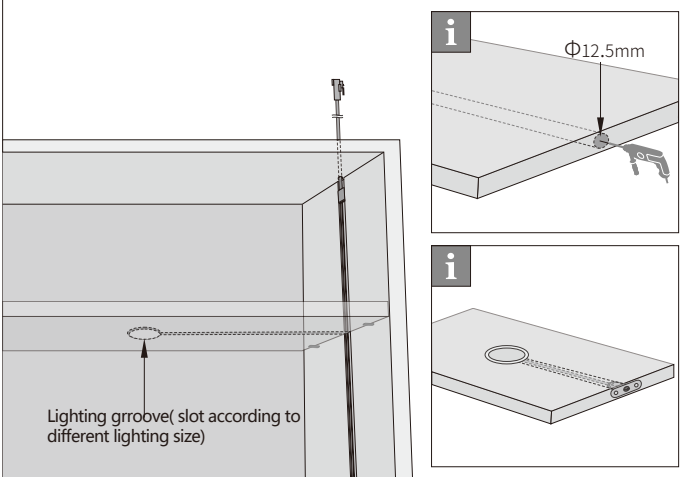

⑥ Connect Driver DC12/24V

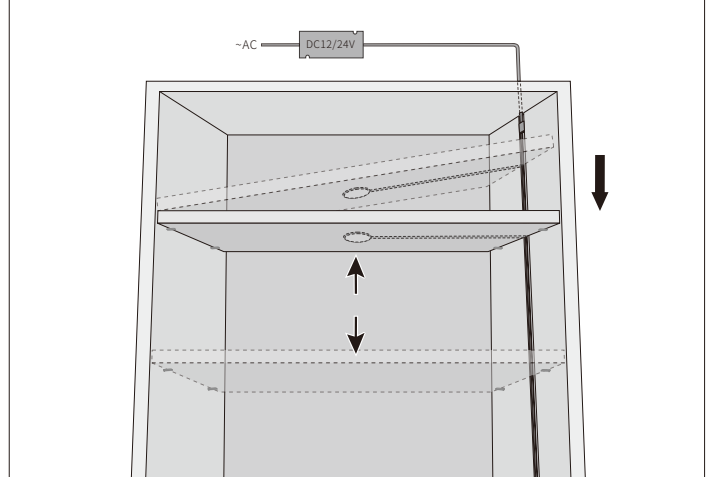

Packing

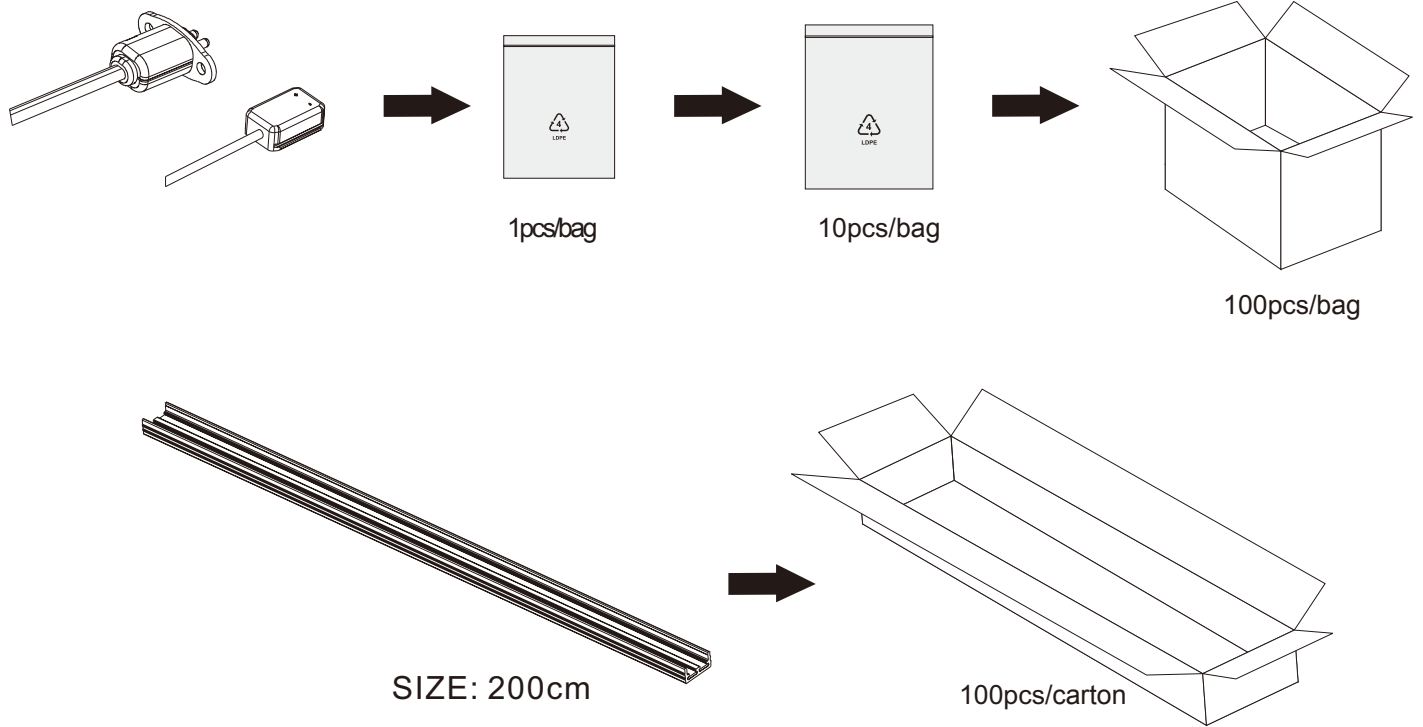

MODEL	SIZE	N.W.	G.W.	QTY
	20*14*16cm	1.1KG	1.5KG	100PCS
	20*14*16cm	3.8KG	4.2KG	100PCS
	200*18*6cm	16.3KG	17.3KG	100PCS