

AVAILABLE SIZES

- 300x300mm
- 300x600mm
- 300x1200mm
- 600x600mm
- 600x1200mm

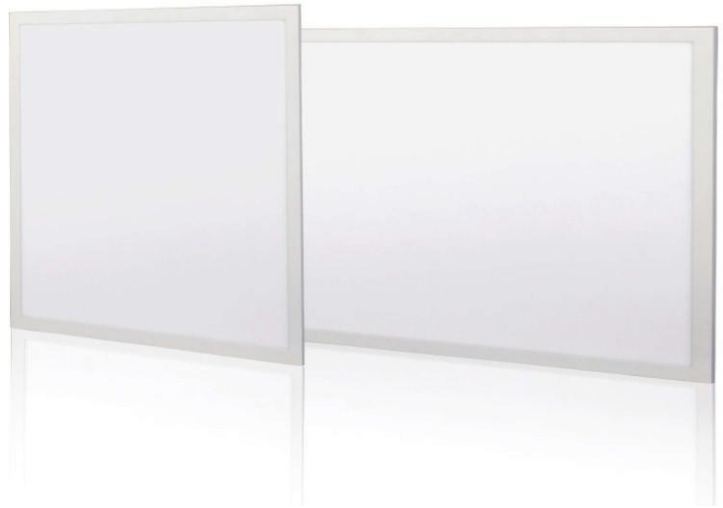

FEATURES

- 2 Side Edge-lit
- PS-A Light Guide Plate
- Standard 100lm/w , Energy Saving
- Patent design to avoid blue light & Water ripper and light spot
- UGR<19 available
- Dali, Triac, push, 0-10V Dimmable

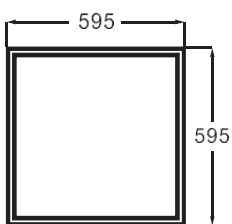
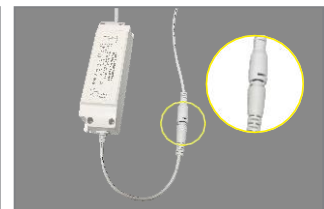
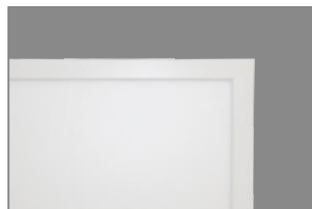

595*595mm

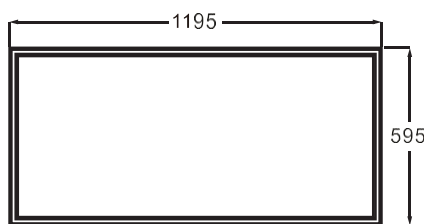

595*1195mm

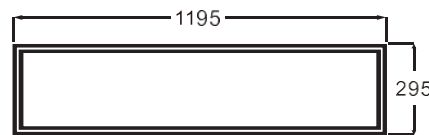

295*1195mm

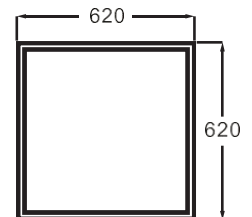

620*620mm

Model	Wattage (W)	Efficacy (lm/w)	Colour Temp (K)	CRI
600x600	26/30/36/40/CCT	100	3000/4000/5000	>80
300x1200	26/30/36/40/CCT	100	3000/4000/5000	>80
600x1200	50/CCT	100	3000/4000/5000	>80
620x620	36/40/CCT	100	3000/4000/5000	>80

● Panel connection diagram

Reversing connection may cause lighting delay.

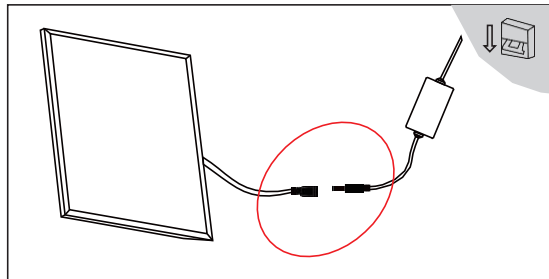

1. Connect driver to the panel

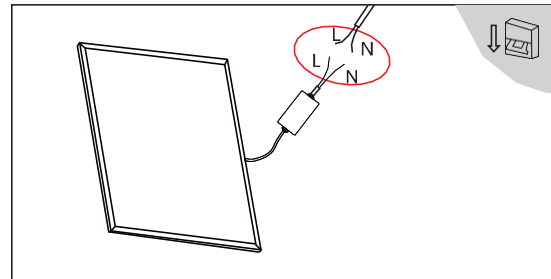

2. Then connect with city power (L-L ; N-N)

● Recession Installation

Customers can choose safety rope to avoid lamp falling caused by uncertain factors (earthquake, etc).

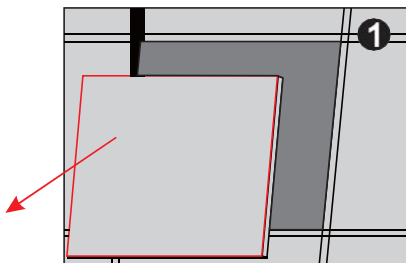

1. Remove the plasterboard from the ceiling.

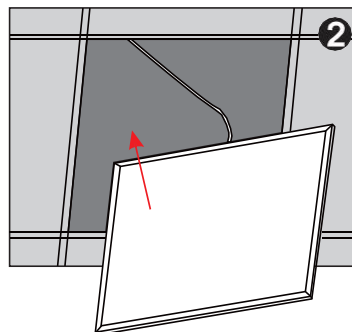

2. Fix the panel into ceiling.

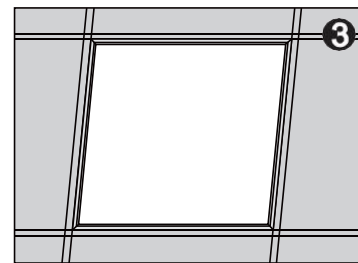

3. Installation finished.

● Suspension Installation

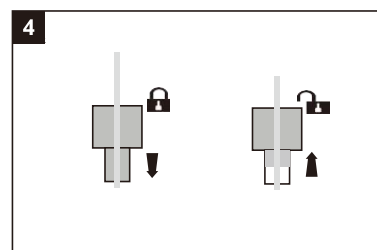
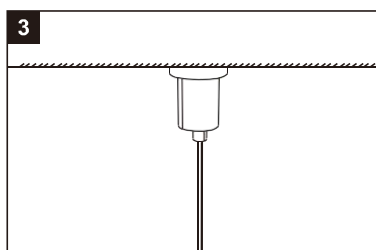
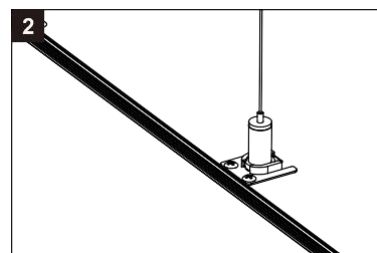
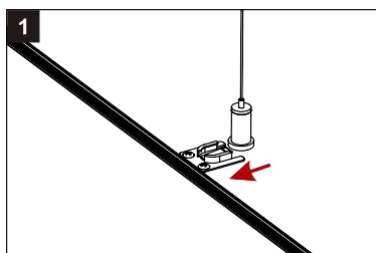

● Recessed Frame MG-M002

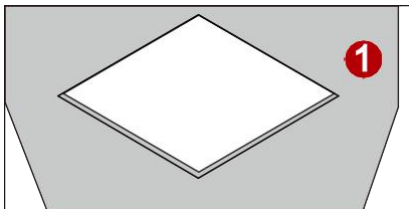

1. Open a hole on the ceiling

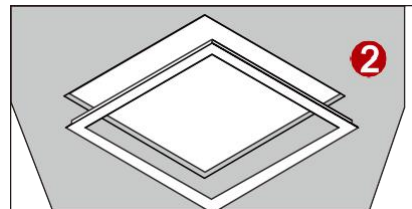

2. Fix the frame to the hole

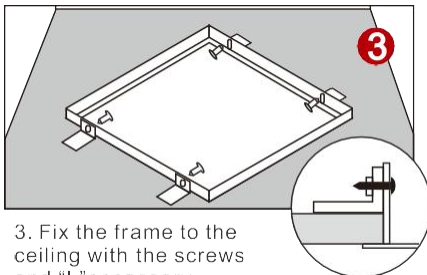

3. Fix the frame to the ceiling with the screws and "L" accessory

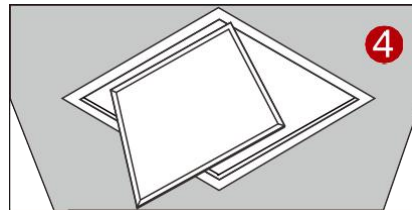

4. Put the panel into the frame

● Surfaced Mounted Frame MG-M004

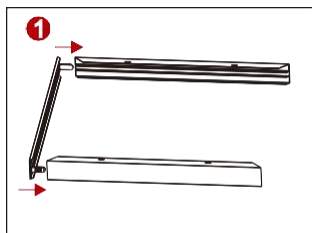

1. Splice the 3 pieces of frame by metal bracket

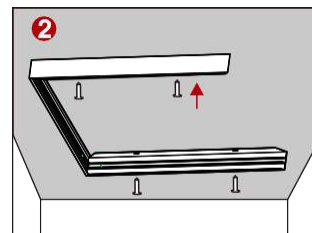

2. Fix the square frames to ceiling with Screw.

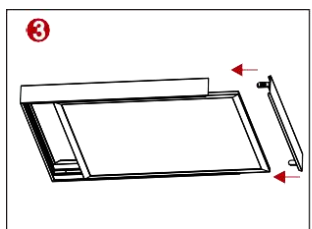

3. Insert the panel into frames and fix the cover plate frame

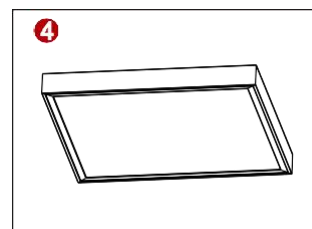

4. Finished frame installation

● Package



1pcs/inner box 5pcs/carton box



2pcs/inner box 6pcs/carton box



No inner box 6pcs/carton box